

burdock



LIGHTING NARRATIVE AND CONCEPT

Entering this restaurant, the goal is for customers to feel as if they are being revived by fresh colors, finishes, and food. The Turkish motif known as the "Burdock" is a type of flower and root. It is the motif for protection and abundance. This plant is used to ward off the evil eye in Turkish culture. Burdock has many health and beauty benefits which is the concept behind Burdock. In the entryway customers are greeted with the stunning Aluminum pendant dome's from Halo. They will then see the hostess stand where the Lanterra fixture from Lumiere puts menu's on display. Looking ahead toward the waiting area flowers are extruding from the wall behind the Halo mini LED track lights that graze against the historic brick wall. This entire restaurant space aims to mimic the beautiful, organic shape of the Burdock flower. Shadows from light fixtures are purposeful to display flowers being casted all over the restaurant.

PROJECT DESCRIPTION

I designed this restaurant in the historical, bazaar section of Izmir, Turkey. The goal was to preserve existing historical aspects of this building while transforming it into a brand new space. Burdock will be the first restaurant in this area to start the transition to become more contemporary.



Ceiling Under Mezzanine Floor 1

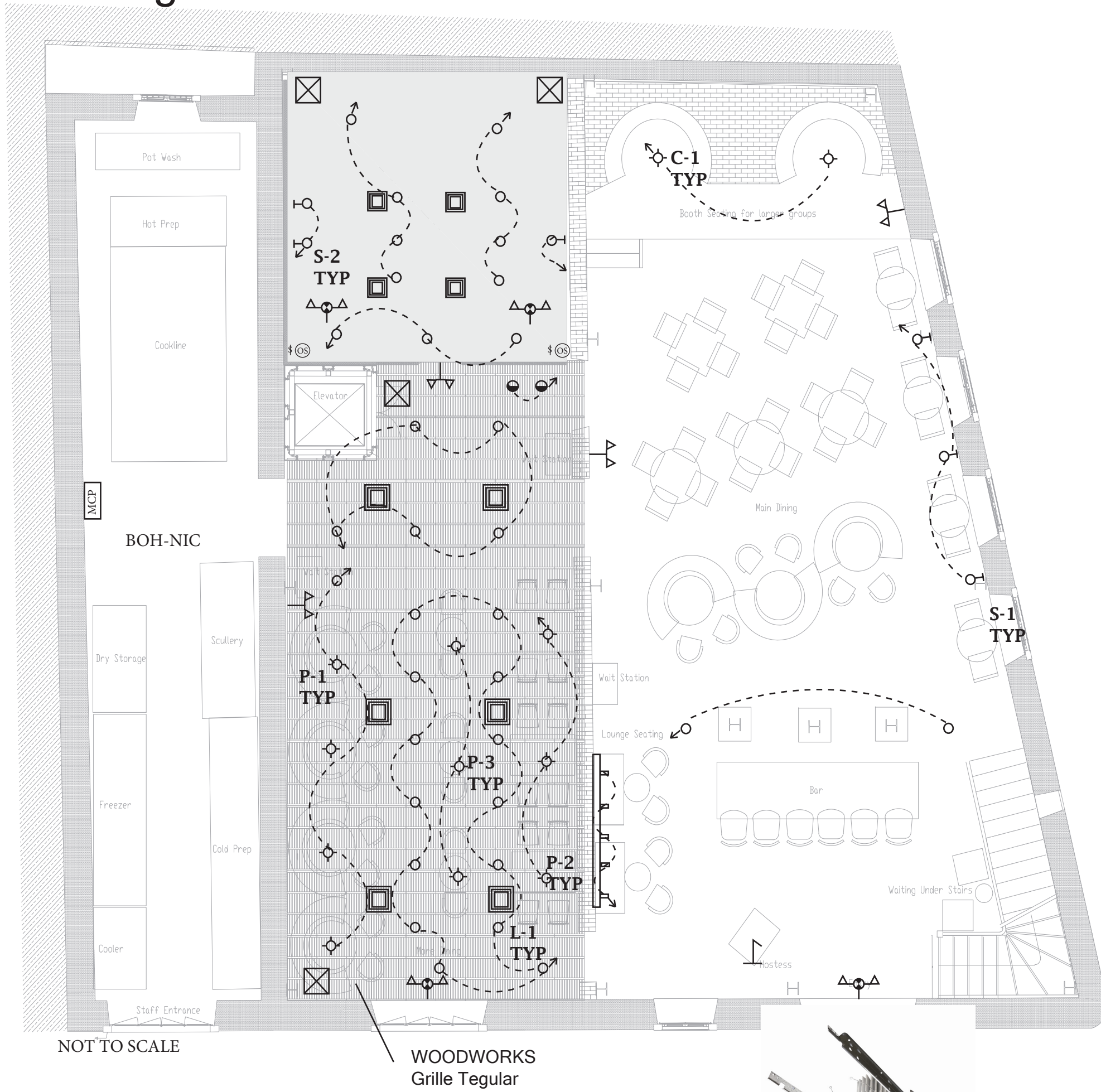

Ceiling Above Mezzanine Floor 2

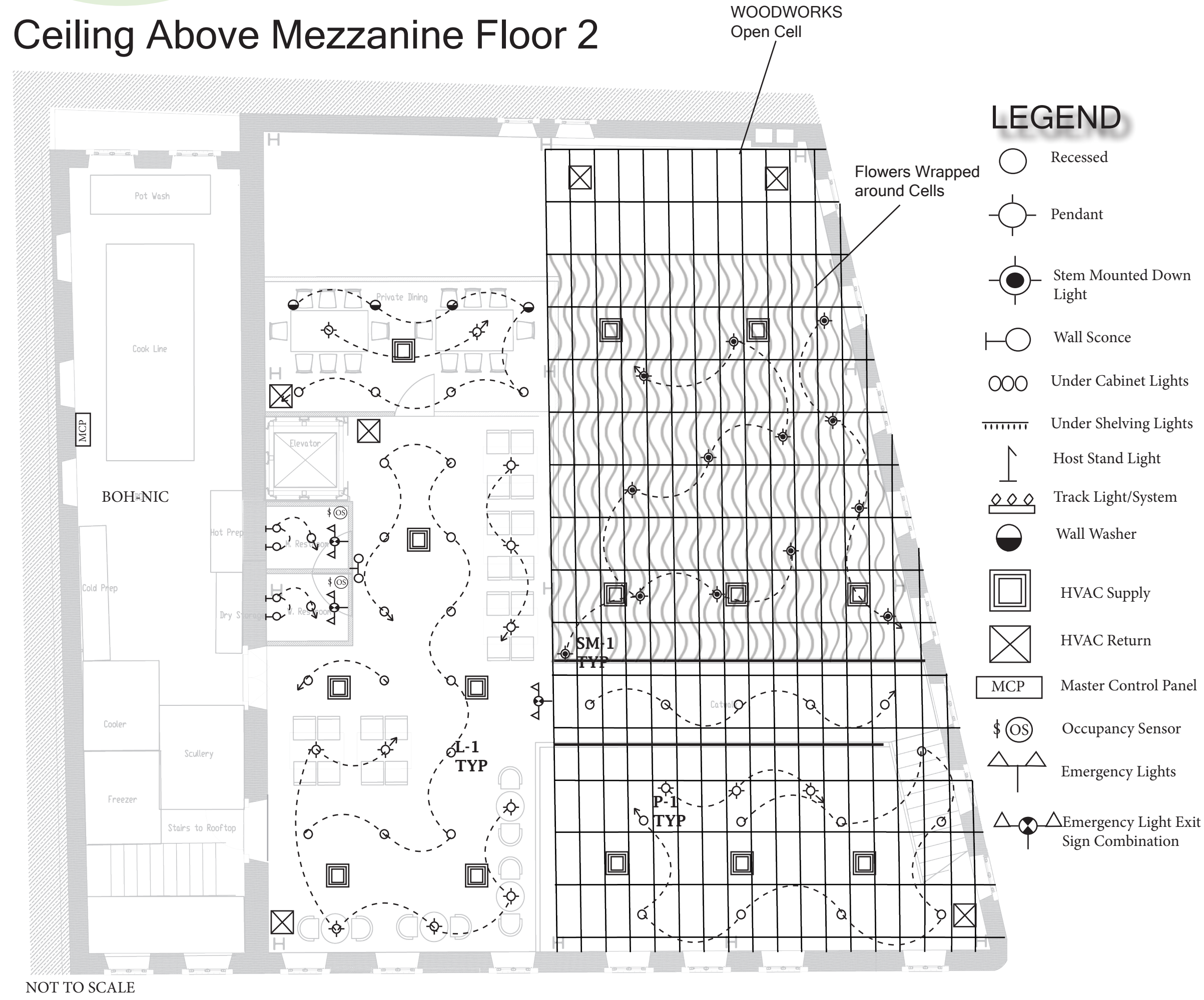

LEGEND

- Recessed
- Pendant
- Stem Mounted Down Light
- Wall Sconce
- Under Cabinet Lights
- Under Shelving Lights
- Host Stand Light
- Track Light/System
- Wall Washer
- HVAC Supply
- HVAC Return
- Master Control Panel
- Occupancy Sensor
- Emergency Lights
- Emergency Light Exit Sign Combination

GENERAL NOTES:

- Propelling flowers attach to WOODWORKS Open Cell Ceiling.
- Fixtures are controlled by MCP unless otherwise stated.

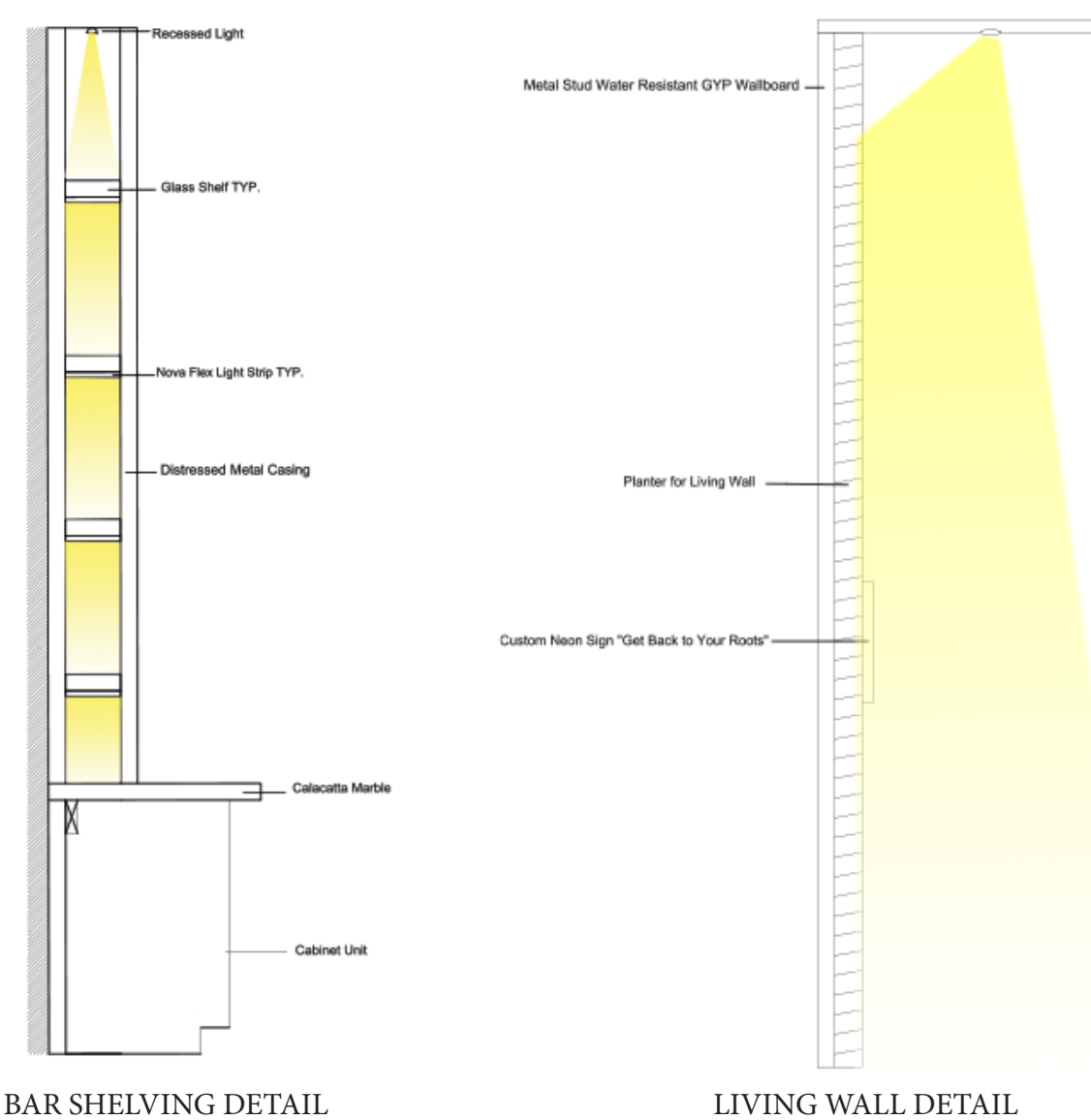
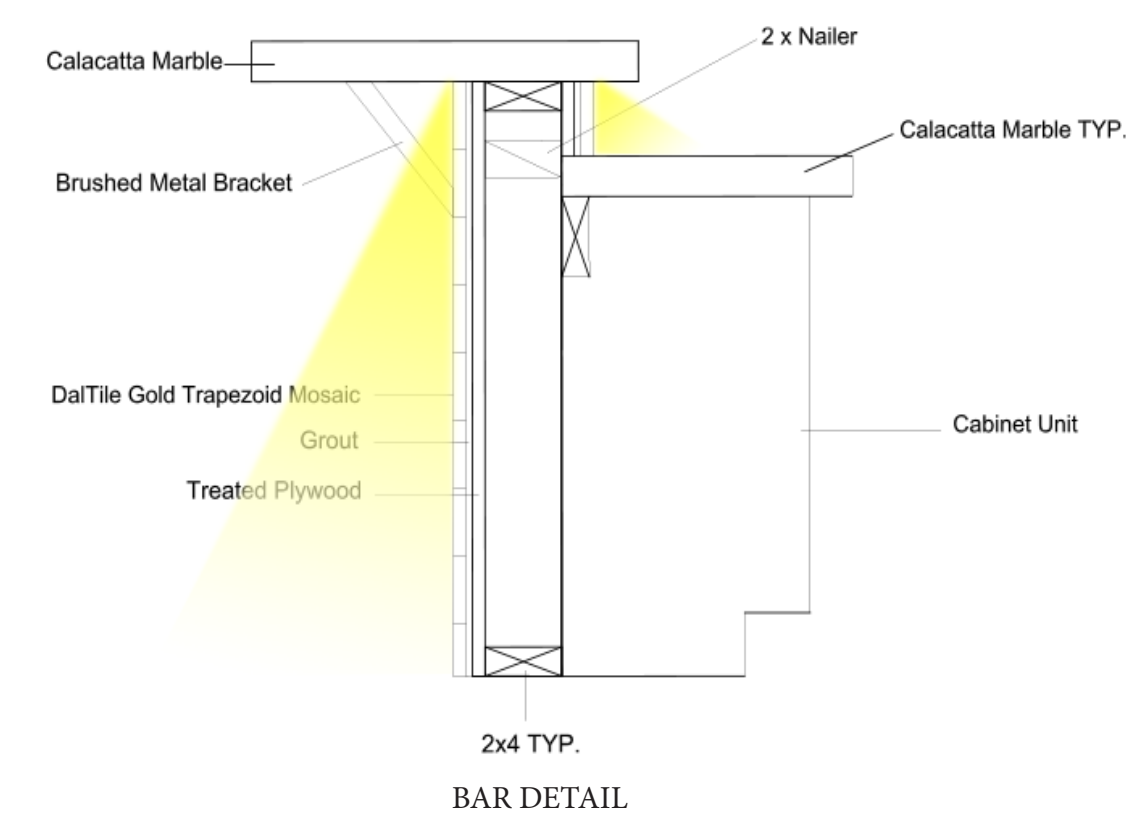

BAR SHELVING DETAIL

LIVING WALL DETAIL



LIGHT SCHEDULE

Tag	Symbol	Description	Manufacturer/Model	Lamp	Mounting	Switching	Remarks
L-1		Recessed Downlight	Halo HC4 LED Series HM412940	LED	Ceiling	MCP	
L-2		Recessed Light for Bar	Halo 3001 Adjustable Pinhole Baffle 3001SNBB	LED	Millwork	MCP	Used in bar structures.
SM-1		Stem Mounted Down Light	Halo Commercial HCC6 LED Cylinder Series HCC4S15D010MW	LED	Ceiling	MCP	Hung to match level of flowers.
P-1		Pendant Dome	Halo Classic Low Voltage Pendant Dome H2MDMEAH4MB	*low voltage	Ceiling	MCP	Custom sizing.
P-2		Direct Pendant	Shaper 1800 Performance Pendants 1800DOME80L352MUNVSTDSBATBA	LED	Ceiling	MCP	Secondary seating 4 top tables.
P-3		Direct Pendant	Shaper 148-P Series 148-28-PIS-L3/1827/UNVMCSCA32 1428-28-SHD-SBG-LCK-NFX	Suspension LED	Suspended	MCP	Rotate shade 180 degrees.
P-4		Direct Pendant	Yellow Goat Coco	LED	Ceiling	MCP	Custom-individual.
P-5		Direct Pendant	Jute, Powdercoated steel 240V Warm White Modern Forms Cosmic PD-28807BN	LED	Ceiling	MCP	
C-1		Chandelier	Tech Lighting Mara Grande Chandelier 700MRAGWRLED927	LED	Suspended	MCP	Used in private booths main dining.
WS-1		Sconce	Tech Lighting Scadona Wall Sconce 700WSSDNKRELED927	LED	Wall Mount	MCP	Use in main dining walls.
WS-2		Restroom Sconce	Tech Lighting OKO-Light Bath 700BCOKO3RLED930 - women's 700BCOKO3SLED930 - men's	LED	Wall Mount	MCP	Use in restroom.
ST-1		Under Bar Lighting	Halo HU20 Gen2 LED Undercabinet HU2024PS2P930MBR	LED	Under Cabinet	Millwork	Use under bar.
ST-2		LED Ribbon Bar Shelving	Nova Flex Adjustable Design Series NF-DS-O-128-24V-AS	LED	Under Shelving	Millwork	Under glass shelves behind bar.
H-1		Host Stand Light	Lumiere Lanterra 1002 Pathway 1002PIRWstandCRISBK1421UNVRSM F79-2LSL-2LVR-2LLR-W-2	LED	Surface Mount	MCP	Mounted on host stand.
T-1		Track System	Halo L652 Mini Single Circuit Track L653MB	n/a	Wall Mount	MCP	Mounted on brick wall of entry.
T-2		Track Light	Halo L812 Mini LED Series L81211NF9035MB_	LED	Track Mount	MCP	
WW-1		Wall Washer	IRIS E5TWW P5-M32T-ESTWW-MW_	Compact Fluorescent	Ceiling Mount	MCP	
E-1		Emergency Light Exit Sign Combo	Sure-Lites APC Combo with Square Heads APC7RSQ	LED	Wall Mounted	Emergency	
E-2		Emergency Light	Sure-Lites AP2SQLED Series AP2SQLED	LED	Wall Mounted	Emergency	
MCP-1		Master Control Panel	Color PoE Touchscreen, TSE	-	Wall Mounted	-	
MCP-2		Master Control Panel App	iLumin Mobile Application	-	Mobile	-	
OS-1		Occupancy Sensor	NeoSwitch - Dual Tech/Single Relay Wall Switch Vacancy Sensor	-	Wall Mounted	MCP	



Secondary Dining



Entry and Bar View



Mezzanine View

Sustainable Design Features

- Light colors chosen to reflect more light.
- Used all energy efficient LEDs.
- Master control panel that would preset scenes to dim light according to different times of day and moods.
- Dual tech occupancy sensor switches in each restroom.
- Percentage of windows are small in this historic building compared to the size of exterior walls due to its location in Izmir, Turkey which is a hot environment.

My total is .646 Watts per square feet which is lower than the lighting power allowance allowed by the International Building Code (IBC) limit of .95 for dining. Although Izmir, Turkey does not have an energy conservation code, in order to follow international best practices I chose to use the IBC maximum.