

DESCRIPTION

Low brightness 6" aperture LED adjustable accent fixture with choice of distribution. Adjustment mechanism allows LED capsule to pivot about the center of the aperture at the ceiling line, allowing maximum light output with no flashback. Offered with adjustable accent, flat cut downlight and lensed wall wash trims. Available with dim-to-warm technology – similar to halogen at full power, the 3000K LED warms smoothly as dimmed to 1850K creating a rich warm glow within the space.

Catalog #		Type	
Project		Date	
Comments			
Prepared by			

SPECIFICATION FEATURES

Lower Reflector

Spun 0.050" aluminum. Available in a variety of Alzak® and painted finishes. Two torsion springs pull trim tight to ceiling. Reflector is keyed to prevent improper orientation relative to LED position. Truncated adjustable cut cone allows for full tilt range and flexibility. Lensed wall wash provides even illumination on vertical surfaces.

Upper Reflector

Field interchangeable optics in 15°, 20° or 35° provides smooth beam without color separation. Media holder fits onto upper reflector and holds up to two lens media.

Trim Ring

Self flanged or white polymer trim ring.

Adjustment Mechanism

Stable aiming and locking mechanism allows smooth 362° rotation and 45° elevation adjustment. Aiming scale enables consistent setting across multiple fixtures.

Housing

One piece die cast 1-5/8" deep collar. 18 gauge CRS housing is painted matte black to eliminate stray light. Housing is toolless top accessible.

Universal Mounting Bracket

Accepts 1/2" EMT, C-Channel, T bar fasteners and hanger bars. Provides 5" total adjustment.

Thermal

Aluminum heat sink conducts heat away from the LED module for optimal performance and long life.

LED

LED system contains a plurality of high brightness white LED's combined with a high reflectance upper reflector producing even distribution with no pixilation. Lumen output shall not decrease by more than 10% over the minimum life of 55,000 hours (L90 > 55,000 hours) Auto resetting, thermally protected, LED's are turned off when safe operating temperatures are exceeded. Color variation within 3-step MacAdam ellipses. D2W™ – dim-to-warm shifts CCT from 3000K to 1850K as fixture dims mimicking halogen sources.

Driver

Combination 120-277V 0-10V or 120V trailing edge phase cut driver provides flicker free dimming from 100% to 10%. Optional 1% 0-10V, Fifth Light, or DMX. Driver can be serviced from above or through the aperture.

Connected Lighting Systems

field installed WaveLinX accessory tile mount sensor kit. The WTA WaveLinX tile mount sensor kit offers daylight dimming, PIR motion sensing control, and optional RLTS - Real Time Location Services available. (Refer to WaveLinX system specifications and application guides for details)

The WTA WaveLinX kit includes control module that mounts on the luminaire electrical junction box via 1/2" knock-out, and tilemount sensor with direct-mount spring clips or for octagon ceiling box with included mounting bracket. (Field mount kit ordered and installed separately).

Enlighted wireless tile mount sensor and relay accessory enables wireless control using a tile mount sensor accessory.

Code Compliance

Thermally protected and cULus listed for damp locations with flat cut, pinhole or angle cut and wet location covered ceiling with lensed or lensed wall wash. Optional City of Chicago environmental air (CCEA) marking for plenum applications. EMI/RFI emissions per FCC 47CFR Part 18 Class B consumer limits. 3000 lumen Non-IC rated - Insulation must be kept 3" from top and sides of housing. IC rated up to 2000 lumen. RoHS Compliant. 3000 lumen and above are marked spacing and must follow spacing requirements. Photometric testing completed in accordance with IES LM 79 standards. Lumen maintenance projections in accordance with IES LM-80-08 and TM-21-11.

Warranty

5 year warranty.



LDA6A 6L

1000-7000 Lumen LED

6-Inch
Adjustable Slope Wall Wash
New Construction

ENERGY DATA

Sound Rating: Class A standards
T ambient -40 + 40°C
Power Factor: >0.90
THD < 20%

1000 Lumen		
	120V	277V
Input Power	13.8W	15.0W
Input Current	0.12A	0.06A
Inrush Current	0.49A	0.85A

1500 Lumen		
	120V	277V
Input Power	22.9W	22.9W
Input Current	0.19A	0.09A
Inrush Current	0.72A	0.53A

2000 Lumen		
	120V	277V
Input Power	29.1W	29.4W
Input Current	0.24A	0.12A
Inrush Current	0.79A	1.09A

3000 Lumen		
	120V	277V
Input Power	44.5W	44.2W
Input Current	0.37A	0.17A
Inrush Current	1.09A	1.23A

4500 Lumen		
	120V	277V
Input Power	54.4W	52.2W
Input Current	0.46A	0.2A
Inrush Current	0.48A	1.316A

5500 Lumen		
	120V	277V
Input Power	60.8W	60.5W
Input Current	0.51A	0.24A
Inrush Current	1.248A	2.944A

6500 Lumen		
	120V	277V
Input Power	78.7W	77.5W
Input Current	0.66A	0.3A
Inrush Current	0.224A	0.704A

7500 Lumen		
	120V	277V
Input Power	78.7W	77.5W
Input Current	0.66A	0.3A
Inrush Current	0.224A	0.704A

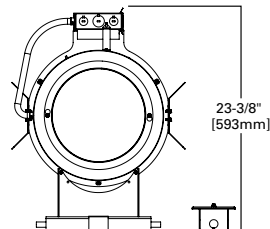
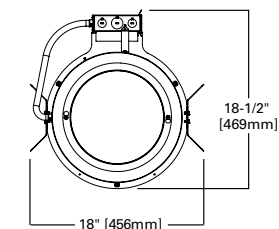

Refer to ENERGY STAR® Qualified Products List.

H1= 7-7/8" [200mm] (1000-3000 lumen)
8-3/8" [213mm] (4500-7000 lumen)
H2= 9-1/2" [241mm] (1000-3000 lumen)
10" [254mm] (4500-7000 lumen)

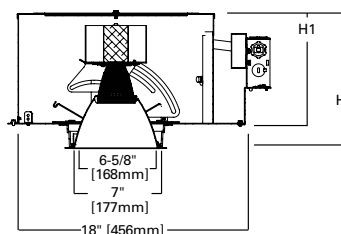
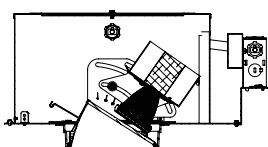
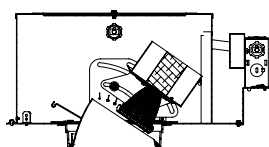

ORDERING INFORMATION

SAMPLE NUMBER: LDA6A15930D010TE

Housing	Lumens ¹	CRI	CCT	Driver	Options ^{3,6}
LDA6A=6" Aperture adjustable/ slope LDA6ACP=6" Aperture adjustable/ slope, Chicago Plenum	10=1000 (IC Rated) 15=1500 (IC Rated) 20=2000 (IC Rated) 30=3000 (Non IC) ⁵ 45=4500 (Non IC) ^{5,7} 55=5500 (Non IC) ^{5,7} 65=6500 (Non IC) ^{5,7} 75=7500 (Non IC) ^{6,7}	8=80 CRI 9=90 CRI	27=2700K 30=3000K 35=3500K 40=4000K 30D2W= Dim to warm 3000K to 1850K (1800 lumen and below, 90 CRI) ⁸	1000, 1500, 2000, 3000 and 4500 Lumen D010TE=120-277V 0-10V 1% dimming or trailing edge 120V Dimming 1000, 1500, 2000 and 3000 Lumen D010TR=120-277V 0-10V 1% dimming or leading edge 120V Dimming D5LT=Fifth Light® (DALI) 0% Dimming DE010=1 to 100% Dimming, 120-277V 50/60Hz, 0-10V DLT=Hi-Lume Forward Phase 2-wire Dimming 120V DMX=DMX 0% Dimming ¹⁰ 5500, 6500, and 7500 Lumen D010=120-277V, 0-10V 10% Dimming	EMBOD=7W Bodine® Emergency Module with Remote Test Switch EMBOD7ST=Bodine® Emergency Module with Self Test Remote Test Switch EM7=7W Emergency Module with Remote Test Switch EM14=14W Emergency Module with Remote Test Switch

SAMPLE NUMBER: LARL20NF

Beam Forming Upper Reflector	
1000 to 3000 lumen LARL15SP=15° Reflector LARL20NF=20° Reflector LAR35FL=35° Reflector	4500 to 7500 lumen LARH20SP=20° Reflector LARH30NF=30° Reflector LARH40FL=40° Reflector

SAMPLE NUMBER: 6LA1LI

Reflector	Finish	Options
6LA0=6" Adjustable Accent, Polymer Trim Ring 6LA1= 6" Adjustable Accent, Self Flanged 6LLWW0=6" Lensed Wall Wash, Polymer Trim Ring ⁹ 6LLWW1=6" Lensed Wall Wash, Self Flanged ⁹ 6LAL0=6" Lensed Adjustable Accent, Polymer Trim Ring 6LAL1=6" Lensed Adjustable Accent, Self Flanged 6LFC0=6" Flat Cut, Polymer Trim Ring 6LFC1=6" Flat Cut, Self Flanged	LI=Specular Clear H=Semi-Specular Clear WMH=Warm Haze G=Specular Gold WH=Wheat WHH=Wheat Haze GP=Graphite GPH=Graphite Haze B=Specular Black MW=Matte White	Self-Flanged Only WF=White Painted Flange

Accessories

TRM6P=Metal Trim Ring, White ² TRM6MB=Metal Trim Ring, Black ² TRR6=Rimless Trim Ring ² LGSKT6IP66=IP66 Gasket Kit ⁴ Bar Hangers HB26=C-channel Bar Hanger, 26" Long, Pair HB50=C-channel Bar Hanger, 50" Long, Pair RMB22=Wood Joist Bar Hanger, 22" Long, Pair Transformers H347=347 to 120V Step Down Transformer, 75VA H347200=347 to 120V Step Down Transformer, 200VA Connected Lighting Systems PORLWTPD1=Enlighted wireless sensor kit (0-10V only) WTA=WaveLinX wireless sensor kit for daylight dimming, PIR motion sensing, and optional RLTS - Real Time Location Services, use with D010 only (Refer to WaveLinX system specifications and guides for details) Field installed ¹¹	Color Filters F22-20=Red F33-20=Blue F44-20=Green F55-20=Yellow F66-20=Mercury Dichronic Filters F71-20=Peach F72-20=Amber F73-20=Green F74-20=Medium Blue F75-20=Yellow F76-20=Red F77-20=Dark Blue F78-20=Light Blue F79-20=Neutral Density F80-20=Magenta	Beam-Modifying Lenses LSL-20=Linear Spread Lens OSL-20=Overall Spread Lens DIF-20=Diffused Lens Louvers LVR-20=Hex Cell Louver
--	--	---

Notes:

- Nominal Lumens will vary depending on selected color, driver and reflector finish.
- Order trim with polymer trim ring (Consult specification sheet for color ordering information and options).
- Not available with Chicago Plenum and requires above ceiling access. Not for use with insulation.
- Required for T-24 compliance with lensed trims.
- Product is marked spacing and must be installed with the following minimum spacing:
Center to center of adjacent luminaires: 36"
Center of luminaire to side of building member: 18"
Minimum overhead clearance: 1/2"
- Not CSA approved.
- Not available in Chicago Plenum.
- Includes 30° distribution diffuse lens. Order with LARL15SP upper reflector. Reference ies files for output.
- Use with narrow flood beam forming reflector and 30° tilt.
- DMX fixtures default to full on upon loss of DMX signal..
- Refer to system specifications for additional information, features, and benefits. Order either factory installed option or accessory. Use with 0-10V driver.

PHOTOMETRICS

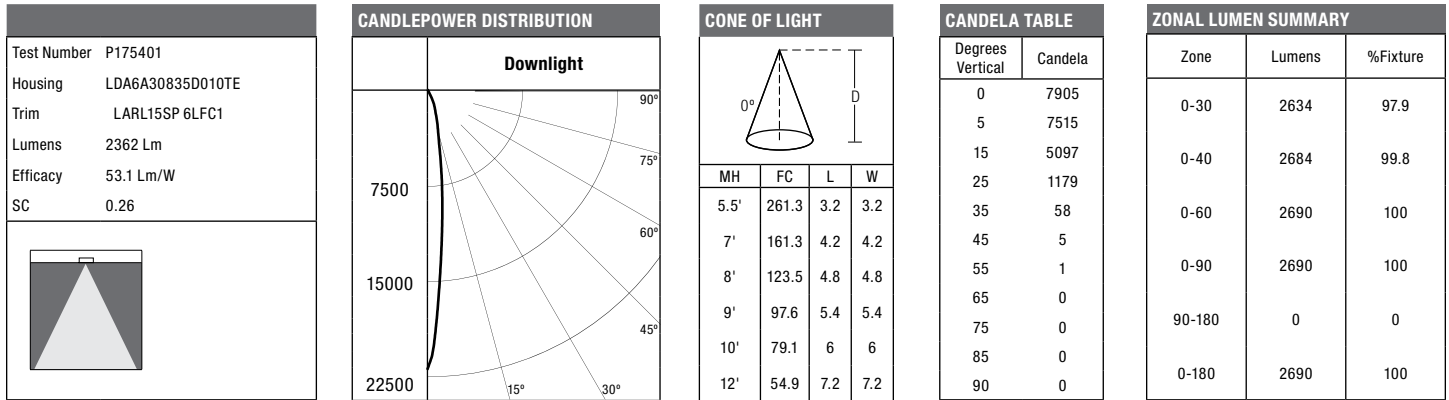
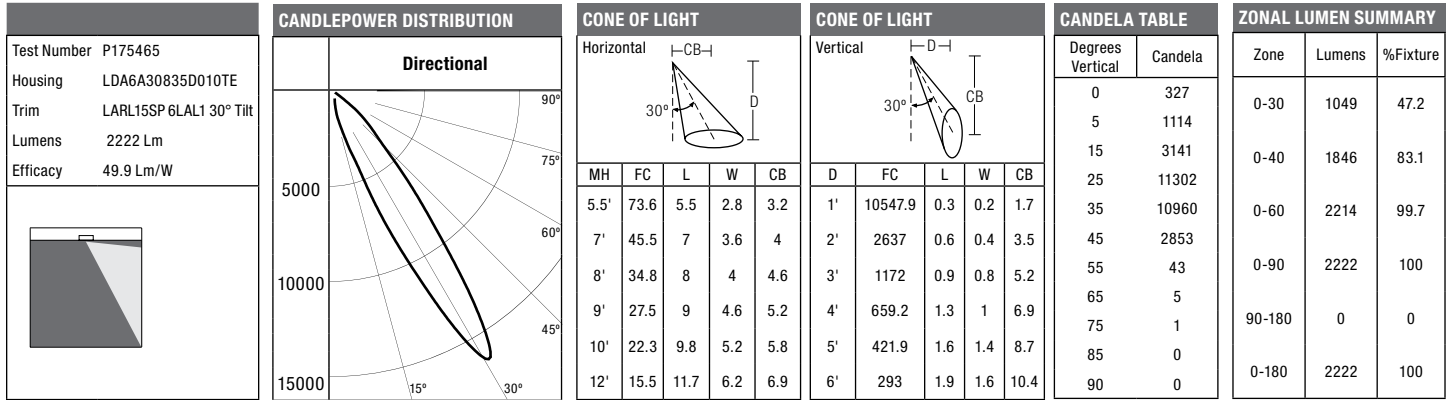
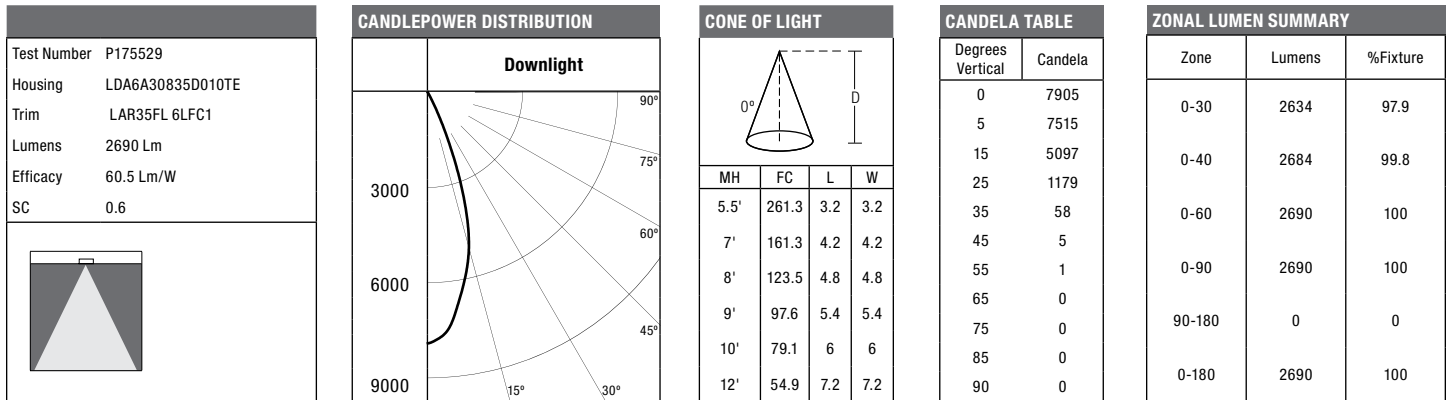
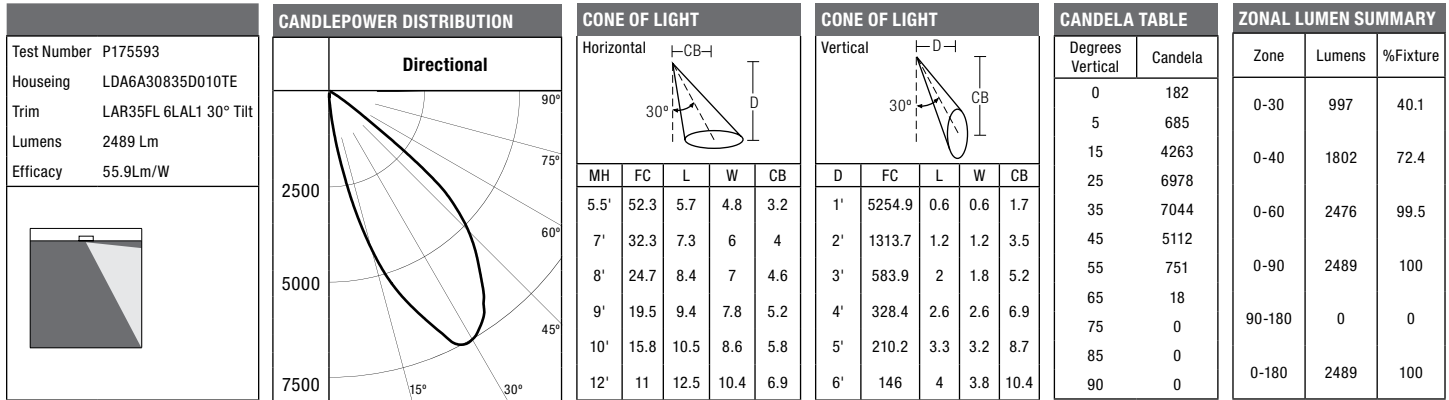

PHOTOMETRICS

Test Number P175497 Housing LDA6A30835D010TE Trim ARL20NF 6LAL1 30° Tilt Lumens 2566 Lm Efficacy 57.7 Lm/W	CANDLEPOWER DISTRIBUTION Directional					CONE OF LIGHT Horizontal					CONE OF LIGHT Vertical					CANDELA TABLE		ZONAL LUMEN SUMMARY																																																																																																				
	<table border="1"> <thead> <tr> <th>MH</th> <th>FC</th> <th>L</th> <th>W</th> <th>CB</th> </tr> </thead> <tbody> <tr><td>5.5'</td><td>84</td><td>5.5</td><td>3.4</td><td>3.2</td></tr> <tr><td>7'</td><td>51.9</td><td>7</td><td>4.4</td><td>4</td></tr> <tr><td>8'</td><td>39.7</td><td>7.9</td><td>5</td><td>4.6</td></tr> <tr><td>9'</td><td>31.4</td><td>8.9</td><td>5.6</td><td>5.2</td></tr> <tr><td>10'</td><td>25.4</td><td>9.8</td><td>6.2</td><td>5.8</td></tr> <tr><td>12'</td><td>17.6</td><td>11.7</td><td>7.6</td><td>6.9</td></tr> </tbody> </table>	MH	FC	L	W	CB	5.5'	84	5.5	3.4	3.2	7'	51.9	7	4.4	4	8'	39.7	7.9	5	4.6	9'	31.4	8.9	5.6	5.2	10'	25.4	9.8	6.2	5.8	12'	17.6	11.7	7.6	6.9	<table border="1"> <thead> <tr> <th>D</th> <th>FC</th> <th>L</th> <th>W</th> <th>CB</th> </tr> </thead> <tbody> <tr><td>1'</td><td>11381.5</td><td>0.3</td><td>0.2</td><td>1.7</td></tr> <tr><td>2'</td><td>2845.4</td><td>0.8</td><td>0.6</td><td>3.5</td></tr> <tr><td>3'</td><td>1264.6</td><td>1.2</td><td>1</td><td>5.2</td></tr> <tr><td>4'</td><td>711.3</td><td>1.7</td><td>1.4</td><td>6.9</td></tr> <tr><td>5'</td><td>455.3</td><td>2.2</td><td>1.8</td><td>8.7</td></tr> <tr><td>6'</td><td>316.2</td><td>2.6</td><td>2.2</td><td>10.4</td></tr> </tbody> </table>	D	FC	L	W	CB	1'	11381.5	0.3	0.2	1.7	2'	2845.4	0.8	0.6	3.5	3'	1264.6	1.2	1	5.2	4'	711.3	1.7	1.4	6.9	5'	455.3	2.2	1.8	8.7	6'	316.2	2.6	2.2	10.4	<table border="1"> <thead> <tr> <th>Degrees Vertical</th> <th>Candela</th> </tr> </thead> <tbody> <tr><td>0</td><td>58</td></tr> <tr><td>5</td><td>561</td></tr> <tr><td>15</td><td>3193</td></tr> <tr><td>25</td><td>13468</td></tr> <tr><td>35</td><td>14168</td></tr> <tr><td>45</td><td>4072</td></tr> <tr><td>55</td><td>133</td></tr> <tr><td>65</td><td>5</td></tr> <tr><td>75</td><td>0</td></tr> <tr><td>85</td><td>0</td></tr> <tr><td>90</td><td>0</td></tr> </tbody> </table>	Degrees Vertical	Candela	0	58	5	561	15	3193	25	13468	35	14168	45	4072	55	133	65	5	75	0	85	0	90	0	<table border="1"> <thead> <tr> <th>Zone</th> <th>Lumens</th> <th>%Fixture</th> </tr> </thead> <tbody> <tr><td>0-30</td><td>1092</td><td>42.6</td></tr> <tr><td>0-40</td><td>2122</td><td>82.7</td></tr> <tr><td>0-60</td><td>2557</td><td>99.6</td></tr> <tr><td>0-90</td><td>2566</td><td>100</td></tr> <tr><td>90-180</td><td>0</td><td>0</td></tr> <tr><td>0-180</td><td>2566</td><td>100</td></tr> </tbody> </table>	Zone	Lumens	%Fixture	0-30	1092	42.6	0-40	2122	82.7	0-60	2557	99.6	0-90	2566	100	90-180	0	0	0-180	2566
MH	FC	L	W	CB																																																																																																																		
5.5'	84	5.5	3.4	3.2																																																																																																																		
7'	51.9	7	4.4	4																																																																																																																		
8'	39.7	7.9	5	4.6																																																																																																																		
9'	31.4	8.9	5.6	5.2																																																																																																																		
10'	25.4	9.8	6.2	5.8																																																																																																																		
12'	17.6	11.7	7.6	6.9																																																																																																																		
D	FC	L	W	CB																																																																																																																		
1'	11381.5	0.3	0.2	1.7																																																																																																																		
2'	2845.4	0.8	0.6	3.5																																																																																																																		
3'	1264.6	1.2	1	5.2																																																																																																																		
4'	711.3	1.7	1.4	6.9																																																																																																																		
5'	455.3	2.2	1.8	8.7																																																																																																																		
6'	316.2	2.6	2.2	10.4																																																																																																																		
Degrees Vertical	Candela																																																																																																																					
0	58																																																																																																																					
5	561																																																																																																																					
15	3193																																																																																																																					
25	13468																																																																																																																					
35	14168																																																																																																																					
45	4072																																																																																																																					
55	133																																																																																																																					
65	5																																																																																																																					
75	0																																																																																																																					
85	0																																																																																																																					
90	0																																																																																																																					
Zone	Lumens	%Fixture																																																																																																																				
0-30	1092	42.6																																																																																																																				
0-40	2122	82.7																																																																																																																				
0-60	2557	99.6																																																																																																																				
0-90	2566	100																																																																																																																				
90-180	0	0																																																																																																																				
0-180	2566	100																																																																																																																				

Test Number P175433 Housing LDA6A30835D010TE Trim LARL20NF 6LFC1 Lumens 2695 Lm Efficacy 60.6Lm/W SC 0.34	CANDLEPOWER DISTRIBUTION Downlight					CONE OF LIGHT				CANDELA TABLE		ZONAL LUMEN SUMMARY																																																															
	<table border="1"> <thead> <tr> <th>MH</th> <th>FC</th> <th>L</th> <th>W</th> </tr> </thead> <tbody> <tr><td>5.5'</td><td>589.9</td><td>1.8</td><td>1.8</td></tr> <tr><td>7'</td><td>364.2</td><td>2.4</td><td>2.4</td></tr> <tr><td>8'</td><td>278.8</td><td>2.8</td><td>2.8</td></tr> <tr><td>9'</td><td>220.3</td><td>3</td><td>3</td></tr> <tr><td>10'</td><td>178.5</td><td>3.4</td><td>3.4</td></tr> <tr><td>12'</td><td>123.9</td><td>4.2</td><td>4.2</td></tr> </tbody> </table>	MH	FC	L	W	5.5'	589.9	1.8	1.8	7'	364.2	2.4	2.4	8'	278.8	2.8	2.8	9'	220.3	3	3	10'	178.5	3.4	3.4	12'	123.9	4.2	4.2	<table border="1"> <thead> <tr> <th>Degrees Vertical</th> <th>Candela</th> </tr> </thead> <tbody> <tr><td>0</td><td>17845</td></tr> <tr><td>5</td><td>14698</td></tr> <tr><td>15</td><td>3736</td></tr> <tr><td>25</td><td>627</td></tr> <tr><td>35</td><td>8</td></tr> <tr><td>45</td><td>1</td></tr> <tr><td>55</td><td>0</td></tr> <tr><td>65</td><td>0</td></tr> <tr><td>75</td><td>0</td></tr> <tr><td>85</td><td>0</td></tr> <tr><td>90</td><td>0</td></tr> </tbody> </table>	Degrees Vertical	Candela	0	17845	5	14698	15	3736	25	627	35	8	45	1	55	0	65	0	75	0	85	0	90	0	<table border="1"> <thead> <tr> <th>Zone</th> <th>Lumens</th> <th>%Fixture</th> </tr> </thead> <tbody> <tr><td>0-30</td><td>2686</td><td>99.7</td></tr> <tr><td>0-40</td><td>2694</td><td>100</td></tr> <tr><td>0-60</td><td>2695</td><td>100</td></tr> <tr><td>0-90</td><td>2695</td><td>100</td></tr> <tr><td>90-180</td><td>0</td><td>0</td></tr> <tr><td>0-180</td><td>2695</td><td>100</td></tr> </tbody> </table>	Zone	Lumens	%Fixture	0-30	2686	99.7	0-40	2694	100	0-60	2695	100	0-90	2695	100	90-180	0	0	0-180	2695
MH	FC	L	W																																																																								
5.5'	589.9	1.8	1.8																																																																								
7'	364.2	2.4	2.4																																																																								
8'	278.8	2.8	2.8																																																																								
9'	220.3	3	3																																																																								
10'	178.5	3.4	3.4																																																																								
12'	123.9	4.2	4.2																																																																								
Degrees Vertical	Candela																																																																										
0	17845																																																																										
5	14698																																																																										
15	3736																																																																										
25	627																																																																										
35	8																																																																										
45	1																																																																										
55	0																																																																										
65	0																																																																										
75	0																																																																										
85	0																																																																										
90	0																																																																										
Zone	Lumens	%Fixture																																																																									
0-30	2686	99.7																																																																									
0-40	2694	100																																																																									
0-60	2695	100																																																																									
0-90	2695	100																																																																									
90-180	0	0																																																																									
0-180	2695	100																																																																									

Test Number P175561 Housing LDA6A30835D010TE Trim LAR35FL 6LLWW1 Lumens 2015 Lm Efficacy 45.3Lm/W	CANDLEPOWER DISTRIBUTION Directional					CONE OF LIGHT Horizontal					CONE OF LIGHT Vertical					CANDELA TABLE		ZONAL LUMEN SUMMARY																																																																																																				
	<table border="1"> <thead> <tr> <th>MH</th> <th>FC</th> <th>L</th> <th>W</th> <th>CB</th> </tr> </thead> <tbody> <tr><td>5.5'</td><td>22.8</td><td>6.8</td><td>6</td><td>3.2</td></tr> <tr><td>7'</td><td>14.1</td><td>8.7</td><td>7.6</td><td>4</td></tr> <tr><td>8'</td><td>10.8</td><td>9.9</td><td>8.8</td><td>4.6</td></tr> <tr><td>9'</td><td>8.5</td><td>11.2</td><td>10</td><td>5.2</td></tr> <tr><td>10'</td><td>6.9</td><td>12.3</td><td>11</td><td>5.8</td></tr> <tr><td>12'</td><td>4.8</td><td>14.7</td><td>13.2</td><td>6.9</td></tr> </tbody> </table>	MH	FC	L	W	CB	5.5'	22.8	6.8	6	3.2	7'	14.1	8.7	7.6	4	8'	10.8	9.9	8.8	4.6	9'	8.5	11.2	10	5.2	10'	6.9	12.3	11	5.8	12'	4.8	14.7	13.2	6.9	<table border="1"> <thead> <tr> <th>D</th> <th>FC</th> <th>L</th> <th>W</th> <th>CB</th> </tr> </thead> <tbody> <tr><td>1'</td><td>2380.4</td><td>0.6</td><td>0.6</td><td>1.7</td></tr> <tr><td>2'</td><td>595.1</td><td>1.3</td><td>1.4</td><td>3.5</td></tr> <tr><td>3'</td><td>264.5</td><td>1.9</td><td>2.2</td><td>5.2</td></tr> <tr><td>4'</td><td>148.8</td><td>2.6</td><td>3</td><td>6.9</td></tr> <tr><td>5'</td><td>95.2</td><td>3.4</td><td>3.8</td><td>8.7</td></tr> <tr><td>6'</td><td>66.1</td><td>4</td><td>4.6</td><td>10.4</td></tr> </tbody> </table>	D	FC	L	W	CB	1'	2380.4	0.6	0.6	1.7	2'	595.1	1.3	1.4	3.5	3'	264.5	1.9	2.2	5.2	4'	148.8	2.6	3	6.9	5'	95.2	3.4	3.8	8.7	6'	66.1	4	4.6	10.4	<table border="1"> <thead> <tr> <th>Degrees Vertical</th> <th>Candela</th> </tr> </thead> <tbody> <tr><td>0</td><td>427</td></tr> <tr><td>5</td><td>726</td></tr> <tr><td>15</td><td>1654</td></tr> <tr><td>25</td><td>2420</td></tr> <tr><td>35</td><td>2384</td></tr> <tr><td>45</td><td>1609</td></tr> <tr><td>55</td><td>551</td></tr> <tr><td>65</td><td>108</td></tr> <tr><td>75</td><td>8</td></tr> <tr><td>85</td><td>3</td></tr> <tr><td>90</td><td>0</td></tr> </tbody> </table>	Degrees Vertical	Candela	0	427	5	726	15	1654	25	2420	35	2384	45	1609	55	551	65	108	75	8	85	3	90	0	<table border="1"> <thead> <tr> <th>Zone</th> <th>Lumens</th> <th>%Fixture</th> </tr> </thead> <tbody> <tr><td>0-30</td><td>694</td><td>34.5</td></tr> <tr><td>0-40</td><td>1263</td><td>62.7</td></tr> <tr><td>0-60</td><td>1959</td><td>97.2</td></tr> <tr><td>0-90</td><td>2015</td><td>100</td></tr> <tr><td>90-180</td><td>0</td><td>0</td></tr> <tr><td>0-180</td><td>2015</td><td>100</td></tr> </tbody> </table>	Zone	Lumens	%Fixture	0-30	694	34.5	0-40	1263	62.7	0-60	1959	97.2	0-90	2015	100	90-180	0	0	0-180	2015
MH	FC	L	W	CB																																																																																																																		
5.5'	22.8	6.8	6	3.2																																																																																																																		
7'	14.1	8.7	7.6	4																																																																																																																		
8'	10.8	9.9	8.8	4.6																																																																																																																		
9'	8.5	11.2	10	5.2																																																																																																																		
10'	6.9	12.3	11	5.8																																																																																																																		
12'	4.8	14.7	13.2	6.9																																																																																																																		
D	FC	L	W	CB																																																																																																																		
1'	2380.4	0.6	0.6	1.7																																																																																																																		
2'	595.1	1.3	1.4	3.5																																																																																																																		
3'	264.5	1.9	2.2	5.2																																																																																																																		
4'	148.8	2.6	3	6.9																																																																																																																		
5'	95.2	3.4	3.8	8.7																																																																																																																		
6'	66.1	4	4.6	10.4																																																																																																																		
Degrees Vertical	Candela																																																																																																																					
0	427																																																																																																																					
5	726																																																																																																																					
15	1654																																																																																																																					
25	2420																																																																																																																					
35	2384																																																																																																																					
45	1609																																																																																																																					
55	551																																																																																																																					
65	108																																																																																																																					
75	8																																																																																																																					
85	3																																																																																																																					
90	0																																																																																																																					
Zone	Lumens	%Fixture																																																																																																																				
0-30	694	34.5																																																																																																																				
0-40	1263	62.7																																																																																																																				
0-60	1959	97.2																																																																																																																				
0-90	2015	100																																																																																																																				
90-180	0	0																																																																																																																				
0-180	2015	100																																																																																																																				

SINGLE UNIT FOOTCANDLES							MULTIPLE UNIT FOOTCANDLES			
DD	2' FROM WALL (Distance From Fixture Along Wall)						3' FROM WALL (Spacing Between Fixtures)			
	●	1'	2'	3'	4'	5'	●	3' apart	●	
1'	33.4	12.6	1.3	0.2	0.1	0	2.5	1.7	2.5	
2'	200.1	103.4	20.5	2.8	0.5	0.1	45.1	36.4	45.1	
3'	136.7	89.5	31.4	8.4	1.9	0.5	98	91.9	98	
4'	69.6	52.5	25	9.8	3.5	1.1	87.1	90.1	87.1	
5'	34.8	28.6	16.9	8.4	3.9	1.7	62.4	67.8	62.4	
6'	18.5	16.1	10.8	6.4	3.5	1.8	42.1	46.7	42.1	
7'	10.5	9.5	7	4.7	2.9	1.7	28	31.2	28	
8'	6.3	5.9	4.6	3.3	2.3	1.5	19	20.9	19	
9'	4	3.8	3.1	2.4	1.8	1.2	13.1	14.3	13.1	
10'	2.7	2.6	2.2	1.8	1.4	1	9.2	10	9.2	