

Project		Catalog #		Type	
Prepared by		Notes		Date	



WaveLinx Wired

SCMD4

WaveLinx Wired Local Bus Control Module

Typical Applications

Office • Education • Healthcare • Hospitality • Retail • Industrial • Manufacturing • Outdoor

Product Certification



Product Features

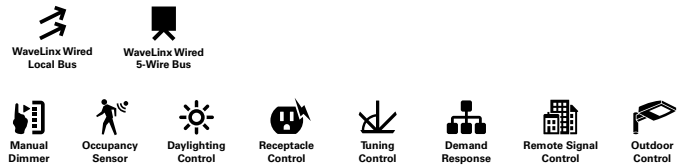

Interactive Menu

- Ordering Information page 2
- Additional Resources page 3
- Wiring Diagrams page 4
- Connected Systems page 5
- Product Warranty

Top Product Features

- Can individually control up to 256 addressable devices on four WaveLinx Wired local bus
- Up to 64 individual devices per WaveLinx Wired local bus
- Alarm and Emergency dry contact inputs
- RS485 & DMX512 inputs

Dimensions

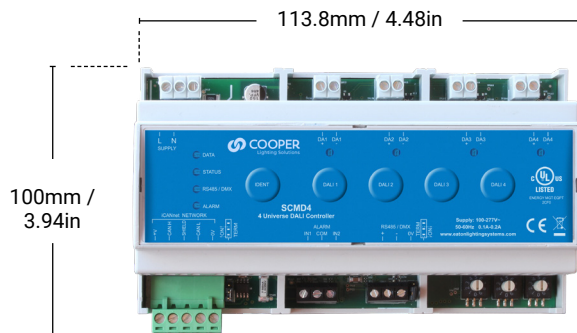

Two key hole slots as an alternative to DINRail fixing

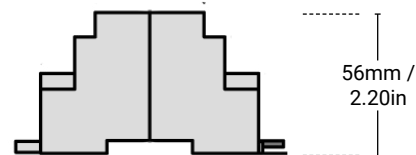

additional product diagrams

Order Information

Catalog Number

Catalog Number	Description
SCMD4	WaveLinx Wired Local Bus Control Module

Product Specifications

Key Features

- Provides four WaveLinx Wired local busses to address and control 256 devices (sensors, fixtures, relays, wallstations)
- Mounts to standard Top Hat (TS 35) DINrail
- 2 dry contact inputs
- DMX control
- RS485 control
- Connects to the WaveLinx Wired digital network
- 4 internal dedicated WaveLinx Wired local bus power supplies
- Each bus has a dedicated test/override button allowing the installer to test or override the installation prior to commissioning
- Configuration stored in Non Volatile EEPROM
- Configurable start up mode

Mechanical

Weight: 0.35kg/0.77lbs

Operating temperature: +2°C to +50°C

Note: All enclosures must be adequately ventilated

Max storage temperature: +60°C

Humidity: +5 to 95% non-condensing

Environmental protection: IP20

Electrical

Supply: 120-277VAC +/- 10% 50/60 Hz, 0.2AMAX

Switch inputs: 2, configurable as break or make, max wire size 12/14AWG

WaveLinx Wired Network inputs/output: Screw terminals

WaveLinx Wired Local Bus: Max wire size 16AWG

WaveLinx Wired Local Bus Power: Nominal 16V, max current 225mA supplies to each bus

DMX signal: Addressable in software, DMX512

Maximum load: 0.2A @ 50°C

Terminals max wire size: 12/14AWG

Standards/Ratings

- cULus Listed - Energy Management Equipment (UL916)
- Manufactured in an ISO 9001 certified factory
- Meets ASHRAE Standard 90.1 requirements
- Meets IECC 2015 requirements
- Meets CEC Title 24 requirements

Environmental Regulations:

- RoHS Directive 2011/65/EU

Warranty

Five year warranty standard

System architecture

Simple WaveLinx Wired system

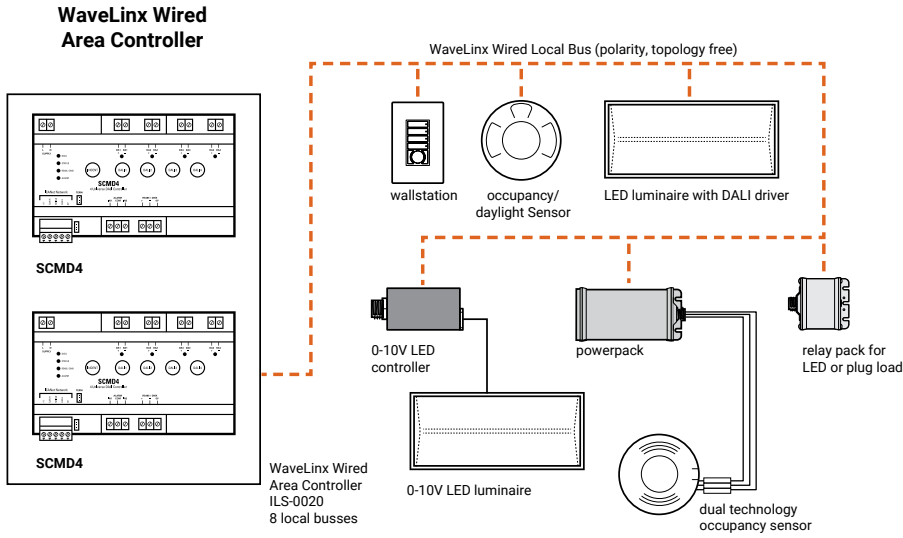

Complete WaveLinx Wired system

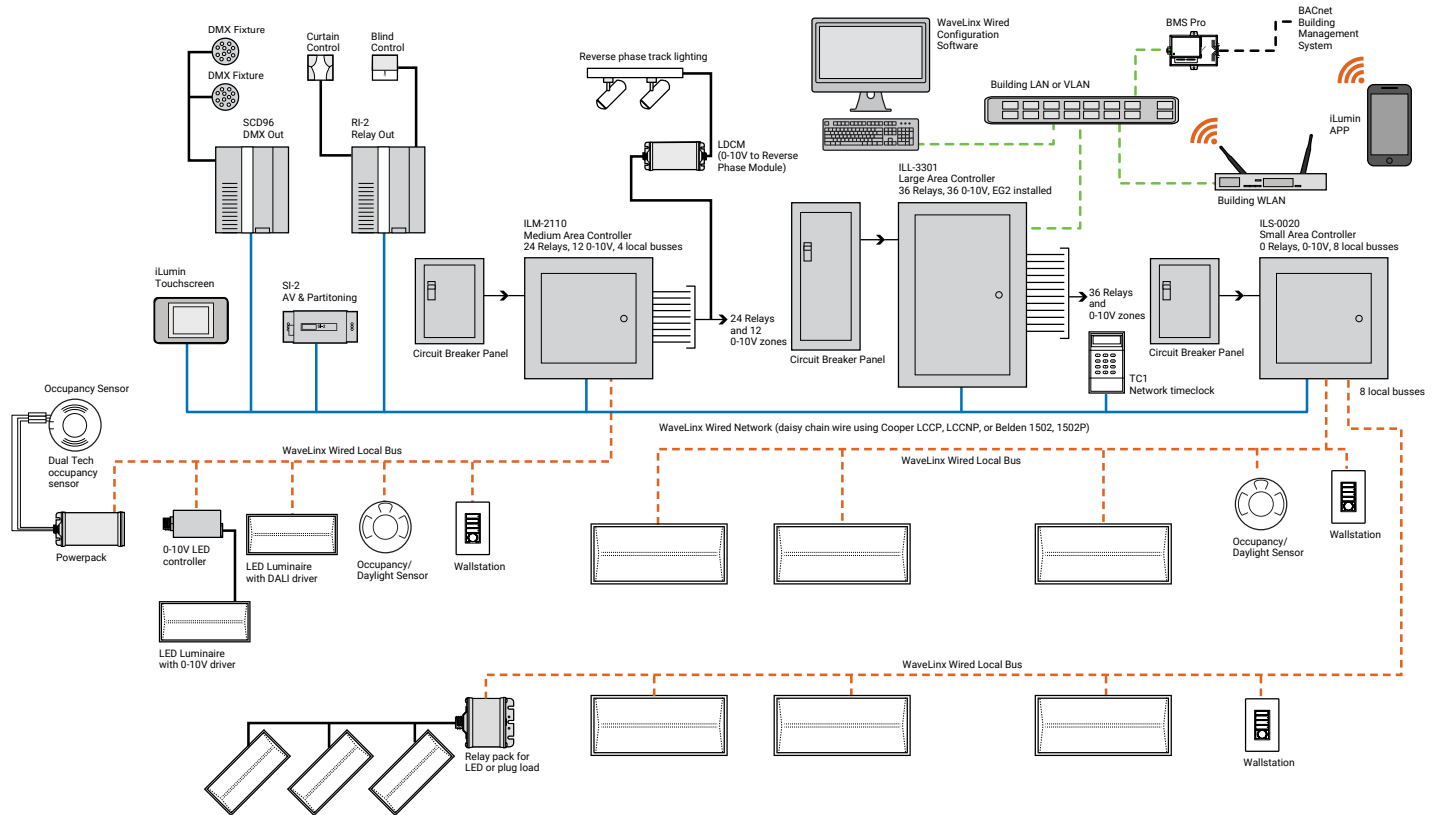

Overview

The SCMD4 provides four WaveLinx Wired local busses enabling dimming and switching of up to 256 individually addressable devices including luminaires and other WaveLinx Wired devices. WaveLinx Wired multi-sensors, wallstations and DAC's can be added to each bus creating a complete solution. Each bus supports up to 64 addresses.

The SCMD4 also features direct input capabilities from a DMX system or from the WaveLinx Wired digital network.

The SCMD4 includes dry contact inputs that can be used for emergency override or fire alarm inputs.

Sample System Topology:

This diagram shows the main components of the WaveLinx Wireless and Wired Connected Lighting system.

The **WaveLinx wireless system** communicates using wireless mesh technology based on the IEEE 802.15.4 standard. A PoE LAN connection for each Wireless Area Controller (WAC) is required for power and data access to the building lighting network.

The **WaveLinx wired system** controls the devices using relay, 0-10V, DMX and the WaveLinx wired digital local bus. The WaveLinx wired system connects to the building LAN using the EG2 module. Each WaveLinx wired area controller communicate on the WaveLinx wired network. The WaveLinx wired network supports over 60,000 devices.

The Trellix Core, WaveLinx Area Controllers (WAC) and WaveLinx Ethernet Gateways (EG2) communicate with each other over the Ethernet network.

Please refer to the WaveLinx Wireless Network and IT Guidance Technical Guide and WaveLinx Wired Network and IT Guidance Technical Guide for more information.

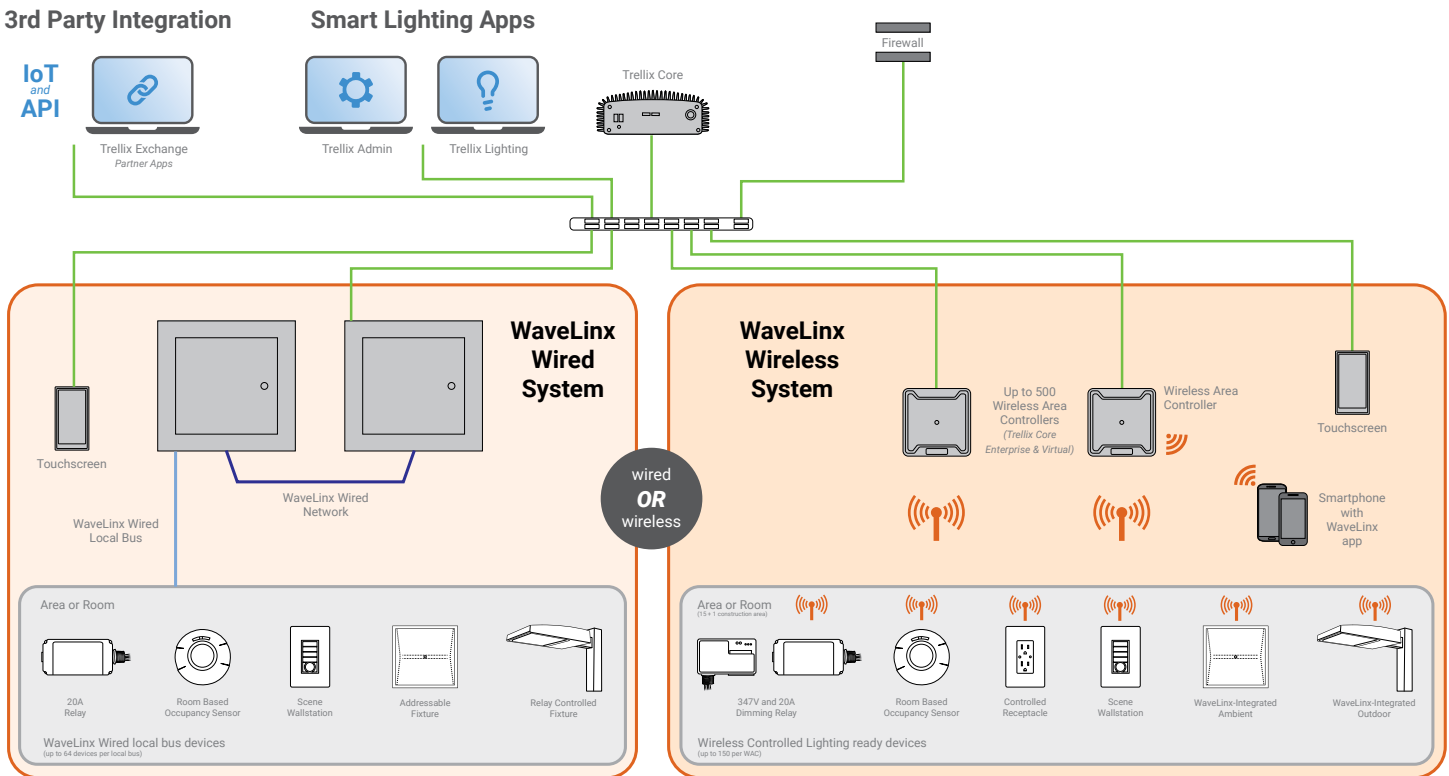
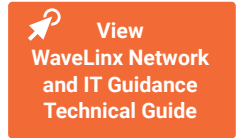

Control Systems

- Trellix
- WaveLinx Wireless
- WaveLinx Wired
- VividTune