

**DESCRIPTION**

Corelite's Iridium Perf suspended semi-indirect fluorescent luminaire features elegant styling with sleek profile and end caps. The engineered optical system provides a widespread upright distribution for excellent ceiling uniformity and wide row spacing. The perforated fixture housing creates a soft downlight component to closely match the ceiling brightness, which minimizes contrast on computer screens. Iridium may be mounted individually or continuously with 4', 8' and 12' modular sections. Luminaires align with T-Grid and interface with all ceiling types. Iridium is suited for open offices, private offices, conference rooms, corridors, schools, libraries, labs and public spaces.

**SPECIFICATION FEATURES**

**A ... Construction**

Housing is one piece die-formed cold rolled steel, forming a 9" x 2-1/2" architectural profile. Standard 4'-0", 8'-0", and 12'-0" fixture lengths combine for continuous runs.

**B ... End Caps**

Standard Straight and optional Beveled end caps are precision die-cast aluminum mechanically attached without exposed fasteners.

**C ... Reflectors**

Reflector pan is painted with a high reflectance white powder coat finish. Optional die-formed side reflectors are highly specular anodized aluminum.

**D ... Electrical**

Fixtures are prewired with quick wire connectors and use UL listed Class P, 265ma T8 instant start universal voltage electronic ballasts. Power factor of 95% with less than 10% THD. Fixtures and electrical components certified to UL and CUL standards.

**E ... Finish**

Fixture housings are standard white using electrostatically applied polyester powder coat paint.

**Mounting**

Standard aircraft cable mounts on 4'-0", 8'-0" and 12'-0" centers. Refer to installation section for various ceiling interface details and rigid pendant mounting details.

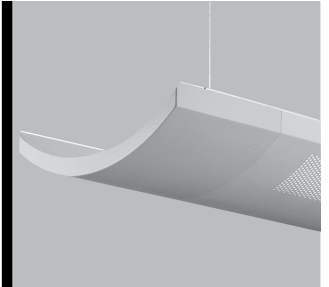

**Iridium Perf**

2T8

**Suspended  
Semi-Indirect**

**Light Distribution**  
Indirect - 92.3%  
Direct - 7.7%

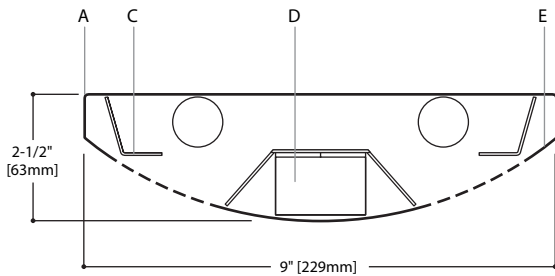

Standard Straight End Cap

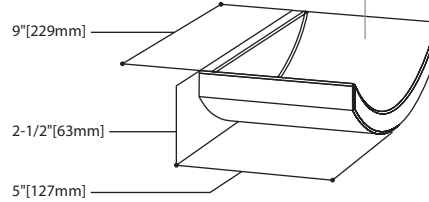

Beveled End Cap

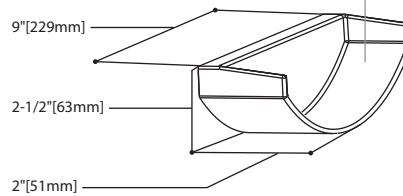

**MODULES AND DIMENSIONS\***



\*Dimensions do not include end caps.



**ORDERING INFORMATION**

Sample Number: IP-WP-2T8-1C-UNV-AC48-T1-12-ES

<b>Series</b> IP: Iridium Perf Suspended	<b>Number of Lamps</b> 2: 2 Lamps	<b>Wiring</b> <sup>1</sup> B: Battery Pack C: Standard Circuit D: Dimming E: Emergency T: Nightlight Y: Daylight	<b>Voltage</b> <sup>1</sup> 120: 120V 277: 277V 347: 347V UNV: Universal (120V-277V)	<b>Suspension</b> A: Aircraft Cable P: Rigid Pendant	<b>Suspension Length</b> <b>Fixed Cable</b> 12", 15", 18", 21", 24", or 27" (+/- 1/2" adjustment) <b>Adjustable Cable</b> 48", 120", 240", 300", or 360" (infinite adjustment along entire length of cable) <b>Rigid Pendant</b> <sup>2</sup> 12", 15", 18", 21", 24", or 27"	<b>Ceiling Type</b> T1: 1" T-Bar T9: 9/16" T-Bar TS: Slotted T-Bar ST: Structure JB: 4" Octagonal J-Box
<b>Optics Up</b> S: Specular W: White	<b>Lamp Type</b> T8: T8 Normal Output			<b>Power Feed</b> <sup>1</sup> C: Straight Cord K: Curly Cord P: Rigid Pendant		<b>Run Length</b> <b>Individually Mounted</b> Luminaires may be 4', 8', or 12' in length <b>Continuously Mounted</b> Standard row configurations over 12' consist of 8' and 12' sections
<b>Optics Down</b> P: Round Perf	<b>Number of Circuits</b> <sup>1</sup> 1: 1 Circuit 2: 2 Circuits					

Notes: 1 Not all options available. Please consult your Cooper Lighting Solutions Representative for availability. Consult adder section of the price guide for additional standard lengths.  
2

PHOTOMETRICS

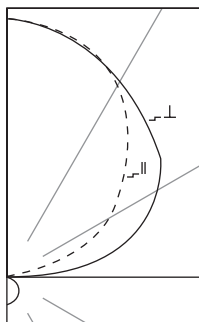

IP-WP-2T8  
(2) F32T8/TL841  
2950 Lumens  
Efficiency 84.5%

Test Report  
#LS15718

Coefficients of Utilization

rc	Effective floor cavity reflectance																							
	80%				70%				50%				30%				10%				0%			
rw	70	50	30	10	70	50	30	10	50	30	10	50	30	10	50	30	10	50	30	10	50	30	10	
RCR	0	82	82	82	82	71	71	71	71	51	51	51	32	32	32	15	15	15	07	07	07	07	07	07
	1	75	71	65	65	64	62	59	56	44	42	41	28	27	26	13	12	12	05	05	05	05	05	05
	2	68	62	57	53	58	54	50	46	38	36	34	24	23	22	11	11	10	04	04	04	04	04	04
	3	62	54	49	44	53	47	43	39	34	31	28	21	20	18	10	09	09	04	04	04	04	04	04
	4	56	48	42	37	49	42	37	33	30	27	24	19	17	16	09	08	07	03	03	03	03	03	03
	5	52	42	36	31	44	37	32	28	27	23	20	17	15	13	08	07	06	03	03	03	03	03	03
	6	47	38	31	27	41	33	28	24	24	20	18	15	13	11	07	06	06	02	02	02	02	02	02
	7	43	34	28	23	37	29	24	20	21	18	15	14	11	10	06	05	05	02	02	02	02	02	02
	8	40	30	24	20	35	26	21	18	19	16	13	12	10	09	06	05	04	02	02	02	02	02	02
	9	37	27	21	17	32	24	19	15	17	14	11	11	09	08	05	04	04	02	02	02	02	02	02
	10	34	25	19	15	30	22	17	14	16	12	10	10	08	07	05	04	03	01	01	01	01	01	01

Candela

Angle	Along	II	45°	Across	⊥
0	136	136	136	136	
5	137	135	134		
15	130	129	129		
25	117	119	119		
35	99	102	104		
45	77	81	90		
55	52	65	75		
65	26	48	63		
75	12	33	47		
85	0	17	28		
90	0	31	41		
95	51	214	231		
105	263	519	629		
115	492	695	828		
125	713	831	976		
135	908	964	1053		
145	1070	1090	1134		
155	1200	1203	1212		
165	1287	1285	1279		
175	1331	1323	1315		
180	1326	1326	1326		

Zonal Lumen Summary

Zone	Lumens	%Lamp	%Fixture
0-30	103	1.75	2.07
0-40	166	2.83	3.34
0-60	287	4.87	5.76
0-90	385	6.53	7.73
40-90	218	3.70	4.38
60-90	98	1.66	1.97
90-180	4599	77.96	92.27
0-180	4985	84.49	100.00

Luminance Data

Angle in Deg	0-Deg cd/sm	45-Deg cd/sm	90-Deg cd/sm
45	927	985	1089
55	771	964	1132
65	534	981	1213
75	383	965	1121
85	0	673	862

COMMON CURCUIT CONFIGURATIONS FOR TWO LAMP SUSPENDED FIXTURES

2C = Two circuit luminaire

2E = Two circuit luminaire with emergency circuit

1B = Single circuit luminaire with battery pack

/1/ = Circuit 1

/2/ = Circuit 2

/E/ = Emergency Circuit

/B/ = Battery Circuit

= Power Mount

= Non-Power Mount

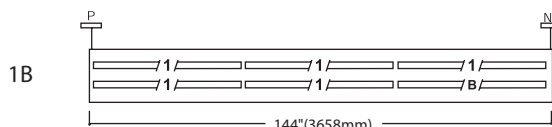
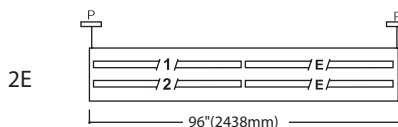
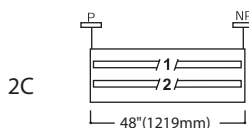

STANDARD ROW CONFIGURATIONS

FIXTURE LENGTH	4'	8'	12'	16'	20'	24'	28'	32'	36'	40'	44'	48'	52'	56'	60'	64'	68'	72'	76'	80'	84'	88'	92'	96'	100'	104'	108'	
4'	1																											
8'		1		2	1		2	1		2	1		2	1		2	1		2	1		2	1		2	1		
12'			1		1	2	1	2	3	2	3	4	3	4	5	4	5	6	5	6	7	6	7	8	7	8	9	