

DESCRIPTION

Specification grade PAR adjustable shower fixture for use with narrow joist spacing. Insulation must be kept 3" from fixture sides and top of fixture. Adjustment mechanism features hot aiming capability, aiming marks and toolless

locking. Optics provide glare free 50° cutoff to lamp and lamp image. Accommodates PAR20 and PAR16 lamps. **Optical element can be changed after installation to provide a variety of distributions. e.g into a Downlight.**

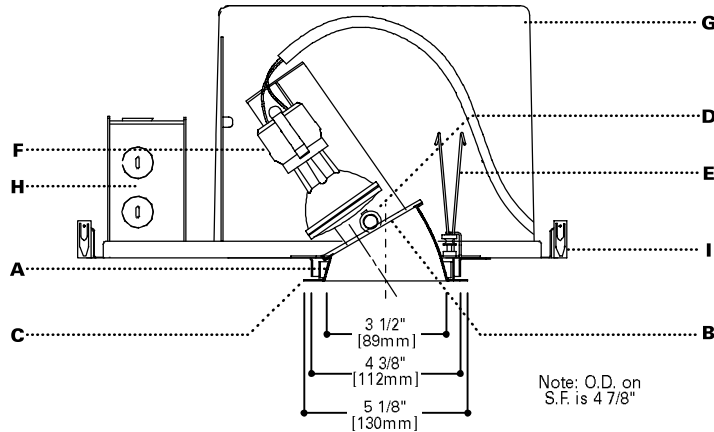

SPECIFICATION FEATURES

A...Reflector

.040 thick aluminum spun parabolic reflector in Clear, Gold, Haze, Warm Haze, Black Alzak® finish, painted gloss white or matte white. Special cone colors listed below.

B...Lens

.125 thick tempered glass protects lamps from direct spray of water and is retained during relamping.

C...Flange

Self flange reflector or die-cast flange with either matte white or clear coat finish. Die-cast flanges are easily removed for field painting. Elements are keyed for proper insertion.

D...Adjustability

Lamp locks in 361° rotation, 35° tilt. Unit is relamped without unlocking adjustments. Translating centerbeam optics maximize light output.

E...Attachment

Positive torsion springs pull flange tight to ceiling. Mechanical light trap eliminates spill light at edge of flange or reflector.

F...Socket

Nickel plated porcelain socket. Two position socket

ensures consistent lamp position.

G...Frame/Housing

Hot dipped galvanized 20 gauge steel frame with built in 1/2 inch plaster lip. Gunsights allow for consistent alignment. One piece 20 gauge steel housing for seamless construction is painted matte black for a visually dark interior.

H...Junction Box

18 cubic inches, listed for 4#12 AWG or 6#14 AWG 90° C additional feed through conductors, has five 1/2 inch pryouts.

I...Bar Hangers

No Flex® bar hangers with positive locking, for use with joists spaced up to 24" O.C. ship with platform. For use in T-bar ceilings order accessory MBCLP. Nailless barb and locator lip provide consistent installation height.

J...Codes

Thermally protected, IP labeled, Unit is airtight and exchanges less than 2.0 CFM with the plenum at a pressure of 75 pascals. Insulation must be kept three inches away from fixture sides and none on top as to entrap heat.

K...Labels

UL and cUL listed, standard wet label, IBEW union made.

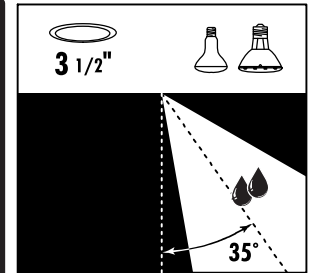

**PN3120
E3AASR**

**75 W PAR16
50 W PAR20**

**3" ADJUSTABLE
SHOWER**

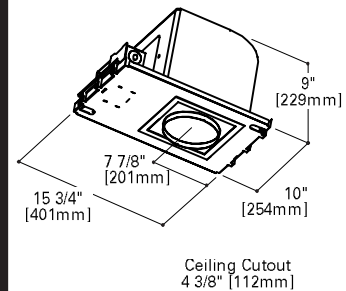

ORDERING INFORMATION

Complete unit consists of a platform and element

Platform	Optical Element	Finish	Flange	Accessories
PN3120	E3AASR			
PN3120 = 3" Non-IC Housing	E3AASR = 3" PAR Adjustable Shower Accent 0° - 35°	Standard C=Clear H=Haze G=Gold WMH=Warm Haze W=Gloss White MW= Matte White B= Black Custom K=Cognac KH=Cognac Haze CC=Chocolate	Custom Cont. CCH=Chocolate Haze BU=Blush BUH=Blush Haze GP=Graphite GPH=Graphite Haze PN=Pine PNH=Pine Haze SK=Sky SKH=Sky Haze	Blank= White die-cast SF= Self Flange RAW= Natural Die-cast SFWF= Self Flange Painted White MBCLP = 40 Push On T Bar Clips (for 10 Units) PLE3 = Plaster Lip Extension for Max 2" Thick Ceiling

PHOTOMETRICS

Lamp	Luminance cd/m ² @ Maximum Tilt			0° Aiming Angle Horizontal Footcandles					30° Aiming Angle Horizontal Footcandles					30° Aiming Angle Vertical Footcandles				
	Degree	@ 180°	@ 90°	D	FC	L	W		D	FC	L	W	CB	D	FC	L	W	CB
GE Q50PAR20/H/SP10 Beam Spread: 10° CBCP: 6000	85°	1848	1848	6'	145	2.0	1.2		6'	89	2.8	2.4	3.5	2'	176	2.2	1.3	3.5
	75°	622	622	8'	82	2.6	1.6		8'	50	3.7	3.1	4.6	3'	78	3.4	1.9	5.2
	65°	381	381	10'	52	3.3	2.0		10'	32	4.6	3.9	5.8	4'	44	4.5	2.6	6.9
	55°	281	0	12'6"	33	4.1	2.5		12'6"	20	5.8	4.9	7.2	5'	28	5.6	3.2	8.7
	45°	228	0	Test # H21293					Test # H21292					Test # H21292				

Notes and Definitions:

Luminance: To convert cd/m² to footlamberts, multiply by 0.2919

- Beam spread is to 50% center beam candlepower (CBCP)

D=Distance to floor or wall.

FC=Footcandles on floor or wall at center beam aiming location.

L=Effective Visual Beam length in feet (50% of maximum footcandle level.)

W=Effective Visual Beam width in feet (50% of maximum footcandle level.)

CB=Distance across or down to center beam location.

IRiS believes that bare lamp data photometrics vastly overstate the performance of adjustable accent fixtures. The "real world photometrics" shown here are from off the shelf lamps in fixtures and operated at 120.0 volts. Please see page 64 & 65 of the IRiS catalog for further discussion and appropriate correction multipliers.

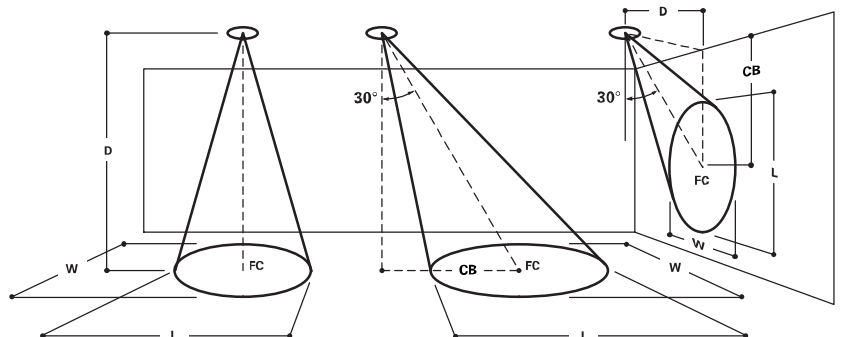

Note: Specifications and Dimensions subject to change without notice.

Visit our web site at www.cooperlighting.com