

DESCRIPTION

The next generation addition to the Iridium family, the direct-indirect i2 series, offers a generous open center aperture for maximum versatility in optics, lamping and distribution. The i2 is also available with adjustable uplight and downlight optics for evolving interior spaces with Corelite's Slide-N-Lock (TM) optics accessory. i2 may be mounted individually or continuously with 4' and 8' modular sections. Luminaires align with T-Grid and interface with all ceiling types. The i2 is ideally suited for open offices, conference rooms, classrooms, libraries, labs and public spaces.

Catalog #		Type
Project		
Comments		Date
Prepared by		

SPECIFICATION FEATURES

A ... Construction

Housing is one piece die-formed cold rolled steel, forming a 9" x 2-1/2" architectural profile. Standard 4'-0" and 8'-0" fixture lengths combine for continuous runs.

B ... End Caps

Standard Straight and optional Beveled end caps are precision die-cast aluminum mechanically attached without exposed fasteners.

C ... Louver

Semi-specular aluminum parabolic blades spaced 1-1/2" on-center with a 3-5/8" opening.

D ... Reflectors

Reflector pan is painted with a high reflectance white powder coat finish. Optional die-formed side reflectors are highly specular anodized aluminum.

E ... Electrical

T5/T5HO fixtures are pre-wired with quick wire connectors and use UL listed Class P, T5/T5HO program rapid start universal voltage electronic ballasts, power factor of 97% with less than 10% THD. Fixtures and electrical components certified to UL and CUL standards.

F ... Finish

Fixture housings are standard white using electrostatically applied polyester powder coat paint.

Mounting

Standard aircraft cable mounts on 4'-0" and 8'-0" centers. Refer to installation section for various ceiling interface details.

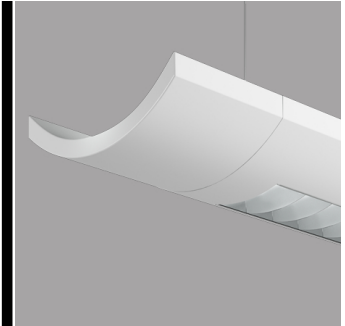

i2 Parabolic Louver

1T5
1T5HO

Suspended
Direct/Indirect

Light Distribution
Indirect - 68.1%
Direct - 31.9%



SLIDE-N-LOCK™

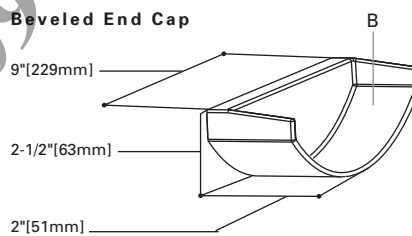
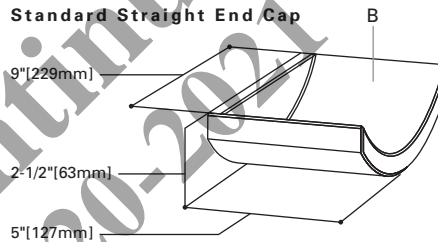
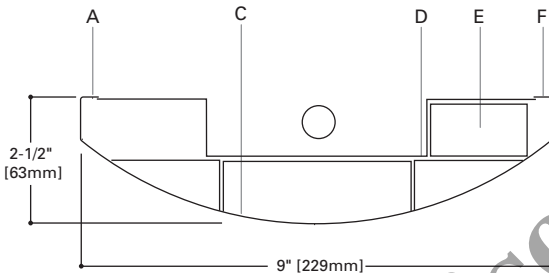

MODULES AND DIMENSIONS*

48" [1219mm]

96" [2438mm]

*Dimensions do not include end caps.

ORDERING INFORMATION

Sample Number: I2-WB-1T5-1C-UNV-AC48-T1-12-ES

Series I2: i2 Suspended	Number of Lamps 1: 1 Lamp	Wiring B: Battery Pack C: Standard Circuit D: Dimming E: Emergency T: Nightlight Y: Daylight	Voltage 120: 120V 277: 277V 347: 347V UNV: Universal (120V-277V)	Suspension A: Aircraft Cable	Ceiling Type T1: 1" T-Bar T9: 9/16" T-Bar TS: Slotted T-Bar ST: Structure JB: 4" Octagonal J-Box	Options Slide-N-Lock™ DL1 DL2 DL3 DL4 DL5 DL6 DL7 DL8
Optics Up S: Specular W: White	Lamp Type N5: T5 Normal Output T5: T5 High Output			Power Feed C: Straight Cord K: Curly Cord	Run Length Individually Mounted Luminaires may be 4' or 8' in length Continuously Mounted Standard row configurations over 8' consist of 4' and 8' sections	
Optics Down B: Parabolic Louver	Number of Circuits 1: 1 Circuit			Suspension Length Adjustable Cable 48", 120", 240", 300", or 360" (infinite adjustment along entire length of cable)		

Notes: 1 Not all options available. Please consult your Cooper Lighting Solutions Representative for availability.

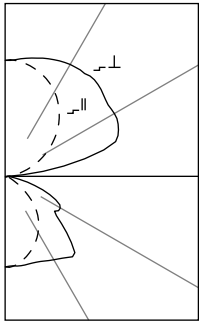

I2-WB-1T5
(1) FP54/841/HO
4500 Lumens

Efficiency 91.2%

Test Report
#LSI26345

Coefficients of Utilization

rc	Effective floor cavity reflectance																																																				
	80%				70%				50%				30%				10%				0%																																
rw	70	50	30	10	70	50	30	10	50	30	10	50	30	10	50	30	10	50	30	10	50	30	10	50	30	10	50	30	10	50	30	10	50	30	10	50	30	10	50	30	10												
RCR	0	94	94	94	94	84	84	84	84	67	67	67	67	51	51	51	51	36	36	36	36	29	29	29	29	25	25	25	25	21	21	21	21	18	18	18	18	16	16	16	16	14	14	14	14	12	12	12	12	10	10	10	10
	1	86	82	79	76	77	74	71	69	59	57	55	55	45	44	43	43	32	32	31	31	25	25	25	25	21	21	21	21	18	18	18	18	16	16	16	16	14	14	14	14	12	12	12	12	10	10	10	10				
	2	78	72	67	62	70	65	60	57	52	49	46	46	40	38	36	36	29	27	26	26	21	21	21	21	18	18	18	18	16	16	16	16	14	14	14	14	12	12	12	12	10	10	10	10								
	3	71	63	57	52	64	57	52	47	46	42	39	39	35	33	30	30	25	24	22	22	18	18	18	18	16	16	16	16	14	14	14	14	12	12	12	12	10	10	10	10	8	8	8	8								
	4	65	56	49	44	58	51	45	40	41	36	33	33	31	28	26	26	23	21	19	19	16	16	16	16	14	14	14	14	12	12	12	12	10	10	10	10	8	8	8	8												
	5	60	50	42	37	54	45	39	34	36	32	28	28	28	25	22	22	20	18	17	17	16	16	16	16	14	14	14	14	12	12	12	12	10	10	10	10	8	8	8	8												
	6	55	44	37	32	49	40	34	30	32	28	25	25	22	20	18	18	16	15	14	14	12	12	12	12	10	10	10	10	8	8	8	8	6	6	6	6	4	4	4	4												
	7	51	40	33	28	45	36	30	26	29	25	21	21	23	20	17	17	15	13	12	12	10	10	10	10	8	8	8	8	6	6	6	6	4	4	4	4	2	2	2	2												
	8	47	36	29	25	42	33	27	23	27	22	19	19	21	18	15	15	13	12	11	11	9	9	9	9	7	7	7	7	5	5	5	5	3	3	3	3	1	1	1	1												
	9	44	33	26	22	39	30	24	20	24	20	17	17	19	16	14	14	12	11	10	10	8	8	8	8	6	6	6	6	4	4	4	4	2	2	2	2	0	0	0	0												
	10	41	30	24	19	37	27	22	18	22	18	15	15	18	14	12	12	13	11	9	9	8	8	8	8	6	6	6	6	4	4	4	4	2	2	2	2	0	0	0	0												

Candela

Angle	Along II	45°	Across I
0	475	475	475
5	475	474	472
15	436	457	477
25	380	424	491
35	309	401	525
45	219	381	494
55	109	265	319
65	38	96	295
75	15	26	122
85	5	5	14
90	0	2	1
95	28	111	95
105	96	451	537
115	196	503	656
125	299	551	661
135	397	595	689
145	481	617	688
155	547	632	675
165	592	628	649
175	616	618	620
180	615	615	615

Zonal Lumen Summary

Zone	Lumens	%Lamp	%Fixture
0-30	373	8.3	9.1
0-40	630	14.0	15.3
0-60	1124	25.0	27.4
0-90	1309	29.1	31.9
40-90	679	15.1	16.6
60-90	185	4.1	4.5
90-180	2794	62.1	28.1
0-180	4103	91.2	100.0

Luminance Data

Angle in Deg	0-Deg cd/sm	45-Deg cd/sm	90-Deg cd/sm
45	2925	5098	6605
55	1793	4360	5250
65	843	2143	6587
75	548	960	4456
85	531	510	1518

COMMON CIRCUIT CONFIGURATIONS FOR ONE LAMP SUSPENDED FIXTURES

- 1C=Single circuit luminaire
- 1E=Single circuit luminaire with emergency circuit
- 1B=Single circuit luminaire with battery pack

/1/ =Circuit 1
/E/ =Emergency Circuit
/B/ =Battery Circuit

