

## Installation Instructions - Hugo Suspended LED

### WARNING

**Risk of Fire, Electrical Shock, Cuts and or other cwasualty hazards. This product must be installed in accordance with the applicable installation code by a qualified electrician or a person familiar with the construction and operation of the product and the hazards involved. Cooper Lighting Solutions assumes no responsibility for claims brought about by improper or careless installation or handling of this product.**

### WARNING

**Risk of Fire and Electric Shock. If not qualified, consult an electrician.**

### CAUTION

Edges May Cut. Handle with care.

### CAUTION

Risk of Burn. Disconnect power and allow fixture to cool before changing bulb or handling fixture.

**Notice:** Green ground screw provided in proper location. Do not relocate.

**Notice:** Minimum 90° supply conductors.

**Note:** Specifications and dimensions subject to change without notice.

**IMPORTANT:** Read carefully before installing Fixture. Retain for future reference.

**ATTENTION Receiving Department:** Note actual fixture description of any shortage or noticeable damage on delivery receipt. File claim for common carrier (LTL) directly with carrier. Claims for concealed damage must be filed within 15 days of delivery. All damaged material, complete with original packing must be retained.

## Mount Spacing

Aircraft cables sit .375" From the end of the Fixture.

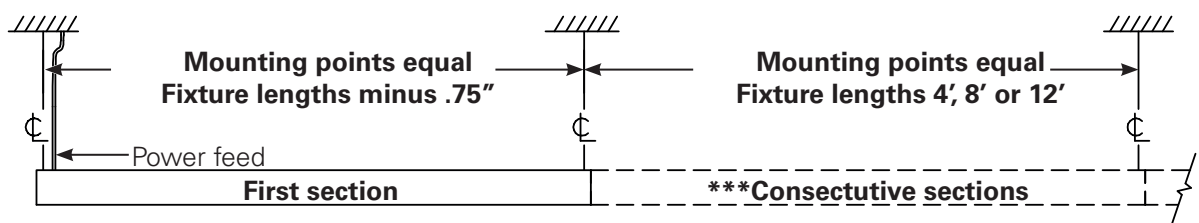

For installation at ceiling, see separate ceiling interface instructions.

## Install Aircraft Cable at Fixture

### CAUTION

If cutting aircraft cable, ensure that at least 3 inches of additional length is exiting the cable adjuster. Aircraft cable may fray and decrease cable strength.

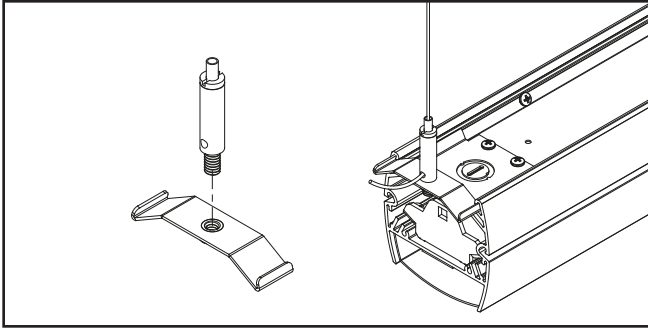

### Power Drops

1. Break off appropriate Knock Out. Either 5/8" or 7/8" KO.
2. Remove access plate.
3. Feed power drop cord through KO, then secure power cord with strain relief.
4. Make electrical connections.

**Note:** If end of run, see End Cap installation section prior to re-installing access plate.

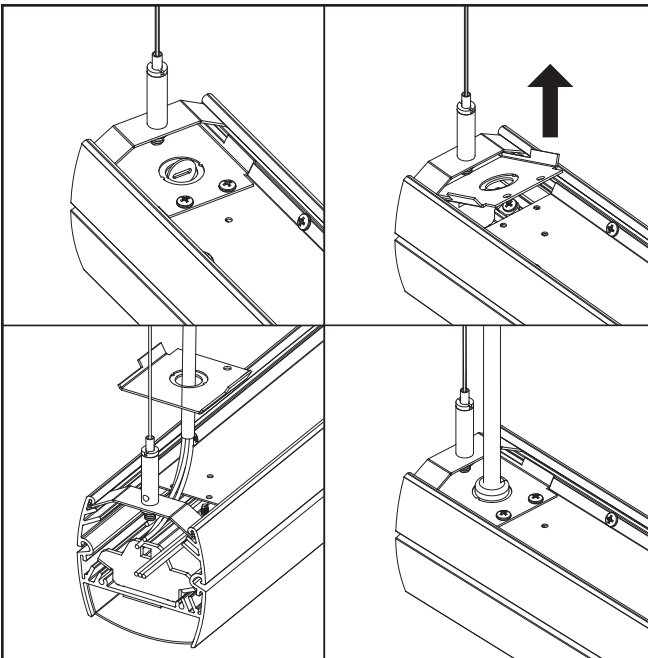

### Joining

1. Install first fixture (A) with two AC cable assemblies, then each additional fixture (B) with one additional cable at the opposite end of the joint.

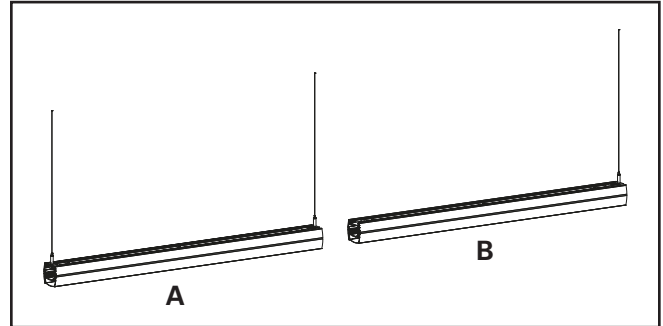

2. Remove access plates on both fixtures.
3. Install two biscuits, tap with hammer until biscuits fully engage.

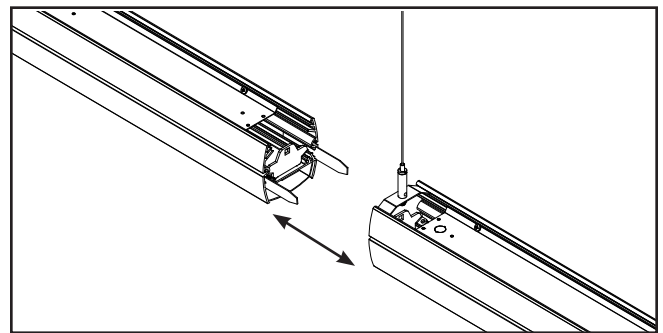

4. Slide both fixtures together.
5. Secure fixtures using 1/4-20 x 1" Carriage Bolt and 1/4-20 Keps Nut. Tighten using 7/16" wrench.

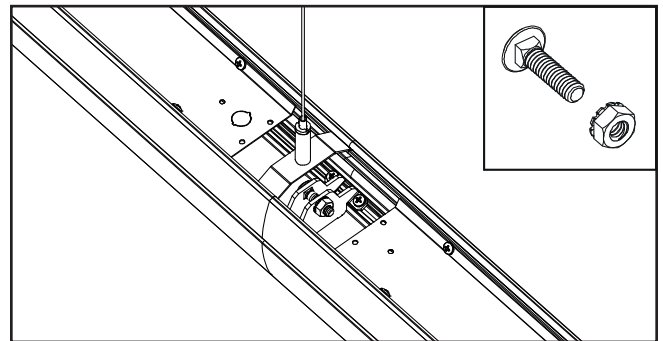

6. Make electrical connections at joint. Tuck wires into fixture.
7. Re-install access plates.

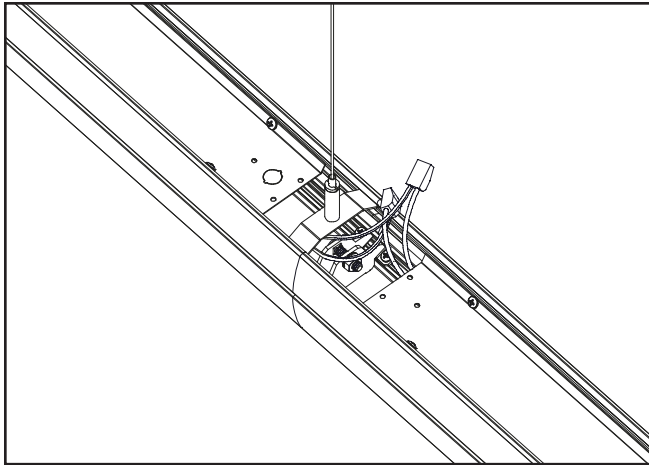

8. At lens joint, install lens cover.
9. Repeat for all joints.

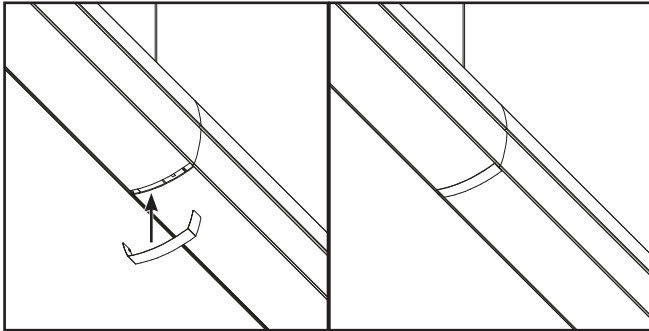

### End Cap

1. Remove access plate.
2. Position end cap onto end of fixture and secure with two 8-32 x 1/2" self-tapping screws.
3. Slide decorative cover into end cap. Tighten using one 8-32 nut.
4. Re-install access plate.

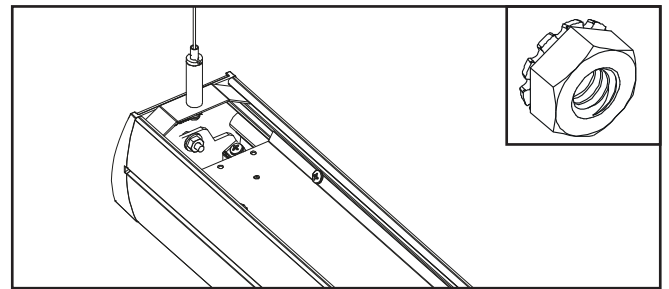
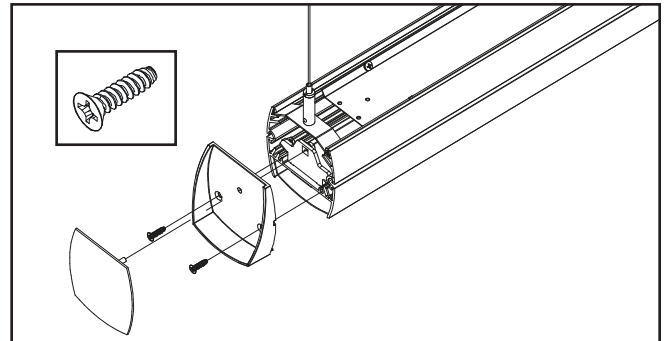

## Warranties and Limitation of Liability

Please refer to [www.cooperlighting.com](http://www.cooperlighting.com) for our terms and conditions.

## Garanties et limitation de responsabilité

Veuillez consulter le site [www.cooperlighting.com](http://www.cooperlighting.com) pour obtenir les conditions générales.

## Garantías y Limitación de Responsabilidad

Visite [www.cooperlighting.com](http://www.cooperlighting.com) para conocer nuestros términos y condiciones.

**Cooper Lighting Solutions**  
1121 Highway 74 South  
Peachtree City, GA 30269  
P:770-486-4800  
[www.cooperlighting.com](http://www.cooperlighting.com)

© 2020 Cooper Lighting Solutions  
All Rights Reserved  
Printed in USA  
Imprimé aux États-Unis  
Impreso en los EE. UU.  
Publication No. IB506002EN  
November 8, 2017

Cooper Lighting Solutions is a registered trademark.  
All trademarks are property of their respective owners.

Cooper Lighting Solutions est une marque de commerce déposée. Toutes les autres marques de commerce sont la propriété de leur propriétaire respectif.

Cooper Lighting Solutions es una marca comercial registrada. Todas las marcas comerciales son propiedad de sus respectivos propietarios.

Product availability, specifications, and compliances are subject to change without notice.

La disponibilité du produit, les spécifications et les conformités peuvent être modifiées sans préavis.

La disponibilidad de productos, las especificaciones y los cumplimientos están sujetos a cambio sin previo aviso.