

## DESCRIPTION

The Accord™ redefines fluorescent lighting by improving on aesthetics, comfort and energy savings. The Accord™ provides the right amount of light while eliminating surface shadows commonly found in parabolics. Therefore, Accord™ increases the comfort level while providing significant energy savings.

The Accord™ is the ideal solution for offices, schools, hospitals, retail and other applications.

Catalog #		Type
Project		
Comments		Date
Prepared by		

## SPECIFICATION FEATURES

### Construction

Shallow 3-1/4" deep housing is die formed of code gauge, prime cold rolled steel. Heavy gauge end plates are securely attached with screws for strength and rigidity and the elimination of gaps. Four auxiliary fixture end suspension points are provided. KOs for continuous row wiring. Large access plate for supply connection.

### Electrical\*

Ballasts are Class "P" and are positively secured. Rotor-lock lampholders ensure positive lamp retention. UL/CUL listed. Suitable for damp locations.

### Ballast Access

Ballast can be removed from below without tools.

### Finish

Durable cold rolled steel with multistage, iron phosphate pretreatment and white enamel finish to ensure maximum bonding and rust inhibition.

### Reflectors

Reflector has high reflectance baked matte white enamel finish for luminous uniformity.

### Shielding

Positively retained frosted acrylic profile lenses provide a soft but effective distribution of light.

### Air Return

Optional Air Return model provides air flow through air slots in the housing.

### Controls

Fifth Light ballast options are offered for both 0-10V continuous dimming and DALI applications. Combine with energy saving products like occupancy sensors, daylighting controls, and lighting relay panels from Cooper Lighting Solutions ([www.cooperlighting.com](http://www.cooperlighting.com)) to maximize energy savings.



**2AC  
217T8**

**2' X 2' RECESSED  
T8 LAMPS**

Troffer Series

*accord*  
Enhanced Lighting Series

powered by  
**fifthlight**  
technology

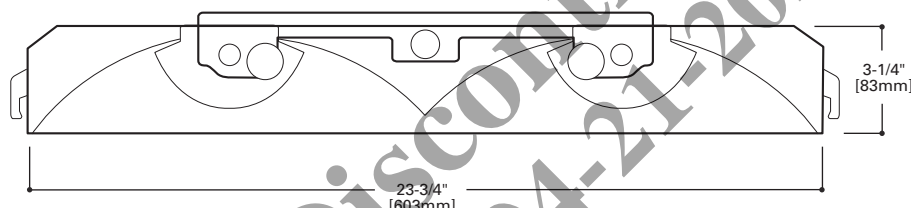

## MOUNTING DATA

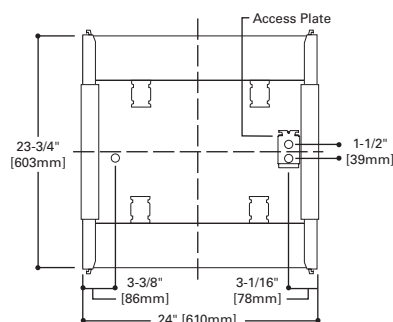

**NOTE:** 2' x 2' and 2' x 4' allow for row mounting  
(1' x 4' does not support feature)

## LAMP CONFIGURATIONS

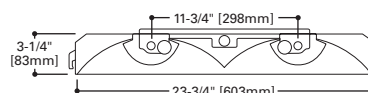

## ENERGY DATA

Input Watts:

**EB Ballast & STD Lamps @ 277V**  
217T8 (30)

Luminaire Efficacy Rating  
**LER = FL69 LPW**  
**Catalog Number: 2AC-217**

**Yearly Cost of 1000 lumens,**  
**3000 hrs at .08 KWH = \$3.47**

\*Reference the lamp/ballast data in the  
Technical Section for specific lamp/  
ballast requirements.

\*\*Consult Pre Sales Technical Support.

\*\*\*See Drywall Frame Kit Accessory

## CEILING COMPATIBILITY

G Grid/Lay-in Standard	F Drywall Frame Kit	Ceiling Type**	Trim Type
		Exposed Grid	G
		Concealed T	G or T
		Slot Grid	G or T
		Flange	***

**LAMPS CONTAIN MERCURY. DISPOSE ACCORDING  
TO LOCAL, STATE OR FEDERAL LAWS**

**LINEAR DISCONNECT**

Safe and convenient means of  
disconnecting power.



ADF080358  
June 18, 2018 2:06 PM

## PHOTOMETRICS

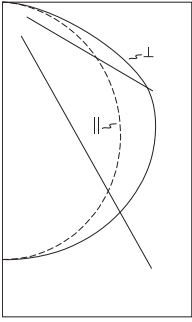
**2AC-217**

Electronic Ballast

(2) F17T8/TL841 lamps  
1400 lumensSpacing criterion:  
(||) 1.2 x mounting  
height, (⊥) 1.4 x  
mounting height

Efficiency 84.3%

Test Report:

2AC-217.IES

LER = FL-69 LPW

Yearly Cost of 1000  
lumens, 3000 hrs at  
.08 KWH = \$3.47**Candela**

Angle	Along	45°	Across ⊥
0	737	737	737
5	735	735	737
10	724	729	735
15	707	719	729
20	682	703	720
25	652	683	707
30	616	658	690
35	574	628	669
40	527	594	643
45	476	555	613
50	422	511	576
55	366	462	533
60	308	408	475
65	248	349	380
70	188	274	266
75	129	181	169
80	76	99	92
85	32	34	33
90	0	0	0

**Coefficients of Utilization**

Effective floor cavity reflectance												20%											
rc	80%				70%				50%				30%				10%				0%		
rw	70	50	30	10	70	50	30	10	50	30	10	50	30	10	50	30	10	0					
RCR																							
0	100	100	100	100	98	98	98	98	94	94	94	90	90	90	86	86	86	84					
1	91	87	84	80	89	85	82	79	82	79	76	78	76	74	75	73	72	70					
2	83	76	70	65	80	74	68	64	71	66	62	68	64	61	66	62	59	58					
3	75	66	59	53	73	65	58	53	62	56	52	60	55	51	57	53	50	48					
4	69	58	50	45	67	57	50	44	55	49	44	53	47	43	51	46	42	41					
5	63	52	44	38	61	51	43	38	49	42	37	47	41	37	46	41	37	35					
6	58	46	38	33	56	46	38	33	44	37	33	43	37	32	41	36	32	30					
7	54	42	34	29	52	41	34	29	40	33	29	39	33	28	37	32	28	26					
8	50	38	31	26	48	38	30	26	36	30	25	35	30	25	34	29	25	23					
9	46	35	28	23	45	34	28	23	33	27	23	32	27	23	32	26	23	21					
10	44	32	25	21	42	32	25	21	31	25	21	30	24	21	29	24	21	19					

**Zonal Lumen Summary**

Zone	Lumens	%Lamp	%Fixture
0-30	588	21.0	24.9
0-40	979	35.0	41.5
0-60	1813	64.7	76.8
0-90	2360	84.3	100.0
0-180	2360	84.3	100.0

**Luminance Data**

Angle in Deg	Average 0-Deg cd/sm	Average 45-Deg cd/sm	Average 90-Deg cd/sm
45	1830	2134	2357
55	1735	2190	2526
65	1595	2245	2444
75	1355	1901	1775
85	998	1060	1029

ORDERING INFORMATION

SAMPLE NUMBER: 2AC-217-UNV-EB82-U

<b>Rating</b> <b>Blank</b> = Standard <b>NY</b> =New York Rated <b>ATW-SW4</b> = Chicago Rated	<b>Number of Lamps</b> (Not included) <b>2</b> =2 Lamp	<b>Shielding</b> <b>Blank</b> =Frosted Acrylic <b>SQP</b> =Lens with Square Pattern Insert <b>RDP</b> =Lens with Round Pattern Insert	<b>Lamps</b> <b>L8835</b> =T8 Lamp, 17W and 32W, 3500K <b>L8841</b> =T8 Lamp, 17W and 32W, 4100K	<b>Ballast Type</b> <b>EB8</b> _ =T8 Electronic Instant Start. Total Harmonic Distortion < 10% <b>EB8</b> _ / <b>PLUS</b> =T8 Electronic Instant Start. High Ballast Factor >1.13. Total Harmonic Distortion < 20% <b>ER8</b> _ =T8 Electronic Program Rapid Start. Total Harmonic Distortion < 10% <b>High Performance T8 Ballasts</b> <b>HB8</b> _L=T8 Electronic Instant Start. Low Ballast Factor .77 <b>HB8</b> _ =T8 Electronic Instant Start. Ballast Factor .88 <b>HB8</b> _N=T8 Electronic Instant Start. Normal Ballast Factor 1.0 <b>HB8</b> _H=T8 Electronic Instant Start. High Ballast Factor 1.15-1.2 <b>HR8</b> _DIM=T8 Electronic Program Start Step Dimming. Ballast Factor .88 <b>HR8</b> _L=T8 Electronic Program Start. Low Ballast Factor .77 <b>HR8</b> _ =T8 Electronic Program Start. Ballast Factor .88 <b>HR8</b> _H=T8 Electronic Program Start. High Ballast Factor 1.15-1.2 <b>0-10V Dimming Ballasts</b> <sup>(3)</sup> <b>5LTV8</b> =T8 0-10V Program Rapid Start. Total Harmonic Distortion < 10%. Ballast Factor 0.87 <b>5LTVS8</b> =T8 0-10V Spec Grade Program Rapid Start. Total Harmonic Distortion < 10%. Ballast Factor 0.87 <sup>(4)</sup> <b>Fifth Light DALI Ballasts</b> <sup>(2)</sup> <b>5LT8</b> _ =T8 DALI Program Rapid Start. Total Harmonic Distortion < 10%. Ballast Factor 1.0	<b>Packaging</b> <b>U</b> =Unit Pack <b>PALC</b> =Job Pack, in carton
<b>Width</b> <b>2</b> =2' Width	<b>Wattage (Length)</b> <b>17</b> =17W T8 (24")	<b>Voltage</b> <sup>(1)</sup> <b>UNV</b> =Universal Voltage 120-277			
<b>Series</b> <b>AC</b> =Accord Series		<b>Options</b> <b>GL</b> =Single Element Fuse <b>GM</b> =Double Element Fuse <b>Flex</b> =Flex installed			
<b>Type</b> <b>A</b> =Air (optional)					
				<b>Number of Ballasts</b> <b>1</b> =1 Ballast <b>2</b> =2 Ballasts	

**NOTES:** <sup>(1)</sup> Products also available in non-US voltages and frequencies for international markets. <sup>(2)</sup> For a complete listing of Fifthlight Technology products and other solutions from Cooper Lighting Solutions, visit [www.cooperlighting.com](http://www.cooperlighting.com). <sup>(3)</sup> 0-10V ballast do not include DALI feature. Please select DALI ballast for use with Fifth Light system. <sup>(4)</sup> Specification grade 0-10V dimming ballast are NEMA premium and CEE listed. They are compatible with low mercury and energy saving lamps.

Specifications & dimensions subject to change without notice. Consult your Cooper Lighting Solutions Representative for availability and ordering information.

ACCESSORIES

T3A END E.Q. BRACKET PARTS BAG

SHIPPING DATA

Catalog No.	Wt.
2AC-217	28 lbs.