

Project		Catalog #		Type	
Prepared by		Notes		Date	



WaveLinx Wired

ADMX – ArchiDMX

Self-contained wallbox DMX controller

Typical Applications

Office • Education • Healthcare • Hospitality • Retail

Interactive Menu

- Order Information [page 2](#)
- Additional Resources [page 3](#)
- Wiring Diagrams [page 4](#)
- Connected Systems [page 5](#)
- Product Warranty

Product Certification



Product Features



Top Product Features

- Completely self contained device that can control virtually any standard DMX device such as RGB fixtures, moving lights, dimmers, and effects
- Preset, scene, and show playback features as well as wireless networking and IR remote control options
- Can be programmed by either the ArchiDMX Studio Software or IR Remote
- Utilizes the 2.4GHz wireless option further expedites commissioning as well as allows for linking of multiple stations
- Suitable for standard single and multi-gang NEMA wall box with decorator style wallplate

Dimensional and Mounting Details

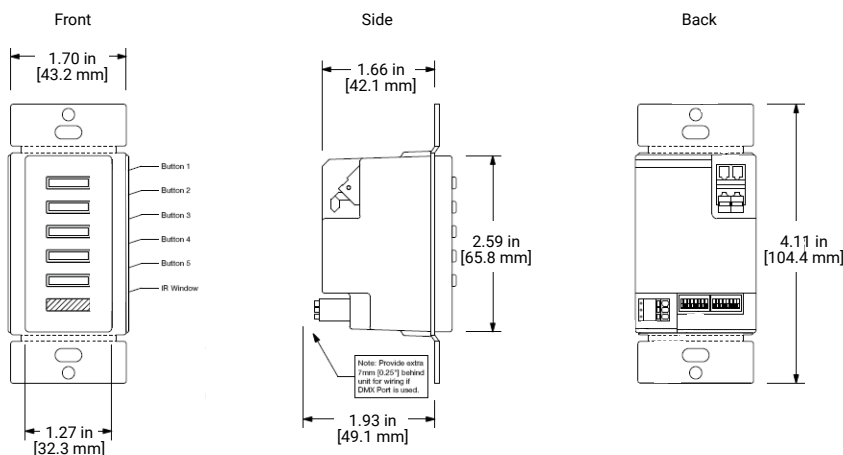

Mounting Height

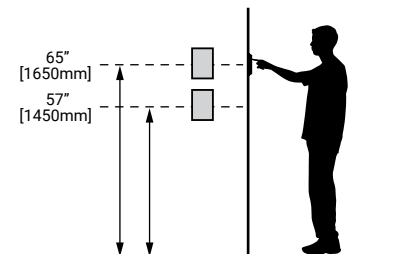

Order Information

Catalog Number

Catalog Number	Description
ADMX-305-W	Self-Contained, Wireless DMX Control Device - White
ADMX-305-B	Self-Contained, Wireless DMX Control Device - Black
ADMX-305-V	Self-Contained, Wireless DMX Control Device - Ivory
ADMX-315	Portable ArchiDMX Demo Kit
ADMX-IR33	33 Button DMX Programmer Remote
ADMX-USB-STICK	DMX USB Stick
ADMX-12P	DMX 12 VDC Power Supply w/ Pigtails

Product Specifications

Key Features

- Control virtually any standard DMX device
- Individual buttons have RGB backlight indicator lights
- Buttons give strong tactile feedback
- Individual buttons can be configured to perform a variety of functions
- Flash memory for future proof upgradeability
- Variable fade times programmable from .01 seconds to 24 hours
- Built-in infrared receiver with learnable remote codes
- Network Communication via DMX

Mechanical

Size: 1.7" x 4.11" x 1.66" (43.2mm x 104.4mm x 42.1mm)

Environment:

- **Operating temperature:** 32°F to 104°F (0°C to +40°C)
- **Relative humidity operating:** 0% - 95% non-condensing
- For indoor use only

Mounting: Suitable for standard single and multi-gang NEMA wall box with decorator style wallplate

Housing: All plastic construction

Buttons: Buttons available with standard or custom engraving

Electrical

- Electrical Supply: 12 Vdc via power supply
- Built-in infrared receiver with learnable remote codes

Software Specifications

Programming:

- Using the remote or ArchiDMX Studio Software each button can be individually configured to perform a variety of functions
- Variable fade times programmable from .01 seconds to 24 hours per button

Memory: Flash memory for future proof upgradeability

Communication Interface: Network Communication via DMX

Standards/Ratings

- cULus Listed

Warranty

Consult website for warranty information

Button Functionality

Using the infrared remote or ArchiDMX Studio Software each button can be configured to perform the following functions:

- 64 Presets of 512 Channels
- Activate
- Toggle
- Step
- Chase
- Momentary
- Effects

Individual buttons have RGB backlight indicator lights and strong tactile feedback.

The ArchiDMX requires a method of programming. Wireless stations may be programmed by the IR Remote or through the Wireless USB adapter using the free ArchiDMX Studio Software. Stations without wireless capability must be programmed with the IR Remote. When ordering ADMX stations, make certain to select a programming method.

Wiring Diagrams

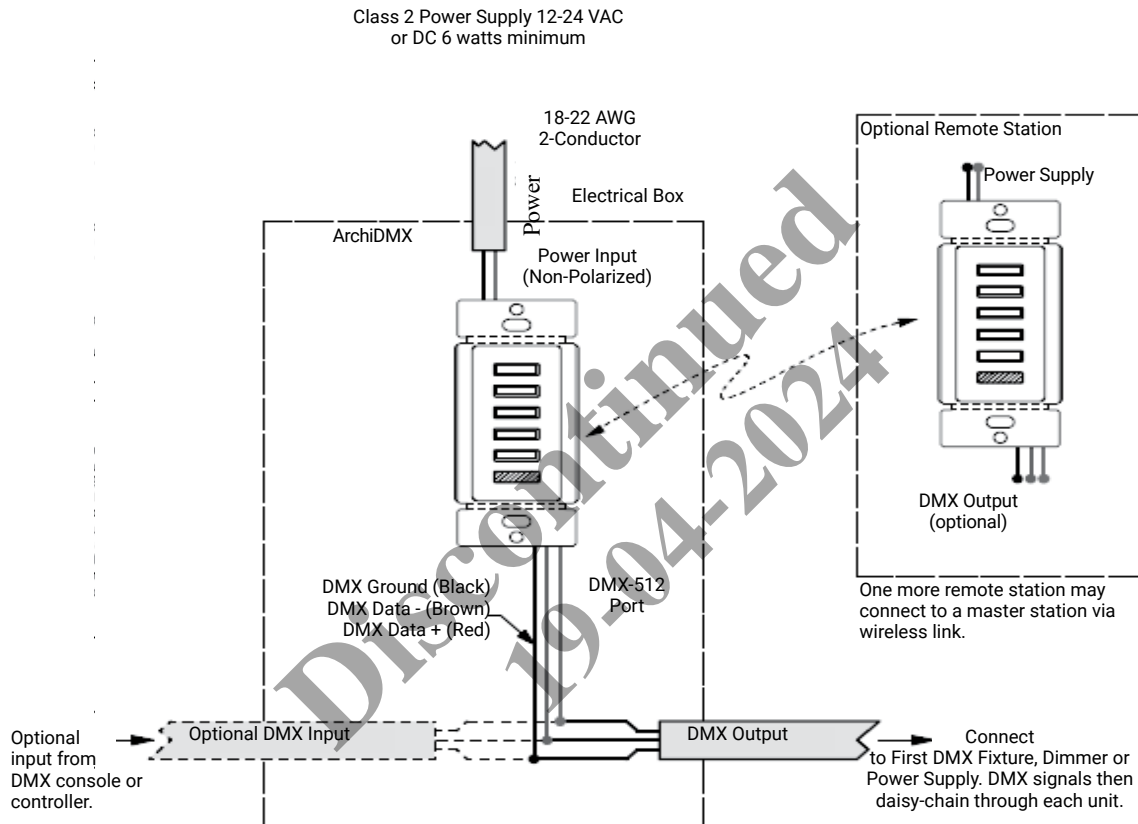

Sample System Topology

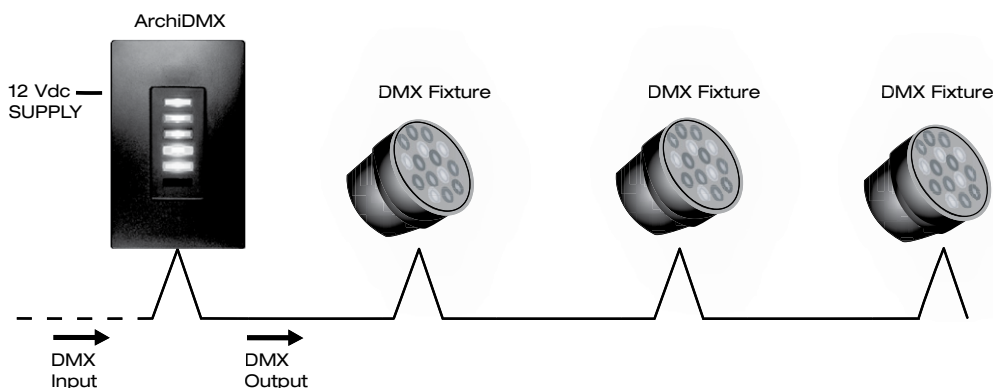

System architecture

Simple WaveLinx wired system

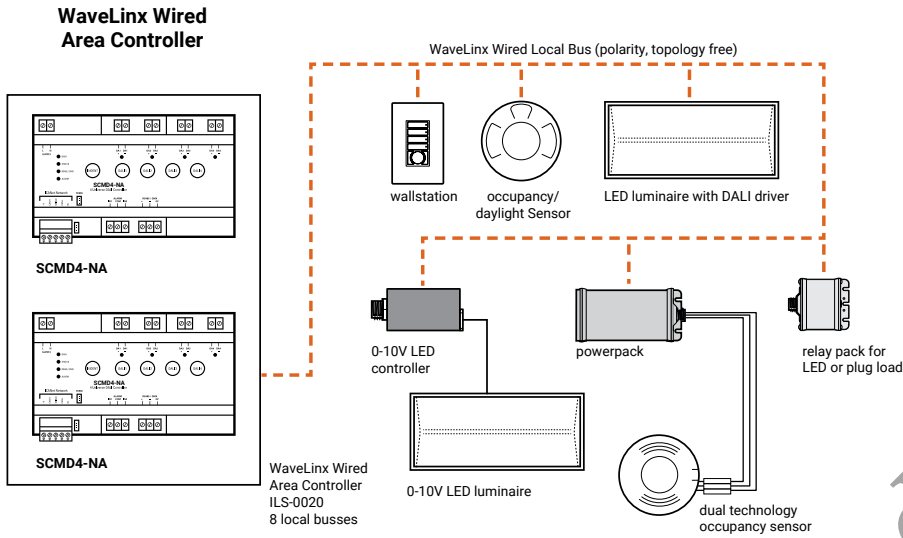

Complete WaveLinx wired system

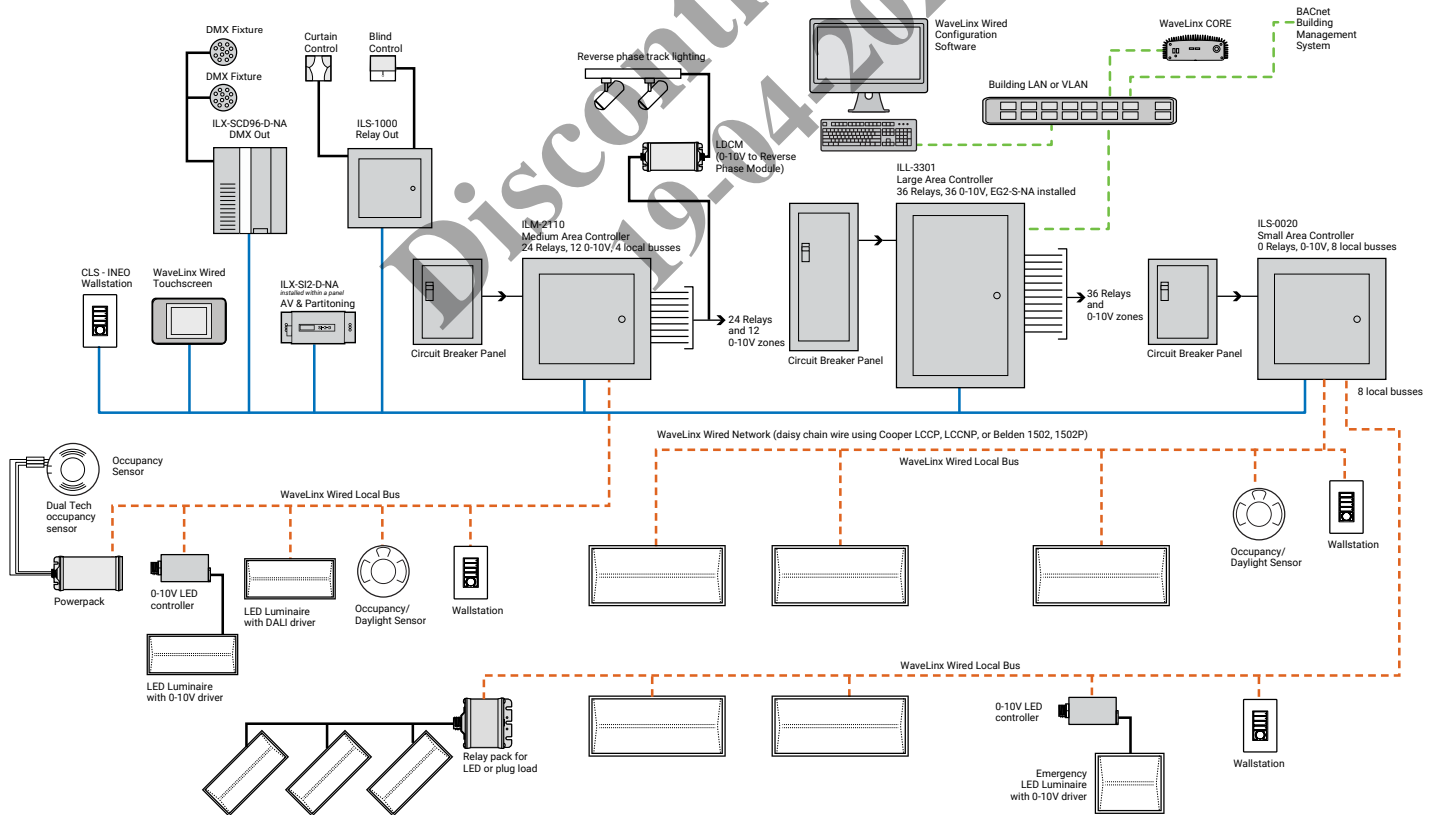

Sample System Topology:

This diagram shows the main components of the WaveLinX wired and PRO wireless connected lighting system.

The **WaveLinX PRO wireless system** communicates using wireless mesh technology based on the IEEE 802.15.4 standard. A PoE LAN connection for each WaveLinX Area Controller (WAC) is required for power and data access to the building lighting network.

The **WaveLinX wired system** controls the devices using relay, 0-10V, DMX and the WaveLinX wired digital local bus. The WaveLinX wired system connects to the building LAN using the EG2 module. Each WaveLinX wired area controller communicates on the WaveLinX wired network.

WaveLinX Area Controllers (WAC) and WaveLinX Ethernet Gateways (EG2) communicate with WaveLinX CORE over the Ethernet network.

Please refer to the WaveLinX PRO Wireless Network and IT Guidance Technical Guide and WaveLinX Wired Network and IT Guidance Technical Guide for more information.

[View WaveLinX Network and IT Guidance Technical Guide](#)

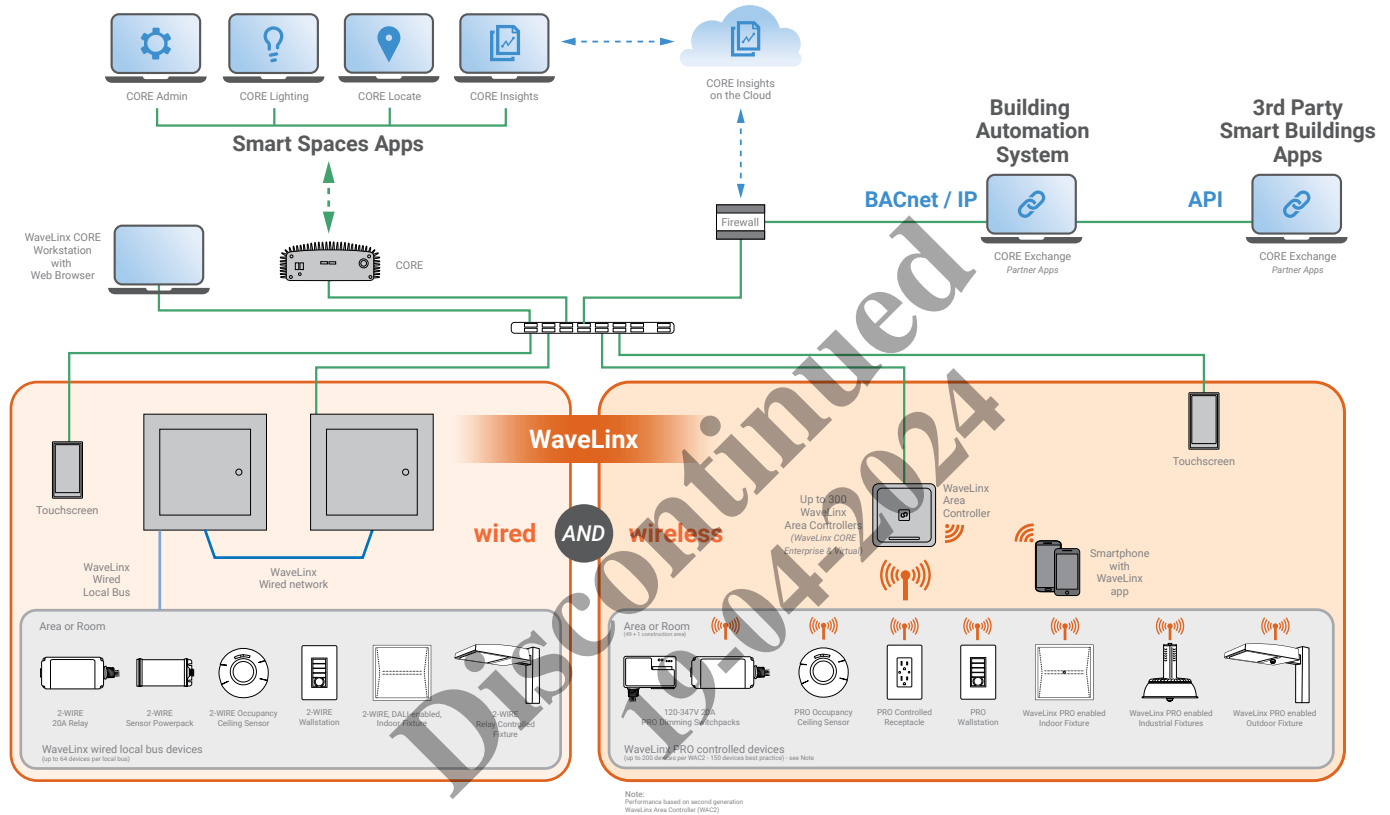

- ### Control Systems
- WaveLinX
 - WaveLinX wired
 - VividTune