

COOPER LIGHTING SOLUTIONS - METALUX®

DESCRIPTION

The Ovation Series is a complete family of recessed direct/indirect luminaires featuring pleasant modern architectural styling, computer-designed optics and the latest energy efficient lamp and ballast technology. The luminaire combines a matte white indirect reflector and a frosted white acrylic lamp shield. All components are located above the ceiling plane for a clean architectural appearance in the finished space. The 2RDI-IC is designed for installations when the housing will be in direct contact with insulation. Carefully balanced design elements combine to provide an efficient and exciting alternative to traditional general lighting. Ovation is an excellent choice for a wide variety of commercial applications.

Catalog #		Type
Project		
Comments		Date
Prepared by		

SPECIFICATION FEATURES

Construction

Nominal 6" deep housing is die formed of code gauge, prime cold rolled steel. Heavy gauge end plates are securely attached with screws for strength and rigidity and the elimination of gaps. Four auxiliary fixture end suspension points are provided. KOs for continuous row wiring. Large access plate for supply connection.

Electrical*

Ballasts are CBM/ETL Class "P" and are positively secured. Biax models use 2G11 base lampholders with double edge wiping action pressure lock contacts and vertically oriented lamp support clips. UL/CUL listed for Type IC Recessed Luminaire (Rated for direct contact with insulation). Suitable for damp locations.

Ballast Access

Ballast can be removed from below without tools or from above using the unique ballast mounting/access plate.

Finish

Durable cold rolled steel with multistage, iron phosphate pretreatment and white enamel finish to ensure maximum bonding and rust inhibition

Reflectors

Indirect reflector has high reflectance baked matte white enamel finish for luminous uniformity. Positively retained direct lamp shield constructed of frosted white acrylic with linear refractors.

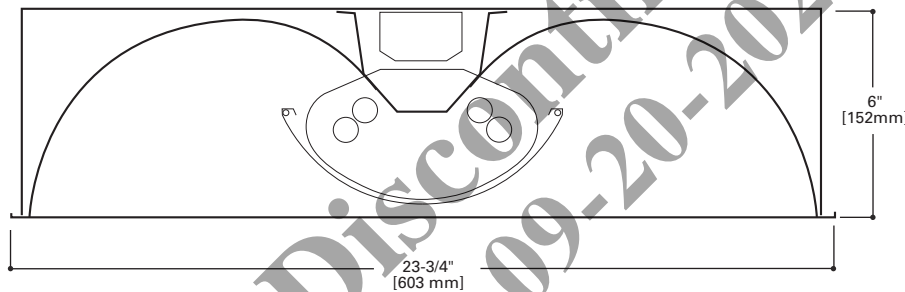

2RDI-IC T1BX40 T2BX40

BIAXIAL LAMPS

2' X 4' Recessed
Direct/Indirect
Center-Mount
Frosted Acrylic Basket
For Use in
Insulated Ceilings.

Ovation™

powered by
fifthlight
technology

MOUNTING DATA

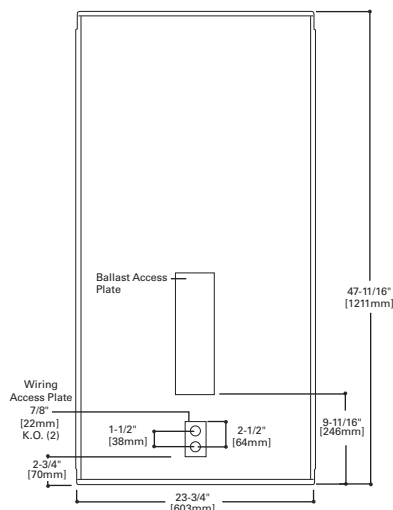

LAMP CONFIGURATIONS

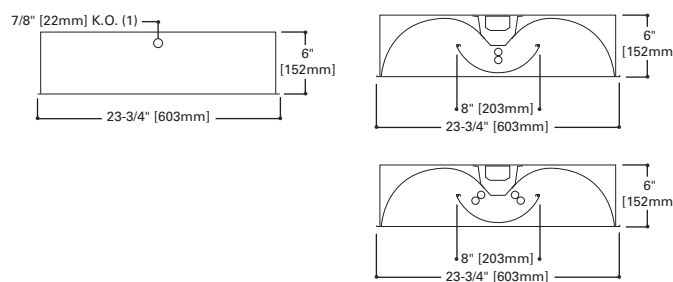

CEILING COMPATIBILITY

G Grid/Lay-in Standard	T Slot Grid	F Dry Wall Frame Kit	Ceiling Type	Trim Type
			Exposed Grid Concealed T Slot Grid Flange	G G or T ***

ENERGY DATA

Input Watts:

EB Ballast & STD Lamps
T1BX40 (70), T2BX40 (140)
T1BX50 (106), T1BX55 (110),

STD Ballast & STD Lamps
T1BX40 (82), T2BX40 (164)

Luminaire Efficacy Rating
LER = FL82

Catalog Number: 2RDI-IC

Yearly Cost of 1000 lumens,
3000 hrs at .08 KWH = \$2.92

*Reference the lamp/ballast data in the
Technical Section for specific lamp/ballast
requirements.

**Consult Pre Sales Technical Support.

***See Drywall Frame Kit Accessory

LAMPS CONTAIN MERCURY. DISPOSE ACCORDING TO LOCAL,
STATE OR FEDERAL LAWS

LINEAR DISCONNECT

Safe and convenient means of
disconnecting power.



ADF110369

ORDERING INFORMATION

SAMPLE NUMBER: 2RDI-IC-T2BX40FLS-UNV-EB51-U

Width 2= 2' Width	Number of Lamps⁽¹⁾ T1=2'x4' Fixture with One Biax Lamp at Each End T2=2 Tandem Lamps (Biax)	Lamp Shield FLS=Frosted Lamp Shield	Ballast Type EB5_=T5 Biax Electronic Instant⁽⁴⁾ Start. Total Harmonic Distortion < 20% TEB5_=T5 Biax Electronic Instant⁽⁴⁾ Start. Total Harmonic Distortion < 10% ER5_=T5 Biax Electronic Program Rapid Start. Total Harmonic Distortion < 10% Fifthlight Ballasts⁽⁶⁾ 5LT5B_=T5 Biax DALI Program Rapid Start. Total Harmonic Distortion < 10%. Ballast Factor 1.0	Options RIF1=Radio Interference Suppressor	Packaging U=Unit Pack PALC=Palletized Fixtures in Carton
Series RDI=Ovation Series (Recessed Direct/Indirect)	Wattage BX40=40W Biax (24")⁽¹⁾ BX50=50W Biax (24")⁽¹⁾ BX55=55W Biax (24")⁽¹⁾	Voltage⁽²⁾ 120V=120 Volt 277V=277 Volt 347V=347 Volt UNV=Universal Voltage 120-277	Number of Ballasts 1=1 Ballast 2=2 Ballasts 3=3 Ballasts	ACCESSORIES EQ-CLIP-U=T-BAR Safety Earthquake Clips⁽³⁾ DF-24-W=Drywall Frame Kit	
Type IC=IC Rated		Options GL=Single Element Fuse GM=Double Element Fuse Lamps=Lamps installed Flex=Flex installed EL=Emergency Installed			
Trim Type Blank=Grid/Lay-in (Standard)					
Lamp Position Blank=Center Mounted Lamps (Standard)					

NOTES: ⁽¹⁾ 50w or 55w Biax only available in tandem 1-lamp option. ⁽²⁾ Products also available in non-US voltages and frequencies for international markets. ⁽³⁾ An EQ Grid Clip is recommended for all 9/16" ceiling systems. ⁽⁴⁾ Not available in UNV voltages. Must specify voltage. ⁽⁶⁾ For a complete listing of Fifthlight Technology products and other solutions from Cooper Lighting Solutions, visit www.cooperlighting.com

For complete product data, reference the Fluorescent Specification binder. Specifications & dimensions subject to change without notice. Consult your Cooper Lighting Solutions Representative for availability and ordering information.

Discontinued
09-20-2021

SHIPPING INFORMATION

Catalog No.	Wt.
2RDI-IC-T1BX40FLS	31 lbs.
2RDI-IC-T2BX40FLS	31 lbs.