

COOPER LIGHTING SOLUTIONS - METALUX®



DESCRIPTION

The Ovation Series is a complete family of recessed direct/indirect luminaires featuring pleasant modern architectural styling, computer-designed optics and the latest energy efficient lamp and ballast technology. The luminaire combines a matte white indirect reflector and frosted white acrylic lamp shield. All components are located above the ceiling plane for a clean architectural appearance in the finished space. Carefully balanced design elements combine to provide an efficient and exciting, high performance alternative to traditional general lighting. Ovation is an excellent choice for a wide variety of commercial applications.

Catalog #		Type
Project		
Comments		Date
Prepared by		

SPECIFICATION FEATURES

Construction

Nominal 6" deep housing is die formed of code gauge, prime cold rolled steel. Heavy gauge end plates are securely attached with screws for strength and rigidity and the elimination of gaps. Four auxiliary fixture end suspension points are provided. KO's for continuous row wiring. Large access plate for supply connection.

Electrical*

Ballasts are Class "P" and are positively secured. Rotor-lock lampholders ensure positive lamp retention. UL/CUL listed. Suitable for damp locations.

Ballast Access

Ballast can be removed from below without tools.

Finish

Durable cold rolled steel with multistage, iron phosphate pretreatment and white enamel finish to ensure maximum bonding and rust inhibition.

Reflectors

Indirect reflector has high reflectance baked matte white enamel finish for luminous uniformity. Positively retained direct lamp shields are constructed of frosted white acrylic with linear retractors.

Controls

Fifth Light ballast options are offered for both 0-10V continuous dimming and DALI applications. Combine with energy saving products like occupancy sensors, daylighting controls, and lighting relay panels from Cooper Lighting Solutions (www.cooperlighting.com) to maximize energy savings.

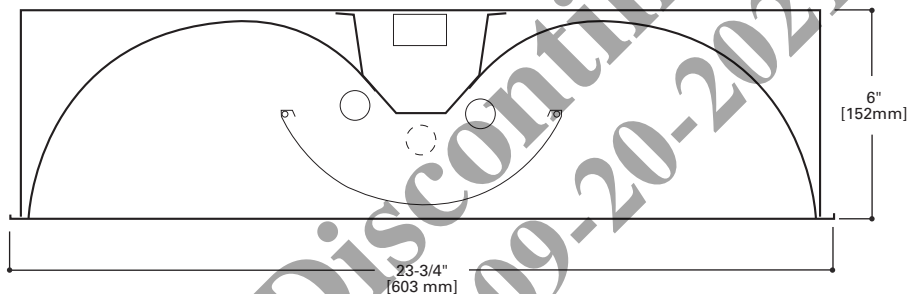

2RDI

128T5

228T5

328T5

154T5HO

254T5HO

354T5HO

T5 OR T5HO LAMPS

2' X 4' Recessed
Direct/Indirect
Center-Mount
Frosted Acrylic Basket

Ovation
T5

powered by
fifthlight
technology

MOUNTING DATA

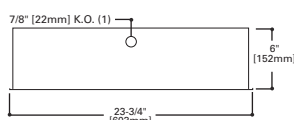
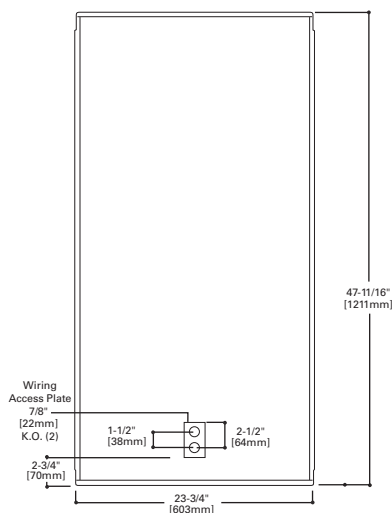

LAMP CONFIGURATIONS

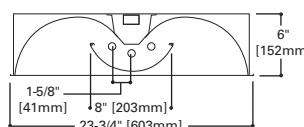
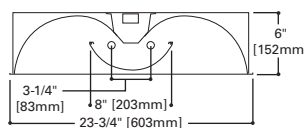
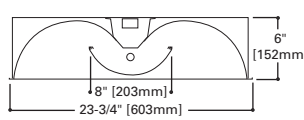

CEILING COMPATIBILITY

G
Grid/Lay-in
Standard

T
Slot Grid

F
Drywall Frame
Kit

**Ceiling
Type****
Exposed Grid
Concealed T
Slot Grid
Flange

**Trim
Type**
G
G or T

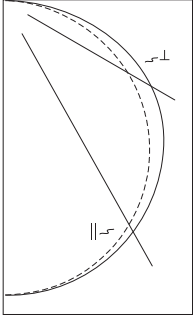

PHOTOMETRICS

**2RDI-228T5FLS**

Electronic Ballast

F28T5/835 28W Lamps

2600 Lumens

Spacing criterion:
(II) 1.3 x mounting
height, (⊥) 1.3 x
mounting height

Efficiency 86.8%

Test Report:

2RDI228T5FLS.IES

LER = FL75

Yearly Cost of 1000
lumens, 3000 hrs at
.08 KWH = \$3.21

Coefficients of Utilization

Effective floor cavity reflectance									20%									
rc	80%				70%				50%			30%			10%			0%
rw	70	50	30	10	70	50	30	10	50	30	10	50	30	10	50	30	10	0
RCR																		
0	103	103	103	103	101	101	101	101	96	96	96	92	92	92	89	89	89	87
1	93	89	85	81	91	87	83	80	83	80	77	80	77	75	77	75	73	71
2	84	77	70	65	82	75	69	64	72	67	63	69	65	61	66	63	60	58
3	77	67	59	53	74	65	59	53	63	57	52	60	55	51	58	54	50	48
4	70	59	51	45	68	58	50	44	56	49	44	53	48	43	52	47	43	41
5	64	52	44	38	62	51	44	38	50	43	38	48	42	37	46	41	37	35
6	59	47	39	33	57	46	39	33	45	38	33	43	37	32	42	36	32	30
7	55	43	35	29	53	42	34	29	40	34	29	39	33	29	38	33	28	27
8	51	39	31	26	49	38	31	26	37	30	26	36	30	25	35	29	25	24
9	47	35	28	23	46	35	28	23	34	28	23	33	27	23	32	27	23	21
10	44	33	26	21	43	32	25	21	31	25	21	31	25	21	30	24	21	19

Zonal Lumen Summary

Zone	Lumens	%Lamp	%Fixture
0-30	1103	21.2	24.4
0-40	1828	35.2	40.5
0-60	3357	64.6	74.4
0-90	4511	86.8	100.0
0-180	4511	86.8	100.0

Typical VCP Percentages

Room Size (Ft.)	Height Along		Height Across	
	8.5'	10.0'	8.5'	10.0'
20 x 20	60	68	57	65
30 x 30	54	59	51	55
30 x 60	48	51	44	47
60 x 30	56	60	54	58
60 x 60	49	51	46	48

Candela

Angle	Along II	45°	Across ⊥
0	1394	1394	1394
5	1387	1390	1392
10	1372	1377	1380
15	1345	1352	1359
20	1306	1318	1328
25	1258	1273	1288
30	1198	1220	1240
35	1130	1157	1185
40	1053	1087	1123
45	966	1011	1054
50	872	927	979
55	771	837	892
60	662	740	793
65	546	635	679
70	426	520	551
75	305	394	412
80	190	261	270
85	87	131	135
90	6	11	10

ORDERING INFORMATION

SAMPLE NUMBER: 2RDI-228FLS-120V-EBT1-U

Width
2=2' Width

Series
RDI=Ovation
Series
(Recessed
Direct/Indirect)

Trim Type
Blank=Grid/Lay-in
(Standard)

Lamp Position
Blank=Center
Mounted Lamps
(standard)

**Number
of Lamps**
1=1 Lamp
2=2 Lamp
3=3 Lamp

Wattage
28T5=28WT5 (48")⁽¹⁾
54T5=54WT5HO (48")⁽¹⁾

Lamp Shield
FLS=Frosted Lamp
Shield

Voltage⁽²⁾
120V=120 Volt
277V=277 Volt
347V=347 Volt
UNV=Universal
Voltage 120-277

Options
Lamps=Lamps Installed
GL=Single Element Fuse
GM=Double Element Fuse
Flex=Flex Installed
EL=Emergency Installed

Ballast Type
EBT__=T5 or T5HO Electronic Program Rapid Start.
Total Harmonic Distortion < 10%.
Standard Ballast Factor=1.0

Ballast/Factor Type
EBT__N=T5 Electronic Program Rapid Start.
Total Harmonic Distortion < 10%.
Normal Ballast Factor=.90⁽⁴⁾

EBT__H=T5 Electronic Program Rapid Start.
Total Harmonic Distortion < 10%.
High Ballast Factor=1.15⁽⁶⁾

EBT__NDIM=T5 Electronic Program Rapid Start.
Total Harmonic Distortion < 10%.
Step Dimming, Normal Ballast
Factor=.95-1.0⁽⁵⁾

EBT__HDIM=T5 Electronic Program Rapid Start.
Total Harmonic Distortion < 10%.
Step Dimming, High Ballast
Factor=1.15

0-10V Dimming Ballasts⁽⁸⁾

5LTV5__=T5 0-10V Program Rapid Start.
Total Harmonic Distortion < 10%.
Ballast Factor 1.0⁽¹¹⁾

5LTVS5__=T5 0-10V Spec Grade Program Rapid
Start. Total Harmonic Distortion < 10%.
Ballast Factor 1.0^{(8), (10)}

5LTV5H__=T5HO 0-10V Program Rapid Start.
Total Harmonic Distortion < 10%.
Ballast Factor 1.0⁽¹¹⁾

5LTVS5H__=T5HO 0-10V Spec Grade Program
Rapid Start. Total Harmonic Distortion
< 10%. Ballast Factor 1.0^{(8), (10)}

Fifth Light DALI Ballasts⁽⁷⁾

5LT5__=T5 DALI Program Rapid Start.
Total Harmonic Distortion < 10%.
Ballast Factor 1.0

5LT5H__=T5HO DALI Program Rapid Start.
Total Harmonic Distortion < 10%.
Ballast Factor 1.0

Number of Ballasts

1=1 Ballast
2=2 Ballasts
3=3 Ballasts

Options
RIF1=Radio Interference
Suppressor
REP=Riveted Endplates, for
use in New York City.
ST=Semi-Specular
Tannenbaum Main Reflector

Packaging
U=Unit Pack
PALC=Job Pack, in carton

ACCESSORIES

EQ-CLIP-U=T-BAR Safety
Earthquake Clips⁽³⁾
DF-24-W=Drywall Frame Kit

NOTES: ⁽¹⁾ 2' x 2' and 2' x 4' Center Lamp Shield models only. ⁽²⁾ Products also available in non-US volt-
ages and frequencies for international markets. ⁽³⁾ An EQ Grid Clip is recommended for all 9/16" ceiling
systems. Four required per fixture. ⁽⁴⁾ .90 ballast factor available for 2 or 3 14WT5 or 28WT5 lamps only.
⁽⁵⁾ 1-Lamp step dimming ballast in a Normal Ballast factor not available. 2-Lamp ballast will not operate
1-Lamp. ⁽⁶⁾ 1-Lamp ballast in a High Ballast factor not available. ⁽⁷⁾ For a complete listing of Fifthlight
Technology products and other solutions from Cooper Lighting Solutions, visit www.cooperlighting.com.
⁽⁸⁾ 0-10V ballast do not include DALI feature. Please select DALI ballast for use with Fifth Light system. ⁽⁹⁾ Spec-
ification grade 0-10V dimming ballast are NEMA premium and CEE listed. They are compatible with low mercury
and energy saving lamps. ⁽¹⁰⁾ Specification Grade 0-10V ballast not offered in 3 or 4-lamp versions. ⁽¹¹⁾ Standard
0-10V ballast not offered in 3 or 4-lamp versions.

For complete product data, reference the Fluorescent Specification binder. Specifications & dimensions
subject to change without notice. Consult your Cooper Lighting Solutions Representative for availability and
ordering information.

SHIPPING INFORMATION

Catalog No.	Wt.
2RDI-128T5FLS	28 lbs.
2RDI-228T5FLS	28 lbs.
2RDI-328T5FLS	28 lbs.
2RDI-154T5FLS	28 lbs.
2RDI-254T5FLS	28 lbs.
2RDI-354T5FLS	28 lbs.