

# COOPER LIGHTING SOLUTIONS - METALUX®

## DESCRIPTION

The Ovation Series is a complete family of recessed direct/indirect luminaires featuring pleasant modern architectural styling, computer-designed optics and the latest energy efficient lamp and ballast technology. The luminaire combines a matte white indirect reflector and a perforated direct lamp shield to provide optimum brightness control. All components are located above the ceiling plane for a clean architectural appearance in the finished space. Carefully balanced design elements combine to provide an efficient and exciting, high performance alternative to traditional general lighting. Ovation is an excellent choice for a wide variety of commercial applications.

Catalog #		Type
Project		
Comments		Date
Prepared by		

## SPECIFICATION FEATURES

### Construction

Nominal 6" deep housing is die formed of code gauge, prime cold rolled steel. Heavy gauge end plates are securely attached with screws for strength and rigidity and the elimination of gaps. Four auxiliary fixture end suspension points are provided. KOs for continuous row wiring. Large access plate for supply connection.

### Electrical\*

Ballasts are Class "P" and are positively secured. Rotor-lock lampholders ensure positive lamp retention. UL/CUL listed. Suitable for damp locations.

### Ballast Access

Ballast can be removed from below without tools or from above using the unique ballast mounting/access plate.<sup>2</sup>

### Finish

Durable cold rolled steel with multistage, iron phosphate pretreatment and white enamel finish to ensure maximum bonding and rust inhibition.

### Reflectors

Indirect reflector has high reflectance baked matte white enamel finish for luminous uniformity. A positively retained direct lamp shield is constructed of heavy gauge perforated steel with high reflectance matte white painted after fabrication finish and milky white overlay diffuser for visual comfort. All reflectors are precision formed in a computer-controlled operation.

### Controls

Fifth Light ballast options are offered for both 0-10V continuous dimming and DALI applications. Combine with energy-saving products like occupancy sensors, daylighting controls, and lighting relay panels from Cooper Lighting Solutions ([www.cooperlighting.com](http://www.cooperlighting.com)) to maximize energy savings.

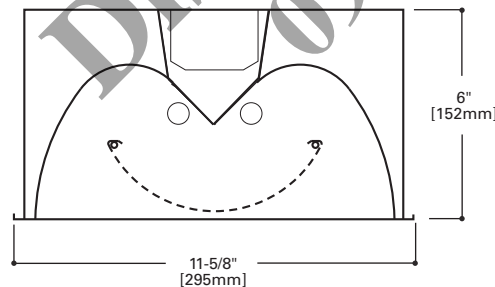

## MOUNTING DATA

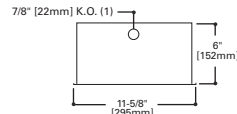
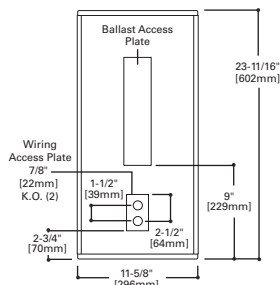

## LAMP CONFIGURATIONS

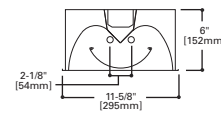

## CEILING COMPATIBILITY

G Grid/Lay-in Standard	T Slot Grid	F Dry Wall Frame Kit	Ceiling Type**	Trim Type
			Exposed Grid	G
			Concealed T	G or T
			Slot Grid	G or T
			Flange	F

(Verify compatibility/ consult factory.)



**RDI**  
**214T5**  
**224T5**

**T5 OR T5HO LAMPS**

1' X 2' Recessed  
Direct/Indirect  
Center-Mount

**Ovation™**  
**T5**

powered by  
**fifthlight**  
technology

## ENERGY DATA

Input Watts:

**EB Ballast & STD Lamps**

214T5 (38)

224T5 (52)

Luminaire Efficacy Rating

**LER = FD46**

**Catalog Number: RDI-214T5RP**

**Yearly Cost of 1000 lumens,  
3000 hrs at .08 KWH = \$5.22**

\*Reference the lamp/ballast data in the  
Technical Section for specific lamp/ballast  
requirements.

**LAMPS CONTAIN MERCURY. DISPOSE ACCORDING TO LOCAL,  
STATE OR FEDERAL LAWS**

**LINEAR DISCONNECT**

Safe and convenient means of  
disconnecting power.

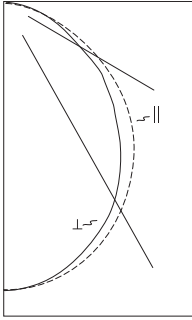

## PHOTOMETRICS

**RDI-214T5RP**

Electronic Ballast

F14T5/835 Lamps

1350 Lumens

Spacing criterion:  
(II) 1.2 x mounting  
height, (⊥) 1.2 x  
mounting height

Efficiency 57.6%

Test Report:

RDISYM214T5RPIES

LER = FD46

Yearly Cost of 1000  
lumens, 3000 hrs at  
.08 KWH = \$5.22

**Coefficients of Utilization**

Effective floor cavity reflectance										20%											
rc	80%				70%				50%				30%				10%				0%
rw	70	50	30	10	70	50	30	10	50	30	10	50	30	10	50	30	10	0			
RCR																					
0	69	69	69	69	67	67	67	67	64	64	64	61	61	61	59	59	59	58			
1	63	61	59	57	62	60	58	56	57	56	54	55	54	53	53	52	51	50			
2	58	54	51	48	57	53	50	47	51	48	46	49	47	45	48	46	44	43			
3	54	48	44	41	52	47	44	40	46	42	40	44	41	39	43	40	38	37			
4	49	43	39	35	48	42	38	35	41	37	34	40	36	34	39	36	33	32			
5	45	38	34	30	44	38	33	30	37	33	29	35	32	29	34	31	29	28			
6	42	35	30	26	41	34	29	26	33	29	26	32	28	26	31	28	25	24			
7	39	31	26	23	38	31	26	23	30	26	23	29	25	22	28	25	22	21			
8	36	28	23	20	35	28	23	20	27	23	20	26	22	20	25	22	19	18			
9	33	25	20	17	32	25	20	17	24	20	17	24	20	17	23	19	17	16			
10	31	23	18	15	30	23	18	15	22	18	15	21	18	15	21	18	15	14			

**Zonal Lumen Summary**

Zone	Lumens	%Lamp	%Fixture
0-30	476	17.6	30.6
0-40	765	28.3	49.2
0-60	1287	47.7	82.7
0-90	1555	57.6	100.0
0-180	1555	57.6	100.0

**Typical VCP Percentages**

Room Size (Ft.)	Height Along		Height Across	
	8.5'	10.0'	8.5'	10.0'
20 x 20	58	63	59	65
30 x 30	56	57	56	58
30 x 60	53	53	53	53
60 x 30	60	61	60	61
60 x 60	56	55	55	55

**Candela**

Angle	Along II	45°	Across ⊥
0	625	625	625
5	624	623	621
10	616	613	610
15	600	596	590
20	579	570	560
25	552	539	527
30	520	502	489
35	482	459	447
40	441	413	397
45	396	365	346
50	347	311	301
55	294	256	254
60	241	209	207
65	185	162	161
70	130	119	117
75	82	77	78
80	43	43	45
85	15	17	18
90	0	0	0

**ORDERING INFORMATION**

SAMPLE NUMBER: RDI-214T5RP-120V-EBT1-U

<b>Width</b> Leave Blank=1' Width  <b>Series</b> RDI=Ovation Series (Recessed Direct/Indirect)  <b>Trim Type</b> Leave Blank=Grid/Lay-in (Standard)  <b>Lamp Position</b> Leave Blank=Center Mounted Lamps (Standard)	<b>Number of Lamps</b> 1=1 Lamp 2=2 Lamp  <b>Wattage</b> 14T5=14WT5 (24") <sup>(1)</sup> 24T5=24WT5HO (24") <sup>(1)</sup>  <b>Voltage</b> <sup>(2)</sup> 120V=120 Volt 277V=277 Volt 347V=347 Volt UNV=Universal Voltage 120-277	<b>Lamp Shield</b> X=Solid Matte White RP=Round Perforated White Steel  <b>Options</b> GL=Single Element Fuse GM=Double Element Fuse Lamps=Lamps installed Flex=Flex installed EL=Emergency Installed	<b>Ballast Type</b> EBT=T5 or T5HO Electronic Program Rapid Start. Total Harmonic Distortion < 10%. Standard Ballast Factor=1.0  <b>0-10V Dimming Ballasts</b> <sup>(5)</sup> 5LTV5=T5 0-10V Program Rapid Start. Total Harmonic Distortion < 10%. Ballast Factor 1.0  5LTVS5=T5 0-10V Spec Grade Program Rapid Start. Total Harmonic Distortion < 10%. Ballast Factor 1.0 <sup>(6)</sup>  5LTV5H=T5HO 0-10V Program Rapid Start. Total Harmonic Distortion < 10%. Ballast Factor 1.0 <sup>(8)</sup>  5LTVS5H=T5HO 0-10V Spec Grade Program Rapid Start. Total Harmonic Distortion < 10%. Ballast Factor 1.0 <sup>(6),(7)</sup>  <b>Fifth Light DALI Ballasts</b> <sup>(4)</sup> 5LT5=T5 DALI Program Rapid Start. Total Harmonic Distortion < 10%. Ballast Factor 1.0  5LTS5H=T5HO DALI Program Rapid Start. Total Harmonic Distortion < 10%. Ballast Factor 1.0	<b>Options</b> RIF1=Radio Interference Suppressor REP=Riveted Endplates LSC=Lamp Shield Cable ST=Semi-Specular Tannenbaum  <b>Packaging</b> U=Unit Pack PALC=Job Pack, in carton  <b>ACCESSORIES</b> EQ-CLIP-U=T-BAR Safety Earthquake Clips <sup>(3)</sup> DF-12-W=Drywall Frame Kit

NOTES: <sup>(1)</sup> 2' x 2' and 2' x 4' Center Lamp Shield models only. <sup>(2)</sup> Products also available in non-US voltages and frequencies for international markets. <sup>(3)</sup> An EQ Grid Clip is recommended for all 9/16" ceiling systems. Four required per fixture. <sup>(4)</sup> For a complete listing of Fifthlight Technology products and other solutions from Cooper Lighting Solutions, visit [www.cooperlighting.com](http://www.cooperlighting.com). <sup>(5)</sup> 0-10V ballast do not include DALI feature. Please select DALI ballast for use with Fifth Light system. <sup>(6)</sup> Specification grade 0-10V dimming ballast are NEMA premium and CEE listed. They are compatible with low mercury and energy saving lamps. <sup>(7)</sup> Specification Grade 0-10V ballast not available for 24WT5HO lamps. <sup>(8)</sup> Standard 0-10V ballast not available for 24WT5HO lamps.

For complete product data, reference the Fluorescent Specification binder. Specifications & dimensions subject to change without notice. Consult your Cooper Lighting Solutions Representative for availability and ordering information.

**Number of Ballasts**  
1=1 Ballast  
2=2 Ballasts  
3=3 Ballasts

**SHIPPING INFORMATION**

Catalog No.	Wt.
RDI-214T5RP	9 lbs.
RDI-224T5RP	9 lbs.