

2001, 2002, 2004 Rigid Stem Mount

IMPORTANT: Read carefully before installing product. Retain for future reference.



WARNING



Risk of Fire, Electrical Shock, Cuts or other Casualty Hazards- Installation and maintenance of this product must be performed by a qualified electrician. This product must be installed in accordance with the applicable installation code by a person familiar with the construction and operation of the product and hazards involved.



Risk of Fire and Electric Shock- Make certain power is OFF before starting installation or attempting any maintenance. Disconnect power at fuse or circuit breaker.



Risk of Fire- Minimum 90°C supply conductors.



Risk of Burn- Disconnect power and allow product to cool before handling or servicing.



Risk of Personal Injury- Due to sharp edges, handle with care.

Risk of Personal Injury- Do not install this product in locations such as gymnasiums, arenas, sports complexes, multi-purpose rooms and other locations where the fixture potentially will be subject to impacts from external sources. Doing so may result in cracking and/or breaking of the fixture which may cause pieces to fall from the application.

Risk of Personal Injury- Failure to comply with these instructions may result in death, serious bodily injury and property damage.

DISCLAIMER OF LIABILITY: Cooper Lighting Solutions assumes no liability for damages or losses of any kind that may arise from the improper, careless, or negligent installation, handling or use of this product.

IMPORTANT: Read carefully before installing fixture. Retain for future reference.

CAUTION: Fixture may become damaged and/or unstable if not installed properly.

NOTE: Specifications and dimensions subject to change without notice.

NOTE: These instructions do not claim to cover all details or variations in the equipment, procedure or process described, nor to provide directions for every possible contingency during installation, operation, or maintenance. When additional information is desired to satisfy a problem not covered sufficiently for user purpose, please contact your nearest representative.

ATTENTION Receiving Department: Note actual fixture description of any shortage or noticeable damage on delivery receipt. File claim for common carrier (LTL) directly with carrier. Claims for concealed damage must be filed within 15 days of delivery. All damaged material, complete with original packing must be retained.

Note: Ensure all components are located before disposing shipping materials.

Figure 1

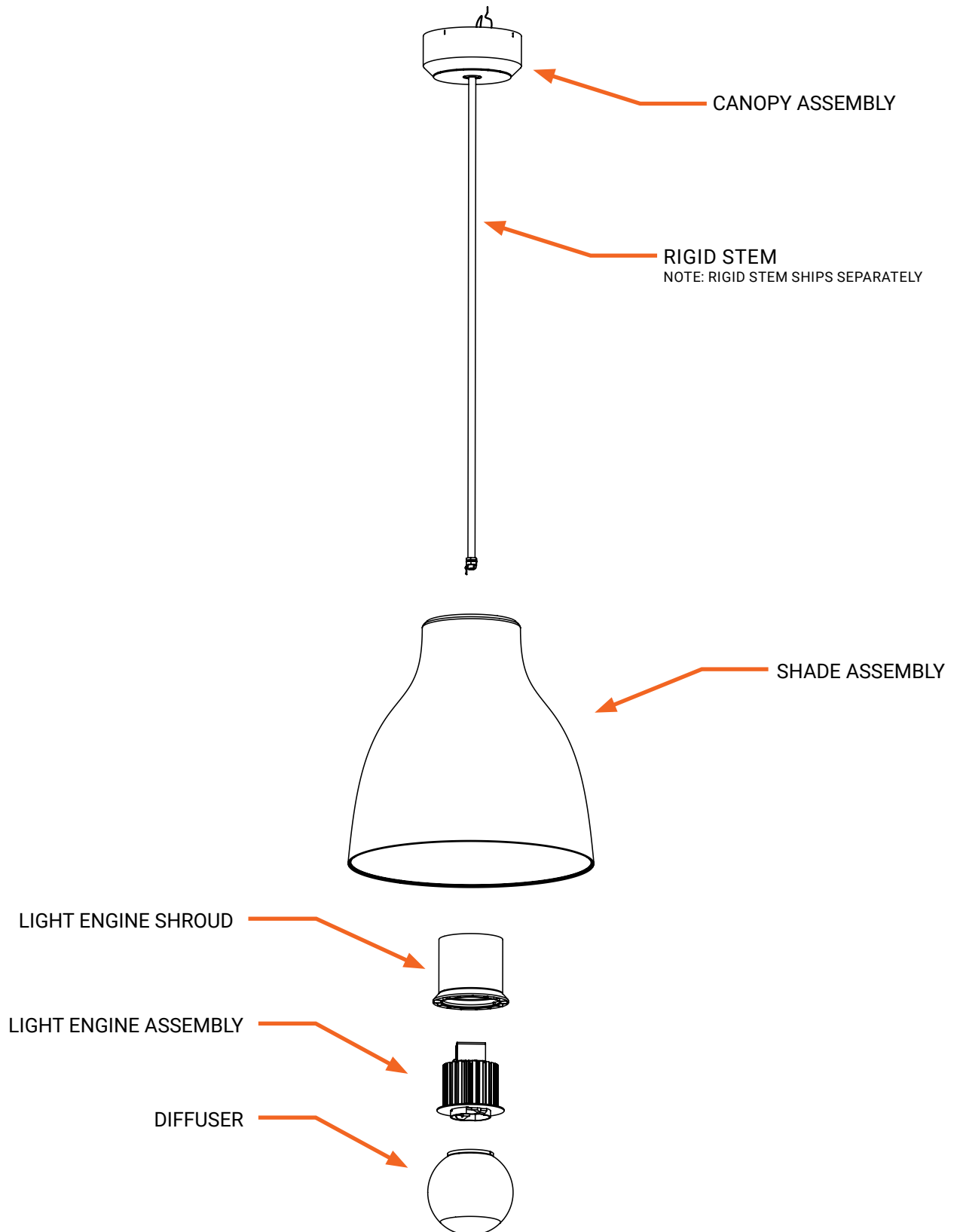

Wiring Table

Power Supply (Input)	
<div></div>	Black (BK) - Hot
<div></div>	White (WT) - Neutral
<div></div>	Green (GN) - Ground
<div></div>	Violet (VT) - Dimming (+)
<div></div>	Pink (PK) - Dimming (-)
<div></div>	Blue (BL) - LED (-)
<div></div>	Red (RD) - LED (+)

Wiring Diagram

Single Driver (Small and Medium Size Fixture)

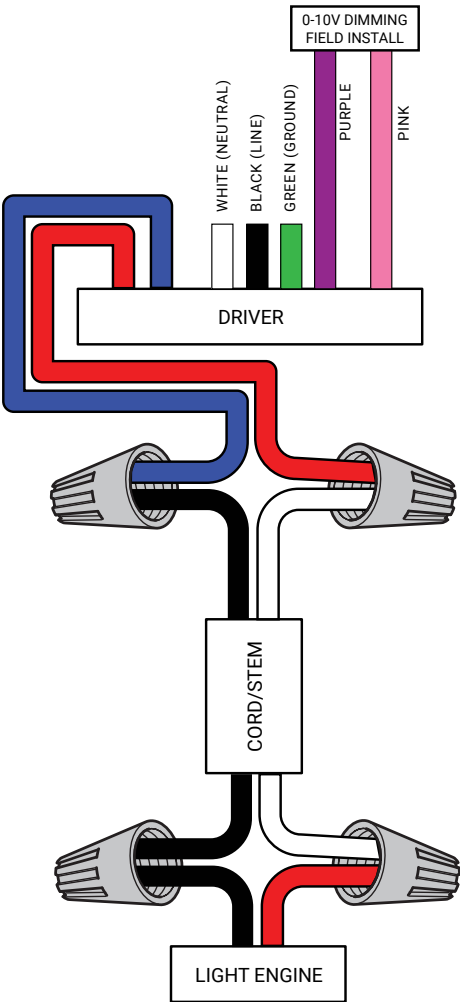

2 Drivers (Large Size Fixture)

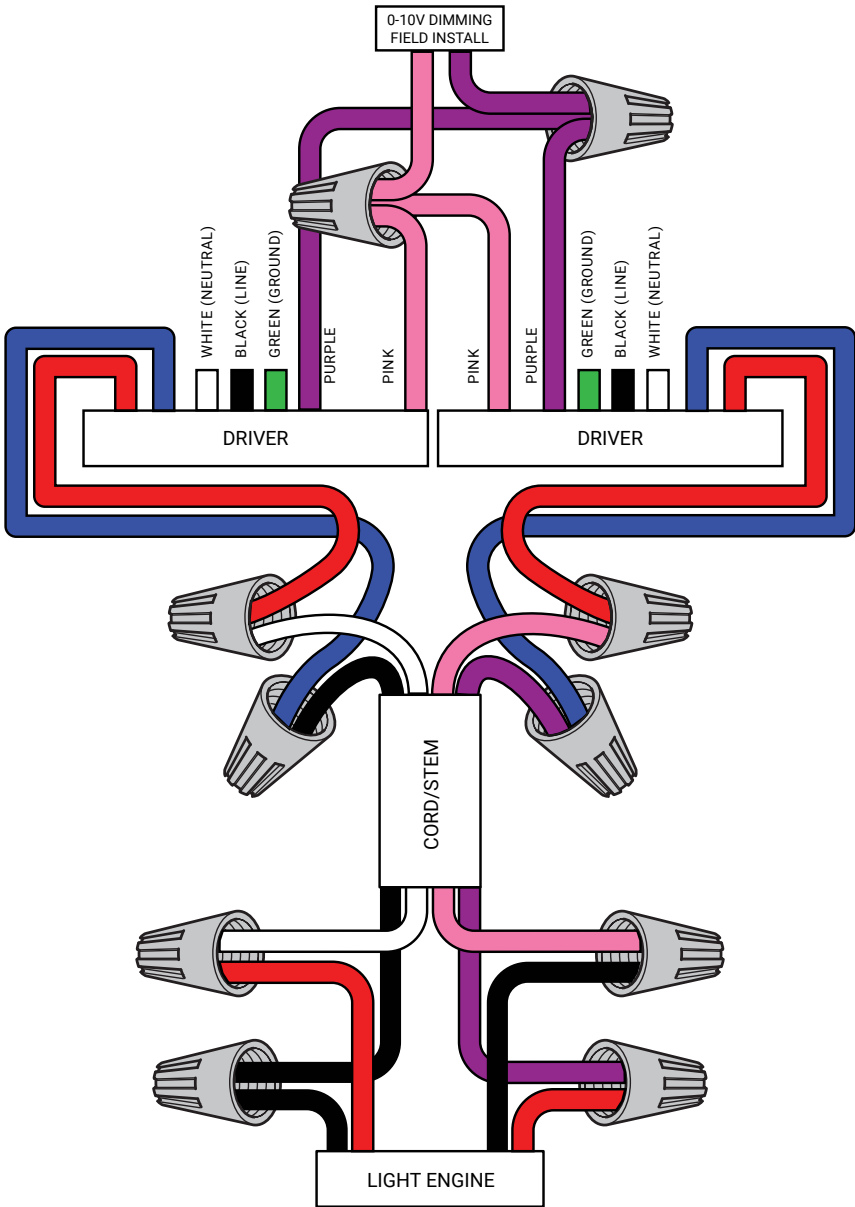

Figure 2A: Small and Medium Single Driver Components Exploded View

Note: Some components will arrive already assembled

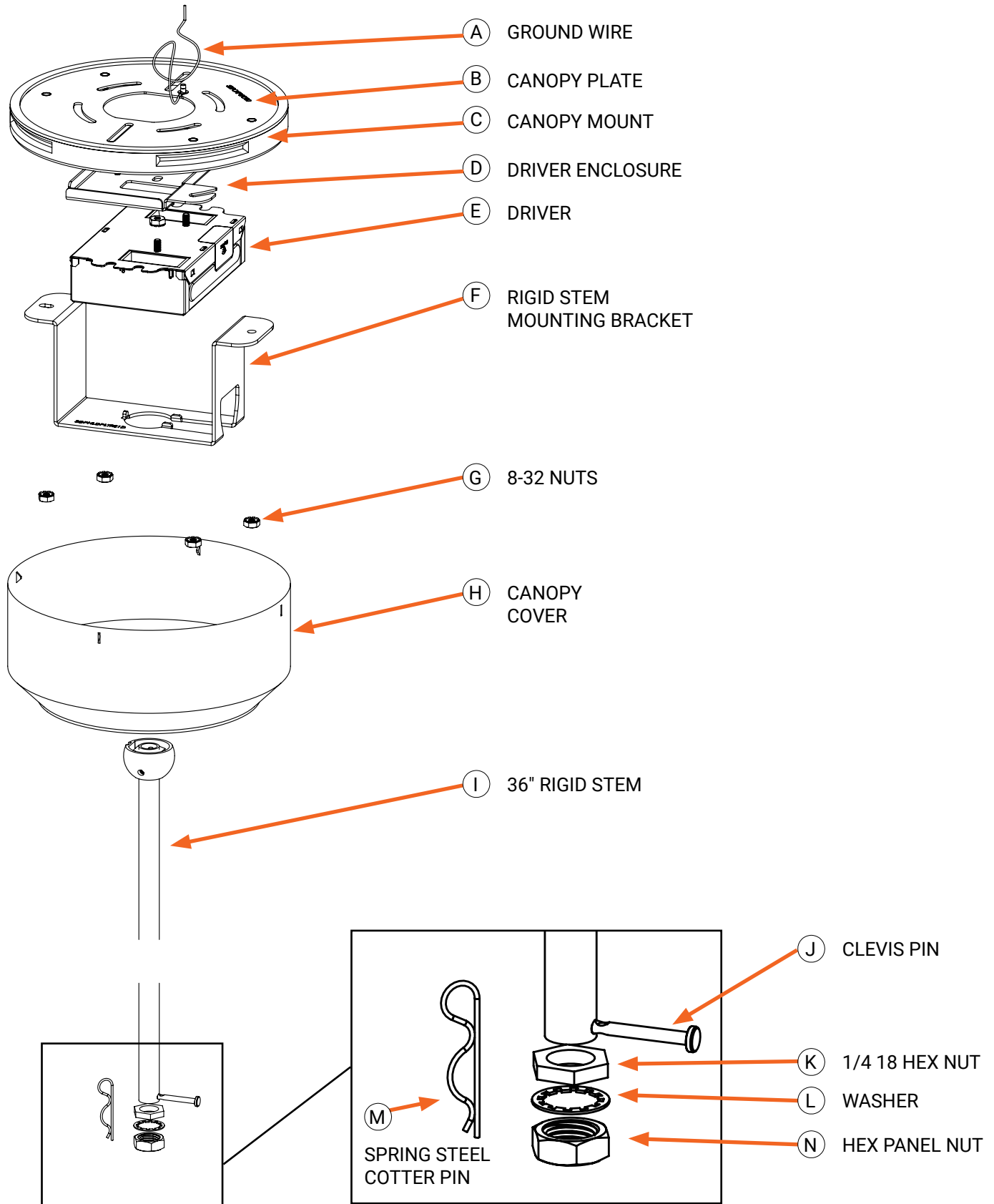
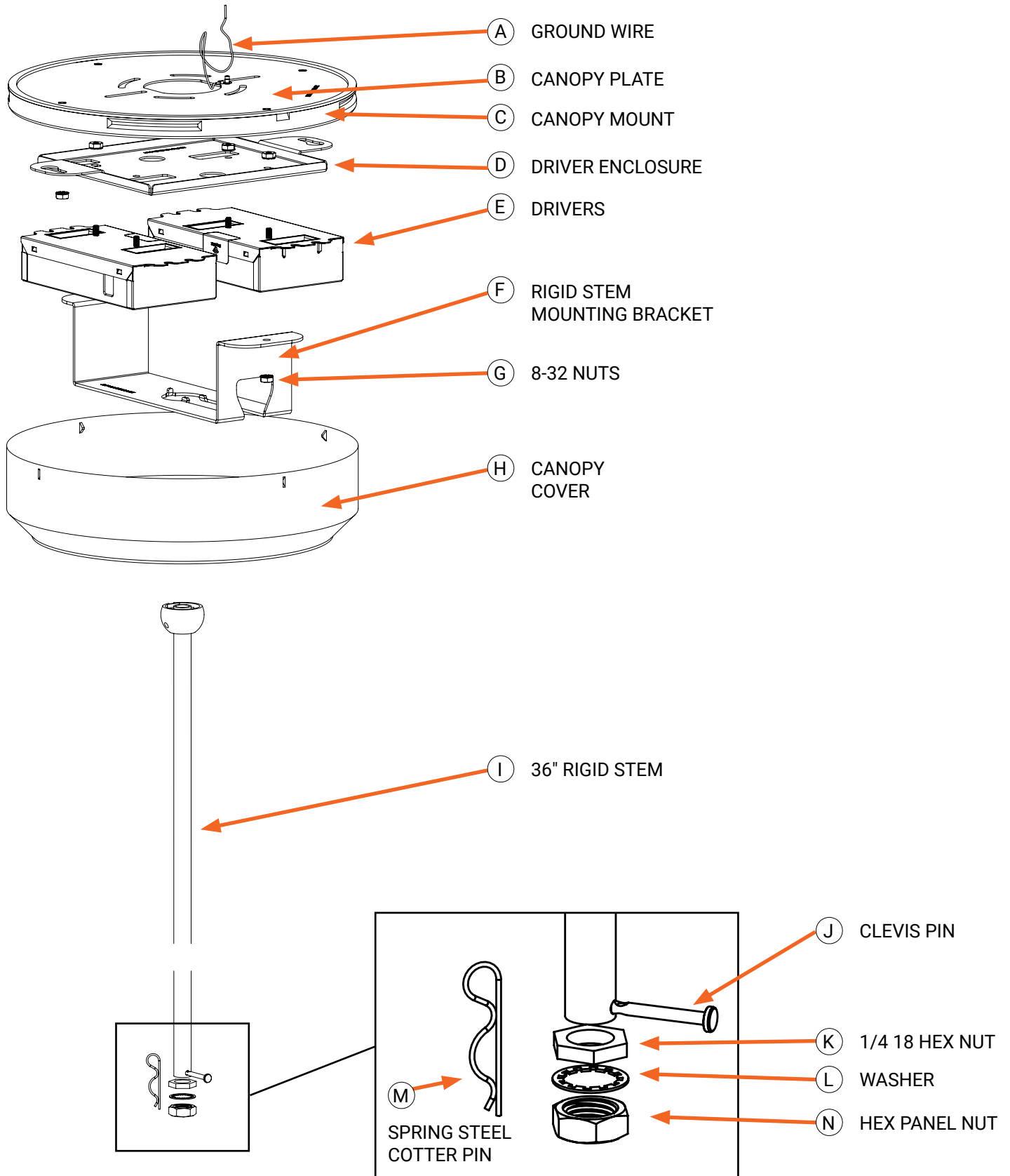

Figure 2B: Large Double Driver Components Exploded View

Note: Some components will arrive already assembled



Rigid Stem Canopy Assembly

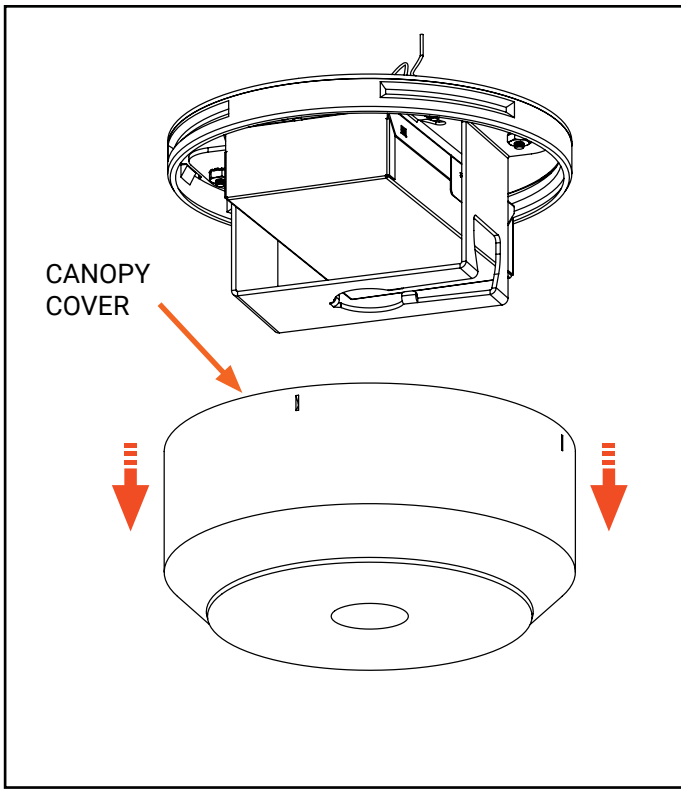

Figure 3

1. Ensure power is off at junction box.
2. Carefully remove lighting fixture, hardware, cords, and packaging from box. Inspect to ensure all items (Figure 1) are included.
3. Take out the **Canopy Cover (H)** by pulling down. (Figure 3)

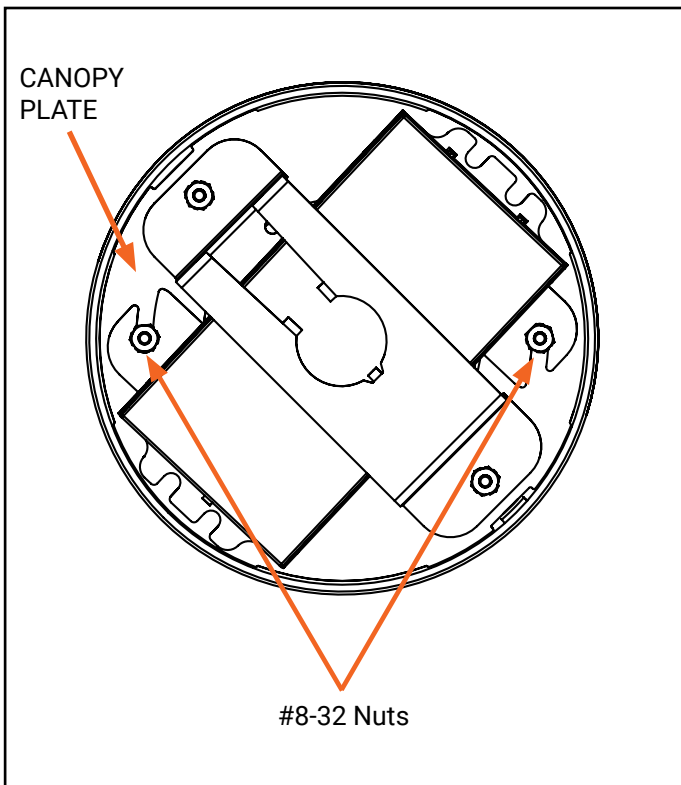
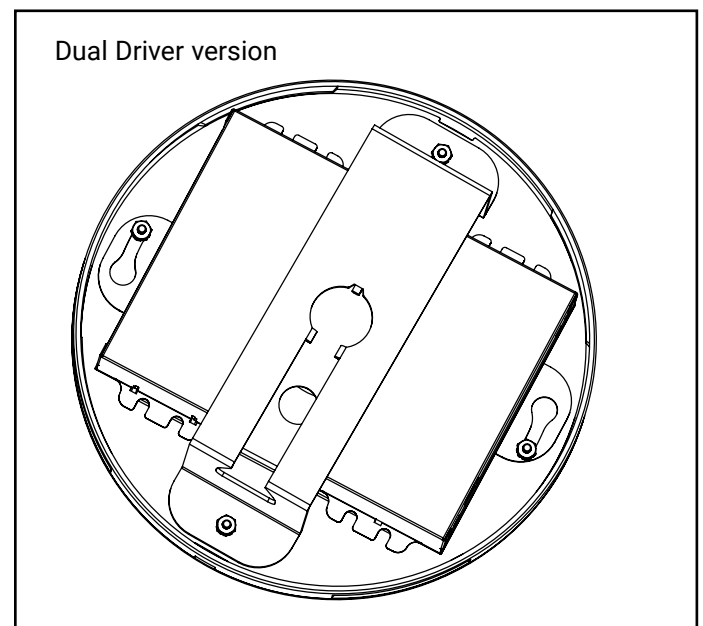

Figure 4

4. Loosen the **two #8-32 nuts (G)** from the **Canopy Plate (B)**. (Figure 4)



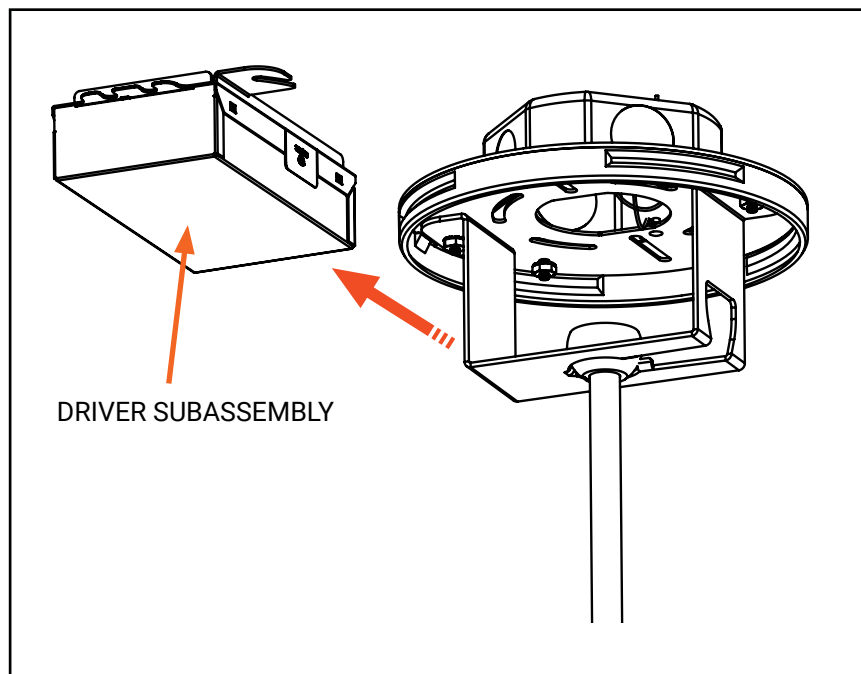

Figure 5

5. Rotate Driver Subassembly CCW and securely remove. (Figure 5)

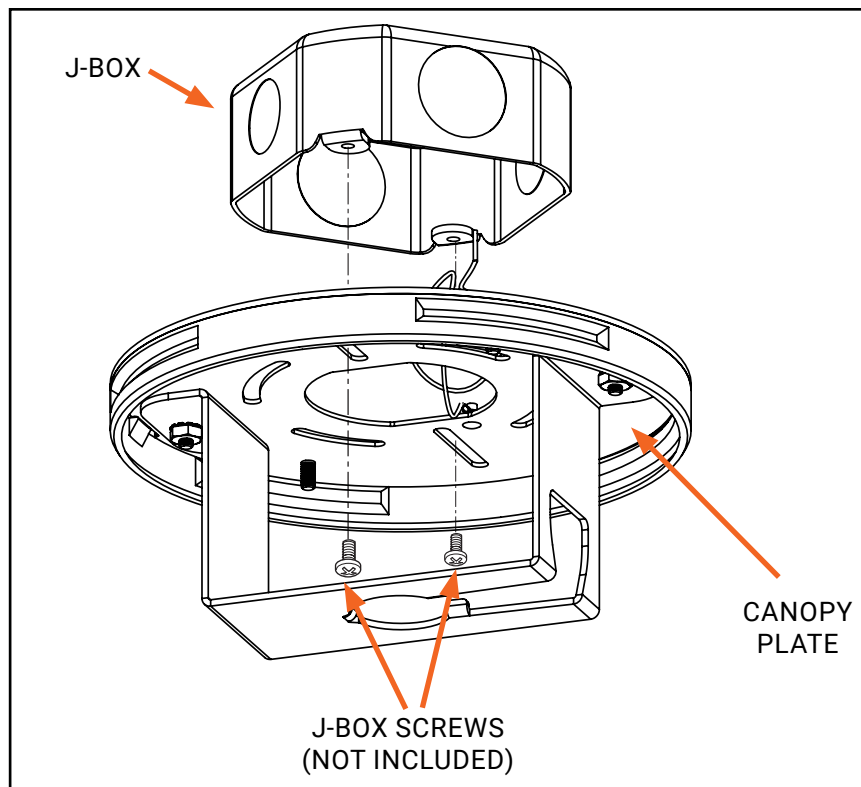
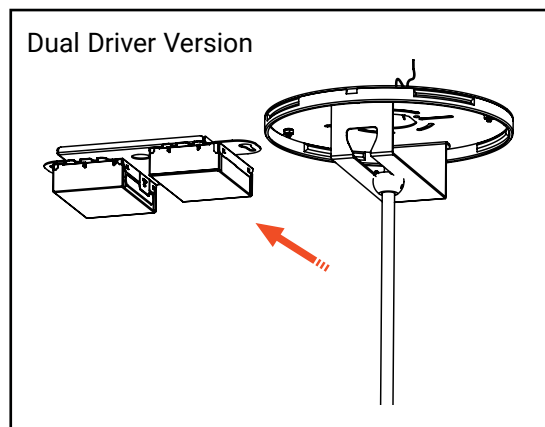

Figure 6

6. Attach the **Canopy Plate (B)** to the J-Box (supplied by others) with 2 screws (not included) adequately tight. (Figure 6)
7. Take the driver subassembly and make the electrical connections as shown in the wiring diagram on page 3.

Note: Single driver and Double driver assemblies use different wiring refer to wiring diagram and wire based on number of drivers.

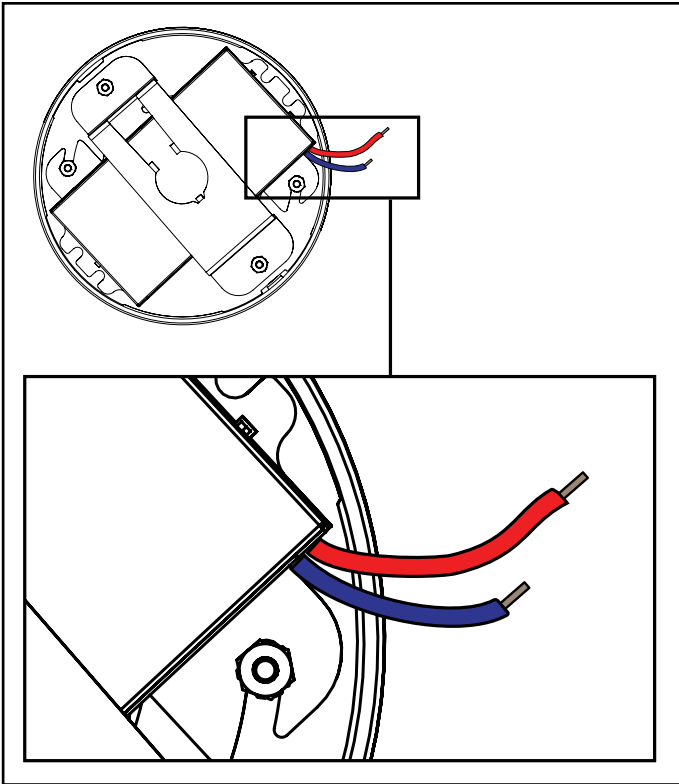

Figure 7

8. Route the Low voltage wire routing (LED wires) from the **Driver Plate (B)** (Figure 7)
9. Push all connectors and extra wire from the driver assembly into the J-Box.

10. Reinstall the driver subassembly by aligning with studs and rotate Clockwise and secure with two **#8-32 nuts (G)**. Make sure wires will not interfere with assembly while rotating. (Figure 8)

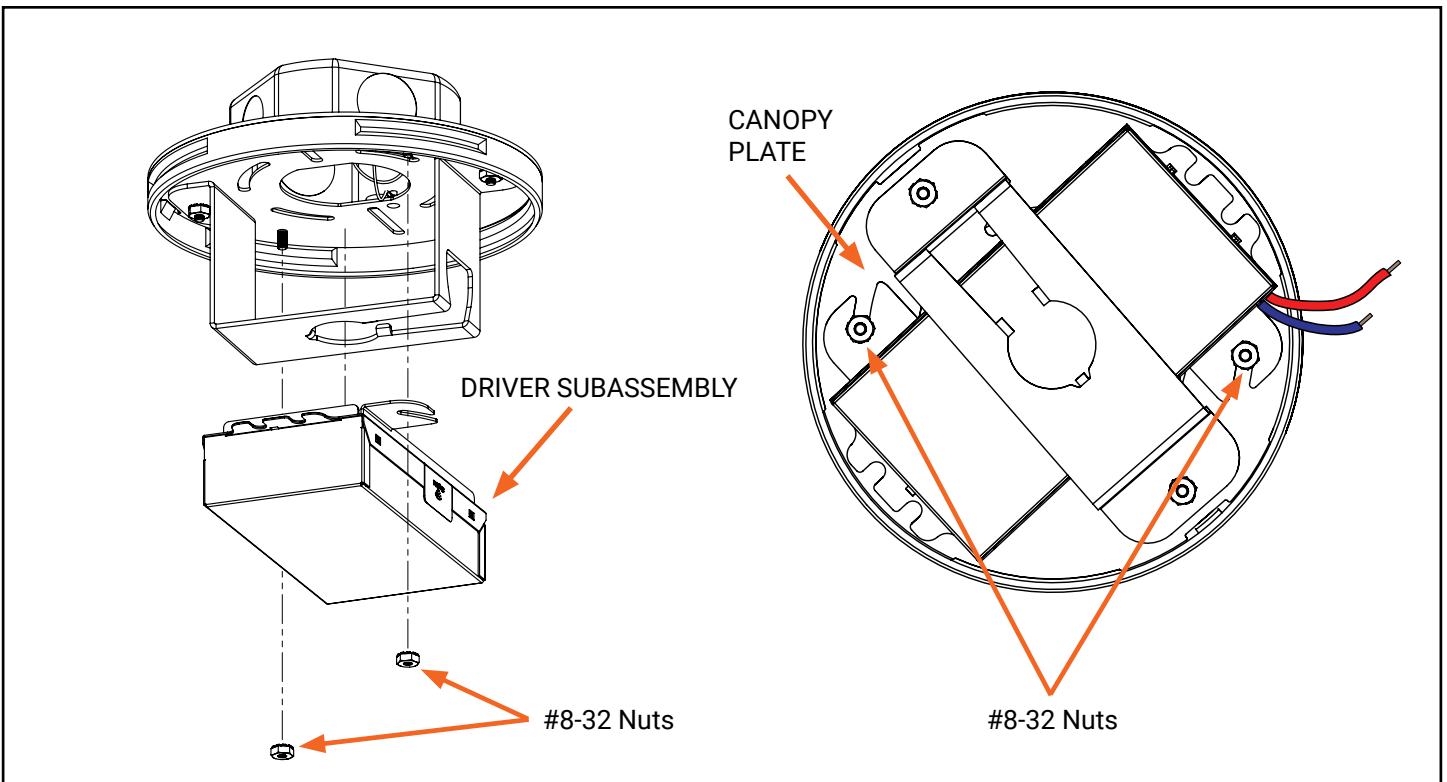
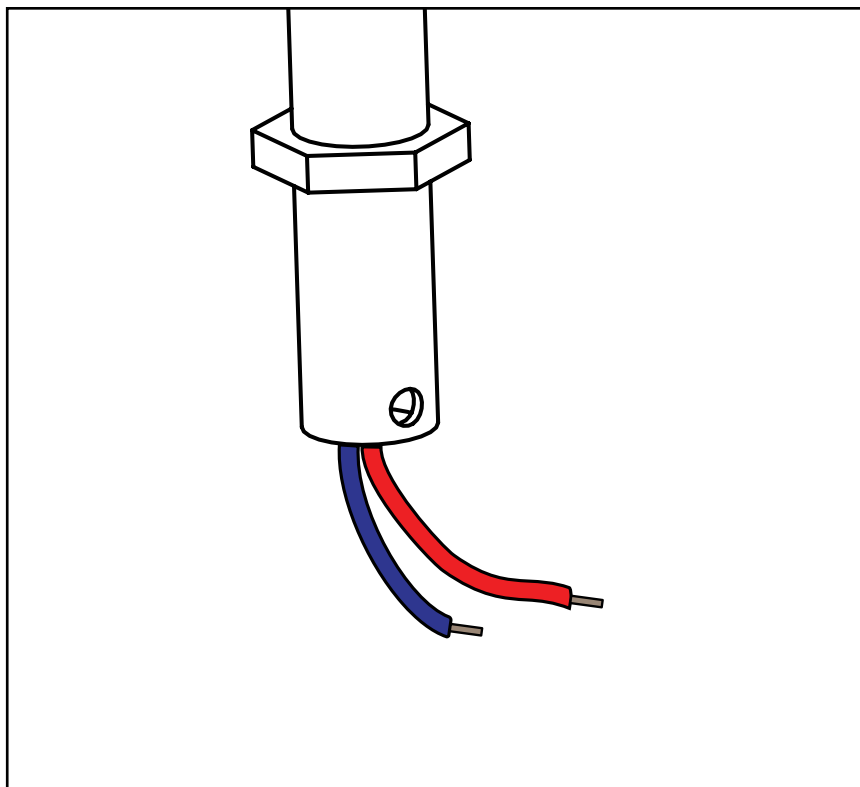

Figure 8



11. Pull Low voltage LED wire leads through stem.
(Figure 9)

Figure 9

Connecting Stem to Light Engine

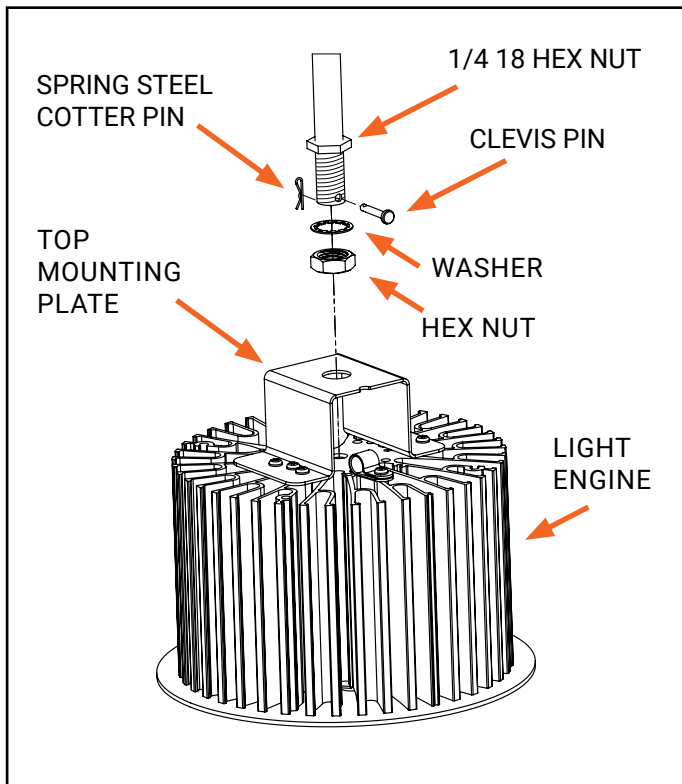

Figure 10

- 12a. For threaded connections along the stem, use 271 Locktite (provided with Stem kit) or similar approved locking compound.
- 12b. **1/4 18 Hex Nut (K)** - Thread top support locknut onto stem. Finger tighten until the end of threads. Tighten w/wrench 1/8-1/4 turn.
- 12c. Insert wires/stem through center hole of top mounting plate on light engine.
- 12d. On the bottom side of the mounting plate, add support stem **lock washer (L)**.
- 12e. **Hex Nut (N)** - Thread bottom support nut. Finger tighten at first. Apply a minimum of 16in-lbs of torque along w/locktite. plate, add support stem lock washer.
- 12f. Add **Clevis Pin (J)** to the hole in the stem below the installed support nut.
- 12g. Insert **Spring Steel Cotter Pin (M)** into end of **Clevis Pin (J)**.

(Figure 10)

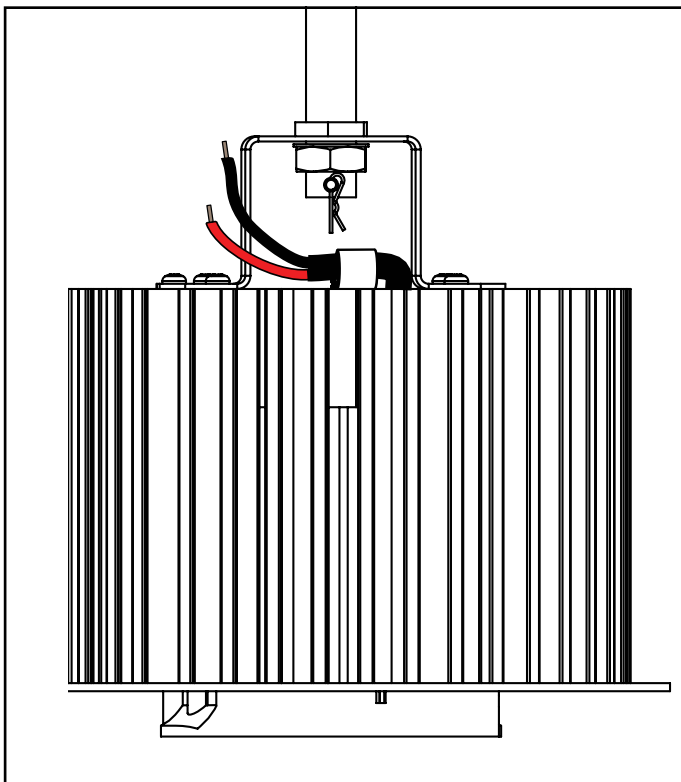

Figure 11

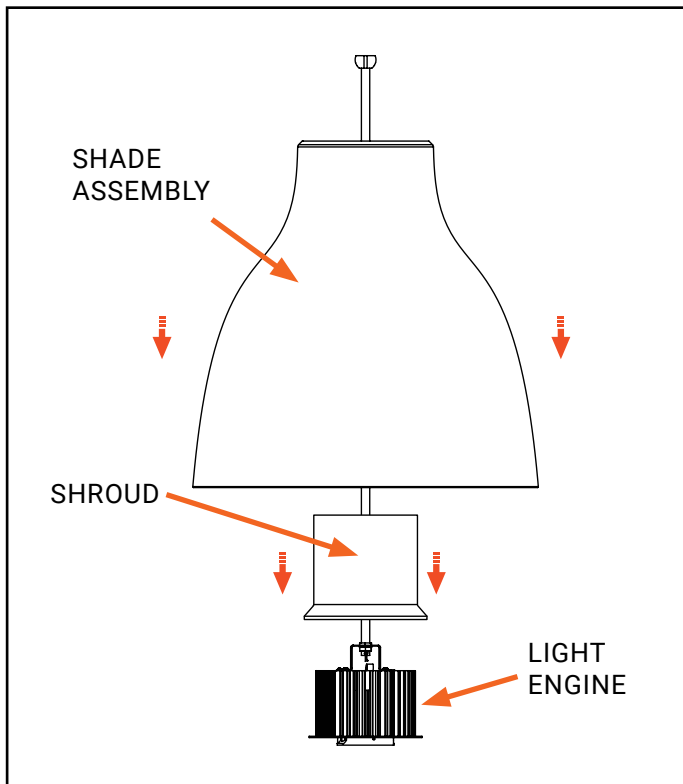

Figure 12

13. Make appropriate wiring connections to Light engine as shown in the wiring diagram.

14. Carefully insert the shade assembly from the top of the stem, Align shroud over the light engine and slide it over light engine till spokes touched to the mount plate.
(Figure 12)

15. Place **Canopy Cover (H)** on **Rigid Stem (I)**.
(Figure 13)

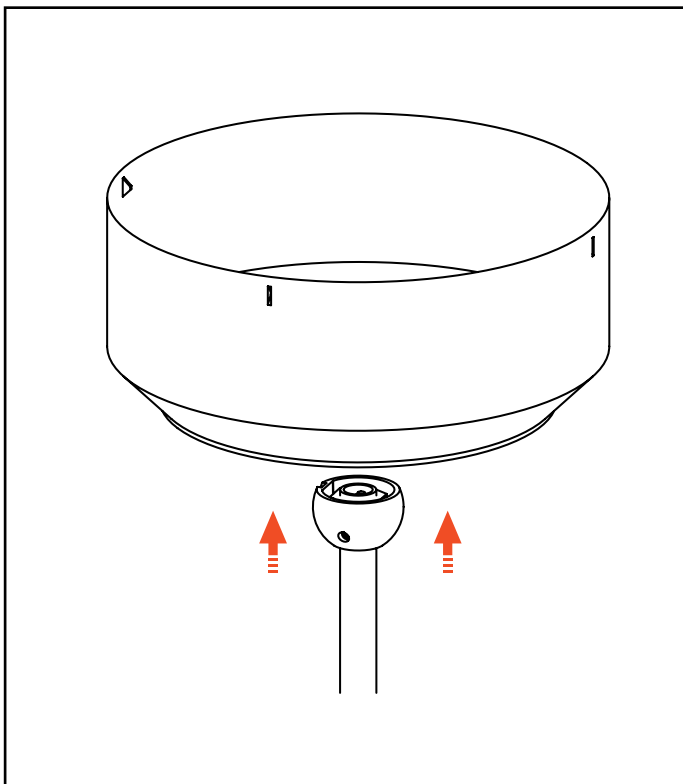

Figure 13

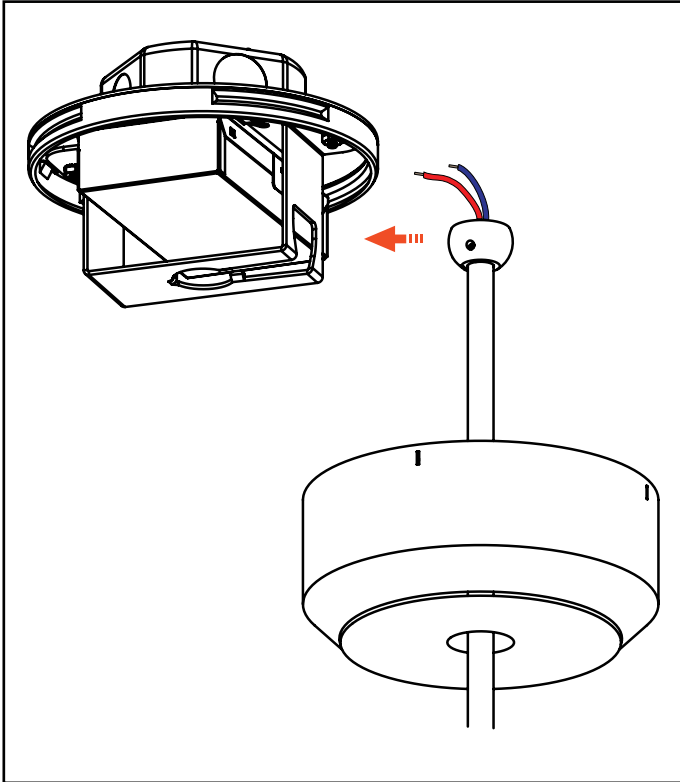

Figure 14a

16. Insert swivel ball end of stem and fixture assembly into swivel support.
(Figure 14a)

Note: Match the groove on swivel ball with the tab in holding plate, such that stem will not rotate on its own
(Figure 14b)

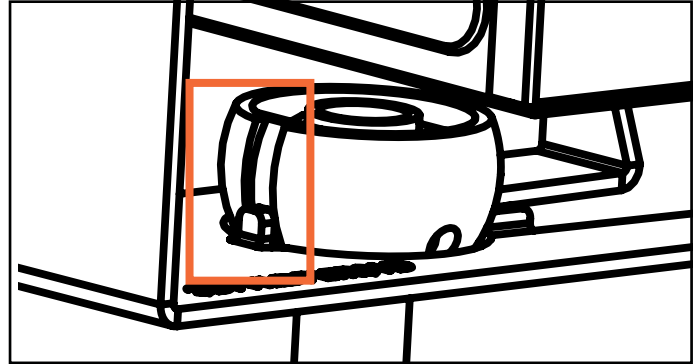

Figure 14b

17. Connect the wire leads as shown in the wiring diagram on page 3

18. Secure back **Canopy Cover (H)** by sliding over stem then pressing against **Canopy Plate (B)**
(Figure 15)

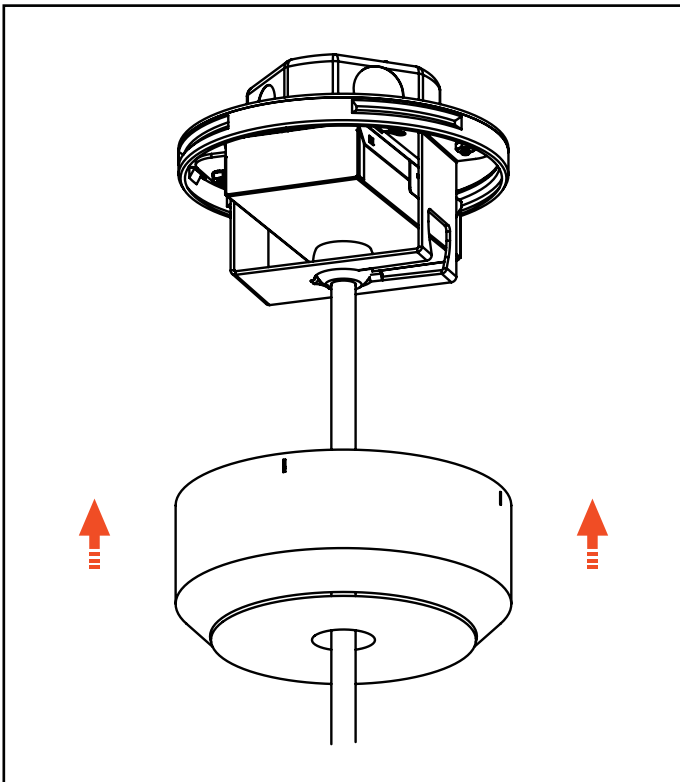

Figure 15

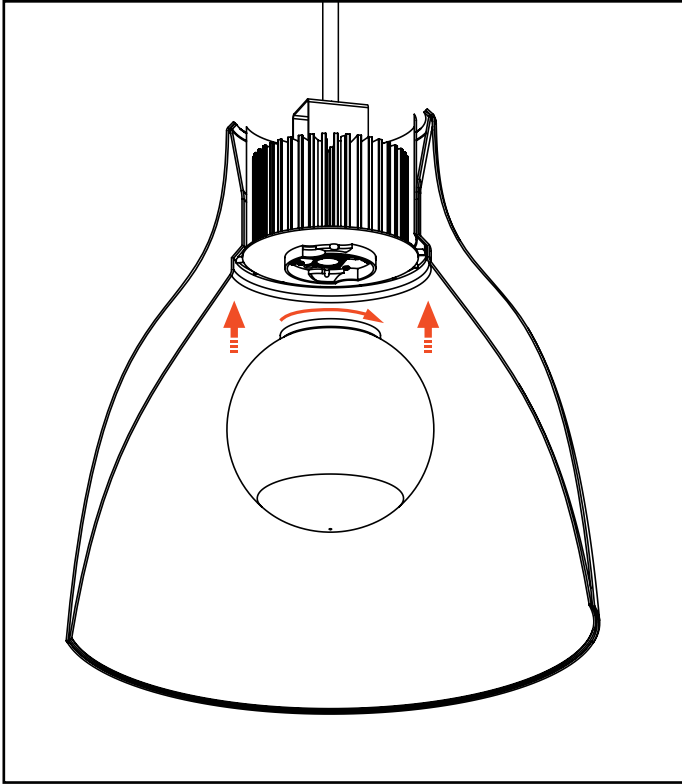

Figure 16

19. Install the optics Globe / Lens from below by turning clockwise and lock into the light engine. May need to hold the top of the light engine assembly or shroud while installing. (Figure 16)

Replacing Shades

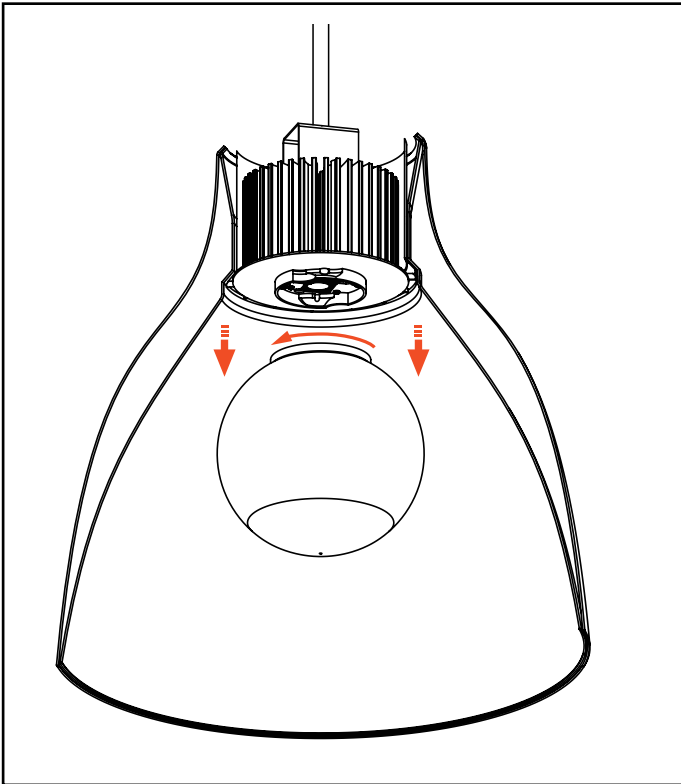

Figure 17

1. Ensure power is off at junction box.
2. Take out the optics Globe / Lens from below by twisting counter clockwise and unlock from the light engine. May need to hold the top of the light engine assembly or shroud while removing. (Figure 17)

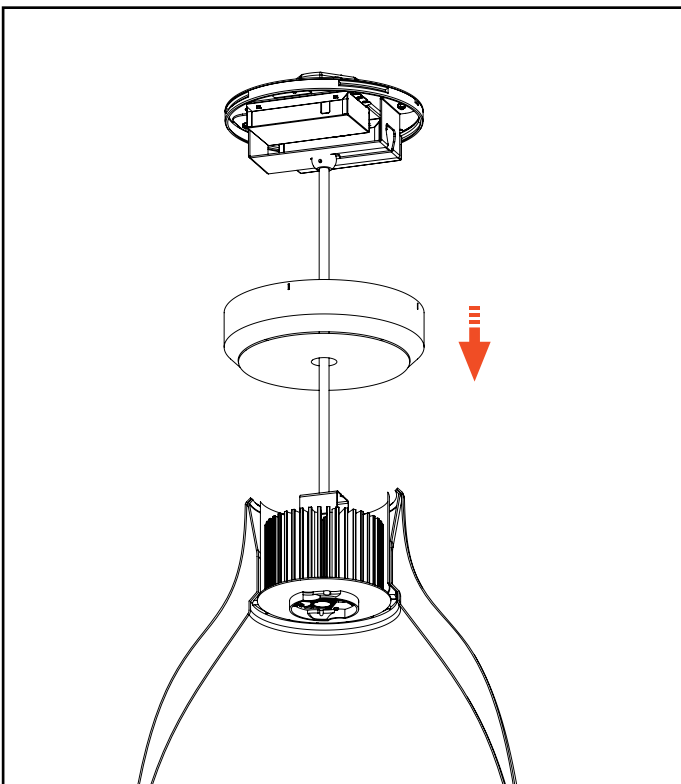

Figure 18

3. Take out the **Canopy Cover (H)** by pulling down (Figure 18)
4. Disconnect the wiring in the canopy assembly (driver to dimming power cord connection)

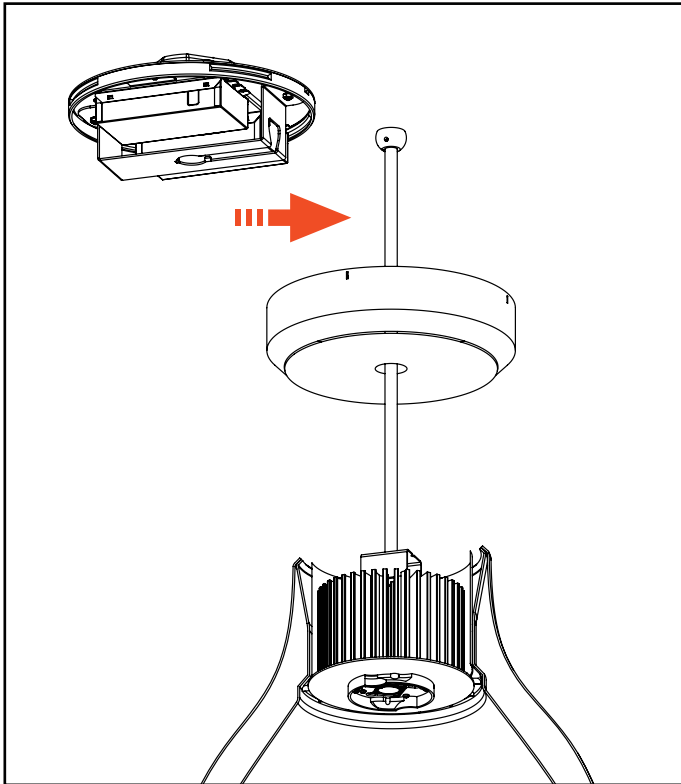

Figure 19

5. Take out the swivel ball end of stem and fixture assembly into swivel support (Fig 19)
6. Take out the **Canopy Cover (H)** from the Stem ball. Carefully take out the shade assembly from the top of the stem by inclining it and sliding over the shroud (Figure 20)
7. Carefully insert the new shade assembly from the top of the stem by inclining it and sliding over the shroud (Figure 21)
8. Place **Canopy Cover (H)** on **Stem (I)**
9. Proceed with steps 16-19 from Light Engine section. (Page 10)

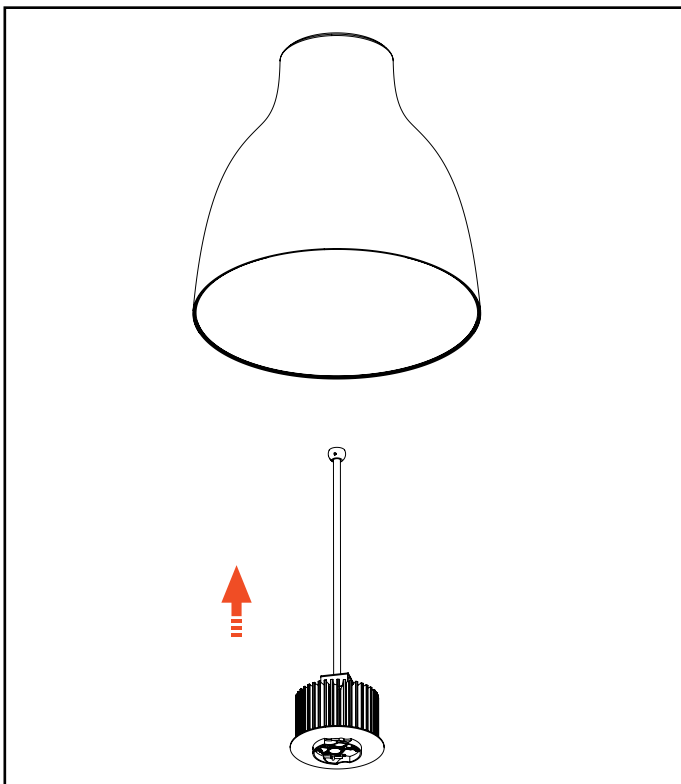

Figure 20

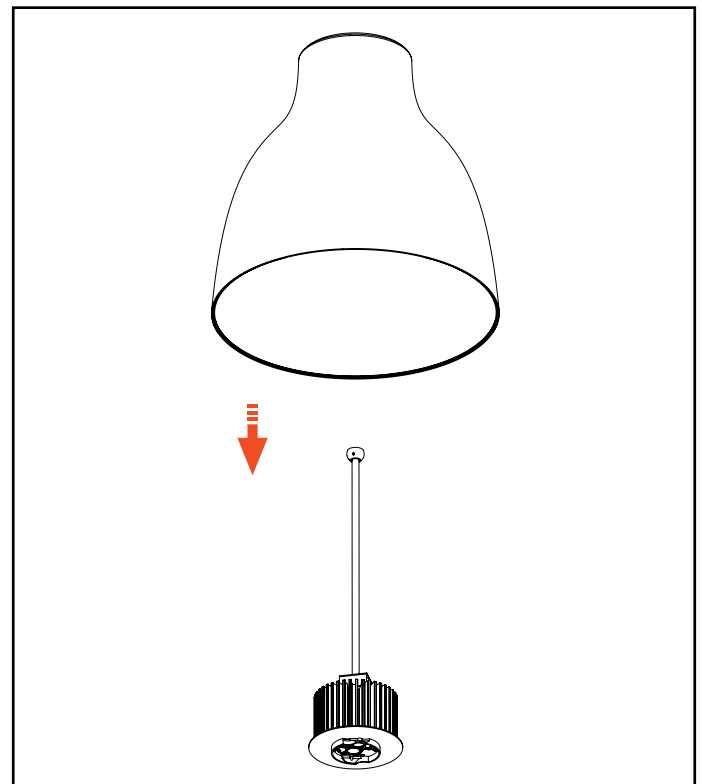

Figure 21

Replacing Drivers

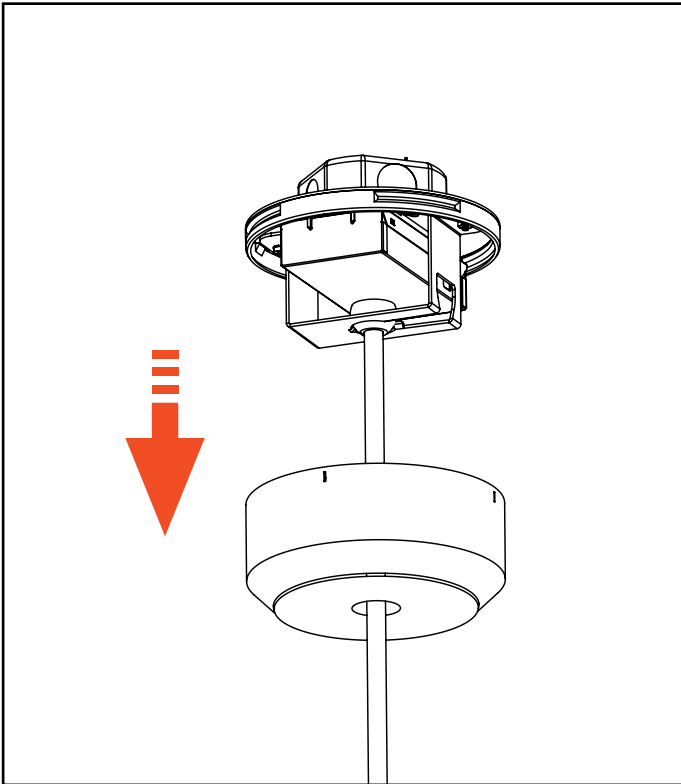

Figure 22

1. Ensure power is off at junction box.
2. Take out the **Canopy Cover (H)** by pulling down (Figure 22)
3. Disconnect the wiring in the canopy assembly (driver to low voltage connection)

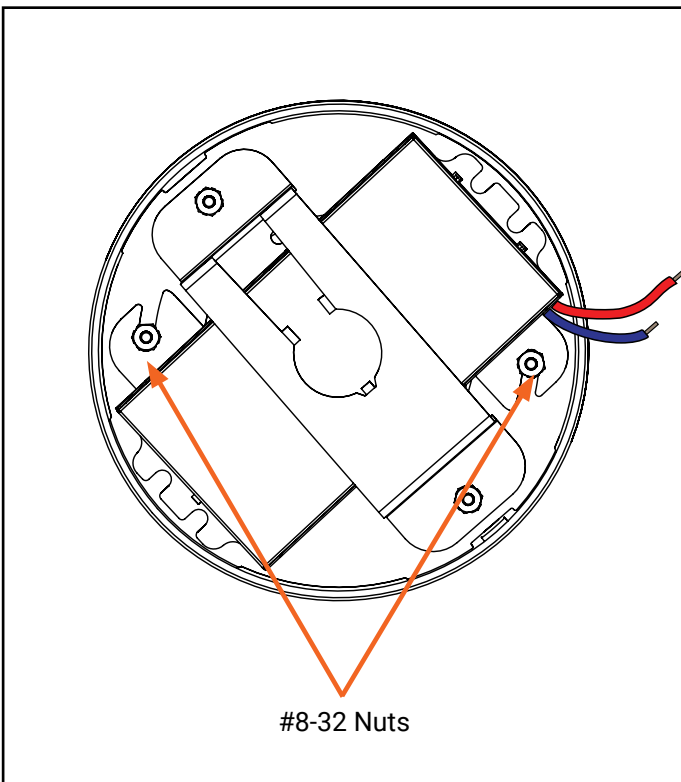

Figure 23

4. Loosen the two **#8-32 nuts (G)** from the **Canopy Plate (B)**. (Figure 23)

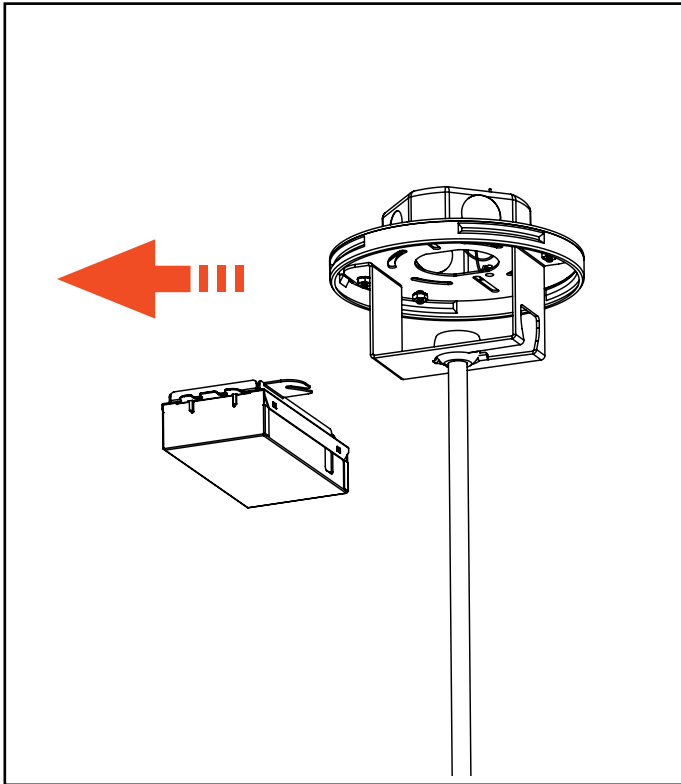

Figure 24

5. Rotate driver subassembly CCW and securely remove.
(Figure 24)
6. Disconnect the electrical connections in the J-Box

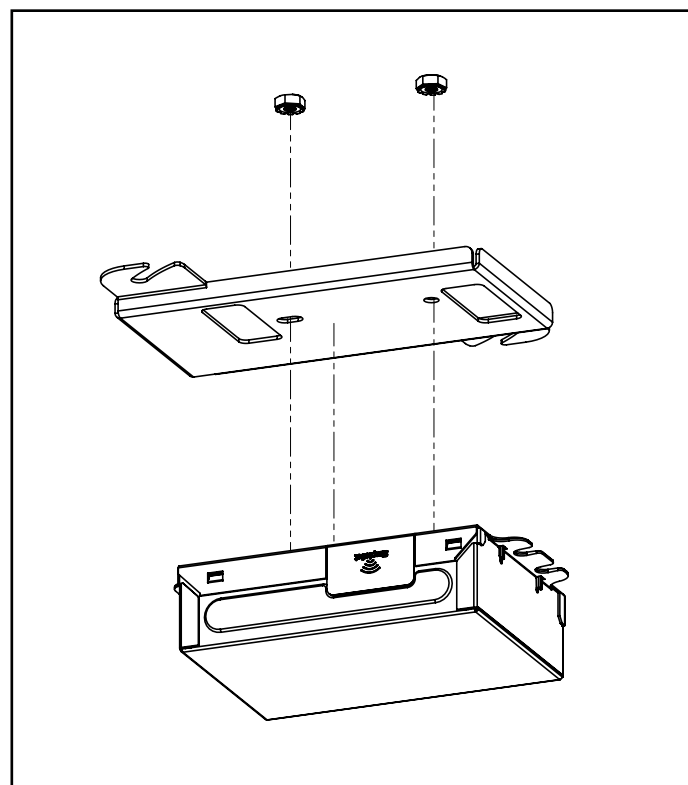
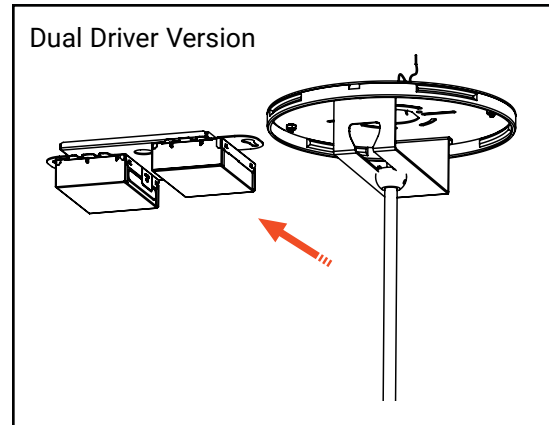

Figure 25

7. Remove two nuts to remove **Driver (E)** from **Driver Enclosure (D)**. Attach new **Driver (E)** to **Driver Enclosure (D)**.
(Figure 25)
8. Take the driver subassembly and make the electrical connections as shown in the wiring diagram on page 3.

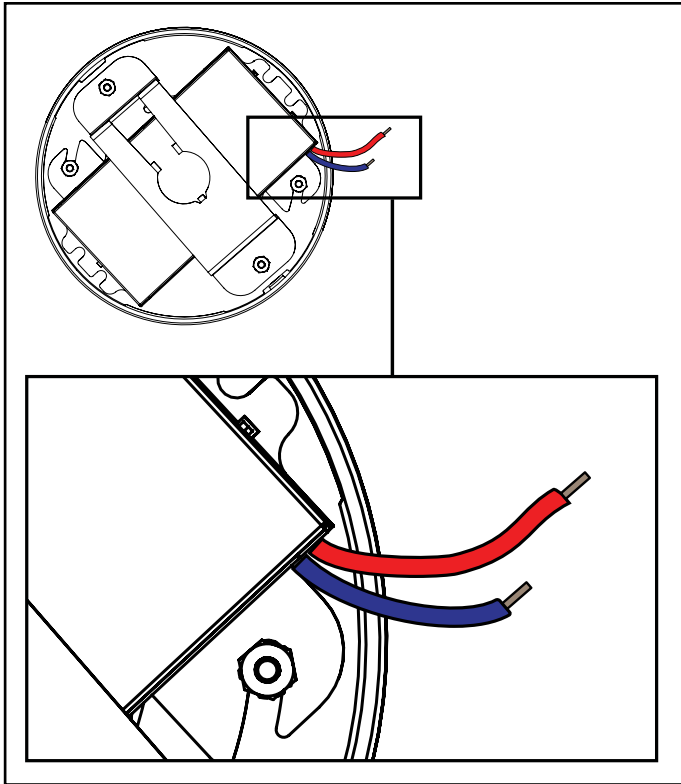

Figure 26

9. Route the Low voltage wire routing (LED wires) from the **Driver Enclosure (D)**. (Figure 26)

10. Reinstall the driver subassembly by aligning with studs and rotate Clockwise. Secure with two **#8-32 nuts (G)**. Make sure wires do not interfere with assembly while rotating. (Figure 27)

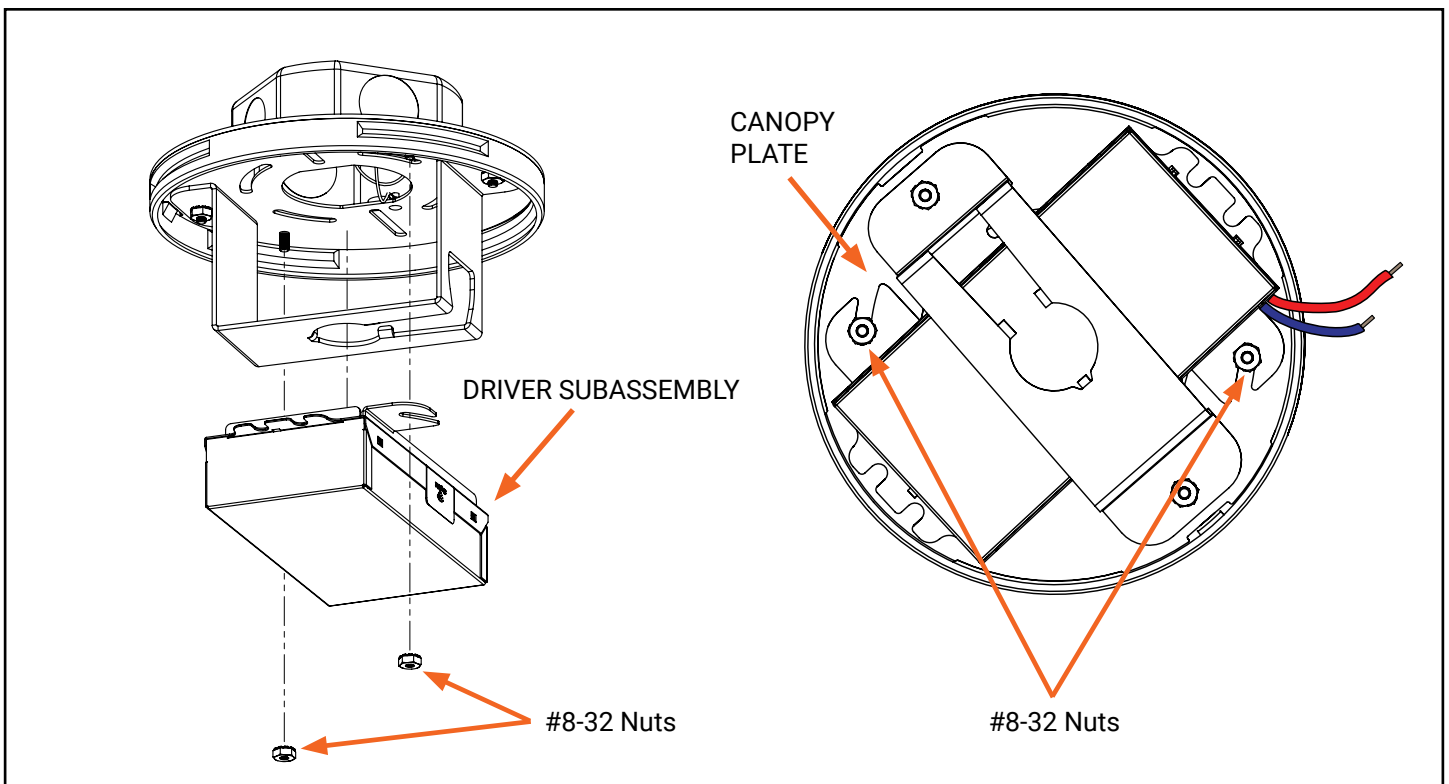

Figure 27

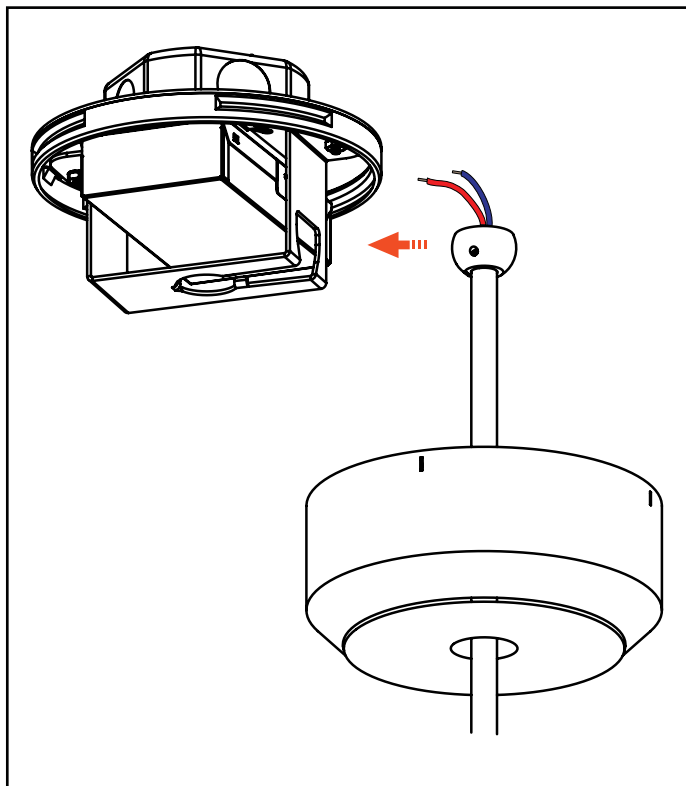

Figure 28

20. Insert swivel ball end of **Stem (I)** and fixture assembly into swivel support on the **Rigid Stem Mounting Bracket (F)**. (Figure 28)

21. Connect the wire leads as shown in the wiring diagram on page 3

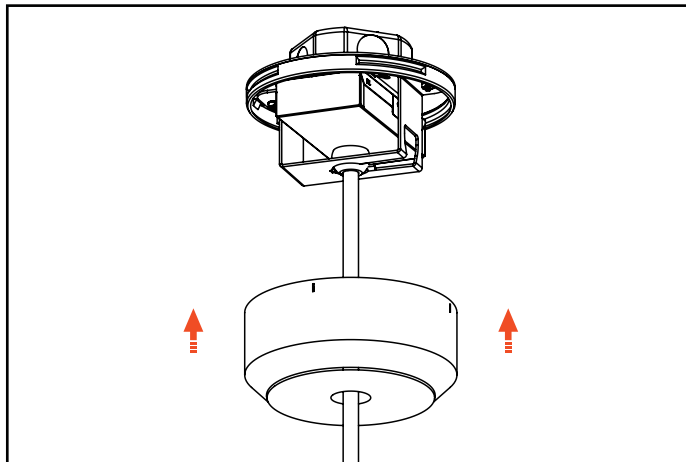

Figure 29

22. Secure back Canopy Cover (H) by sliding over stem then pressing against **Canopy Plate (B)** (Figure 29)

Warranties and Limitation of Liability

Please refer to www.cooperlighting.com/global/warranty for our terms and conditions.

Garanties et limitation de responsabilité

Veuillez consulter le site www.cooperlighting.com/global/warranty pour obtenir les conditions générales.

Garantías y Limitación de Responsabilidad

Visite www.cooperlighting.com/global/warranty para conocer nuestros términos y condiciones.