

## DESCRIPTION

The Paralux III Tannenbaum louver offers designers an exciting new appearance for low brightness recessed applications. The luminaire incorporates a unique European louver design featuring low iridescent specular and Tannenbaum aluminum optical surfaces. This louver integrates into the Paralux III 4-3/4" deep para-contoured housing for optimum performance. The Paralux III series is compatible with all of today's popular ceiling systems and is available with a number of options and accessories to application versatility.

2EP3-IC is rated for installations when the housing is in direct contact with insulation. This is a great visual alternative to traditional recessed luminaires and provides efficient, low glare ambient lighting.

## SPECIFICATION FEATURES

### Construction

4-3/4" deep, para-contoured housing, die formed code gauge, prime cold rolled steel. Die embossed housing has full length die formed stiffeners for added strength. Contoured ballast/wireway cover is easily removed without tools. Die formed captive lampholder bracket fully encloses lampholder wiring permitting easy lampholder replacement. Heavy end plates are securely attached with interlocking tabs and screws. Four auxiliary fixture end suspension points provided. KO's for continuous row wiring. End plates have integral Grid-Lock feature for safety and convenience.

### Electrical\*\*

Ballast are CBM/ETL Class "P" and positively secured. 2G11 base lampholders have double-edge wiping action pressure lock contacts with vertically oriented lamp support clips. UL/CUL listed for Type IC Recessed Luminaire (Rated for direct contact with insulation). Suitable for damp locations.

### Finish

Lighting grade, baked white enamel finish. Multistage, iron phosphate pretreatment ensures maximum bonding and rust inhibition.

### Hinging/Latching

Positive spring loaded, self locking, steel latches. Safety lock T-hinges allow hinging and latching from either side.

### Louver

Die formed of low iridescent anodized specular and Tannenbaum aluminum. Finish is anodic oxide coating. Accurate precision contours are held in place with interlocking feature. True cut mitered corners. Black reveal with integral mechanical light seal around entire perimeter of louver. Louver protected from construction contaminants by poly cover.

### Compliance

Options to meet Buy American Act requirements.

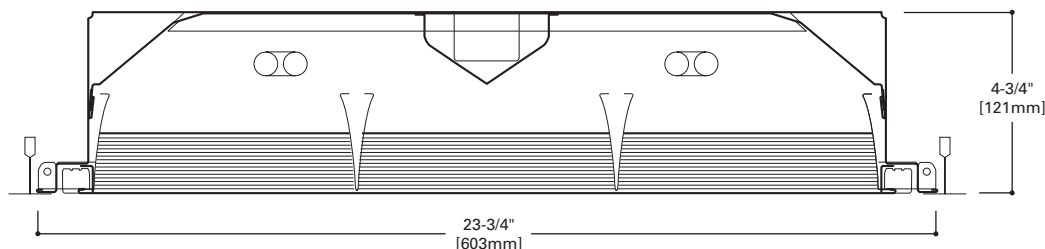

## MOUNTING DATA

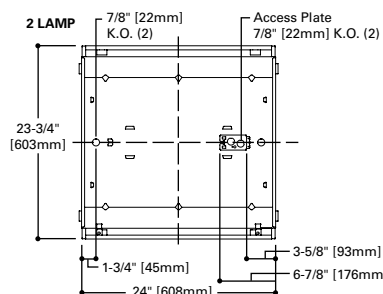

## LAMP CONFIGURATIONS

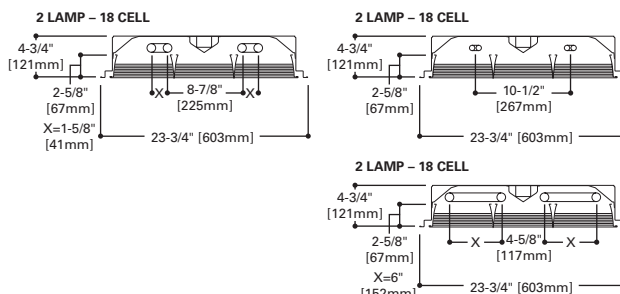

## CEILING COMPATIBILITY

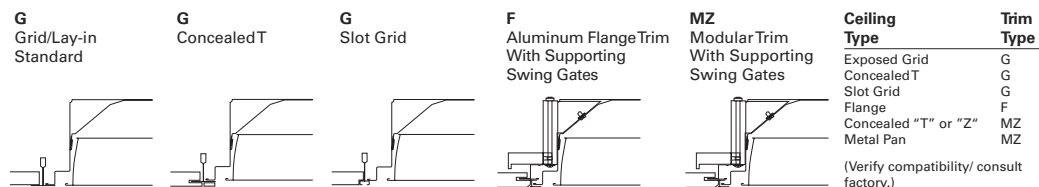

**2EP3GAX-IC**  
**2U6T8, 2U1-5/8,**

**18 Cell**

**2' X 2' PARABOLIC**  
**2 LAMP**  
**TANNENBAUM LOUVER**

Paralux III  
Recessed Static or  
Air Supply Troffer

For Use in  
Insulated Ceilings

**TANNENBAUM™**



## ENERGY DATA

Input Watts:  
**EB Ballast & STD Lamps**  
2U6T8 (61), 2U1-5/8 (61)

\*\*Reference the lamp/ballast data in the Technical Section for specific lamp/ballast requirements.

**LINEAR DISCONNECT**

Designed to provide safe and convenient means of disconnecting power

## ORDERING INFORMATION

SAMPLE NUMBER: 2EP3GAX-IC-2BX40ST36-120V-EB51-U

<b>Domestic Preferences</b> <sup>(10)</sup> <b>[Blank]</b> =Standard <b>BAA</b> =Buy American Act  <b>Rating</b> <b>Blank</b> =Standard <b>ATW-SW4</b> =Chicago Rated  <b>HR</b> =Heat Removal <sup>(11)</sup>  <b>Width</b> <b>2=2'</b> Width  <b>EP</b> =Paralux Louver  <b>3=3"</b> Louver Depth  <b>Trim Type</b> <b>G</b> =Grid/Lay-in (Standard) <b>G</b> =Concealed T/Slot Grid <sup>(6)</sup> <b>F</b> =Aluminum Flange Trim <sup>(7)</sup> <b>MZ</b> =Modular Trim  <b>AX</b> =Air Supply Floating Louver <b>X</b> =Blank Side/Floating Louver - Non-Air Supply (Omit A) <b>AVX</b> =Air Supply Floating Louver with Directional Air Vane (Add V)  <b>IC</b> =IC Rated	<b>Number of Lamps</b> <b>2=2</b> Lamps  <b>Wattage (Length)</b> <b>U6T8</b> =32W T8 (24") <b>U15/8</b> =31W T8 (24")  <b>Louver Color/Type</b> <b>ST</b> =Silver Tannenbaum  <b>Cell Configuration</b> <b>36=3</b> Rows of 6, 18 Cell  <b>Option – Aluminum Flange Trim</b> <sup>(7)</sup> <b>Blank</b> =SW (Single White) Type                      Color 'S' Single                'N' Natural 'R' In Row                'W' White 'E' End of Row	<b>Voltage</b> <sup>(3)</sup> <b>120V</b> =120 Volt <b>277V</b> =277 Volt <b>347V</b> =347 Volt <b>UNV</b> =Universal Voltage 120-277 <sup>(4)</sup>  <b>Options</b> <b>GL</b> =Single Element Fuse <b>GM</b> =Double Element Fuse <b>WTR</b> =White Reveal  <b>Flex</b> =Flex Installed (Reference Flex ordering information) <b>EL</b> =Emergency Installed <sup>(5), (9)</sup>	<b>Ballast Type</b> <b>EB8</b> = T8 Electronic Start. Total Harmonic Distortion < 10% No. of Ballast 1, 2 or 3 <b>EB8 /PLUS</b> = T8 Electronic Start. Total Harmonic Distortion < 10% High Ballast Factor >1.15 No. of Ballast 1, 2 or 3 <b>ER8</b> =T8 Electronic Program Rapid Start. Total Harmonic Distortion < 10% No. of Ballast 1, 2 or 3	<b>Options</b> <b>PAF</b> =Painted After Fabrication  <b>REP</b> =Riveted Endplates  <b>Packaging</b> <b>U</b> =Unit Pack <b>PAL</b> =Job Pack, out of carton <b>PALC</b> =Job Pack, in carton
--	--	---	---	--

ACCESSORIES<sup>(11)</sup>EQ-CLIP-U=T-BAR Safety Earthquake Clips<sup>(2)</sup>

**NOTES:** <sup>(1)</sup> Integral end plate grid lock feature not available in heat removal. <sup>(2)</sup> An EQ Grid Clip is recommended for all 9/16" ceiling systems. Four required per fixture. <sup>(3)</sup> Products also available in non-US voltages and frequencies for international markets. <sup>(4)</sup> Not available when specifying emergencies, voltage must be specific. <sup>(5)</sup> Fixtures equipped with "EL" option may require a 5-1/2" housing depth. If installing in field, must use low profile battery pack. <sup>(6)</sup> Louver is recessed by 5/16" in Concealed T or Slot Grid T. <sup>(7)</sup> Specify row configuration, type in catalog number when ordering complete fixture. <sup>(8)</sup> Please specify required voltage, 120V or 277V. <sup>(9)</sup> Only product configurations with this designated prefix are built to be compliant with the Buy American Act of 1933 (BAA). Please refer to [DOMESTIC PREFERENCES](#) website for more information. Components shipped separately may be separately analyzed under domestic preference requirements. <sup>(11)</sup> Accessories sold separately will be separately analyzed under domestic preference requirements. Consult factory for further information.

Specifications & dimensions subject to change without notice. Consult your Cooper Lighting Solutions Representative for availability and ordering information.

## SHIPPING DATA

Catalog No.	Wt.
2EP3GAX-IC-2U1-5/8ST36	28 lbs.
2EP3GAX-IC-2U6T8ST36	28 lbs.