

DESCRIPTION

The PMX series features the latest in energy efficient technology. The surface mount luminaire incorporates a 2", 4" or 5" deep precision cell louver into a nominal 6-11/16" modular fixture housing. This combination creates a total high performance parabolic optical assembly for optimum performance. The series is available with a number of options and accessories for application versatility. The high performance luminaire is designed to offer maximum efficiency and performance for today's unique interior specifications. The PMX series is an excellent choice for commercial office spaces, schools, hospitals or retail merchandising areas.

SPECIFICATION FEATURES

Construction

Nominal 6-11/16" housing die formed of code gauge prime cold rolled steel. Smooth sides permit flush joint for continuous row mounting. Full seam welded corners. Dihedral recessed top design insures cooler ballast operation. Die formed captive lampholder bracket fully enclosed wiring permitting easy lampholder replacement. Ballast/wireway covers removed without tools.

Electrical**

Ballasts are CBM/ETL Class "P" and

are positively secured by mounting bolts. Pressure lock lampholders. UL/CUL listed. Suitable for damp locations.

Finish

Painted after fabrication. Electrostatically applied baked white polyester powder enamel finish. Multistage cleaning cycle, iron phosphate coating with rust inhibitor.

Hinging/Latching

Positive cam action spring loaded, self locking, black steel latches.

| | | |
|--------------------|--|-------------|
| Catalog # | | Type |
| Project | | |
| Comments | | Date |
| Prepared by | | |

Positive hinging. Safety chains provided.

Louver

Die formed of low iridescent, vertical grain anodized aluminum. Finish is Anodic oxide coating. Accurate precision parabolic cells are held in place with interlocking feature. True-cut mitered corners. Black reveal with integral mechanical light seal around entire perimeter of louver. Louver protected from construction contaminants by polyethylene cover.



PMX
132
232

8 or 16 Cell

1' X 4' PARABOLIC
1 OR 2 LAMP
SEMI-SPECULAR OR
SPECULAR LOUVER

Paralux II, IV and V
Surface Modular

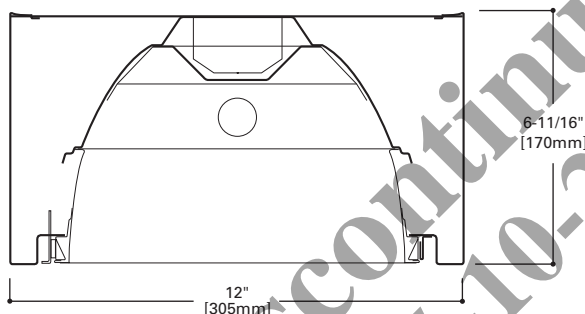

MOUNTING DATA

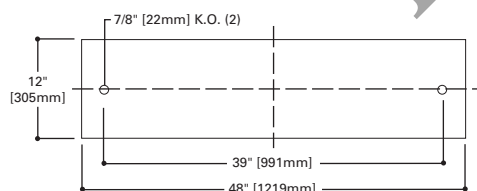

STEM MOUNTING DATA

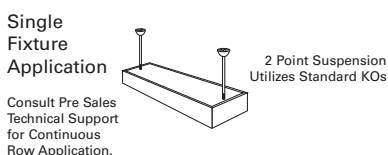

LAMP CONFIGURATIONS

Paralux II (2" Louver)

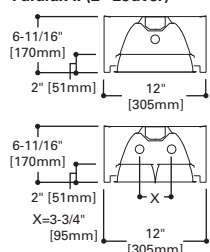

Paralux IV (4" Louver)

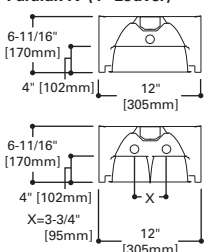

Paralux V (5" Louver)

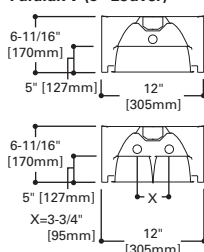

ENERGY DATA

Input Watts:
EB Ballast & STD Lamps
132 (30)
232 (61)

ES Ballast & STD Lamps
132 (37)
232 (71)

Luminaire Efficacy Rating

LER = FP-54

Catalog Number: PMX-132
Yearly Cost of 1000 lumens,
3000 hrs at .08 KWH = \$4.48

**Reference the lamp/ballast data in the Technical Section for specific lamp/ballast requirements.

LAMPS CONTAIN MERCURY. DISPOSE ACCORDING TO LOCAL, STATE OR FEDERAL LAWS

LINEAR DISCONNECT

Safe and convenient means of disconnecting power.

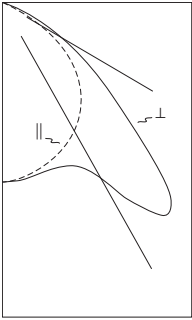

PMX-132S18I
Electronic Ballast
(1) 32WT8 Lamp
2800 Lumens

Spacing criterion:
(||) 1.2 x mounting height,
(⊥) 1.8 x mounting height
Efficiency 65.2%

Test Report:
ITL49390

LER = FP54

Yearly Cost of 1000 lumens, 3000 hrs at .08 KWH = \$4.48

Coefficients of Utilization

| rc | Effective floor cavity reflectance | | | | | | | | | | | | | | | | | |
|------------|------------------------------------|----|----|----|-----|----|----|----|-----|----|----|----|----|----|----|----|----|----|
| | 80% | | | | 70% | | | | 20% | | | | 0% | | | | | |
| rw | 70 | 50 | 30 | 10 | 70 | 50 | 30 | 10 | 50 | 30 | 10 | 50 | 30 | 10 | 50 | 30 | 10 | 0 |
| RCR | | | | | | | | | | | | | | | | | | |
| 0 | 78 | 78 | 78 | 78 | 76 | 76 | 76 | 76 | 73 | 73 | 73 | 69 | 69 | 69 | 67 | 67 | 67 | 65 |
| 1 | 73 | 70 | 68 | 66 | 71 | 69 | 67 | 65 | 66 | 64 | 63 | 64 | 62 | 61 | 61 | 60 | 59 | 58 |
| 2 | 67 | 63 | 59 | 56 | 66 | 62 | 58 | 55 | 59 | 57 | 54 | 57 | 55 | 53 | 55 | 54 | 52 | 51 |
| 3 | 62 | 56 | 52 | 48 | 60 | 55 | 51 | 48 | 53 | 50 | 47 | 52 | 49 | 46 | 50 | 47 | 45 | 44 |
| 4 | 57 | 50 | 45 | 41 | 56 | 49 | 45 | 41 | 48 | 44 | 41 | 46 | 43 | 40 | 45 | 42 | 40 | 38 |
| 5 | 53 | 45 | 40 | 36 | 51 | 45 | 40 | 36 | 43 | 39 | 36 | 42 | 38 | 35 | 41 | 37 | 35 | 34 |
| 6 | 49 | 41 | 35 | 32 | 48 | 40 | 35 | 32 | 39 | 35 | 31 | 38 | 34 | 31 | 37 | 34 | 31 | 30 |
| 7 | 45 | 37 | 32 | 28 | 44 | 37 | 31 | 28 | 36 | 31 | 28 | 35 | 31 | 28 | 34 | 30 | 27 | 26 |
| 8 | 42 | 34 | 29 | 25 | 41 | 33 | 28 | 25 | 32 | 28 | 25 | 32 | 28 | 25 | 31 | 27 | 24 | 23 |
| 9 | 39 | 31 | 26 | 22 | 38 | 30 | 26 | 22 | 30 | 25 | 22 | 29 | 25 | 22 | 28 | 25 | 22 | 21 |
| 10 | 37 | 28 | 23 | 20 | 36 | 28 | 23 | 20 | 27 | 23 | 20 | 27 | 23 | 20 | 26 | 23 | 20 | 19 |

Zonal Lumen Summary

| Zone | Lumens | %Lamp | %Fixture |
|-------|--------|-------|----------|
| 0-30 | 553 | 19.8 | 30.3 |
| 0-40 | 998 | 35.6 | 54.7 |
| 0-60 | 1749 | 62.5 | 95.8 |
| 0-90 | 1825 | 65.2 | 100.0 |
| 0-180 | 1825 | 65.2 | 100.0 |

Typical VCP Percentages

| Room Size (Ft.) | Height Along | | Height Across | |
|-----------------|--------------|-------|---------------|-------|
| | 8.5' | 10.0' | 8.5' | 10.0' |
| 20 x 20 | 90 | 88 | 86 | 82 |
| 30 x 30 | 93 | 91 | 90 | 87 |
| 30 x 60 | 93 | 92 | 91 | 88 |
| 60 x 30 | 93 | 91 | 90 | 87 |
| 60 x 60 | 94 | 92 | 91 | 88 |

Candela

| Angle | Along | 45° | Across ⊥ |
|-------|-------|-----|----------|
| 0 | 700 | 700 | 700 |
| 5 | 697 | 694 | 697 |
| 10 | 682 | 684 | 691 |
| 15 | 657 | 664 | 681 |
| 20 | 627 | 641 | 685 |
| 25 | 595 | 623 | 723 |
| 30 | 559 | 623 | 847 |
| 35 | 516 | 656 | 1014 |
| 40 | 462 | 731 | 995 |
| 45 | 392 | 732 | 718 |
| 50 | 305 | 551 | 504 |
| 55 | 199 | 297 | 332 |
| 60 | 96 | 141 | 213 |
| 65 | 32 | 52 | 89 |
| 70 | 16 | 18 | 30 |
| 75 | 8 | 9 | 14 |
| 80 | 2 | 2 | 6 |
| 85 | 1 | 0 | 1 |
| 90 | 0 | 0 | 0 |

ORDERING INFORMATION

SAMPLE NUMBER: PMX-132S18I-120V-EB81-U

Width
Blank=1' Width

P=Parabolic

Louver Depth
2=Paralux II
Blank=Paralux IV
5=Paralux V

MX=Surface Mount/Floating Louver

Number of Lamps
1 or 2 lamps
(Not included)

Wattage (Length)
32=32W Ocntron T8 (48")

Louver Color
S=Silver
G=Gold
W=White

Cell Configuration
18=1 Row of 8, 8 Cell
28=2 Rows of 8, 16 Cell

Louver Finish
H=Semi-Specular/Haze (Gold only)
I=Semi-Specular/Haze (Low Iridescent) Standard
M=Specular/Mirrored (Low Iridescent)
P=Painted

Options
GL=Single Element Fuse
GM=Double Element Fuse
EL=Emergency Installed⁽³⁾

Voltage ⁽¹⁾
120V=120 Volt
277V=277 Volt
347V=347 Volt
UNV=Universal Voltage 120-277 Volt⁽²⁾

Ballast Type⁽¹⁾
EB8 =T8 Electronic Instant Start.
Total Harmonic Distortion < 10%
No. of Ballast
1 or 2

EB8 /PLUS=T8 Electronic Instant Start.
High Ballast Factor >1.13.
Total Harmonic Distortion < 20%
No. of Ballast
1 or 2

ER8 =T8 Electronic Program Rapid Start.
Total Harmonic Distortion < 10%
No. of Ballast
1 or 2

Options
(Additional options available. See Accessory Section)

Packaging
U=Unit Pack

SHIPPING DATA

| Catalog No. | Wt. |
|-------------|---------|
| PMX-132S18I | 29 lbs. |
| PMX-232S18I | 29 lbs. |
| PMX-232S28I | 29 lbs. |

NOTES: ⁽¹⁾ Products also available in non-US voltages and frequencies for international markets.⁽²⁾ Not available when specifying emergencies, voltage must be specific.
⁽³⁾ Please specify required voltage, 120V or 277V.

For complete product data, reference the Fluorescent Specification binder. Specifications & dimensions subject to change without notice. Consult your Cooper Lighting Solutions Representative for availability and ordering information.

Discontinued
25-10-2023