

Project		Catalog #		Type	
Prepared by		Notes		Date	



WaveLinx Wired

LCNJ - Lighting Control Network Jack

Allows connection to the WaveLinx Wired lighting control system

Typical Applications

Office • Education • Healthcare • Hospitality • Retail

Interactive Menu

- Order Information [page 2](#)
- Additional Resources [page 3](#)
- Wiring Diagrams [page 3](#)
- Connected Systems [page 5](#)
- Product Warranty

Product Certification



Product Features



Top Product Features

- Device allows access to the iLumin lighting control network while in the space where the lighting levels are being modified
- It is preferred to be in the space being modified when setting and saving light levels to create different moods/ atmospheres
- Decorator screwless wallplate included

Dimensional Details

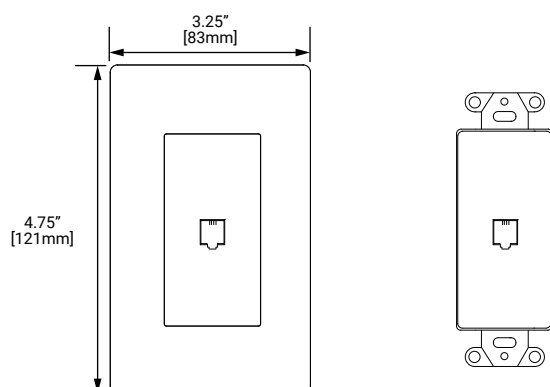

Order Information

Catalog Number

Catalog Number	Description
LCNJ-W	Lighting Control Network Jack, White
LCNJ-B	Lighting Control Network Jack, Black
LCNJ-V	Lighting Control Network Jack, Ivory

Product Specifications

Key Features

- Allows connection to the WaveLinx Wired control system
- Decorator screwless wallplate included

Mechanical

Environment:

- **Operating temperature:** 32°F to +104°F (0°C to 40°C)
- **Relative humidity operating:** 0% - 90% non-condensing
- For indoor use only

Mounting: Suitable for standard single and multi-gang NEMA wall box with decorator style wallplate

Electrical

- **Supply:** 12Vdc via the iCANnet network
- **iCANnet connection:** wire leads

Standards/Ratings

- cULus Listed

Environmental Regulations:

- RoHS Directive 2011/65/EU

Warranty

Five year warranty standard

Wiring Diagram

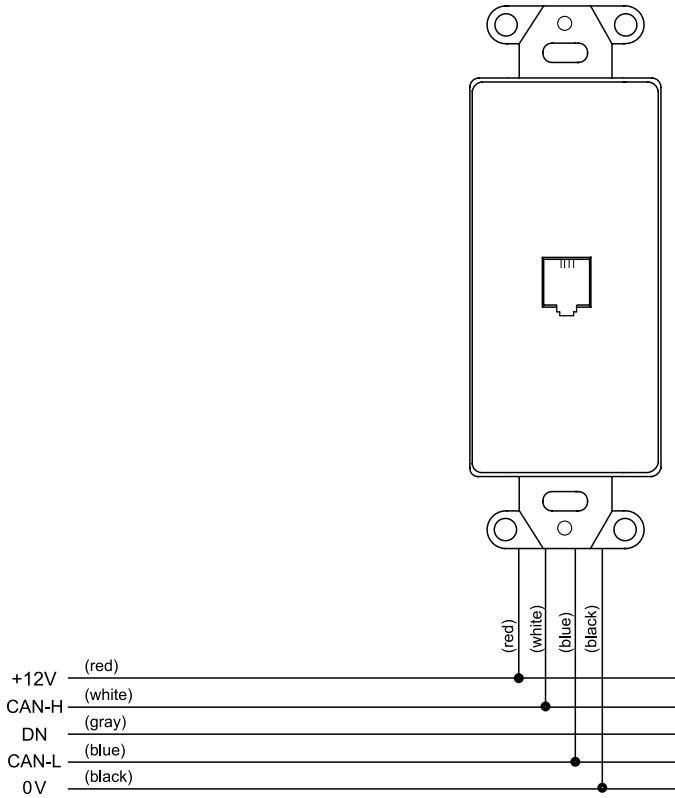

Sample System Topology

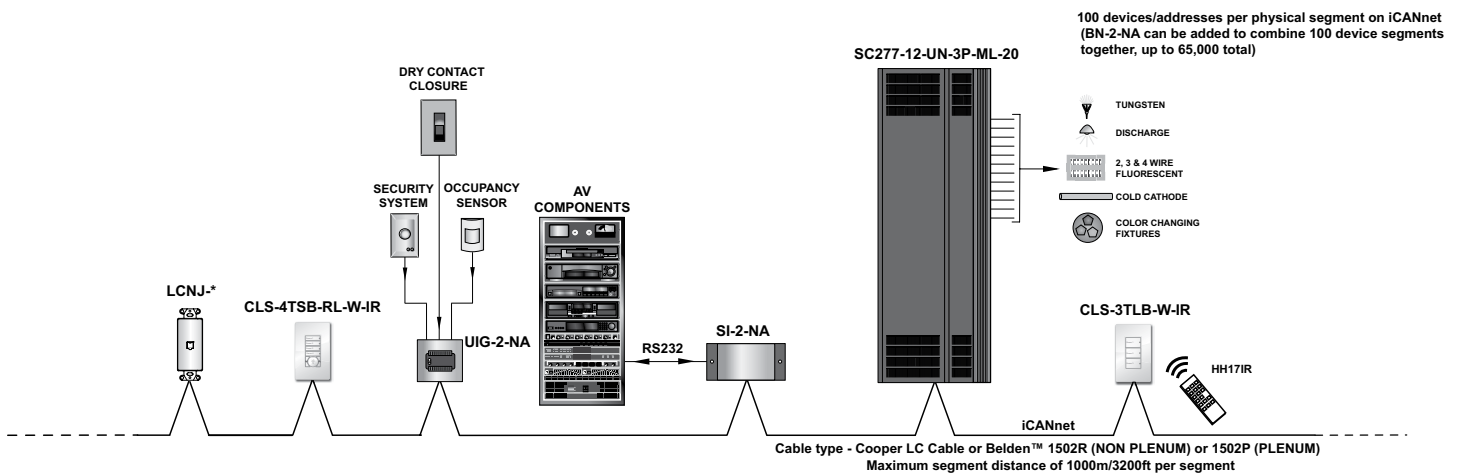

System architecture

Simple WaveLinX wired system

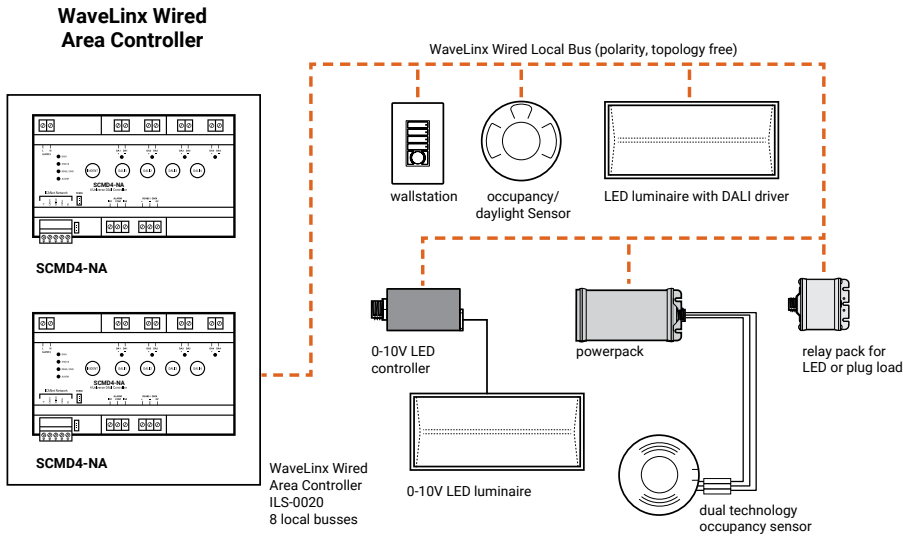

Complete WaveLinX wired system

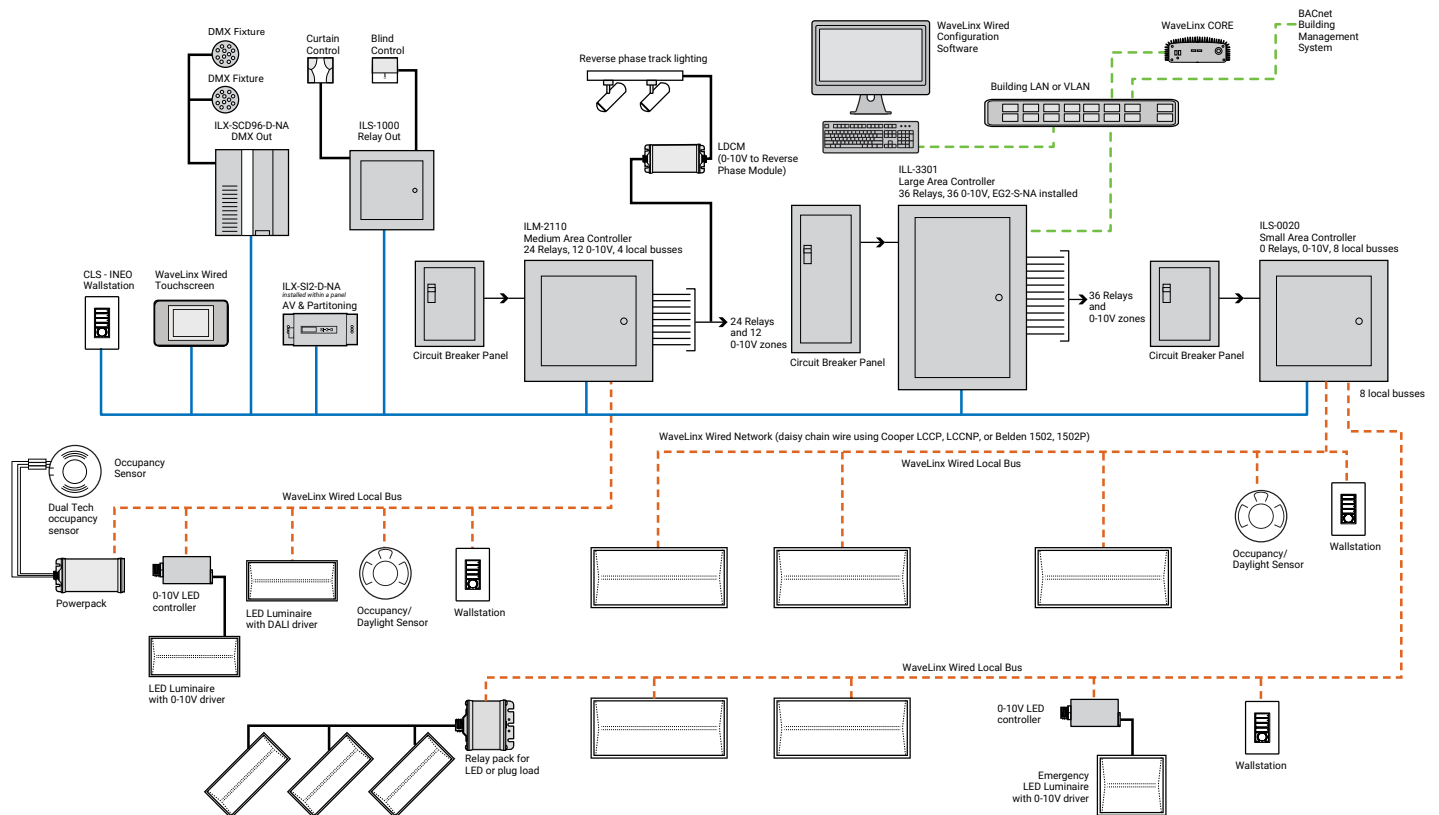

Sample System Topology:

This diagram shows the main components of the WaveLinX wired and PRO wireless connected lighting system.

The **WaveLinX PRO wireless system** communicates using wireless mesh technology based on the IEEE 802.15.4 standard. A PoE LAN connection for each WaveLinX Area Controller (WAC) is required for power and data access to the building lighting network.

The **WaveLinX wired system** controls the devices using relay, 0-10V, DMX and the WaveLinX wired digital local bus. The WaveLinX wired system connects to the building LAN using the EG2 module. Each WaveLinX wired area controller communicates on the WaveLinX wired network.

WaveLinX Area Controllers (WAC) and WaveLinX Ethernet Gateways (EG2) communicate with WaveLinX CORE over the Ethernet network.

Please refer to the WaveLinX PRO Wireless Network and IT Guidance Technical Guide and WaveLinX Wired Network and IT Guidance Technical Guide for more information.

[View WaveLinX Network and IT Guidance Technical Guide](#)

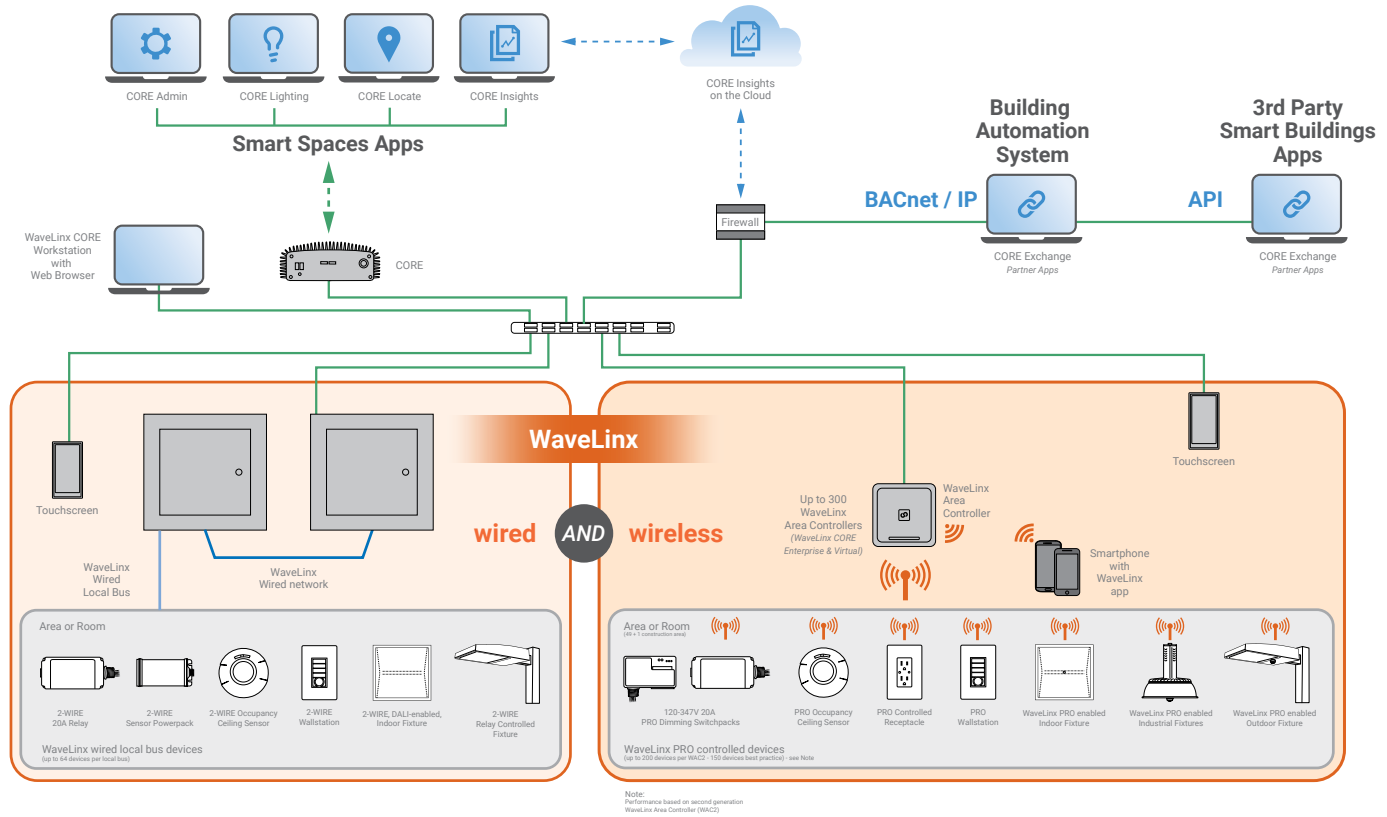

Control Systems

- WaveLinX
- WaveLinX wired
- VividTune