

INSTALLATION INSTRUCTIONS

IMPORTANT: READ BEFORE REMOVING FIXTURE FROM CARTON. RETAIN FOR FUTURE REFERENCE.



SAFETY: This fixture must be wired in accordance with the national electrical code and applicable local codes and ordinance. Proper grounding is required to insure personal safety. Carefully observe grounding procedure under installation section. All work should be done by a qualified electrician.

WARNING: Make certain power is OFF before starting installation or attempting any maintenance. Risk of fire/electric shock. If not qualified, consult an electrician.

- **RISK OF ELECTRIC SHOCK** – Disconnect power at fuse or circuit breaker before installing or servicing.
- **RISK OF BURN** – Disconnect power and allow fixture to cool before servicing.
- **RISK OF PERSONAL INJURY** – Fixture may become damaged and/or unstable if not installed properly. Tighten all fixture components to their recommended torque values.

WARNING: Make certain power is OFF before starting installation or attempting any maintenance.

SLIPFITTER MOUNT INSTRUCTIONS

TOOLS REQUIRED: 3/16 Allen wrench 9/16 Open end, Box or Adjustable Wrench 5/64 Allen wrench Torque wrench.

- Make sure Pivot Gasket is in place on Pivot Flange with the #8-32 x 3/8" long set screws extended 1/2 way through the Pivot Gasket.
- Feed fixture wires through the 3/4" NPT (National Pipe Thread Tapered) hole on the slipfitter, using a pipe sealing system screw Slipfitter onto the Pivot until a torque of 300 inch pounds is reached.
- Tighten the (2) #8-32 x 3/8" long Allen set screw to 20 inch pounds using 5/64" Allen wrench.
- Locate fixture with slipfitter near 2 3/8" tenon to be used, with supply wires extending out of tenon (if your installation has splice compartment access, see step D1). Splice power supply leads to fixture leads making sure to ground the fixture in a manner that complies with the National Electric Code and applicable to local codes. DO NOT USE POLE AS GROUND. Push wiring into tenon while lowering slipfitter over tenon, being careful not to pinch wiring between slipfitter and tenon.
- POLE WITH WIRE SPLICE ACCESS NEAR TENON. Lower fixture over tenon with wires extending into tenon being careful not to pinch wires between slipfitter and tenon. Make power supply splices through access opening as described above.
- Aiming and Securing fixture. Using a 3/16 Allen Wrench, tighten 3/8" set screws evenly (screws must be loose enough to allow rotation of slipfitter). Rotate fixture on tenon to the desired position. Tighten the (3) Slipfitter Set Screws to 200 inch pounds. Loosen pivot lock bolt, tilt fixture to desired angle, tighten knuckle lock bolt to 200 inch pounds torque.

KNUCKLE MOUNT INSTRUCTIONS

TOOLS REQUIRED: 5/64 Allen wrench 3/16 Allen wrench Torque wrench Channel lock pliers or 1-1/2" open face wrench or adjustable wrench.

- Make sure the Pivot Gasket is in place on the Pivot Flange with the #8-32 x 3/8" set screw extending half way through the pivot gasket. Feed wires through 1-1/8" mounting hole. Place the large lock washer over the 3/4" NPT nipple on the back side of the mounting surface. Screw the 3/4" NPT locknut onto the pipe nipple, rotate fixture to desired location and tighten to 800 inch pounds. (See A1 if mounting Knuckle into NPT cover or flange.)
- Feed fixture wires through the 3/4" NPT pipe opening. Using a pipe sealing system thread Knuckle and pipe fitting together until tight and aimed horizontally in the desired direction. To aim the fixture in the vertical angle loosen the Knuckle Lock Bolt, adjust angle, and tighten Knuckle Lock Bolt to 200 inch pounds.
- Tighten the (2) #8-32 x 3/8" long Allen set screws to 20 inch pounds with a 5/64 Allen wrench.
- Loosen the Knuckle Lock Bolt using a 3/16 Allen Wrench. Adjust the fixture angle and tighten the Knuckle Lock Bolt to 200 inch pounds.

NOTE: When this fixture is installed on bridges or overpasses (locations with vibration), drill two depressions in mounting surface to correspond with the two 8-32 set screws on the pivot flange.

These instructions do not claim to cover all details or variations in the equipment, procedure, or process described, nor to provide directions for meeting every possible contingency during installation, operation or maintenance. When additional information is desired to satisfy a problem not covered sufficiently for user's purpose, please contact your nearest representative. **NOTE:** Specifications and dimensions subject to change without notice.

Customer First Center
1121 Highway 74 South
Peachtree City, GA 30269
P: 770.486.4800 F: 770.486.4801
www.cooperlighting.com

INSTALLATION INSTRUCTIONS

IMPORTANT: READ BEFORE REMOVING FIXTURE FROM CARTON. RETAIN FOR FUTURE REFERENCE.

WARNING: Make certain power is OFF before starting installation or attempting any maintenance.

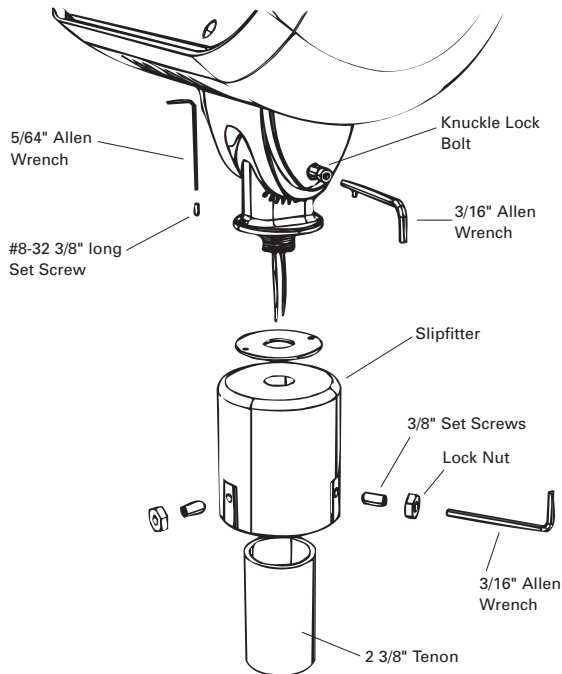

Slipfitter Mount

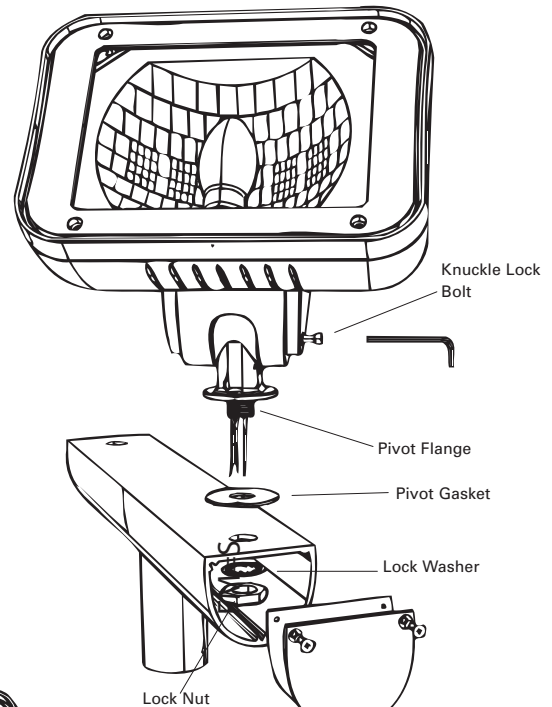

Knuckle Mount

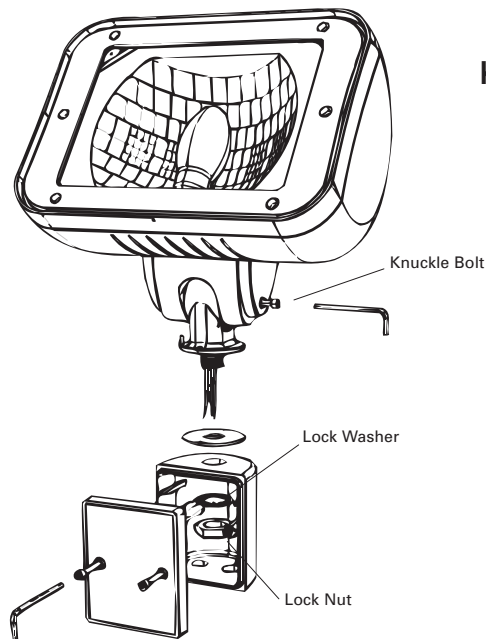

Architectural Junction Box Mount

These instructions do not claim to cover all details or variations in the equipment, procedure, or process described, nor to provide directions for meeting every possible contingency during installation, operation or maintenance. When additional information is desired to satisfy a problem not covered sufficiently for user's purpose, please contact your nearest representative. **NOTE:** Specifications and dimensions subject to change without notice.

INSTALLATION INSTRUCTIONS

IMPORTANT: READ BEFORE REMOVING FIXTURE FROM CARTON. RETAIN FOR FUTURE REFERENCE.

WARNING: Make certain power is OFF before starting installation or attempting any maintenance.

ARCHITECTURAL JUNCTION BOX INSTRUCTIONS

- A. Provide a suitable conduit mounting system capable of securely supporting the J-Box and attached fixture. For two conduit mounting method, conduit should be installed with conduit 1-1/2" apart on center.
- B. Conduit must be installed within 5 degrees of vertical.
- C. J-Box is ONLY to be mounted with the threaded supply conduit hole(s) nearest the ground. Do NOT hang the J-Box from Conduit.
- D. Make sure all power has been turned off.
- E. Attach J-Box directly to threaded conduit, or use rain tight fittings (by others) to attach to unthreaded conduit. Use a sealant on all threads to ensure a weather resistant installation.
- F. Mount fixture onto J-Box:
 - Make sure the pivot gasket is in place on the fixture pivot, with the (2) set screws extending half way into associated holes in the gasket.
 - Feed fixture supply wires into the J-Box and place the fixture pivot into the hole on the top of the J-Box.
 - Rotate the fixture to its proper aiming position. Place the lock washer and nut onto the 3/4" NPT nipple on the inside of the J-Box, and tighten the nut to 800 inch pounds.
- G. Tighten the two (2) pivot set screws to 20 inch pounds.
- H. Have a qualified electrician make the wiring connections.
- I. Make sure the cover gasket is seated into the groove in the cover, and that the door bolt washers and O-rings are properly located. Attach the door and securely tighten the cover bolts.

NOTE: When Color Filter is used with Barn Doors the Barn Doors must be oriented perpendicular or away from the face of the fixture. The aiming of the fixture with both Color Filter and Barn Doors must be at least 30° up or greater from straight down.

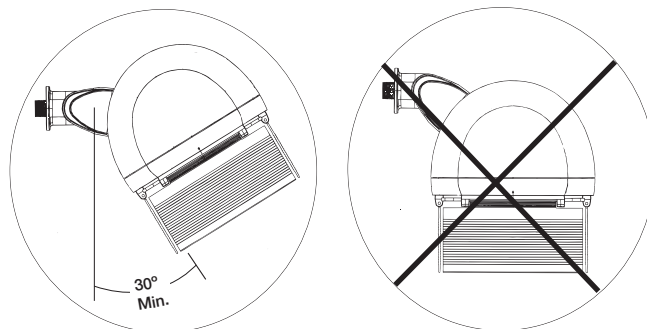
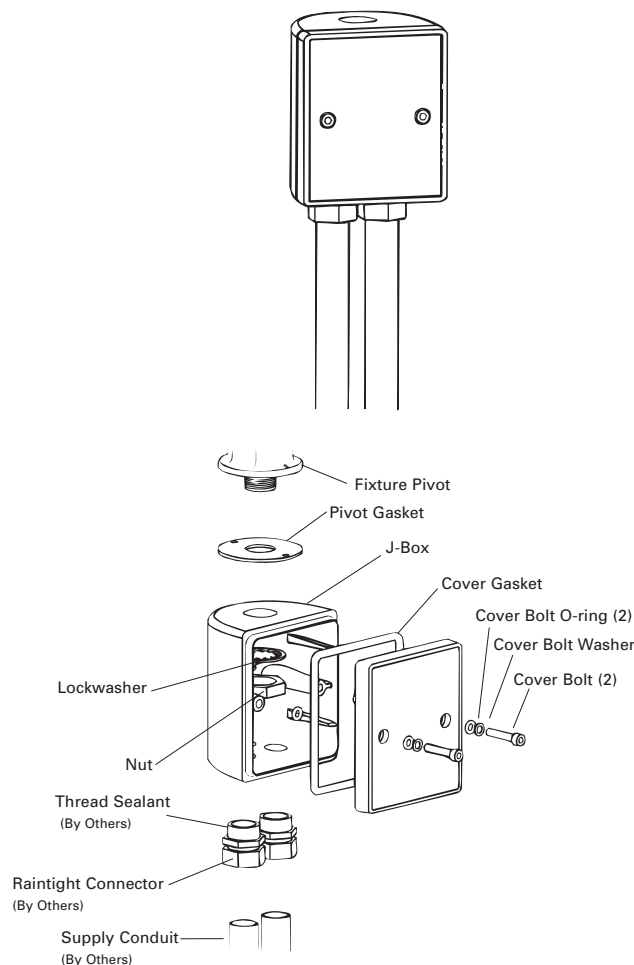

These instructions do not claim to cover all details or variations in the equipment, procedure, or process described, nor to provide directions for meeting every possible contingency during installation, operation or maintenance. When additional information is desired to satisfy a problem not covered sufficiently for user's purpose, please contact your nearest representative. **NOTE:** Specifications and dimensions subject to change without notice.