

| | | | | | |
|-------------|--|-----------|--|------|--|
| Project | | Catalog # | | Type | |
| Prepared by | | Notes | | Date | |

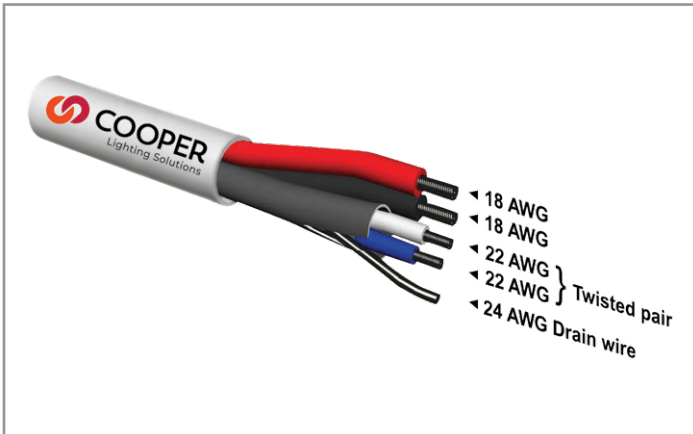

WaveLinx Wired

LCCP (plenum) and LCCNP (non-plenum) Network Communication Cable

Used to interconnect Source Controllers and peripheral devices

Typical Applications

Office • Education • Healthcare • Hospitality • Retail

Interactive Menu

- Order Information page 2
- Additional Resources page 2
- Connected Systems page 4
- Product Warranty

Product Certification



Product Features



Top Product Features

- WaveLinx Wired network communications cable is used to interconnect Source Controllers and peripheral devices
- The cable provides one 18AWG wire pair to deliver power to peripherals and one 22AWG twisted and shielded wire pair to carry data transmissions
- Carries both power and data in a single cable
- Both non-plenum (LCCNP) and plenum rated (LCCP) versions are available

Order Information

Catalog Number

| Catalog Number | Description |
|----------------|---------------------------------------|
| LCCP | Communication cable; plenum rated |
| LCCNP | Communication cable; non-plenum rated |

Product Specifications

Key Features

- Interconnects Source Controllers and peripheral devices
- Carries both power and data in a single cable

Mechanical

Nominal diameter: LCCP, 0.205"; LCCNP, 0.250"

Color: LCCP, Natural; LCCNP, Black

Outer Jacket Material: PVC

Electrical

Power Wire Pair:

- Conductors: 2 x 18 AWG, tinned copper
- Colors: Red / Black
- Shield: None

Data Wire Pair:

- Conductors: 2 x 22 AWG, tinned copper
- Colors: Blue / White
- Shield: Aluminum foil (100% coverage)
- Shield drain wire: 24 AWG
- Impedance: 100 Ohms

Standards/Ratings

- NEC / (UL) specification: LCCP-CMP; LCCNP-CMR
- CEC / C (UL) specification: LCCP-CMP; LCCNP-CMG

Warranty

Five year warranty standard

Conductors

| Function | Color | Construction | Normal Size |
|----------|-------|----------------------------------|--|
| Power | Red | 16 strand x 30 AWG tinned copper | 18 AWG |
| Common | Black | 16 strand x 30 AWG tinned copper | 18 AWG |
| Data | Blue | 7 strand x 30 AWG tinned copper | Twisted pair in foil shield 22 AWG |
| Data | White | 7 strand x 30 AWG tinned copper | |
| Drain | | 7 strand x 32 AWG tinned copper | 24 AWG |

General

| Type | Cable Outer Jacket (PVC) | | | Ratings | | | |
|-------|--------------------------|------------------|-------------|-----------------------|---------------------------|-------------|---------------|
| | Color | Nominal Diameter | Reel Length | Impedance (Data Pair) | Maximum Operating Voltage | Temperature | Plenum Rated? |
| LCCP | Natural | 0.205 | 500 Feet | 100 Ohm | 300V RMS | 75° C | Yes |
| LCCNP | Black | 0.250 | 500 Feet | 100 Ohm | 300V RMS | 75° C | No |

System architecture

Simple WaveLinX wired system

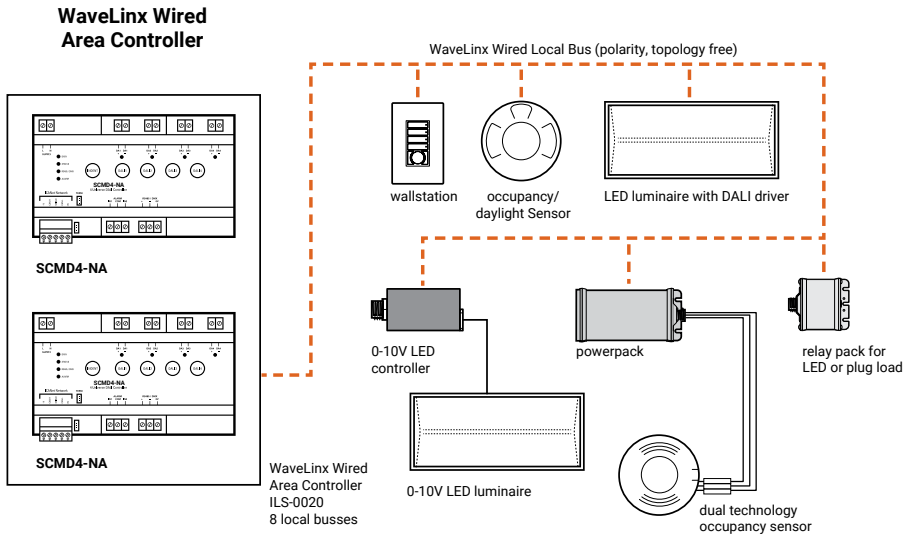

Complete WaveLinX wired system

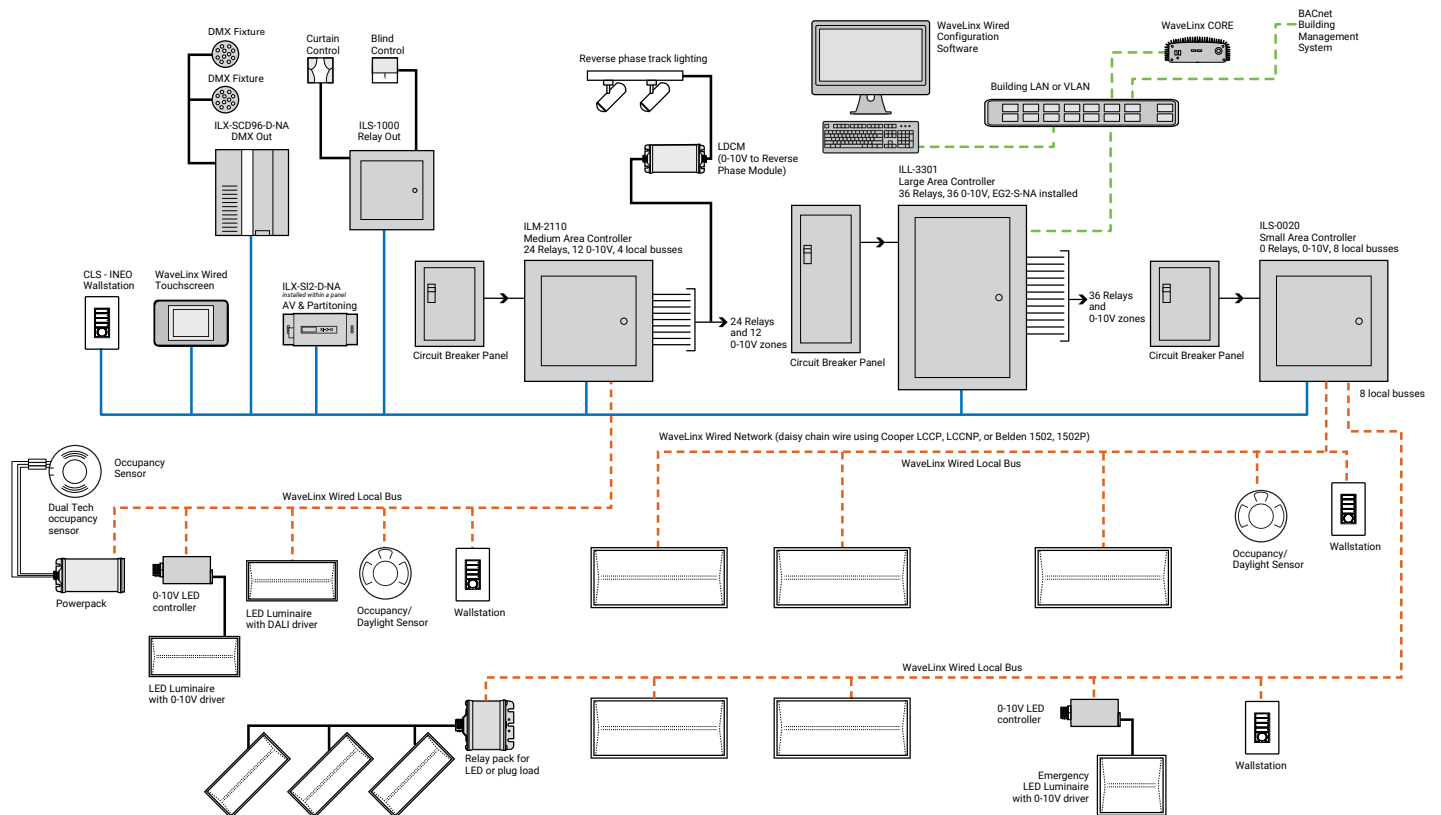

Sample System Topology:

This diagram shows the main components of the WaveLinX wired and PRO wireless connected lighting system.

The **WaveLinX PRO wireless system** communicates using wireless mesh technology based on the IEEE 802.15.4 standard. A PoE LAN connection for each WaveLinX Area Controller (WAC) is required for power and data access to the building lighting network.

The **WaveLinX wired system** controls the devices using relay, 0-10V, DMX and the WaveLinX wired digital local bus. The WaveLinX wired system connects to the building LAN using the EG2 module. Each WaveLinX wired area controller communicates on the WaveLinX wired network.

WaveLinX Area Controllers (WAC) and WaveLinX Ethernet Gateways (EG2) communicate with WaveLinX CORE over the Ethernet network.

Please refer to the WaveLinX PRO Wireless Network and IT Guidance Technical Guide and WaveLinX Wired Network and IT Guidance Technical Guide for more information.

[View WaveLinX Network and IT Guidance Technical Guide](#)

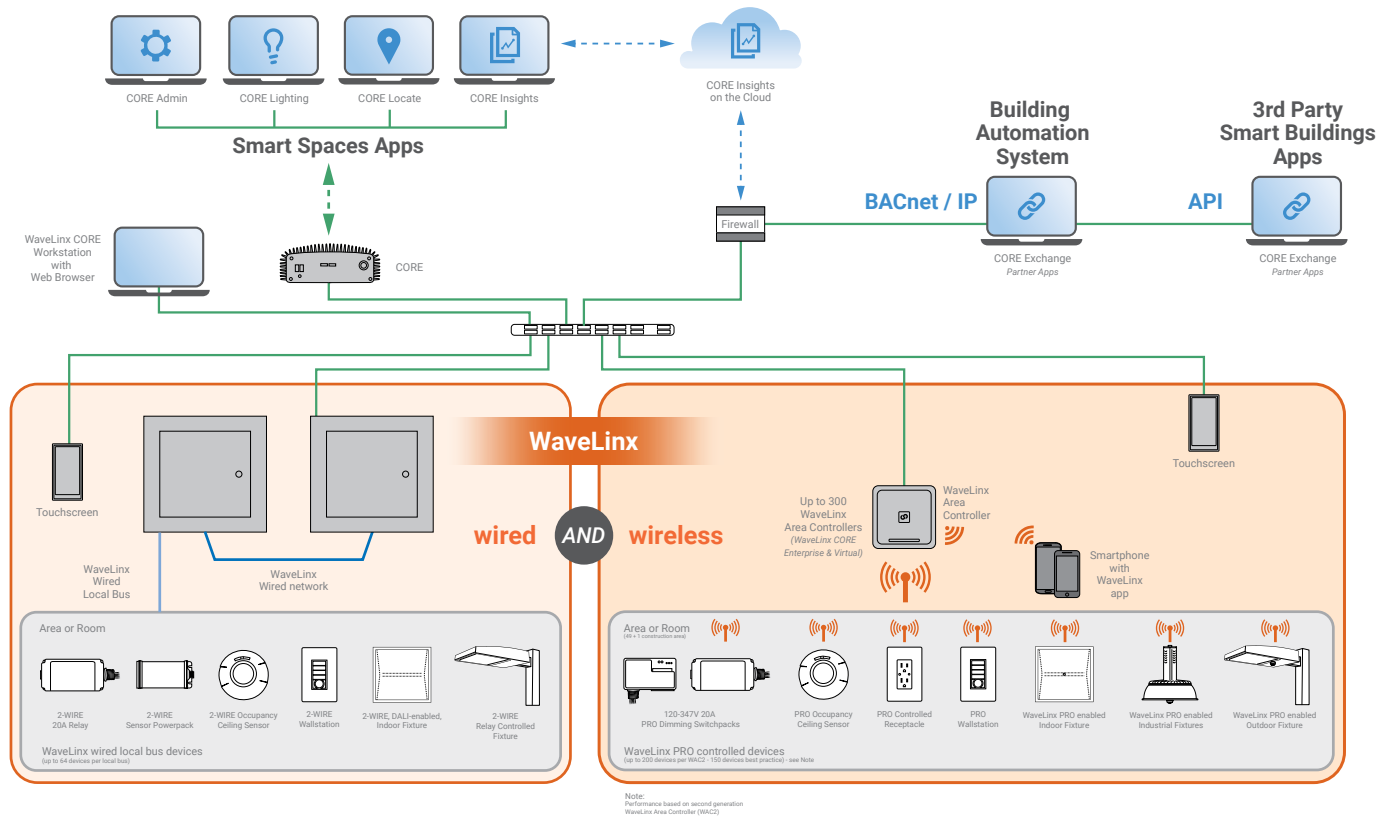

Control Systems

- WaveLinX
- WaveLinX wired
- VividTune