

Project		Catalog #		Type	
Prepared by		Notes		Date	



Metalux

EBP-RM40R

Emergency LED Driver for UHBS Selectable High-Bay

Typical Applications

Industrial • Commercial • Retail • Manufacturing • Warehouse • Gymnasium • Multi-purpose • Grocery • High Bay / Low Bay Applications

Product Certification

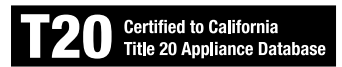

Interactive Menu

- Order Information page 2
- Product Specifications page 2
- Project Features page 2
- Product Warranty

Top Product Features

- UL Listed for factory or field installation
- Universal input: 100-347Vac, 50/60Hz
- Constant power output
- Built-in junction box
- Easy wiring, connect directly to AC output of luminaire
- Over-voltage, short-circuit, over-load, open-circuit protection
- Remote control device included
- CEC Title 20 certified

Dimensional Details

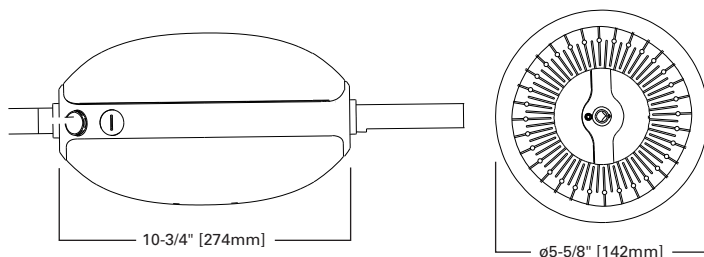

Installation Example



[additional product diagrams](#)

Ordering Information

Model No.	Input Voltage	Emergency Power
EBP-RM40R	100-347V AC	40W

Note: To meet state and local codes, EBP cannot be used with UHBS with sensor or with UHBS sensor accessory.

Packaging

UPC Code	Unit Weight (lbs)	Master Pack Qty	Master Pack Size
080083259496	32.2	4PCS	23.6" x 13.8" x 8"

Product Specifications

Input Voltage	100-347V AC, 50/60Hz	Output Voltage	170V DC
Input Current (Max.)	200mA	Output Current (Max.)	460mA
Input Power (Max.)	15W	Output Power	40W
Emergency Time	90 minutes	Battery Type	Lithium ion battery
Charging Time (Full)	≥24 hours	Ambient Temp.	5°C~50°C (41°F~122°F)

Product Features

EASY WIRING

Directly connect to Fixture LED Driver AC input

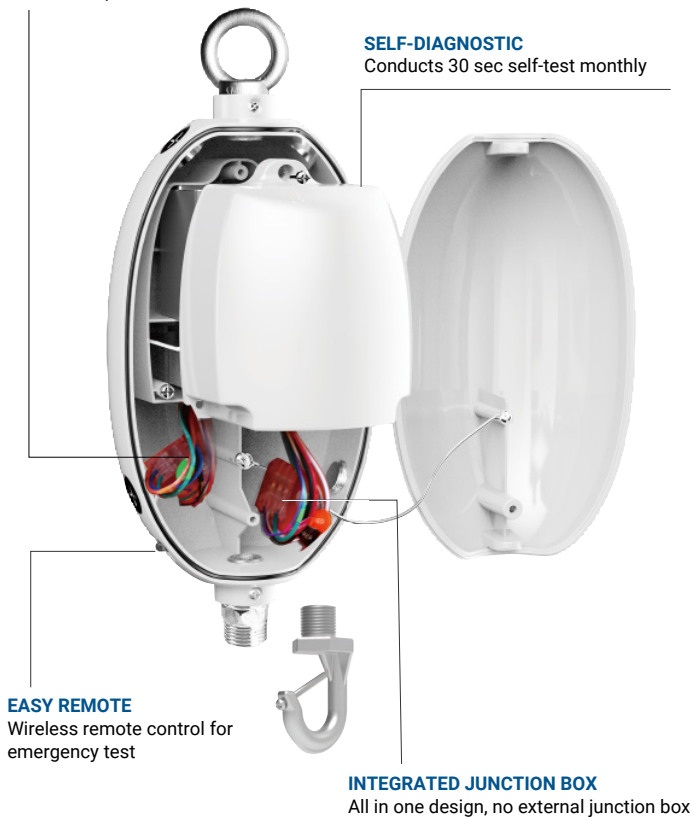

Components (included)

No.	Parts	Quantity	Picture	Remark
1	Rugby LED Emergency Driver	1		
2	Ring	1		
3	G-hook and 1/2" NPT	1		
4	Waterproof Connectors (For AC Wires)	3		Cable Range: Ø5-Ø9mm (v0.19"~Ø0.35")
5	Waterproof Connectors (For Dimming Wires)	2		Cable Range: Ø4-Ø5mm (Ø0.16"~Ø0.19")
6	Remote Controller (Includes 2 Tek screws)	1		
7	Philips Head Screws	2		
7	Wiring Connectors	5		Inside Housing
7	Instruction Sheet	1		