

## DESCRIPTION

The Paralux III Series features recessed aesthetics and the latest in energy efficient technology. The luminaire incorporates a nominal 3" deep precision cell louver into a 4-3/4" deep para-contoured fixture housing. This combination creates a total high performance parabolic optical assembly for optimum performance. The series is compatible with all of today's popular ceiling systems and is available with a number of options and accessories for application versatility.

2EP3-IC is rated for installations when the housing is in direct contact with insulation. The high performance luminaire is designed to offer maximum efficiency and performance for today's unique interior specifications.

## SPECIFICATION FEATURES

### Construction

4-3/4" deep, para-contoured housing, die formed of code gauge, prime cold rolled steel. Die embossed housing has full length die formed stiffeners for added strength. Contoured ballast/wireway cover is easily removed without tools. Die formed captive lampholder bracket fully encloses lampholder wiring permitting easy lampholder replacement. Heavy end plates are securely attached with interlocking tabs and screws. Four auxiliary fixture end suspension points provided. KOs for continuous row wiring. End plates have integral Grid-Lock feature for safety and convenience.

### Electrical\*\*

Ballasts are CBM/ETL Class "P" and are positively secured. 2G11 base lampholders have doubleedge wiping action pressure lock contacts with vertically oriented lamp support clips. UL/CUL listed lampholders. UL/CUL listed for Type IC Recessed Luminaire (Rated for direct contact with insulation). Suitable for damp locations.

### Finish

Lighting grade, baked white enamel finish. Multistage, iron phosphate pretreatment ensures maximum bonding and rust inhibition.

### Hinging/Latching

Positive spring loaded, self locking, steel latches. Safety lock T-hinges allow hinging and latching from either side.

### Louver

Die formed of low iridescent, vertical grain anodized aluminum. Finish is Anodic oxide coating. Accurate precision parabolic cells are held in place with interlocking feature. True-cut mitered corners. Black reveal with integral mechanical light seal around entire perimeter of louver. Louver protected from construction contaminants by polyethylene cover.

### Compliance

Options to meet Buy American Act requirements.

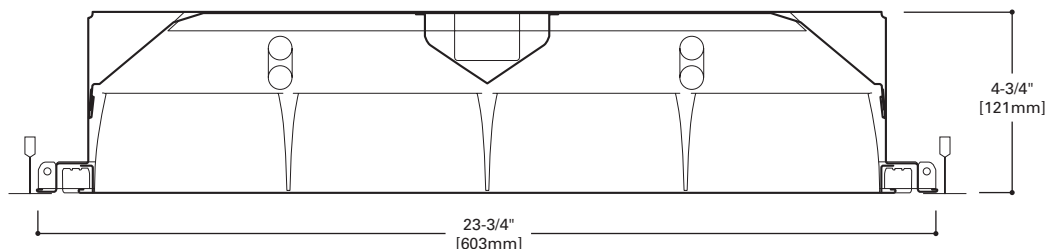

## MOUNTING DATA

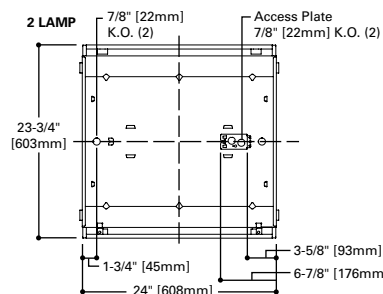

## LAMP CONFIGURATIONS

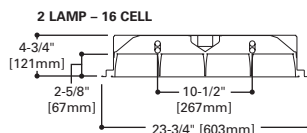

## CEILING COMPATIBILITY

G	G	G	F	MZ	Ceiling Type	Trim Type
Grid/Lay-in Standard	Concealed T	Slot Grid	Aluminum Flange Trim With Supporting Swing Gates	Modular Trim With Supporting Swing Gates	Exposed Grid	G
					Concealed T	G
					Slot Grid	G
					Flange	F
					Concealed "T" or "Z"	MZ
					Metal Pan	MZ
					(Verify compatibility/ consult factory.)	



## 2EP3GAX-IC 2BX40

## 9 or 16 Cell

2' X 2' PARABOLIC  
2 LAMP BIAxIAL  
SEMI-SPECULAR,  
SPECULAR OR WHITE  
PAINTED LOUVER

Paralux III  
Recessed Static or  
Air Supply Troffer

For Use in  
Insulated Ceilings



## ENERGY DATA

Input Watts:  
**EB Ballast & STD Lamps**  
28X40 (67)

Luminaire Efficacy Rating  
**LER = FP-57**  
**Catalog Number:** 2EP3GAX-IC-  
2BX40S33I

**Yearly Cost of 1000 lumens,**  
**3000 hrs at .08 KWH = \$4.62**

\*\*Reference the lamp/ballast data in the  
Technical Section for specific lamp/ballast  
requirements.

LAMPS CONTAIN MERCURY. DISPOSE ACCORDING  
TO LOCAL, STATE OR FEDERAL LAWS

## LINEAR DISCONNECT

Safe and convenient means of  
disconnecting power.

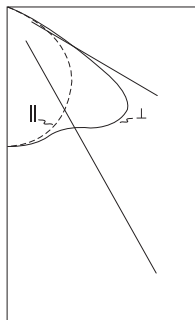

## PHOTOMETRICS

**2EP3GAX-IC-2BX40S44I**

Electronic Ballast

F40BX/35K/RS Lamps

3150 Lumens

Spacing criterion:

(II) 1.2 x mounting

height, (⊥) 2.2 x

mounting height

Efficiency 63.7%

Test Report:

2EP3GAXIC2BX40S44I.IES

LER = FP-52

Yearly Cost of 1000

lumens, 3000 hrs at

.08 KWH = \$4.62

**Candlepower**

Angle	Along II	45°	Across ⊥
0	1262	1262	1262
5	1254	1241	1233
10	1225	1218	1251
15	1188	1211	1264
20	1143	1197	1331
25	1097	1200	1471
30	1039	1245	1648
35	970	1311	1799
40	892	1379	2007
45	800	1416	2283
50	690	1405	1920
55	543	1152	938
60	338	543	284
65	145	118	85
70	49	43	40
75	23	21	20
80	10	10	9
85	3	3	3
90	0	0	0

**Coefficients of Utilization**

rc	Effective floor cavity reflectance												20%											
	80%				70%				50%				30%				10%				0%			
	70	50	30	10	70	50	30	10	50	30	10	50	30	10	50	30	10	50	30	10	0	0	0	0
RCR																								
0	76	76	76	76	74	74	74	74	71	71	71	68	68	68	65	65	65	65	65	65	64			
1	71	68	66	64	69	67	65	63	64	62	61	62	60	59	59	58	57	56						
2	65	60	57	54	63	59	56	53	57	54	52	55	53	51	53	51	50	48						
3	60	54	49	45	58	53	48	45	51	47	44	49	46	43	48	45	43	41						
4	55	48	43	39	53	47	42	38	45	41	38	44	40	37	42	39	37	36						
5	50	42	37	33	49	42	37	33	40	36	33	39	35	32	38	35	32	31						
6	46	38	33	29	45	37	32	29	36	32	28	35	31	28	34	31	28	27						
7	43	34	29	25	42	34	29	25	33	28	25	32	28	25	31	27	24	23						
8	40	31	26	22	39	31	26	22	30	25	22	29	25	22	28	25	22	20						
9	37	28	23	20	36	28	23	20	27	23	20	27	22	19	26	22	19	18						
10	34	26	21	18	33	26	21	18	25	21	18	24	20	17	24	20	17	16						

**Zonal Lumen Summary**

Zone	Lumens	%Lamp	%Fixture
0-30	1039	16.5	25.9
0-40	1881	29.9	46.9
0-60	3826	60.7	95.3
0-90	4014	63.7	100.0
0-180	4014	63.7	100.0

**Typical VCP Percentages**

Room Size (Ft.)	Height Along		Height Across	
	8.5'	10.0'	8.5'	10.0'
20 x 20	77	70	74	66
30 x 30	83	77	81	74
30 x 60	86	81	85	79
60 x 30	85	81	84	79
60 x 60	88	84	87	83

## ORDERING INFORMATION

SAMPLE NUMBER: 2EP3GAX-2BX40S33I-120V-EB51-U

<b>Domestic Preferences</b> <sup>(10)</sup> <b>[Blank]</b> =Standard <b>BAA</b> =Buy American Act  <b>Rating</b> <b>Blank</b> =Standard <b>ATW-SW4</b> =Chicago Rated  <b>HR</b> =Heat Removal <sup>(11)</sup>  <b>Width</b> <b>2</b> =2' Width  <b>EP</b> =Paralux Louver  <b>3</b> =3" Louver Depth  <b>Trim Type</b> <b>G</b> =Grid/Lay-in (Standard) <b>G</b> =Concealed T/Slot Grid <sup>(6)</sup> <b>F</b> =Aluminum Flange Trim <sup>(7)</sup> <b>MZ</b> =Modular Trim  <b>AX</b> =Air Supply Floating Louver <b>X</b> =Blank Side/Floating Louver - Non-Air Supply (Omit A) <b>AVX</b> =Air Supply Floating Louver with Directional Air Vane (Add V)  <b>IC</b> =IC Rated	<b>Number of Lamps</b> <b>2</b> =2 Lamps  <b>Wattage (Length)</b> <b>BX40</b> =40W Biac (24")  <b>Louver Color</b> <b>S</b> =Silver <b>W</b> =White  <b>Cell Configuration</b> <b>33</b> =3 Rows of 3, 9 Cell <b>44</b> =4 Rows of 4, 16 Cell  <b>Louver Finish</b> <b>I</b> =Semi-Specular/Haze (Low Iridescent) Standard (Silver Only) <b>P</b> =Painted (White only)  <b>Option - Aluminum Flange Trim</b> <sup>(7)</sup> <b>Blank</b> =SW (Single White) Type Color 'S' Single 'N' Natural 'R' In Row 'W' White 'E' End of Row	<b>Voltage</b> <sup>(3)</sup> <b>120V</b> =120 Volt <b>277V</b> =277 Volt <b>347V</b> =347 Volt <b>UNV</b> =Universal Voltage 120-277 <sup>(4)</sup>  <b>Options</b> <b>GL</b> =Single Element Fuse <b>GM</b> =Double Element Fuse <b>WTR</b> =White Reveal <b>Lamps</b> =Lamps Installed (refer to lamp ordering options) <b>Flex</b> =Flex Installed (Reference Flex ordering information) <b>EL</b> =Emergency Installed <sup>(8), (9)</sup>	<b>Ballast Type</b> <b>EB5</b> =T5 Biac Electronic Instant <sup>(8)</sup> Start. Total Harmonic Distortion < 20% <b>TEB5</b> =T5 Biac Electronic Instant <sup>(8)</sup> Start. Total Harmonic Distortion < 10% <b>ER5</b> =T5 Biac Electronic Program Rapid Start. Total Harmonic Distortion < 10%  <b>Number of Ballasts</b> <b>1</b> =1 Ballast <b>2</b> =2 Ballasts <b>3</b> =3 Ballasts	<b>Options</b> <b>PAF</b> =Painted After Fabrication  <b>REP</b> =Riveted Endplates  <b>Packaging</b> <b>U</b> =Unit Pack <b>PAL</b> =Job Pack, out of carton <b>PALC</b> =Job Pack, in carton
--	---	---	---	--

**ACCESSORIES** <sup>(11)</sup>**EQ-CLIP-U**=T-BAR Safety Earthquake Clips <sup>(2)</sup>

**NOTES:** <sup>(1)</sup> Integral end plate grid lock feature not available in heat removal. <sup>(2)</sup> An EQ Grid Clip is recommended for all 9/16" ceiling systems. Four required per fixture. <sup>(3)</sup> Products also available in non-US voltages and frequencies for international markets. <sup>(4)</sup> Not available when specifying emergencies, voltage must be specific. <sup>(5)</sup> Fixtures equipped with "ET" option may require a 5-1/2" housing depth. If installing in field, must use low profile battery pack. <sup>(6)</sup> Louver is recessed by 5/16" in Concealed T or Slot Grid T. <sup>(7)</sup> Specify row configuration, type in catalog number when ordering complete fixture. <sup>(8)</sup> Not available in UNV voltages. Must specify voltage. <sup>(9)</sup> Please specify required voltage, 120V or 277V. <sup>(10)</sup> Only product configurations with this designated prefix are built to be compliant with the Buy American Act of 1933 (BAA). Please refer to **DOMESTIC PREFERENCES** website for more information. Components shipped separately may be separately analyzed under domestic preference requirements. <sup>(11)</sup> Accessories sold separately will be separately analyzed under domestic preference requirements. Consult factory for further information.

Specifications &amp; dimensions subject to change without notice. Consult your Cooper Lighting Solutions Representative for availability and ordering information.

**SHIPPING DATA**

Catalog No.	Wt.
2EP3GAX-IC-2BX40S33I	35 lbs.
2EP3GAX-IC-3BX40S33I	28 lbs.