

Description

The E4RTATSB is a remodel Non-IC Air-Tite™ housing optimized and listed for EISA compliant tungsten-halogen lamps, CFL and LED lamps as well as incandescent. Housing features an adjustable socket bracket, and is suitable for residential or commercial applications. Installation in non-insulated ceilings with Air-Tite code compliant construction. If insulation is present it must be kept 3" from all sides of the housing. May be retrofit with compatible Halo LED lighting systems.

Catalog #		Type
Project		
Comments		Date
Prepared by		

Specification Features

Housing

- Die-formed CRS
- For installation from below the finished ceiling
- Air-Tite gasket pre-installed on remodel flange

Remodel Clips

- Four remodel clips secure housing and accommodates 1/2" and 5/8" ceiling materials.

Junction Box

- Seven conduit knockouts are uniform 1/2" size with true pry-out slots
- Four pry-outs with integral strain relief simplify "NM" non-metallic sheathed cable installation
- Three quick connect wire connectors included

Includes:

- **Quick Connect™**
- (3) Push wire nuts included, for speed & reliability
- Clear caps for wire connection visibility

Air-Tite™ code compliant

- ASTM E283 compliant

Socket

- Adjustable position porcelain socket with nickel plated brass screw shell provides flexibility in lamp positioning.

Thermal Protector

- Self resetting thermal protector deactivates fixture if overheating occurs due to improper lamping or misapplied insulation.

Trims

- Halo Fit-All concept offers multiple trim options in a variety of design styles, and functional beam distributions to control beam angle and lumen delivery in accommodating various lamp types

Compliance

- cULus Listed 1598 Luminaire
- cULus Listed for Damp Location
- cULus Listed for Wet Location, with select trims
- RoHS compliant
- Options to meet Trade Agreements Act requirements
- Air-Tite code compliant. Certified under ASTM E283; not exceeding 2.0 cfm (0.044 L/s) air leakage rate tested at a 1.57 psf (75 Pa) pressure differential



E4RTATSB

4" Non-Insulated Ceiling AIR-TITE Remodel Housing with Adjustable Socket Bracket

4" Trims

Discontinued
12-03-2026



FOR USE IN EXISTING CEILINGS

FOR USE IN NON-INSULATED CEILINGS OR INSULATED CEILINGS BUT INSULATION MUST BE KEPT 3" FROM ALL SIDES OF FIXTURE

Dimensions

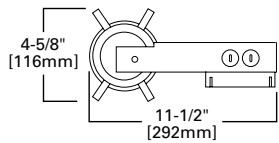
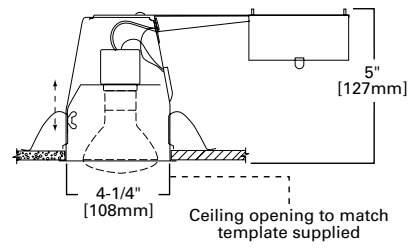

Ordering Information

Sample Number: E4RTATSB 4003SC

Order housing, trim and lamp (by others) separately for a complete luminaire.

Domestic Preferences⁽¹⁾

[Blank] = Standard

TAA = Trade Agreements Act

Housing

E4RTATSB = 4" non-insulated ceiling AIR-TITE small aperture remodel housing with adjustable socket bracket

Trims

Reflectors



999 Reflector Cone

OD: 5-1/16" [129mm]

- 999P=Specular Clear, White Trim Ring
- 999RG=Residential Gold, White Trim Ring
- 999W=White Reflector, White Trim Ring
- 999H=Haze Reflector, White Trim Ring
- 999MB=Specular Black Reflector, White Trim Ring
- 999SN=Satin Nickel Reflector with Satin Nickel Trim Ring
- 999TBZ=Tuscan Bronze Reflector with Tuscan Bronze Trim Ring



4003 Reflector Cone

OD: 4-3/4" [120mm]

- 4003SC=Specular Clear Reflector, White Trim Ring

Baffles



953 Metal Baffle

OD: 5-1/16" [129mm]

- 953P=Black Baffle with White Trim Ring
- 953W=White Baffle with White Trim Ring
- 953SN=Satin Nickel Baffle with Satin Nickel Trim Ring
- 953TBZ=Tuscan Bronze Baffle with Tuscan Bronze Trim Ring



990 Pinhole Trim

OD: 5-1/16" [129mm]

- 990P=White Die Cast Trim
- 990SN=Satin Nickel Die Cast Trim
- 990TBZ=Tuscan Bronze Die Cast Trim



992 Wall Wash with Baffle

OD: 5-1/16" [129mm]

- 992P=White Scoop and Trim Ring, Black Baffle
- 992W=White Scoop and Trim Ring, White Baffle
- 992SN=Satin Nickel Scoop and Trim Ring, Black Baffle
- 992TBZ=Tuscan Bronze Scoop and Trim Ring, Black Baffle

Baffles



993 Coil Baffle

OD: 5-1/16" [129mm]

- 993P=Black Baffle with White Trim Ring
- 993W=White Baffle with White Trim Ring
- 993SN=Black Baffle with Satin Nickel Trim Ring
- 993TBZ=Black baffle with Tuscan Bronze Trim Ring



4001 Step Baffle

OD: 4-3/4" [120mm]

- 4001BB=Black Plastic Baffle, White Trim Ring
- 4001WB=White Plastic Baffle, White Trim Ring



4010 Metal Baffle

OD: 5" [127mm]

- 4010BB=Black Metal Baffle, White Trim Ring
- 4010WB=White Metal Baffle, White Trim Ring

Adjustable



998 Eyeball 30° Tilt

OD: 5-1/16" [129mm]

- 998P=White Eyeball
- 998SN=Satin Nickel Eyeball
- 998TBZ=Tuscan Bronze Eyeball



4002 Eyeball

OD: 4-3/4" [120mm]

- 4002WH=White Eyeball

Lens / Wet Location Listed



945 Metropolitan Ice Light

OD: 5-5/16" [135mm]

- 945=Clear Frosted
- 945Blue=Blue Frosted



952 Cone Reflector

- 952PS=White Trim Ring, Dome Lens Shower Light



4055 Prismatic Glass Lens Shower Light

OD: 4-3/4" [120mm]

- 4055WH=Shower Light, White Trim Ring, Prismatic Flat Glass Lens

Mounting Accessories

Filters and Lenses

The following filters and lenses can be substituted for the cover glass supplied for use with MR16 lamps.

Color Filters

- L112=Red Gel Filter
- L114=Ultraviolet Dichroic Filter
- L120=Red Dichroic Filter
- L121=Amber Dichroic Filter
- L122=Yellow Dichroic Filter
- L123=Green Dichroic Filter
- L124=Daylight Blue Dichroic Filter
- L125=Blue Dichroic Filter
- L127=Cosmetic (2700°K) Dichroic Filter
- L121=Yellow Gel Filter
- L121=Amber Gel Filter

Optical Lenses

- L100N=Diffuse Sand Blasted Lens. Provides an even beam spread from MR16 lamps- especially useful in wall washing.
- L111=Soft Focus Lens. Smooths irregular beam pattern while maintaining high controlled illumination levels and beam angles.
- L113=Prismatic Spread Lens. Provides a symmetrical broadening of MR16 lamp beams.
- L115=Fans the MR16 beam to produce a wide rectangular illumination pattern.

Notes: (1) Only product configurations with this designated prefix are built to be compliant with the Trade Agreements Act of 1979 (TAA). Please refer to [DOMESTIC PREFERENCES](#) website for more information. Components shipped separately may be separately analyzed under domestic preference requirements. Accessories sold separately will be separately analyzed under domestic preference requirements. Consult factory for further information.

*Outdoor rated lamp only (purchase separately)



For use in Halo listed housings.

Can also be used with the following LED Modules:

LT4 = 4" LED retrofit module

RL4 = 4" all-purpose retrofit LED retrofit module

RA4 = 4" adjustable gimbal all-purpose LED retrofit module

ML4 = 4" LED module (see ML4 spec sheets for trim options)

SLD4 = 4" surface LED downlight