

Nimbaro, Minaro, Unaro Aircraft Cable Mount

IMPORTANT: Read carefully before installing product. Retain for future reference.



WARNING



Risk of Fire, Electrical Shock, Cuts or other Casualty Hazards- Installation and maintenance of this product must be performed by a qualified electrician. This product must be installed in accordance with the applicable installation code by a person familiar with the construction and operation of the product and hazards involved.



Risk of Fire and Electric Shock- Make certain power is OFF before starting installation or attempting any maintenance. Disconnect power at fuse or circuit breaker.



Risk of Fire- Minimum 90°C supply conductors.



Risk of Burn- Disconnect power and allow product to cool before handling or servicing.



Risk of Personal Injury- Due to sharp edges, handle with care.

Risk of Personal Injury- Do not install this product in locations such as gymnasiums, arenas, sports complexes, multi-purpose rooms and other locations where the fixture potentially will be subject to impacts from external sources. Doing so may result in cracking and/or breaking of the fixture which may cause pieces to fall from the application.



Risk of Personal Injury- Failure to comply with these instructions may result in death, serious bodily injury and property damage.

DISCLAIMER OF LIABILITY: Cooper Lighting Solutions assumes no liability for damages or losses of any kind that may arise from the improper, careless, or negligent installation, handling or use of this product.

IMPORTANT: Read carefully before installing fixture. Retain for future reference.

CAUTION: Fixture may become damaged and/or unstable if not installed properly.

NOTE: Specifications and dimensions subject to change without notice.

NOTE: These instructions do not claim to cover all details or variations in the equipment, procedure or process described, nor to provide directions for every possible contingency during installation, operation, or maintenance. When additional information is desired to satisfy a problem not covered sufficiently for user purpose, please contact your nearest representative.

ATTENTION Receiving Department: Note actual fixture description of any shortage or noticeable damage on delivery receipt. File claim for common carrier (LTL) directly with carrier. Claims for concealed damage must be filed within 15 days of delivery. All damaged material, complete with original packing must be retained.



COOPER
Lighting Solutions





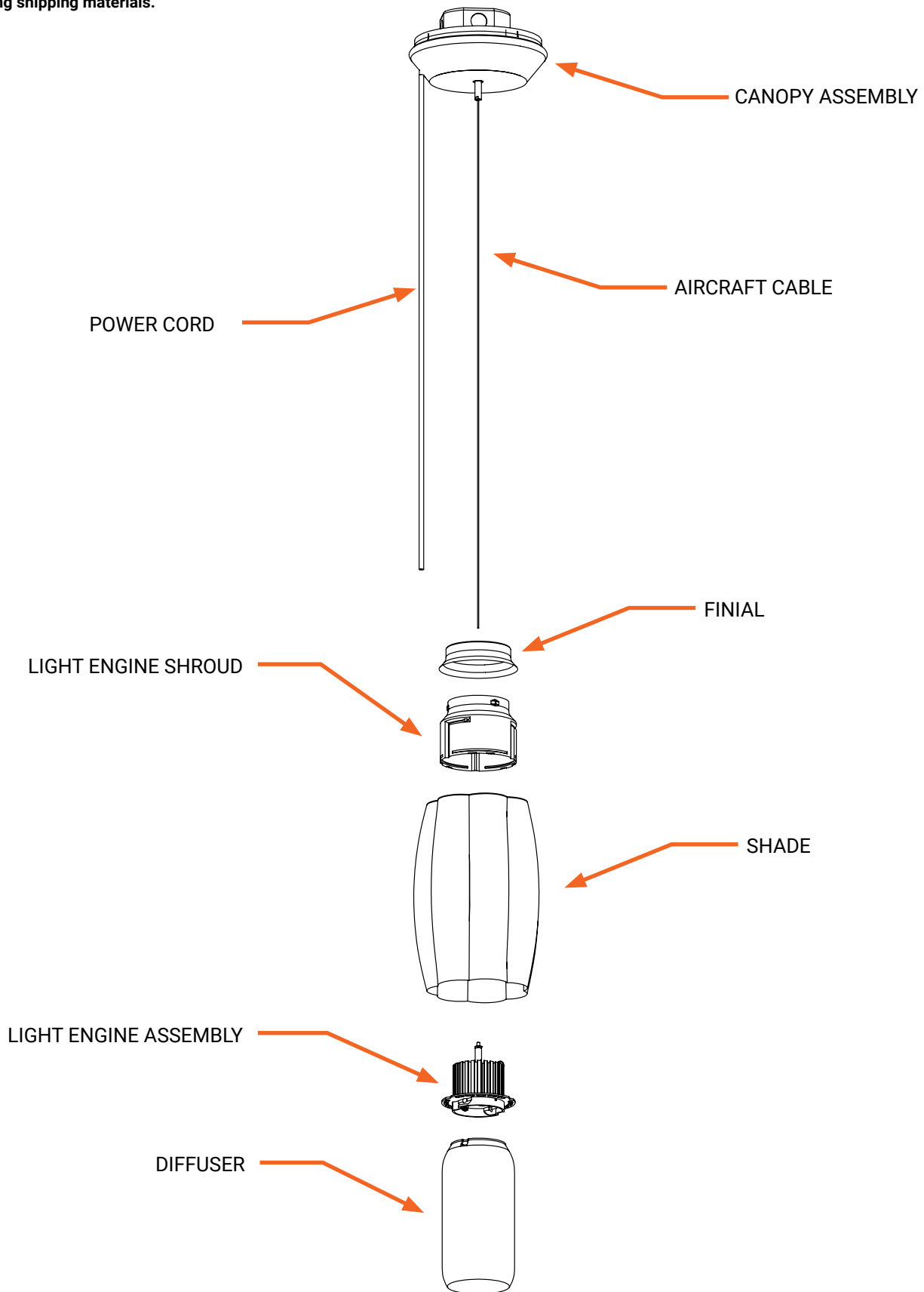

a @ignify business

Note: Ensure all components are located before disposing shipping materials.

Figure 1



Wiring Table

Power Supply (Input)	
	Black (BK) - Hot
	White (WT) - Neutral
	Green (GN) - Ground
	Violet (VT) - Dimming (+)
	Pink (PK) - Dimming (-)
	Blue (BL) - LED (-)
	Red (RD) - LED (+)

Wiring Diagram

Single Driver (Small and Medium Size Fixture)

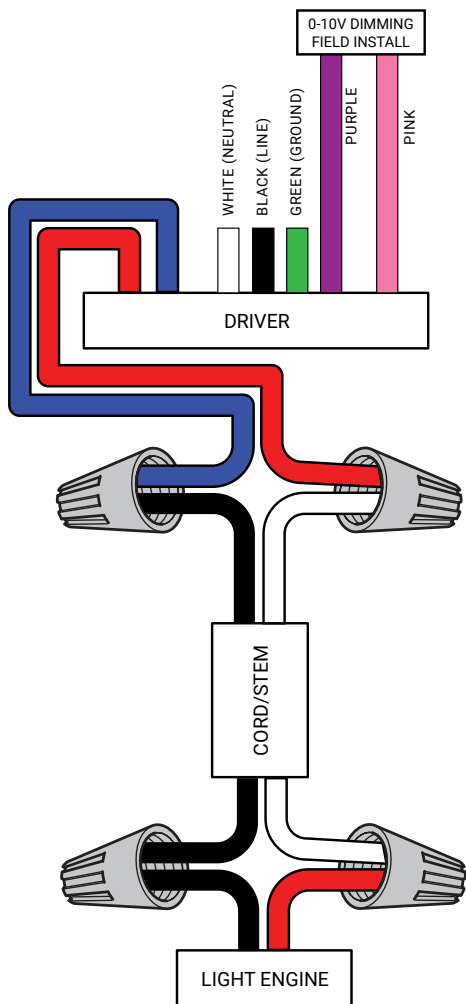

2 Drivers (Large Size Fixture)

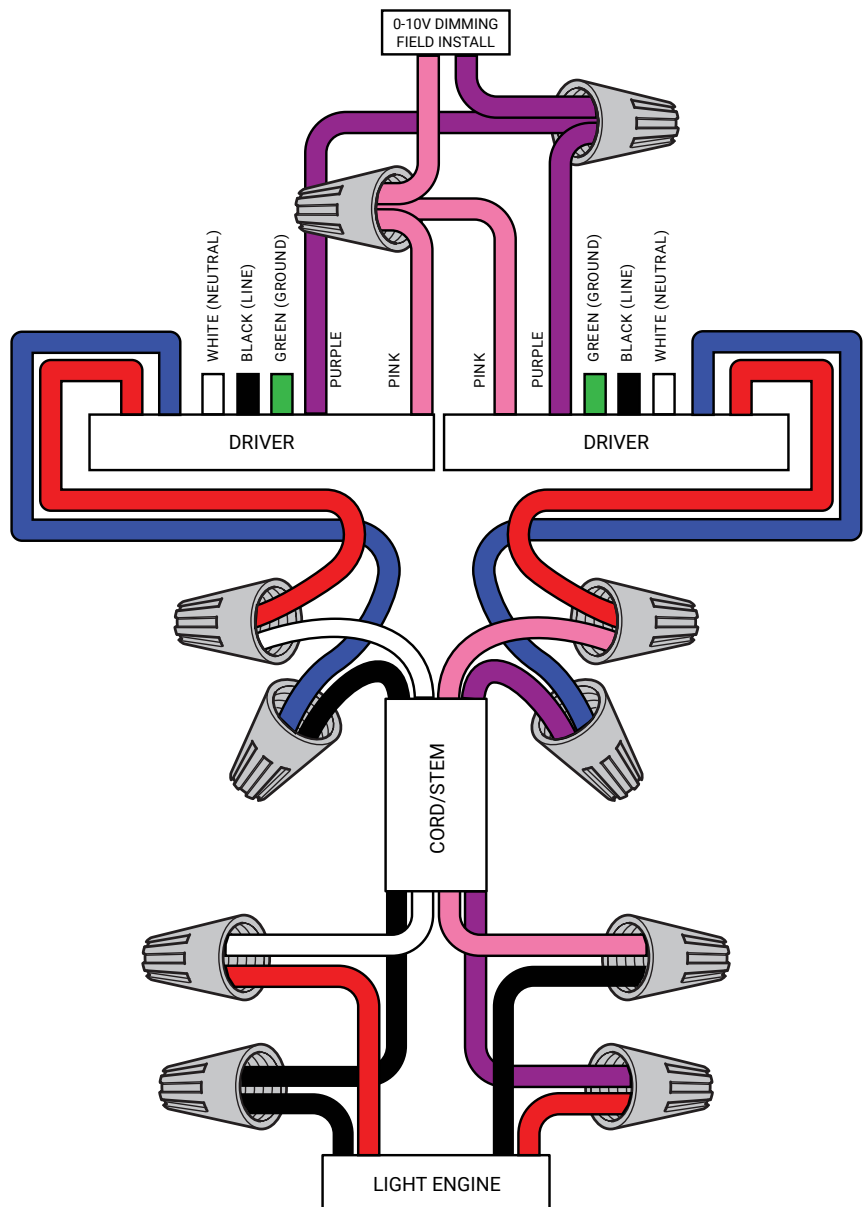

Figure 2A: Small and Medium Single Driver Components Exploded View

Note: Some components will arrive already assembled

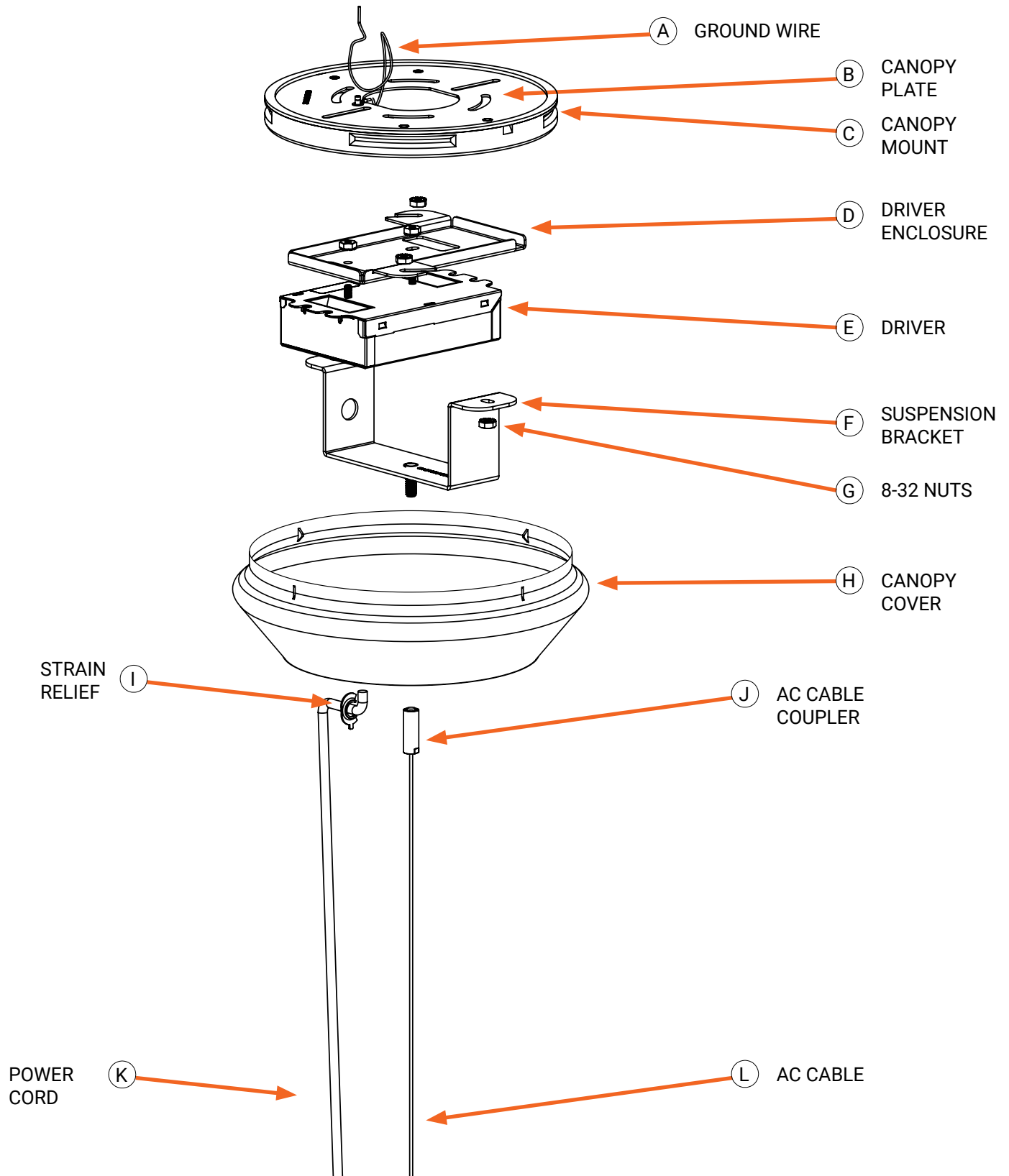
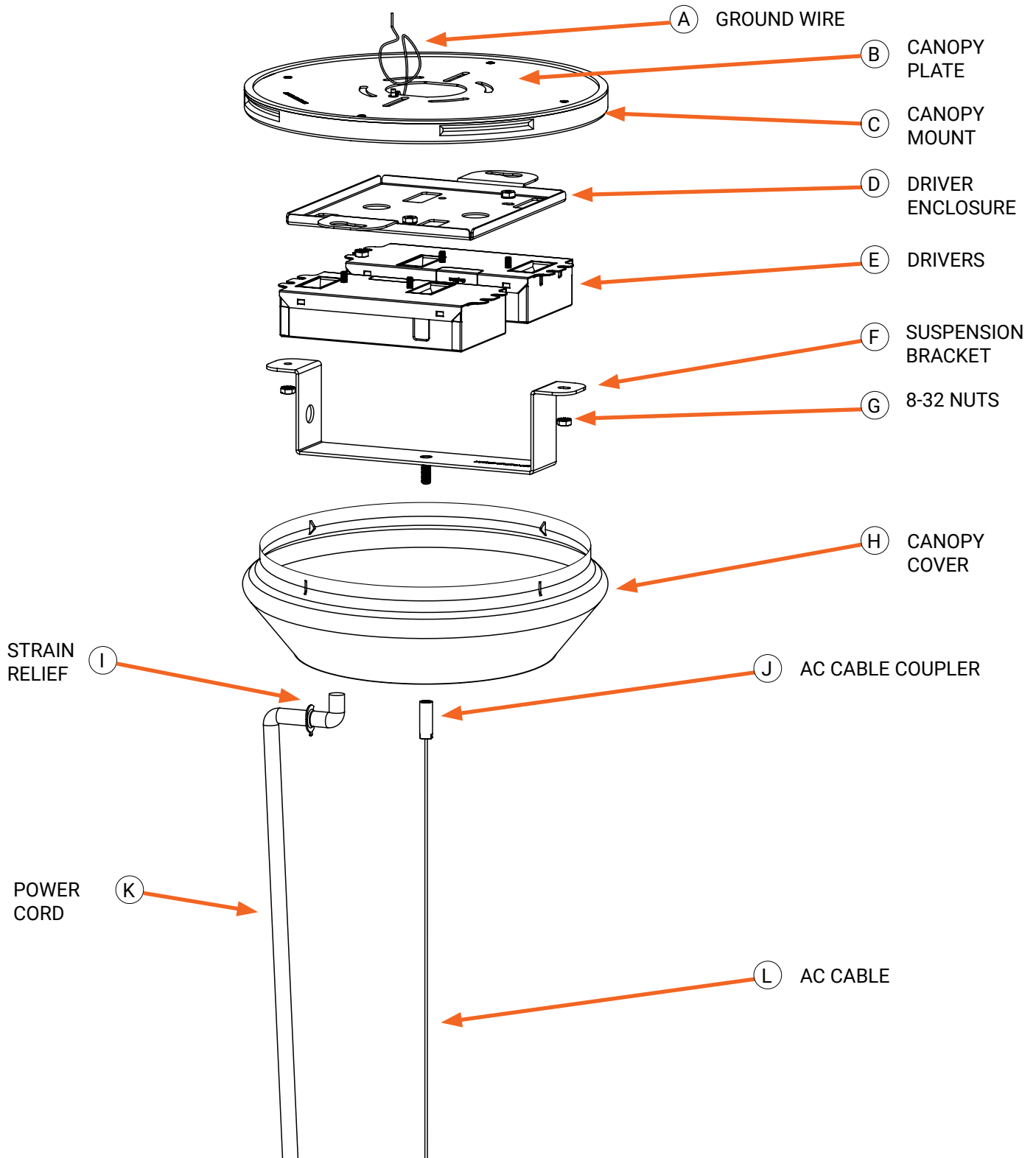

Figure 2B: Large Size Double Driver Components Exploded View

Note: Some components will arrive already assembled



Aircraft Cable Canopy Assembly

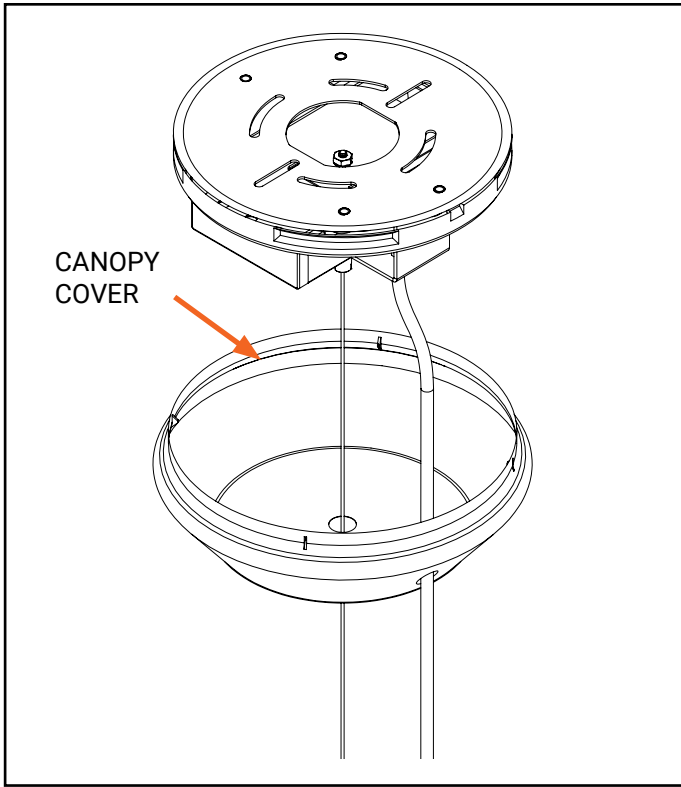

Figure 3

1. Ensure power is off at junction box.
2. Carefully remove lighting fixture, hardware, cords, and packaging from box. Inspect to ensure all items (Figure 1) are included.
3. Take out the **Canopy Cover (G)** by pulling down. (Figure 3)

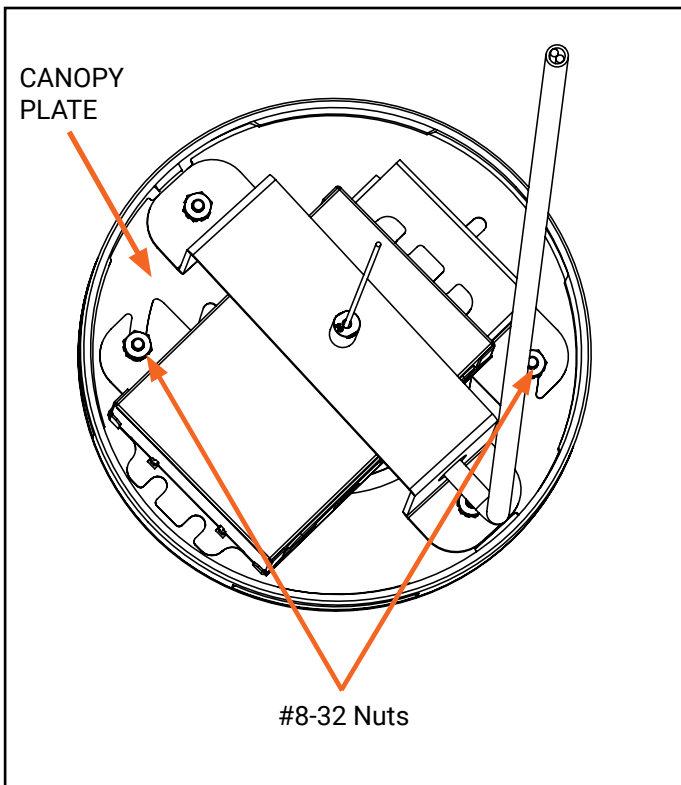
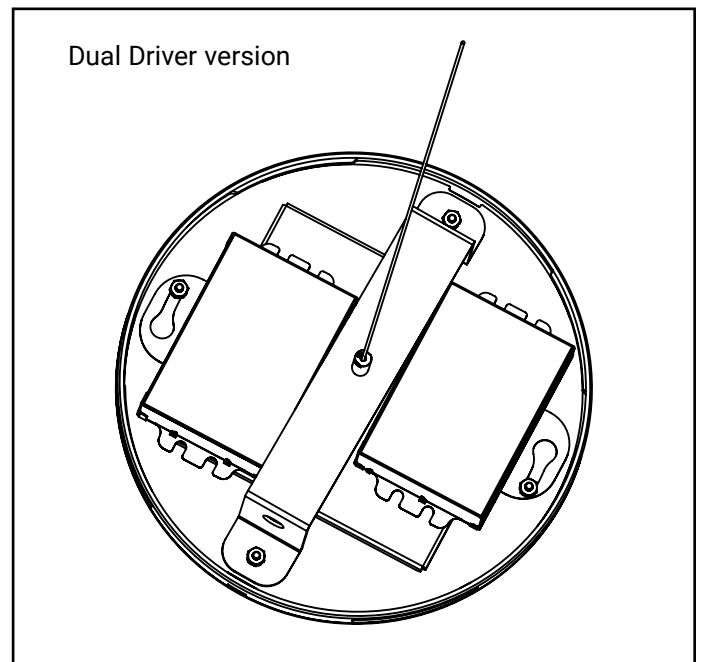

Figure 4

4. Loosen the two **#8-32 nuts (G)** from the **Canopy Plate (B)**. (Figure 4)



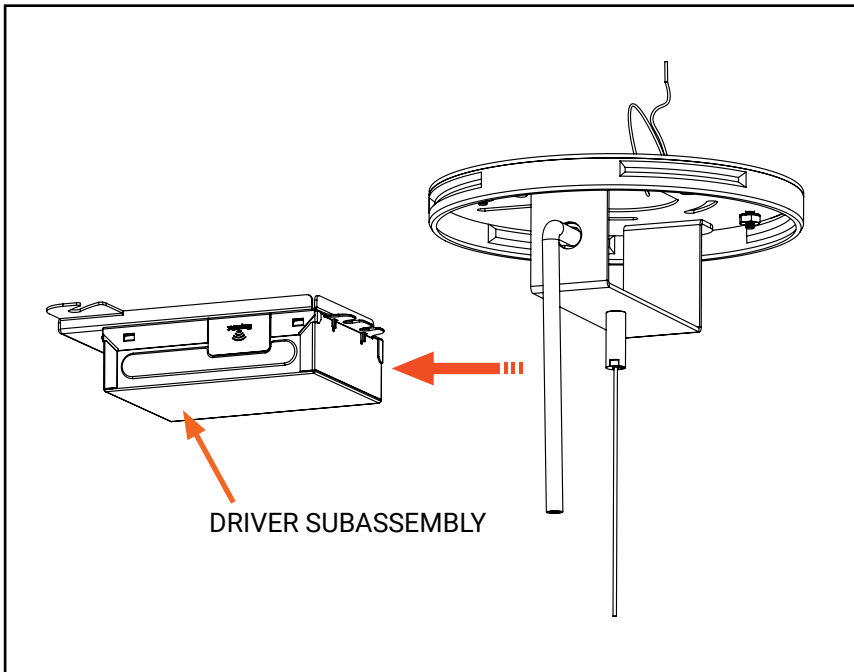

Figure 5

5. Rotate Driver Subassembly CCW and securely remove. (Figure 5)

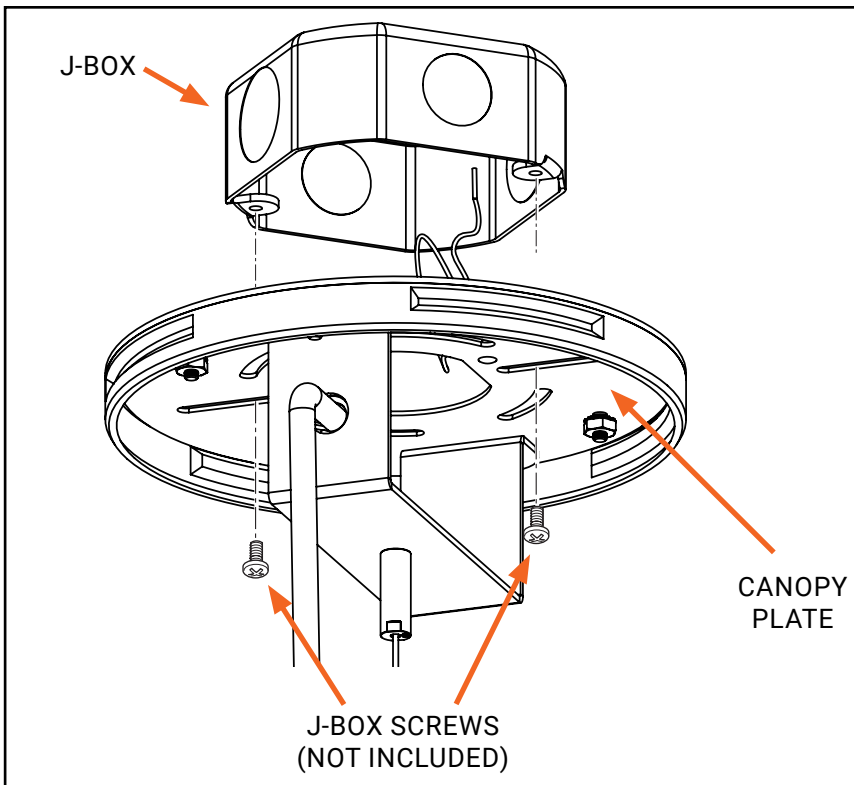
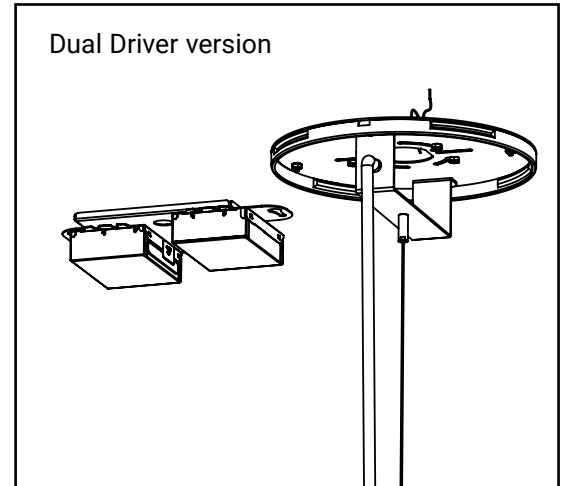

Figure 6

6. Attach the **Canopy Plate (B)** to the J-Box (supplied by others) with 2 screws (not included) adequately tight. (Figure 6)
7. Take the driver subassembly and make the electrical connections as shown in the wiring diagram on page 3.

Note: Single driver and Double driver assemblies use different wiring refer to wiring diagram and wire based on number of drivers.

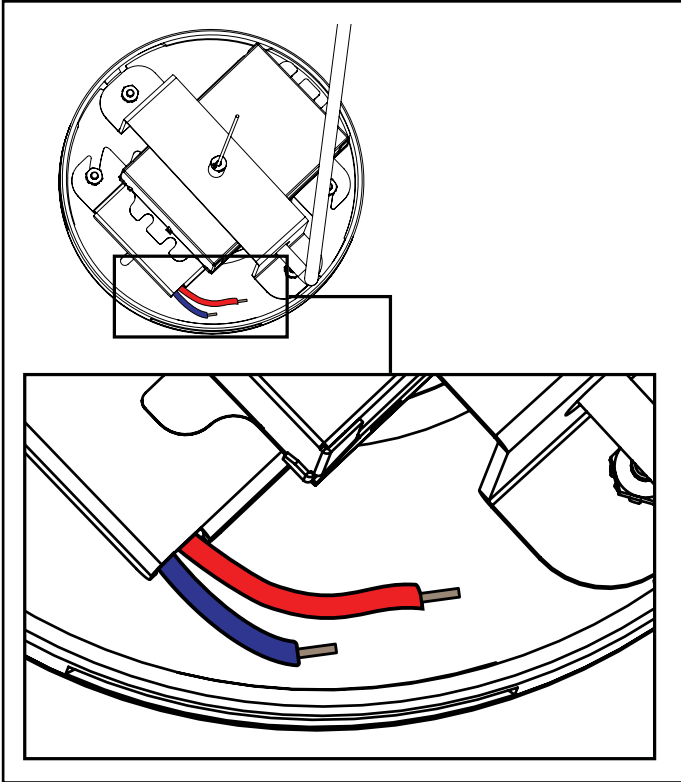

Figure 7

8. Route the Low voltage wire routing (LED wires) from the **Driver Enclosure (D)**. (Figure 7)
9. Push all connectors and extra wire from the driver assembly into the J-Box.

10. Reinstall the driver subassembly by aligning with studs and rotate Clockwise and secure with two **#8-32 nuts (G)**, Make sure wires will not interfere with assembly while rotating. (Figure 8)

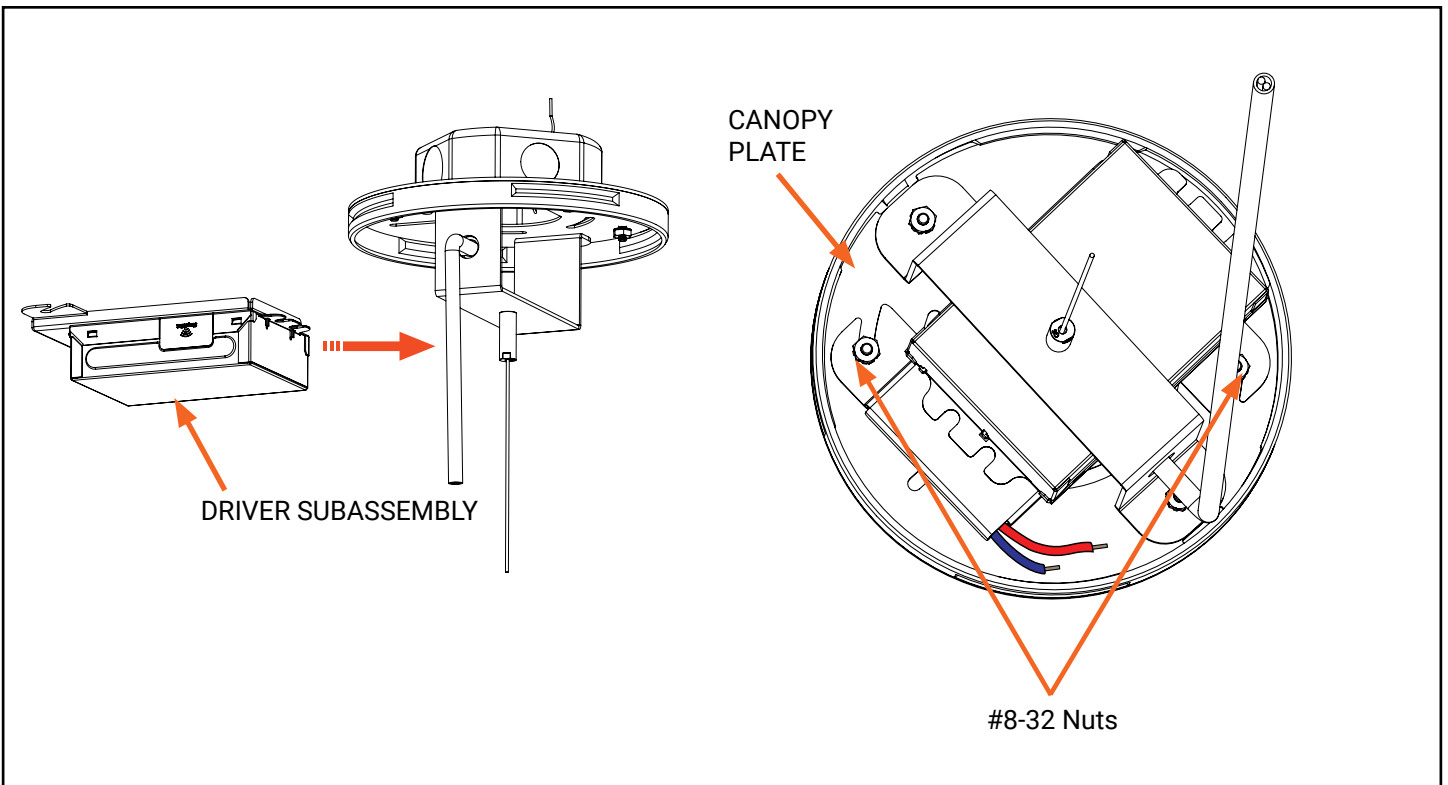

Figure 8

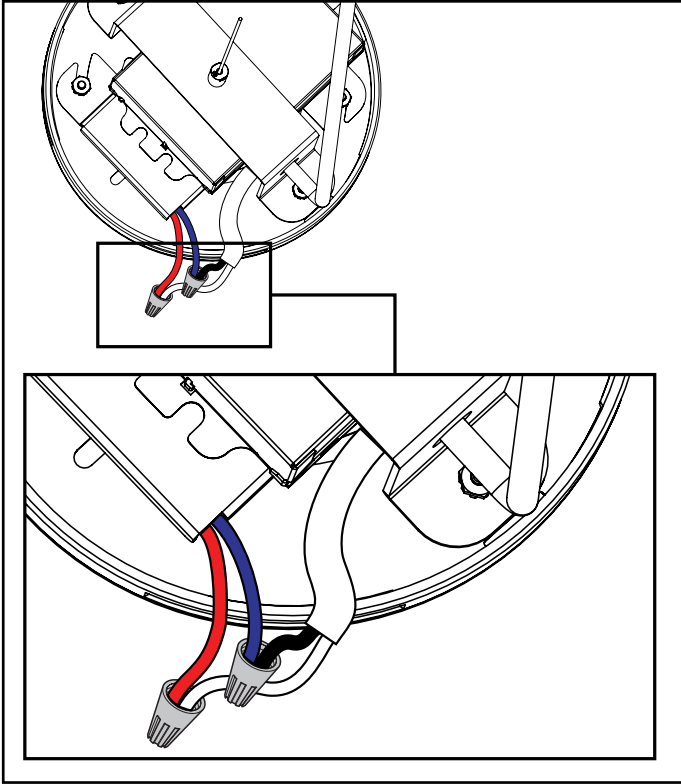

Figure 9

11. Connect the low voltage power cord as shown in the wiring diagram and in Figure 9. Make sure that other end of the low voltage power cord passes through the hole in the canopy. (Figure 9)

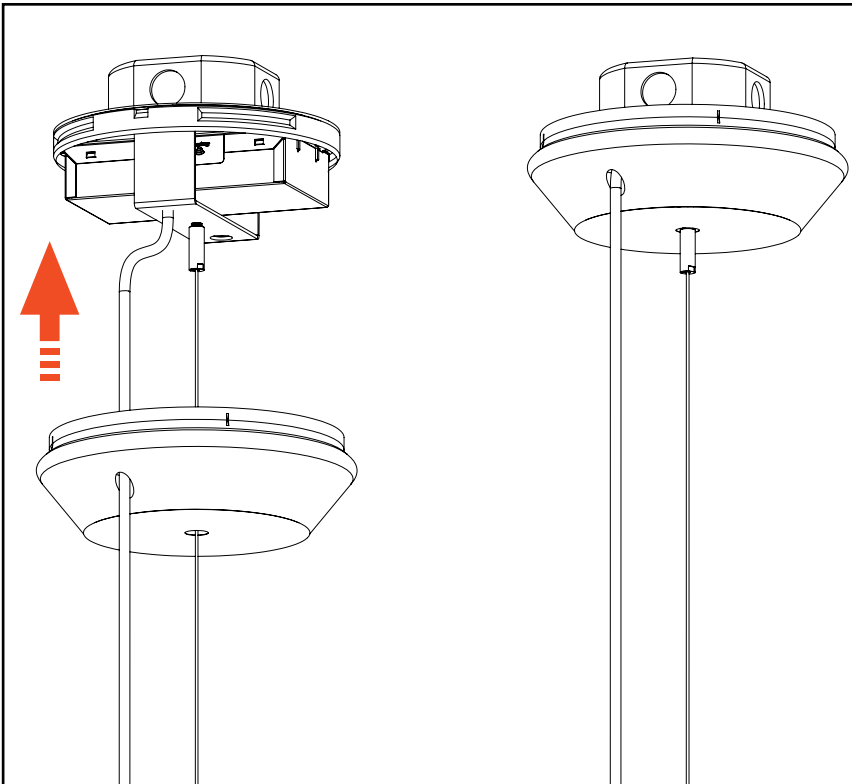

Figure 10

12. Secure back canopy by making sure that low voltage power cord exit in canopy matches with the wire hole in the hold plate and **Aircraft Cable (L)** is passing through the center hole, Press the **Canopy Cover (H)** against the **Canopy Plate (B)**. (Figure 10)

Light Engine

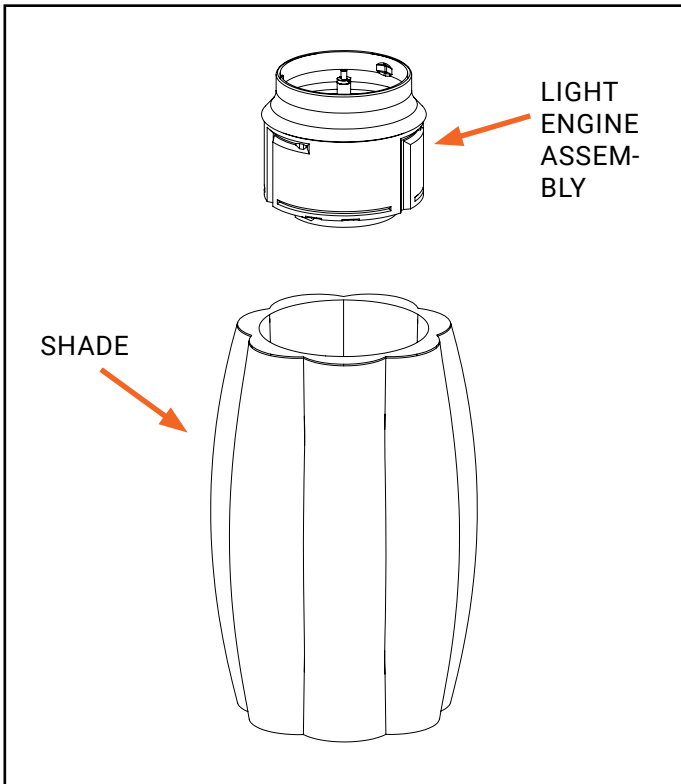

Figure 11

13. Take the shade and light engine out from the box. (Figure 11)

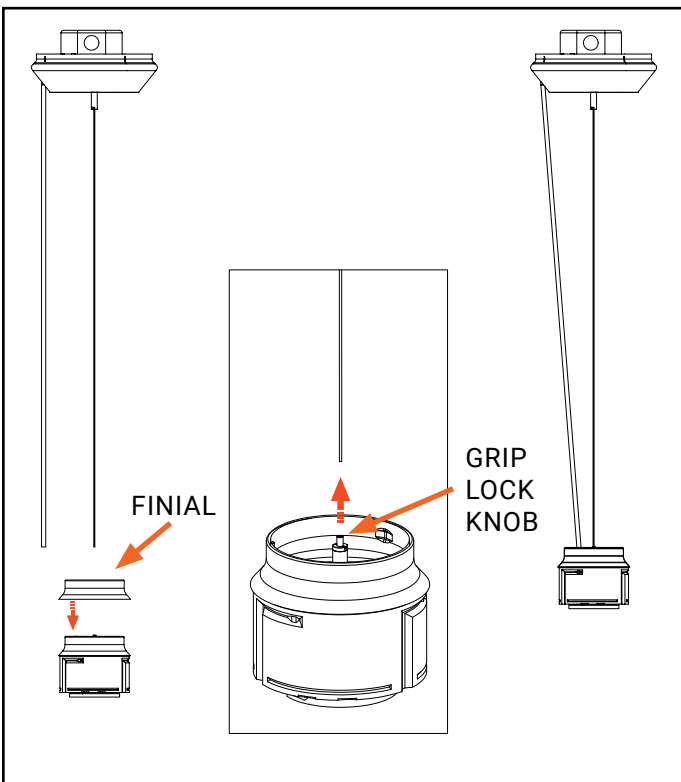

Figure 12

14. Place finial on top of light engine assembly. Lift the light engine assembly and insert the Aircraft Cable (L) in the grip lock by pushing the Grip lock knob. (Figure 12)
15. Cut the **Power Cord** to the desired mounting length and make the wiring as shown in the wiring diagram on Page 3.
16. Adjust the **Aircraft Cable** length to the desired mounting length, if required, by pushing the Grip Lock Knob.

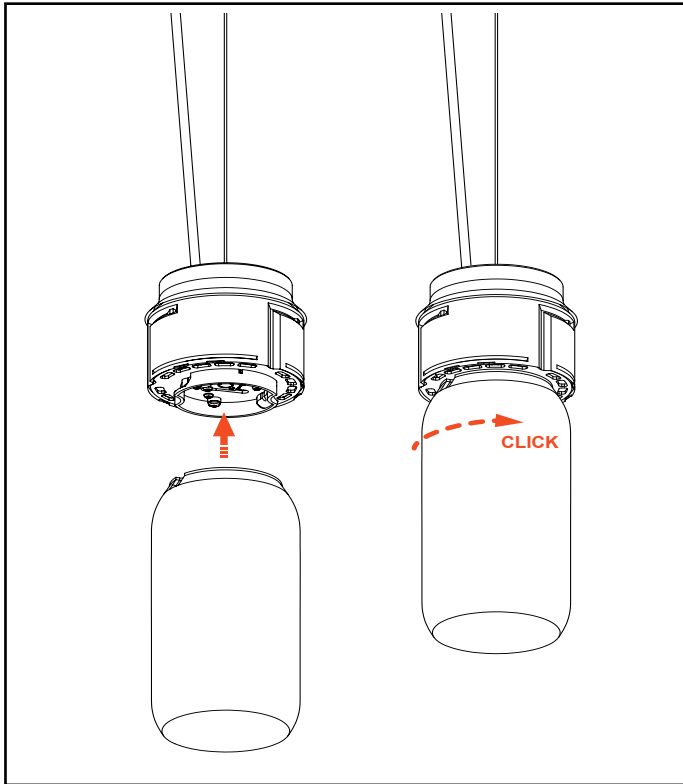

Figure 13

17. Install the diffuser from below by turning clockwise and lock into the light engine. May need to hold the top of the light engine assembly or shroud while installing. (Figure 13)

WARNING: DO NOT TOUCH THE ANY METAL COMPONENTS OF LIGHT ENGINE WHILE, OR IF RECENTLY, POWERED ON. HEATSINK AND CONNECTING COMPONENTS MAY BE HOT.

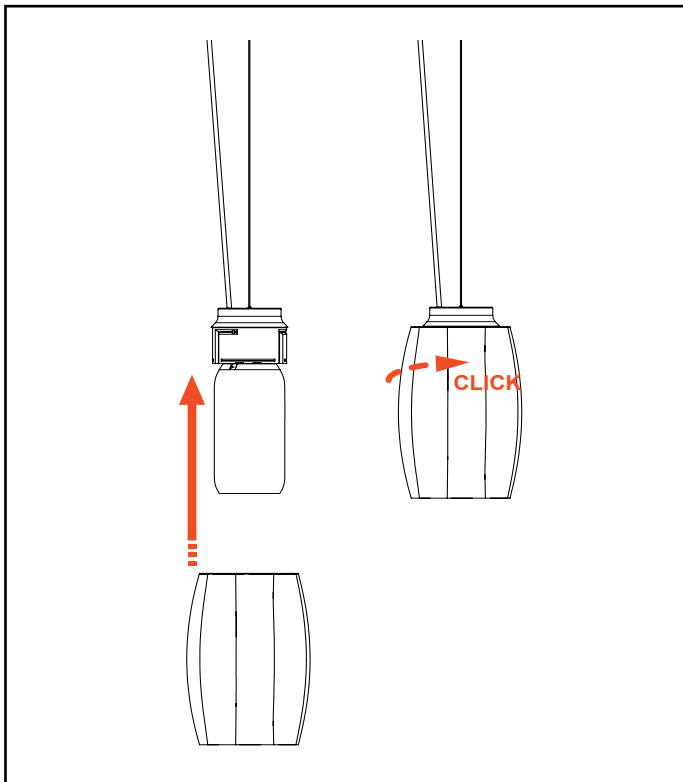

Figure 14

18. Install shade over light engine/diffuser subassembly by inserting into grooves and twisting to lock in place. (Figure 14)

WARNING: DO NOT TOUCH THE ANY METAL COMPONENTS OF LIGHT ENGINE WHILE, OR IF RECENTLY, POWERED ON. HEATSINK AND CONNECTING COMPONENTS MAY BE HOT.

Replacing Shades

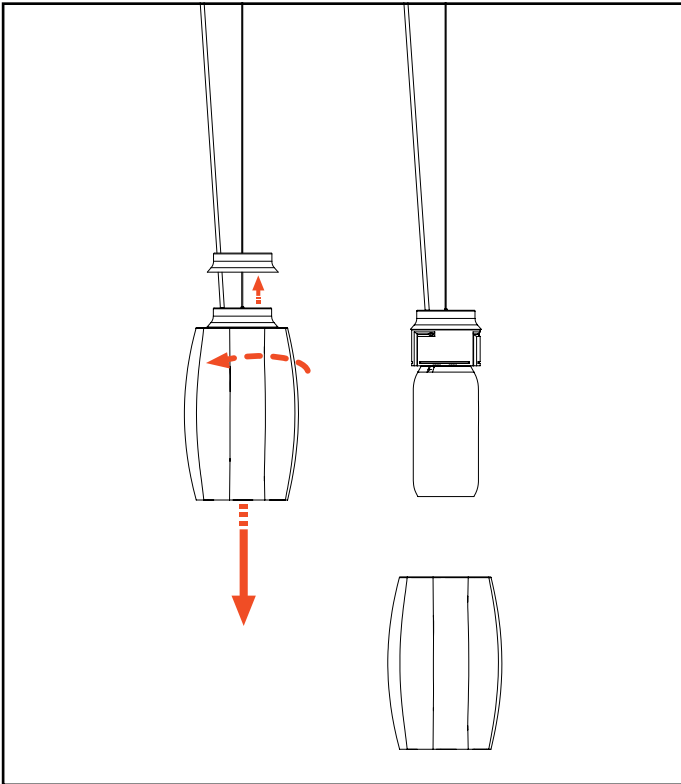

Figure 15

1. Ensure power is off at junction box.
2. Allow adequate time for light engine to cool.
3. Remove the top finial, hold the light engine shroud, and twist the shade counter clockwise to remove the shade. (Figure 15)

WARNING: DO NOT TOUCH THE ANY METAL COMPONENTS OF LIGHT ENGINE WHILE, OR IF RECENTLY, POWERED ON. HEATSINK AND CONNECTING COMPONENTS MAY BE HOT.

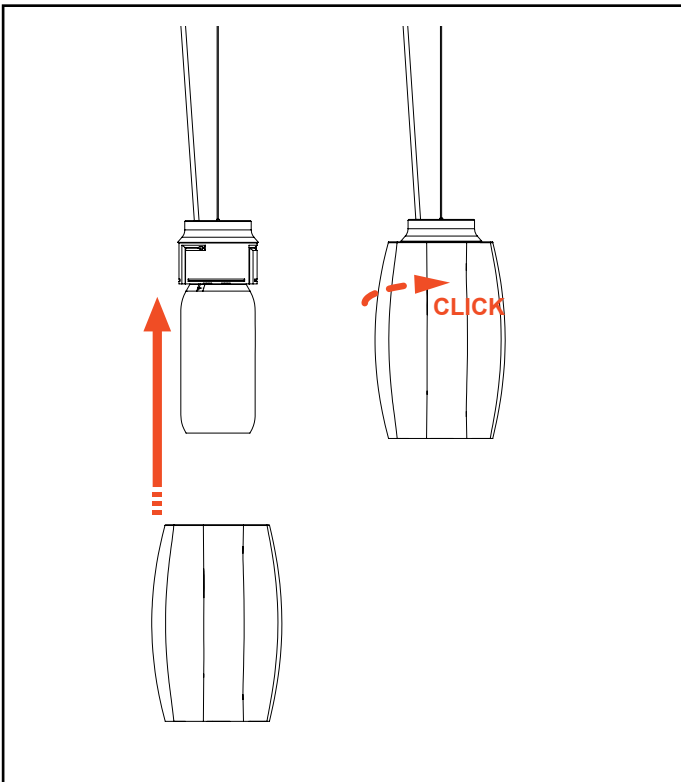

Figure 16

4. Install new shade over light engine/diffuser subassembly by inserting into grooves and twisting to lock in place. (Figure 16)

WARNING: DO NOT TOUCH THE ANY METAL COMPONENTS OF LIGHT ENGINE WHILE, OR IF RECENTLY, POWERED ON. HEATSINK AND CONNECTING COMPONENTS MAY BE HOT.

Replacing Drivers

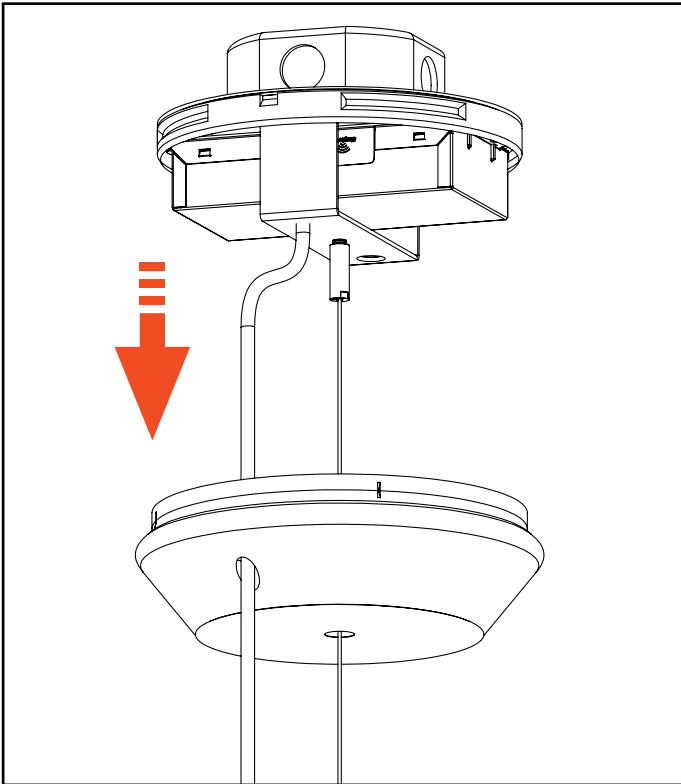

Figure 17

1. Ensure power is off at junction box.
2. Take out the **Canopy Cover (H)** by pulling down. (Figure 17)
3. Disconnect the wiring in the canopy assembly (driver to low voltage connection).

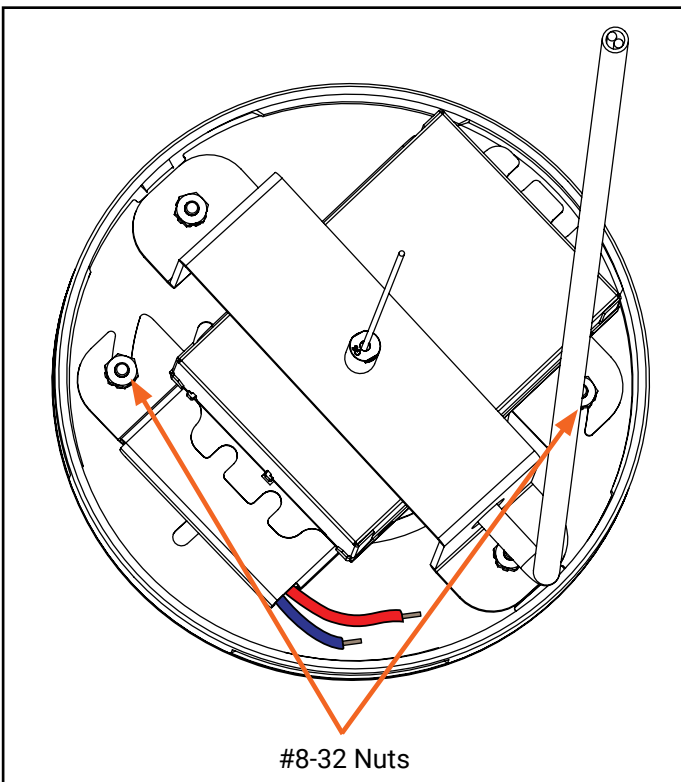

Figure 18

4. Loosen the two **#8-32 nuts (G)** from the **Canopy Plate (B)**. (Figure 18)

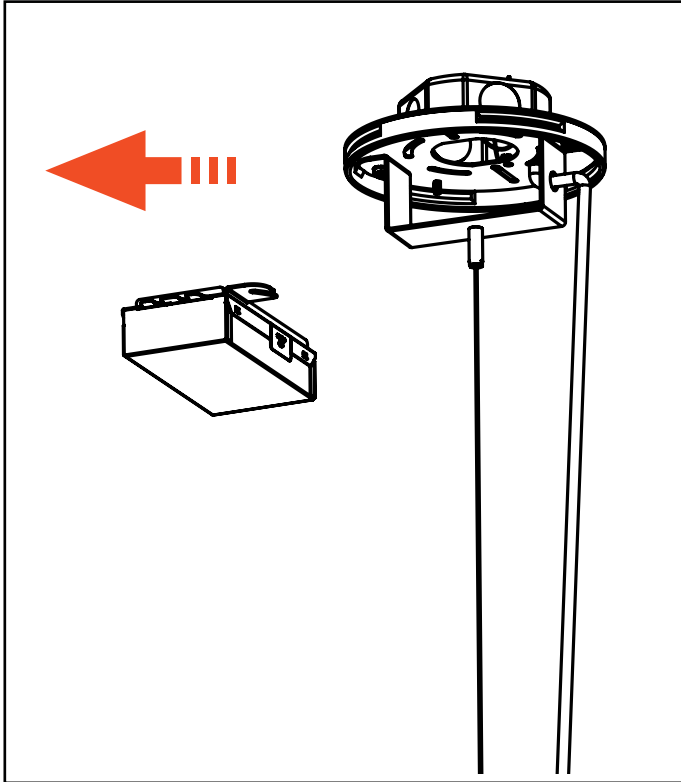

Figure 19

5. Rotate driver subassembly CCW and securely take it out along with **Driver (E)**. (Fig 19)
6. Disconnect the electrical connections in the J-Box.

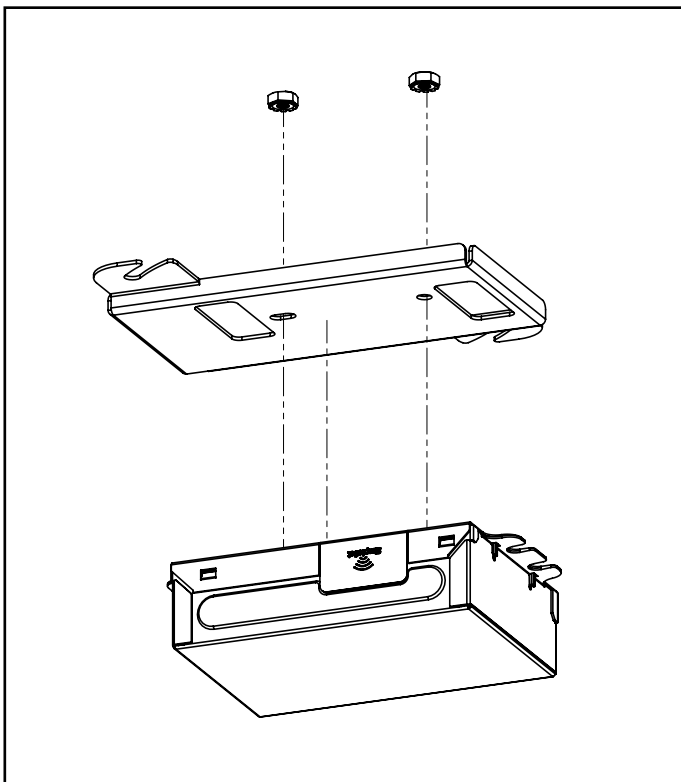

Figure 20

7. Remove two nuts to remove **Driver (E)** from **Driver Enclosure (D)**. Attach new **Driver (E)** to **Driver Enclosure (D)**. (Figure 20)
8. Take the driver subassembly and make the electrical connections as shown in the wiring diagram on page 3.

9. Route the Low voltage wire routing (LED wires) from the **Driver Enclosure (D)**. (Figure 21)

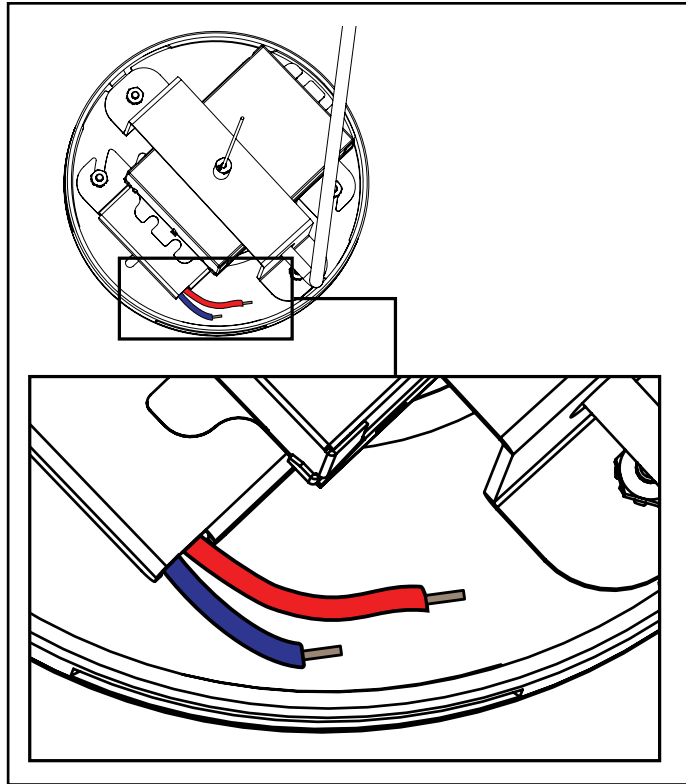

Figure 21

10. Reinstall the driver subassembly by aligning with studs and rotate Clockwise. Secure with two **#8-32 nuts (G)**. Make sure wires will not interfere with assembly while rotating. (Figure 22)

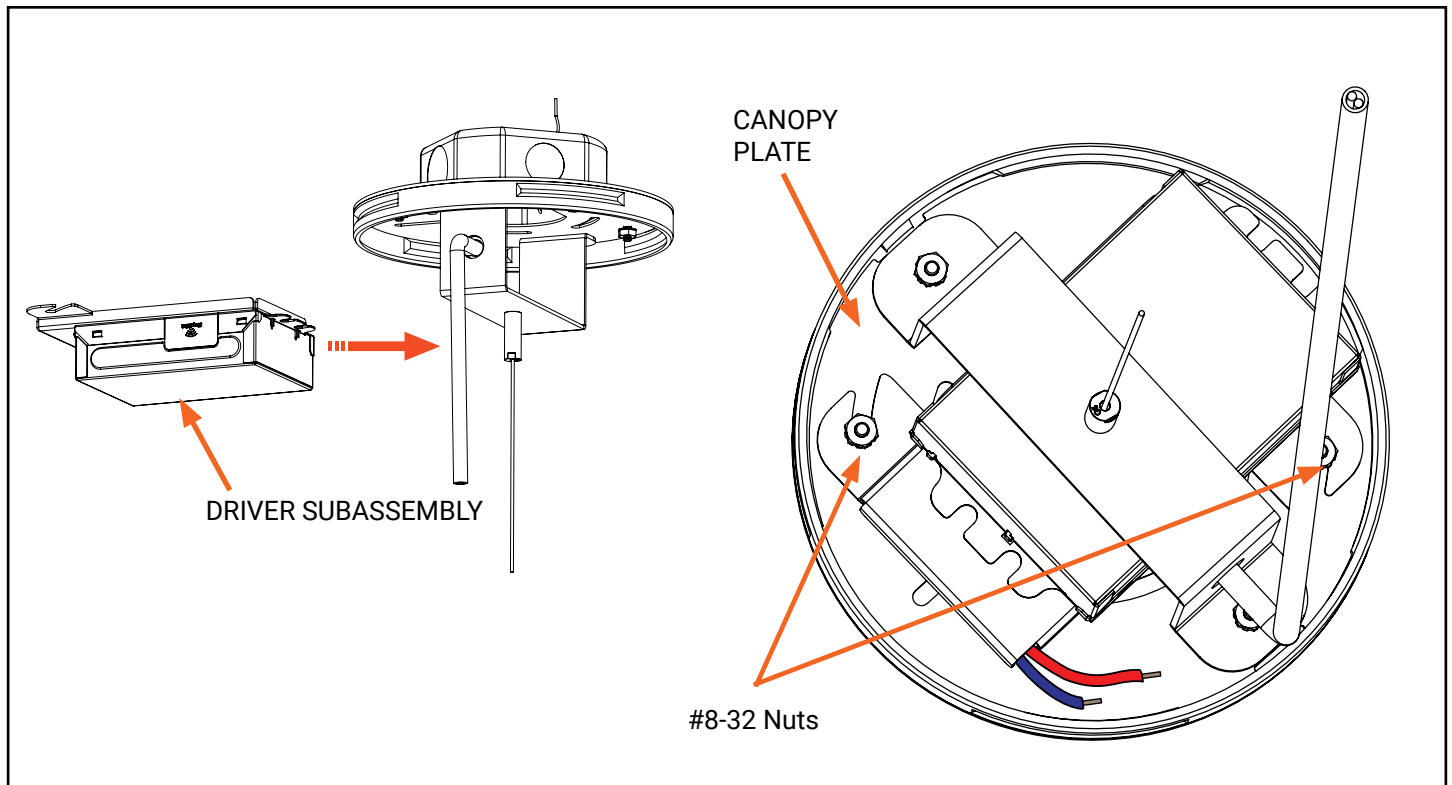

Figure 22

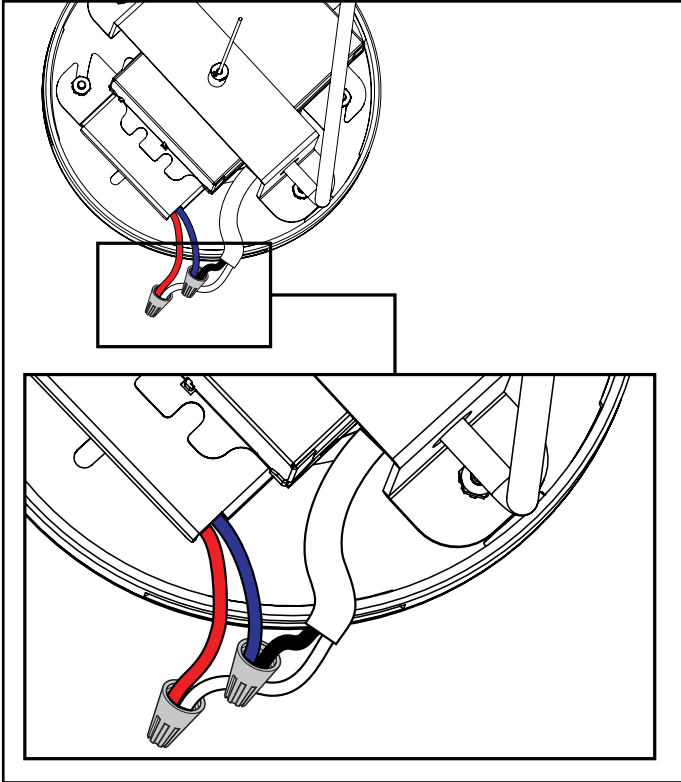

Figure 23

11. Connect the low voltage LED power cord as shown in the wiring diagram on page 3 and Figure 23.

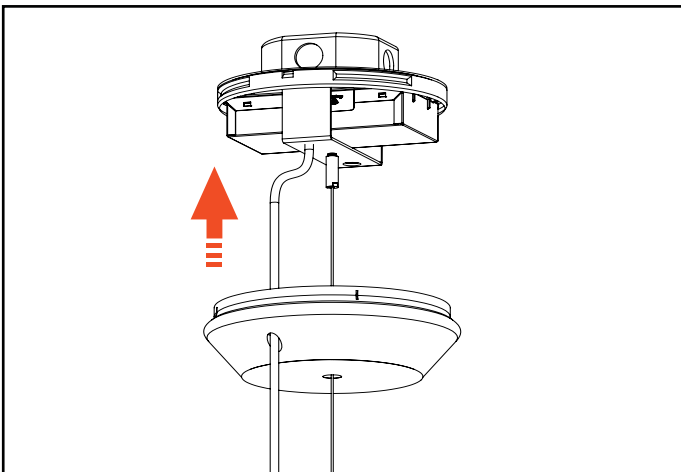

Figure 24

12. Secure back canopy by making sure that low voltage power cord exit in canopy matches with the wire hole in the hold plate and **Aircraft Cable (L)** is passing through the center hole, Press the **Canopy Cover (H)** against the **Canopy Plate (B)**. (Figure 24)

Warranties and Limitation of Liability

Please refer to www.cooperlighting.com/global/warranty for our terms and conditions.

Garanties et limitation de responsabilité

Veuillez consulter le site www.cooperlighting.com/global/warranty pour obtenir les conditions générales.

Garantías y Limitación de Responsabilidad

Visite www.cooperlighting.com/global/warranty para conocer nuestros términos y condiciones.