

Project		Catalog #		Type	
Prepared by		Notes		Date	



Fail-Safe

SGI Sealed and Gasketed

Medical and High Abuse - Recessed
Behavioral Health
1x4 / 2x2 / 2x4
IP65

Typical Applications

Psychiatric Centers • Behavioral Health • Education • Public Gathering Spaces • Patient Rooms • Sterile Environments

Interactive Menu

- Order Information [page 2](#)
- Product Specifications [page 3](#)
- Energy Data and Performance Data [page 3](#)
- Lens Options [page 4](#)
- Product Warranty

Product Certification



Product Features



Top Product Features

- Full bottom clear lens for easy wipe down
- Choose from 6 decorative lens options to add aesthetic appeal to the space
- Inset piano hinge door, or aircraft cable attachment
- Fully gasketed for wet location listing and IP65 compliance
- Extruded aluminum door with clear bottom acrylic or polycarbonate lens
- **Ligature resistant**
- Options to meet Buy American and other domestic preference requirements

Dimensional and Mounting Details

1' x 4'

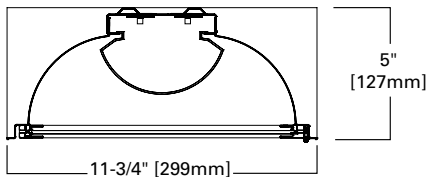

2' x 2' / 2' x 4'

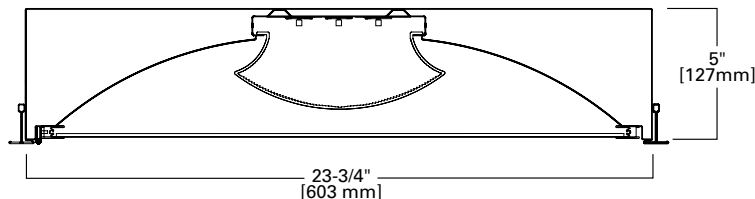

Lens Options

See page 4 for decorative lens options



STRT/BL



STRM/BL



CLSC



BRDR



SWRL



CURV

Order Information

SAMPLE ORDER NUMBER: SGI-G-12-4-LD4-2-STD-40-CA125-FA-CRSW-UNV-EDC2-ASY

Domestic Preferences	Series	Ceiling	Width	Length	LED	No. of LED Modules in Cross-section	Illumination Level	Color Temperature
Domestic Preferences ⁽¹¹⁾	Series	Ceiling	Width	Length	LED	No. of LED Modules in Cross-section	Illumination Level	Color Temperature
[Blank]=Standard BAA=Buy American Act TAA=Trade Agreements Act	SGI=Sealed and Gasketed ⁽¹⁾	G=Grid ⁽⁵⁾ (See Accessories) For flange (sheetrock, hard-lid) ceilings, specify the following: DFCL: Gasketed Drywall Framing Kit ⁽⁴⁾ 2' x 4': DFCL-2448W-U 2' x 4': DFCL-2448AMW-U 1' x 4': DFCL-1248W-U 1' x 4': DFCL-1248AMW-U 2' x 2': DFCL-2424W-U 2' x 2': DFCL-2424AMW-U DFVR: Gasketed Vandal Resistant Drywall Framing Kit 2' x 4': DFVR/SGI-2448W-U 2' x 4': DFVR/SGI-2448AMW-U 1' x 4': DFVR/SGI-1248W-U 1' x 4': DFVR/SGI-1248AMW-U 2' x 2': DFVR/SGI-2424W-U 2' x 2': DFVR/SGI-2424AMW-U	12=12" [Blank]=24"	2=2' 4=4'	LD4=LED 4.0	1=(1) LED Module 2=(2) LED Modules 3=(3) LED Modules (24" wide only)	LO=Low STD=Standard HI=High	30=3000K 35=3500K 40=4000K 50=5000K
Notes (11) Only product configurations with these designated prefixes are built to be compliant with the Buy American Act of 1933 (BAA) or Trade Agreements Act of 1979 (TAA), respectively. Please refer to DOMESTIC PREFERENCES website for more information. Components shipped separately may be separately analyzed under domestic preference requirements.	Notes (1) Hard metric sizes available. Consult factory.	Notes (4) Ceiling cutout dimensions: 2' x 2' = 24-3/8" x 24-3/8"; 2' x 4' = 24-3/8" x 48-3/8"; 1' x 4' = 12-3/8" x 48-3/8". Ships with gasketing applied in field. (5) For 15/16" NEMA G T-bar ceiling system. For 1-1/2" T-bar ceiling systems, please consult factory. Extended lead-times likely.						

Bottom Lens	Diffuser	Door	Voltage	Electronic Driver	No. of Circuits	Options
Bottom Lens	Diffuser	Door ⁽⁹⁾	Voltage	Electronic Driver ⁽⁷⁾	No. of Circuits	Options
CA125=Clear Acrylic, Smooth, 0.125" thick CA187=Clear Acrylic, Smooth, 0.187" thick CP125=Clear Polycarbonate, Smooth, 0.125" thick CP187=Clear Polycarbonate, Smooth, 0.187" thick CP250=Clear Polycarbonate, Smooth, 0.250" thick CP375=Clear Polycarbonate, Smooth, 0.375" thick ⁽¹⁰⁾	FA=Frosted Acrylic, Linear Ribbed Decorative Inlay (2x2, 2x4 only) STRT/BL=Thin Stripe, Blue To order different color of stripe, use BK or RD in place of "BL". BK=Black RD=Red STRM/BL=Medium Stripe, Blue To order different color of stripe, use BK or RD in place of "BL". BK=Black RD=Red CLSC=Classic BRDR=Border SWRL=Swirl CURV=Curve See page 4 for details	CRSW=Die formed steel door, painted matte white ALW=Die formed aluminum door, painted matte white ALXP=Aluminum extruded door, painted matte white ALXPCPH=Aluminum extruded door, painted matte white, continuous piano hinge	UNV=120V-277V 120=120V 277=277V	EDC=Non-Dimming EDD=0-10V Dimming, 10% ED1D=0-10V Dimming, 1% 5LTD=Fifth Light Dali Driver 10%-100% dimming	1=1 Circuit 2=2 Circuits 3=3 Circuits	EL10W=Emergency Battery Pack, 10 watt output ⁽³⁾ GLR=Fuse and Holder AM=Antimicrobial Finish, exposed surfaces TP=Tamper-proof Screws (Torx® T20) ⁽⁶⁾ WL=Wet Location Under Covered Ceiling ASY=Asymmetric distribution (1' x 4' only) IP65=IP65 Rated ⁽⁸⁾ 90=90CRI OS1=Internal occupancy sensor (behind lens), connected to 1 row of LEDs OS2=Internal occupancy sensor (behind lens), connected to all rows of LEDs
Notes (10) CP375 only available with CRSW door.		Notes (9) Continuous piano hinge available with aluminum extruded door only.		Notes (7) EDC3 not available 1' x 4'. Standard EDC_driver, the low voltage leads not connected to driver. EDD_ and ED1D_ driver, low voltage leads are connected to driver.		Notes (3) Emergency option is only available 3LO, (not available 3STD or 3HI), Emergency option is only available 2LO & 2STD, (not available 2HI), Emergency option is available 1LO, 1STD, & 1HI. (6) TP defaults to standard lanyard (aircraft cable) door. Six screws secure the door to the housing. If TP option is specified with ALXPCPH, three screws are used. Counter sunk, stainless steel, Torx® T20. (8) IP65, available with CRSW door only.

Accessories

Accessories (Order Separately) ⁽¹²⁾
VRSD=Vandal Resistant Screwdriver, Torx® T20 MSC4-PK=Mounting Security Clips. Use to secure fixture to grid or to attach tie-wires DFCL-2448W-U*=2' x 4' gasketed drywall framing kit. Ships with gasket to be applied in field. Cut out dimension 24.25" x 48.25" DFCL-1248W-U*=1' x 4' gasketed drywall framing kit. Ships with gasket to be applied in field. Cut out dimension 12.25" x 48.25" DFCL-2424W-U*=2' x 2' gasketed drywall framing kit. Ships with gasket to be applied in field. Cut out dimension 24.25" x 24.25" DFVR/SGI-2448W-U*=2' x 4' gasketed framing kit, vandal resistant. Supplied with (6) countersunk tamper resistant screws. Cut out dimension 24.25" x 48.25" DFVR/SGI-1248W-U*=1' x 4' gasketed framing kit, vandal resistant. Supplied with (6) countersunk tamper resistant screws. Cut out dimension 12.25" x 48.25" DFVR/SGI-2424W-U*=2' x 2' gasketed framing kit, vandal resistant. Supplied with (6) countersunk tamper resistant screws. Cut out dimension 24.25" x 24.25" * Change W to AMW for antimicrobial matte white finish.
Notes (12) Accessories sold separately will be separately analyzed under domestic preference requirements. Consult factory for further information.

Product Specifications

Application

- Designed for use in healthcare facilities and high abuse environments including:
 - Patient rooms
 - Behavioral healthcare areas
 - Detention center
 - Schools
 - Public gathering areas

Housing

- Die-formed 20-gauge construction
- Electrostatically applied, Matte White powder coat finish
- Optional Matte White antimicrobial finish

Fasteners and Gasket

- Flush-mount, stainless steel machine screws secure door to housing
- Screws are evenly spaced to compress gasketing on all sides
- Closed cell gasketing between housing and door
- Optional stainless steel tamper-resistant T20 TORX® screws with center pin reject standard

Door

- One-piece inset, fully gasketed, steel or aluminum extruded door
- Matte White polyester powder coat finish
- Two stainless steel aircraft cables to attach door to housing is provided along with 6 counter sunk stainless steel phillips-head screws

Lens

- Frosted Inner Diffuser
 - Linear ribbed, frosted acrylic lens; 0.100" thickness
 - Optional clear acrylic with perforated and decorative inlays
- Decoative Inlays
 - 6 inlay patterns (2 x 2 and 2 x 4 only) include colored Thin Strip or Medium Strip (Blue, Black and Red), and Classic, Border, Swirl and Curve (see page 4)
- Clear Bottom Lens
 - Clear acrylic or polycarbonate; 0.125" or 0.187" thickness
 - Clear polycarbonate; 0.250" thickness
 - Clear polycarbonate; 0.375" thickness; Available with steel door only

Mounting

- Compatible with 15/16" NEMA G T-bar system
- Specify DFCL drywall framing kit for NEMA F Flange (hard pan ceilings) applications

LEDs

- Available in 3000K, 3500K, 4000K and 5000K; 80 CRI minimum
- Choice of Standard, Low or High illumination levels
- Projected life is 50,000 hours at 70% lumen maintenance

Electrical

- Electronic driver 120-277V, dimming driver standard
- 0-10V dimming down to 1% or 10%
- Non-dimming available

Compliances

- cULus listed for damp locations
- Wet location listed under covered ceiling optional
- IP65 rated from below the luminaire/ceiling when specified in the ordering logic

Warranty

- Five year limited warranty on LEDs and Electrical, consult website for details. www.cooperlighting.com/legal

Energy and Performance Data

[View IES files](#)

SGI with 0.125" thick Clear Acrylic Lens, Frosted Acrylic Diffuser

Number of Modules, Level	2' x 4'		2' x 2'		1' x 4'	
	Input Watts	Delivered Lumens*	Input Watts	Delivered Lumens*	Input Watts	Delivered Lumens*
1LO	27.2	1677	13.1	864	23.9	2098
1STD	36.6	2342	18.3	1153	34.1	2794
1HI	47.2	2945	23.6	1534	45.1	3405
2LO	52.4	4738	26.2	2268	52.4	4086
2STD	73.2	6310	36.6	3021	73.2	5441
2HI	90.2	7689	45.0	3681	90.1	6630
3LO	78.6	7100	39.3	3376	N/A	N/A
3STD	109.8	9455	54.9	4496	N/A	N/A
3HI	135.1	11521	67.5	5479	N/A	N/A

Lumen Multipliers For Decorative Lenses	
Thin Blue Stripe	0.98
Medium Blue Stripe	0.96
Swirl	0.83
Curve	0.85
Classic	0.91
Border	0.89

Nominal input wattage values include LED voltage, drive current and typical driver efficiency. Refer to LM79 test data/ photometric files for exact delivered lumen values, as values above are nominal/approximate.

* Delivered lumens will decrease by approximately 3% for 0.125" clear polycarbonate.

* Delivered lumens will decrease by approximately 6% for 0.250" clear polycarbonate (relative to 0.125" thick acrylic).

* 1' x 4' photometry in-progress.

Lens Options



STRT/BL = Thin Stripe, Blue BL=BLUE
BK=BLACK
RD=RED



STRM/BL = Medium Stripe, Blue BL=BLUE
BK=BLACK
RD=RED



CLSC=Classic



BRDR=Border



SWRL=Swirl



CURV=Curve