

**Description**

H1499TCP is a Non-IC housing designed for non-insulated Chicago Plenum rated ceilings. H1499TCP features an integral low voltage dual-tap 120V/277V transformer that supplies 12 volts to MR16 lamps. H1499TCP is for non-insulated ceilings. If installed in insulated ceilings, insulation must be kept 3 inches away from all sides of housing.

Catalog #		Type
Project		
Comments		Date
Prepared by		

**Specification Features**

**Housing**

Formed of CRS with white powder coat finish

**Plaster Frame**

- Galvanized steel die-formed construction
- The housing can be removed from plaster frame to provide access to the junction box
- Plaster frame features include:
  - Regressed locking screw positioned for securing hanger bars from below the ceiling
  - Cutouts for easily crimping hanger bars in position
  - Halo identity embossed on plaster frame

**Junction Box:**

- Positioned to accommodate straight conduit runs
- Six 1/2" trade size conduit knockouts
- Gasketed junction box per Chicago Plenum standards

**Includes:**

**Got Nail!™**

- Pre-installed nail easily installs in regular lumber, engineered lumber and laminated beams
- Safety and guidance system prevents nail snagging, ensures smooth straight nail penetration and allows bar hangers to be easily removed if necessary

- Automatic leveling flange aligns the housing and lets you hold the housing in place with one hand while driving nails
- Five additional mounting points
- Mounting point on top for hanger wire connection
- Integral T-bar clips snaps onto T-bars - no additional clips required

**Pass-N-Thru™ bars**

- Pass-N-Thru™ allows the bars to pass through each other for tool-less shortening in tight spots less than 12" without removing from the plaster frame. Push bars together and flex at score lines until excess can be removed
- Housing positions at any point within 24" joist span
- Bar hangers may be repositioned 90° on the frame on select housings
- (1) Locking screw and multiple crimp points on plaster frame secure bars in place

**Quick Connect™ push wire nuts**

- cULus Listed 24 in<sup>3</sup> box volume, listed for through-branch (8) No. 12 AWG branch circuit 90° C conductors through the box Quick Connect™
  - (3) Push wire nuts included, for speed & reliability
  - Clear caps for wire connection visibility
- Chicago Plenum

**Transformer**

Integral 120/277V dual-tap magnetic transformer steps line voltage down to 12V nominal lamp operating voltage. Rated for 50W max. Housing ships as 277V model with 120V transformer wire lead capped. For use in 120V systems, simply cap the 277V wire lead and use 120V lead (refer to wiring diagram).

**Socket**

GU5.3 socket with reflector plate for bi-pin 12V MR16 lamps

**Thermal Protector**

Self resetting thermal protector deactivates fixture if overheating occurs due to improper lamping

**Compliance**

- cULus Listed damp location
- cULus Listed for wet location, covered ceiling, with select trims
- cULus Listed for feed through
- City of Chicago Plenum



**H1499TCP**

**4" Non-IC,  
New Construction,  
120V/277V - 12V Low  
Voltage, MR16,  
Chicago Plenum**

DISCONTINUED  
16-05-2024



**Dimensions**

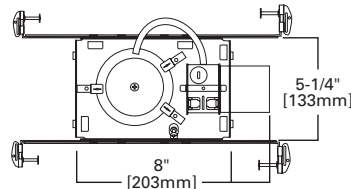
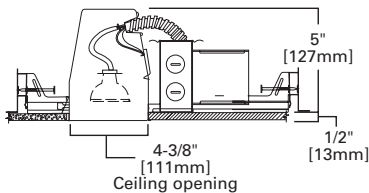

**Special Features**

- Got Nail!™ bar hangers
- Pass-N-Thru™ bars
- Quick Connect™ push wire nuts

## Ordering Information

Sample Number: H1499TCP 1421W

Order housing, trim and lamp (by others) separately for a complete luminaire.

## Housing

H1499TCP = 4" Non-IC, New Construction, 120V/277V - 12V Low Voltage, MR16, Chicago Plenum

## Trims

### Reflectors

#### 1421 Precision Reflector - 35° Tilt

OD: 5-1/16" [129mm]

1421W=White Reflector with White Trim Ring

1421C=Specular Clear Reflector with White Trim Ring

1421H=Haze Reflector with White Trim Ring

1421CG=Champagne Gold Reflector with White Trim Ring

1421RG=Residential Gold Reflector with White Trim Ring

1421MB=Specular Black Reflector with White Trim Ring

1421SN=Satin Nickel Reflector with Satin Nickel Trim Ring

1421TBZ=Tuscan Bronze Reflector with Tuscan Bronze Trim Ring

### Baffles

#### 1419 Pinhole Baffle

OD: 5-1/16" [129mm]

1419P=Black Baffle, White Trim Ring

1419W=White Baffle, White Trim Ring

1419SN=Black Baffle, Satin Nickel Trim Ring

1421TBZ=Black Baffle, Tuscan Bronze Trim Ring

#### 1493 Coilex® Baffle - 35° Tilt

OD: 5-1/16" [129mm]

1493P=Black Baffle, White Trim Ring

1493BC=Black Baffle, Black Chrome Trim Ring

1493W=White Baffle, White Trim Ring

1493SN=Black Baffle, Satin Nickel Trim Ring

1493TBZ=Black Baffle, Tuscan Bronze Trim Ring

#### 1453 Precision Metal Baffle - 35° Tilt

OD: 5-1/16" [129mm]

1453SN=Satin Nickel Baffle, Satin Nickel Trim Ring

1453TBZ=Tuscan Bronze Baffle, Tuscan Bronze Trim Ring

### Adjustables

#### 1420 Adjustable Slot Aperture - 35° Tilt

OD: 5-1/16" [129mm]

1420P=White

1420SN=Satin Nickel

1420TBZ=Tuscan Bronze

#### 1498 Adjustable Eyeball with Baffle - 30° Tilt

OD: 5-1/16" [129mm]

1498P=White Eyeball, Black Baffle

1498W=White Eyeball, White Baffle

1498BC=Black Chrome Eyeball, Black Baffle

1498SN=Satin Nickel Eyeball, Black Baffle

1498TBZ=Tuscan Bronze Eyeball, Black Baffle

#### 1495 Adjustable Gimbal - 30° Tilt

OD: 4-3/4" [120mm]

1495P=Satin White

1495SN=Satin Nickel

1495TBZ=Tuscan Bronze

#### 1496 Retractable Elbow - 60° Tilt

OD: 5" [127mm]

1496P=White Eyeball and Trim Ring

1496SN=Satin Nickel Eyeball and Trim Ring

1496TBZ=Tuscan Bronze Eyeball and Trim Ring

#### 1497 Adjustable Mirror Trim - 90° Tilt

OD: 5" [127mm]

1497P=White

### Shower Light

#### 1945 Metropolitan Ice Light

OD: 5" [127mm]

1945=Clear Frosted

1945B=Blue Frosted

#### 1946 Metropolitan Deco

OD: 5" [127mm]

1946BC=Black Chrome Accent with Green Tint Translucent Rings

### 1951 Regressed Lens Shower Light

OD: 5-1/16" [129mm]

1951PS=Shower Light, White Trim Ring, Specular Reflector

1951SNS=Shower Light, Satin Nickel Trim Ring, Specular Reflector

1951TBZS=Shower Light, Tuscan Bronze Trim Ring, Specular Reflector

## Mounting Accessories

### Filters and Lenses

The following filters and lenses can be substituted for the cover glass supplied for use with MR16 lamps.

### Color Filters

L112=Red Gel Filter

L114=Ultraviolet Dichroic Filter

L120=Red Dichroic Filter

L121=Amber Dichroic Filter

L122=Yellow Dichroic Filter

L123=Green Dichroic Filter

L124=Daylight Blue Dichroic Filter

L125=Blue Dichroic Filter

L127=Cosmetic (2700°K) Dichroic Filter

L121=Yellow Gel Filter

L121=Amber Gel Filter

### Optical Lenses

L100N=Diffuse Sand Blasted Lens. Provides an even beam spread from MR16 lamps-especially useful in wall washing.

L111=Soft Focus Lens. Smooths irregular beam pattern while maintaining high controlled illumination levels and beam angles.

L113=Prismatic Spread Lens. Provides a symmetrical broadening of MR16 lamp beams.

L115=Fans the MR16 beam to produce a wide rectangular illumination pattern.



For use in Halo listed housings.