

Project		Catalog #		Type	
Prepared by		Notes		Date	



# Ephesus

## PRISM RGBA

### RGBA LED Sports & Entertainment Luminaire

#### Typical Applications

Pro Arenas • University & Collegiate Arenas • University & Collegiate Stadiums • Multi-Event & Convention Centers • Gymnasiums & Field Houses

#### Interactive Menu

- Dimensional Details [page 1](#)
- Ordering Information [page 2](#)
- Performance & Optical Performance Data [page 4](#)
- Required Mounting Options and Accessories [page 3](#)
- Sample System Topology [page 6](#)

#### Product Certification



### Top Product Features

- Custom-engineered optics precisely direct light while minimizing glare
- Control options provide flexibility and fan experience effects
- Rugged and weather-tight for use even in harsh environments
- Solid state design means no moving parts - maintenance-free operation
- Not for use as an architectural floodlight
- Options to meet Trade Agreements Act requirements

### Dimensional Details

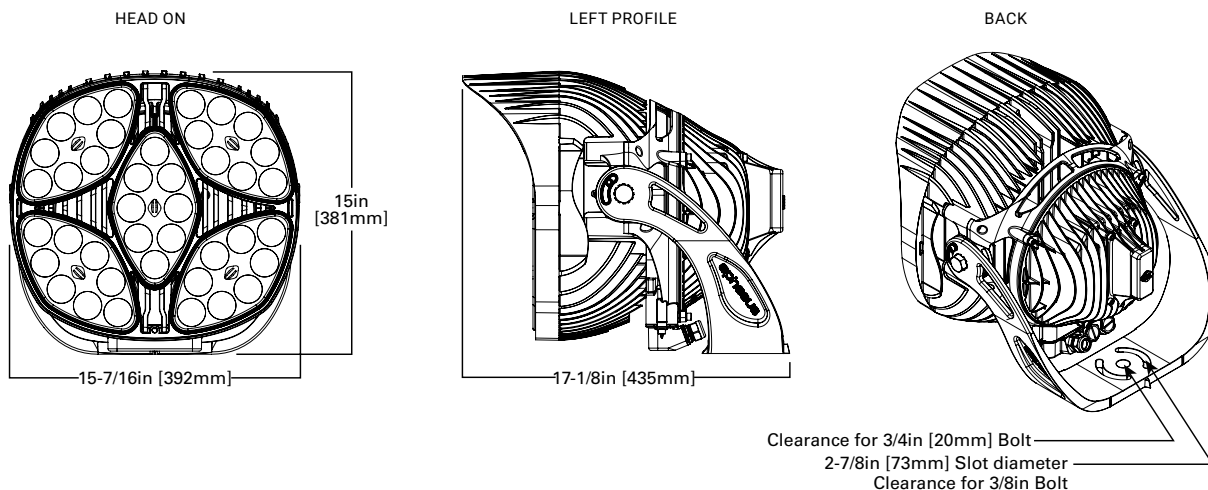

[Installation Instructions](#)

## Order Information

Sample Number: **PM-RGBA-2-VH-BLK-LB**

Model	Colors	Optics	Voltage	Luminaire Color	Controls
Series <sup>1</sup>	Model	Optics	Voltage	Luminaire Color	Controls
<b>PM</b> = Prism, Standard <b>TAA</b> =Trade Agreements Act <sup>1</sup>	<b>RGBA</b> = Red/Green/Blue/Amber	<b>2</b> = NEMA2 <b>3</b> = NEMA3 <b>4</b> = NEMA4 <b>5</b> = NEMA5	<b>VH</b> = High Voltage <b>VL</b> = Low Voltage	<b>BLK</b> = Black <b>WHT</b> = White	<b>LB</b> = Wired DMX <b>AM</b> = Wireless AirMesh
Notes			Notes	Notes	
(1)Only product configurations with this designated prefix are built to be compliant with the Trade Agreements Act of 1979 (TAA). Please refer to <a href="#">DOMESTIC PREFERENCES</a> website for more information. Components shipped separately may be separately analyzed under domestic preference requirements.			(2) <b>VH</b> voltage configuration only available in <b>BLK</b> = Black luminaire color units.	(3) <b>WHT</b> luminaire color only available in <b>VL</b> = Low Voltage units.	

## Performance Data

	Prism RGBA
<b>Lumen Output Range by Color</b>	
<b>Red</b>	13665 - 14069
<b>Green</b>	10973 - 11295
<b>Blue</b>	1972 - 2032
<b>Amber</b>	11436 - 11774
<b>System Wattage</b>	675
<b>Input Voltage</b>	
<b>High Voltage</b>	277-480VAC
<b>Low Voltage</b>	120-240VAC
<b>Operating Temperature Range</b>	-40°C to +55°C
<b>Surge</b>	10kV
<b>NEMA Rating</b>	NEMA 4X
<b>Effective Projected Area (EPA)</b>	1.8 (sq. ft.)
<b>Approximate Weight<sup>1</sup></b>	45 lbs. (20.45kgs.)

### NOTES:

The specifications listed were obtained under optimal testing conditions. Changes in options, features and conditions may result in slightly different performance specifications among luminaires.

(1)Weight may vary depending on mounting bracket selection.

## Optical Performance Data

OPTIC	NEMA TYPE	LED TYPE	LUMENS	INPUT POWER (W)	BEAM ANGLE	FIELD ANGLE
2	NEMA 3	RED	13775	232	18.5	42.7
		GREEN	11059	150	18.5	42.7
		BLUE	1591	129	18.5	42.7
		AMBER	11527	160	18.5	42.7
3	NEMA 3	RED	14015	232	28.3	44.0
		GREEN	11252	150	28.3	44.0
		BLUE	1619	129	28.3	44.0
		AMBER	11729	160	28.3	44.0
4	NEMA 4	RED	14069	232	38.6	58.6
		GREEN	11295	150	38.6	58.6
		BLUE	1626	129	38.6	58.6
		AMBER	11774	160	38.6	58.6
5	NEMA 5	RED	13665	232	45.0	78.1
		GREEN	10973	150	45.0	78.3
		BLUE	1578	129	47.2	78.6
		AMBER	11436	160	45.8	79.2

## Ordering Information for Diving Board (EH-0406) Mounting Option and Accessories

Part Number	Description	Intended Use
<b>EH-0406</b>	<b>Diving Board Mount and Hardware Kit</b> <b>1 qty:</b> Welded Bracket <b>2 qty:</b> Bolt Sleeve (2 qty) <b>2 qty:</b> 3/4in x 6in ASTM325 Bolt Galvanized <b>2 qty:</b> 3/4in Washer ASTM325 Galvanized <b>2 qty:</b> 3/4in Ext Tooth Washer <b>2 qty:</b> 3/4in Hex Nut ASTM325 Galvanized	<b>Retrofit mounting accessory to a 2in x 4in crossarm and the hardware to secure the Diving Board mount to the crossarm</b> (Note, additional EH-0405 All Field Hardware Kit needed to secure Luminaire to the diving board).
<b>EH-0405</b>	<b>1 qty:</b> 3/4in x 2in ASTM325 Bolt Galvanized <b>1 qty:</b> 3/4in Washer ASTM325 Galvanized <b>1 qty:</b> 3/4in Ext Tooth Washer <b>1 qty:</b> 3/4in Hex Nut ASTM325 Galvanized	<b>Hardware kit needed to secure All Field Luminaire to the EH-0406 Diving Board Mount</b>

## Diving Board Mounting Details

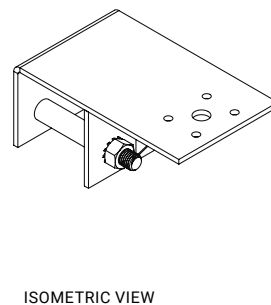
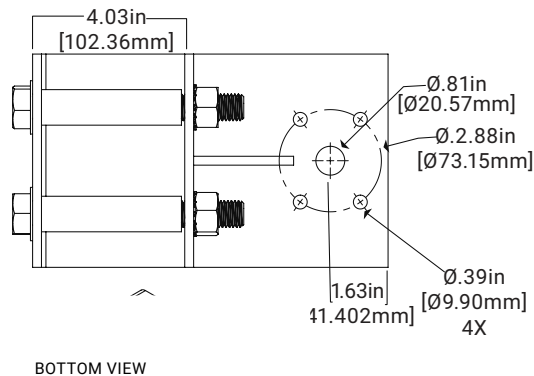
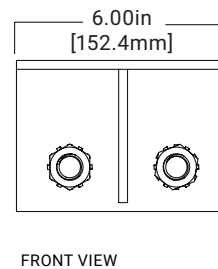
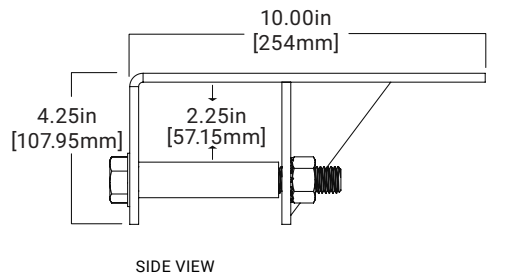

## Ordering Information for Extension Plate (EXTPLT) Mounting Option and Accessories

NOTE: A complete accessory order requires a selection entry for **Brand, Accessory, Option**.

SAMPLE ORDER NUMBER: **EPH-HRDM34-025**

Brand	Accessory	Option	
Brand	Accessory	Option	Intended Use
EPH = Ephesus	EXTPLT = Extension Plate <sup>1</sup>	025 = .25in 050 = .5in 200 = 2.0in	Extension Plate Kit to mount to structures .25in, .5in, or 2.00in thick. Designed to be used with the LUMASPORT 8, LUMADAPT 8, PRISM RGBA & ALL FIELD luminaires only.
	HRDM58 = Mounting Hardware 5/8in diameter	050 = .375in - .50in Range of Clamping Thickness <sup>2</sup> 200 = 2in Clamping Thickness <sup>2</sup>	<b>HRDM58-050:</b> .375- .500in clamping thickness, Use for Extension Plate (EXTPLT) or other flat surfaces drilled for 5/8in hardware  <b>HRDM58-200:</b> 2.00in clamping thickness, use for 2in x 4in Cross arms that are drilled for 5/8in hardware
	Notes: (1) Additional mounting fastener hardware kit needed to attach a fixture to the EXTPLT = Extension Plate	Notes: (2) Option only available for use with HRDM58	

### HRDM58 Dimension and Part Details:

#### HRDM58-050:

.375-.500in clamping thickness, Use for Extension Plate (EXTPLT) or other flat surfaces drilled for 5/8in hardware

#### HRDM58-200:

2.00in clamping thickness, use for 2in x 4in Cross arms that are drilled for 5/8in hardware

#### HRDM58 Data

MODEL #	WEIGHT (LBS)
HRDM58-050	.65
HRDM58-200	.84

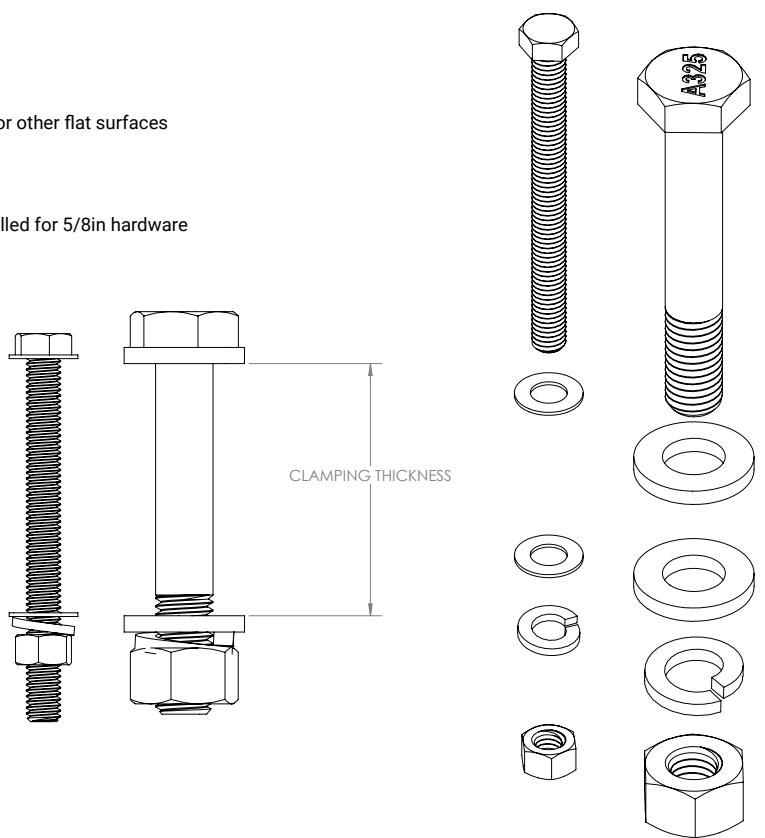



## Example System Topology (Wired DMX Controls)

Example system topology showing the **PRISM RGBA** System in commonly used wired DMX Control Installations. Refer to the specifications and limitations of your wired DMX control device before installing this configuration.

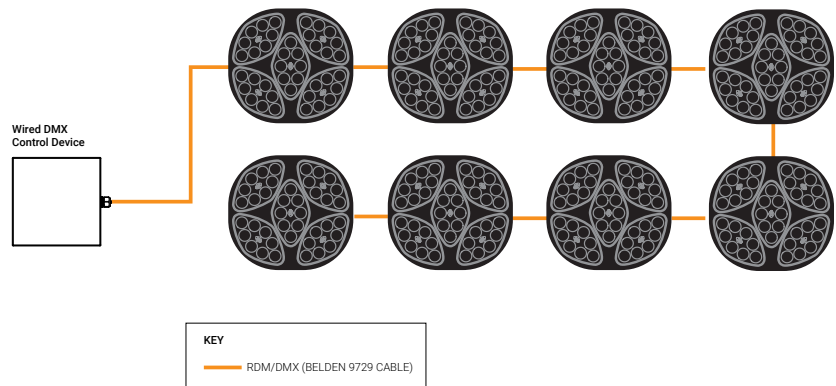

## Example System Topology (Remote Access Point With Wired DMX Controls)

Example system topology showing the **PRISM RGBA** System in a commonly used remote access point with wired DMX Control Installation. Refer to the specifications and limitations of your wired DMX control device before installing this configuration. Note: Laptop or mobile device not included. A cellular network connection requires a cellular carrier network plan.

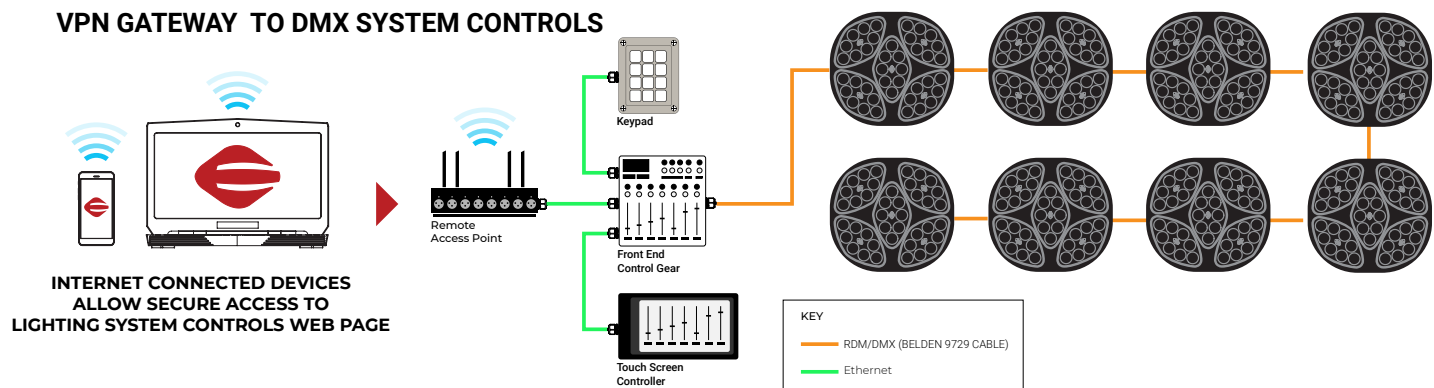

### NOTES:

Remote Access Point requires either a wired Internet connection at the lighting system site or through a cellular carrier network connection plan.

### Example System Topology (Wireless AirMesh Controls)

Example system topology showing the **PRISM RGBA** System in a Wireless AirMesh Control Installation.

Note: Laptop or mobile device not included. A cellular network connection requires a cellular carrier network plan.

