

Project		Catalog #		Type	
Prepared by		Notes		Date	



# WaveLinx Wired

## Mobile App

iCANnet control from a mobile device or tablet

### Typical Applications

Office • Education • Healthcare • Hospitality • Retail  
Industrial • Manufacturing

### Interactive Menu

- Order Information page 2
- Additional Resources page 3
- Connected Systems page 4
- Product Warranty

### Product Certification



- Apple® iOS® v11 and greater and supporting hardware
- Android™ version 7 and greater and supporting hardware

### Product Features



Manual Dimmer



Daylighting Control



Manually Switched ON/OFF



Task Tuning



Scheduling



Lumen Maintenance Control

### Top Product Features

- Mobile user interface for controlling WaveLinx Wired network
- Fast and intuitive control of a complete lighting system to a hand held device
- Navigate floors and rooms to choose, adjust, and save lighting scenes with simple touch control operation
- Mobile applications must be used in conjunction with the WaveLinx Wired EG2-NA Ethernet Gateway device for network access - Supports multiple iPhone® and iPad® devices on same network
- At turn on of the mobile device the EG2-S-NA will recognize and auto populate the mobile device with the latest layout, scene and level settings for immediate use. The EG2-S-NA requires initial commissioning and setup
- Installations may support multiple devices and varying security levels permitting only authorized user to make alterations
- Screen views can be personalized with custom background images via the mobile device
- Area, room, and floor labels may be individually tailored for the installation at setup
- Application includes demo program to preview and learn operational capabilities prior to commissioning
- Bi-directional control and feedback
- Automatically loads room and scene information
- Selective password protection
- Adjust and save changes
- Customizable background images
- Intuitive fader and switch icons
- Ideal hand held device for maintenance or operational adjustment not requiring a service engineer

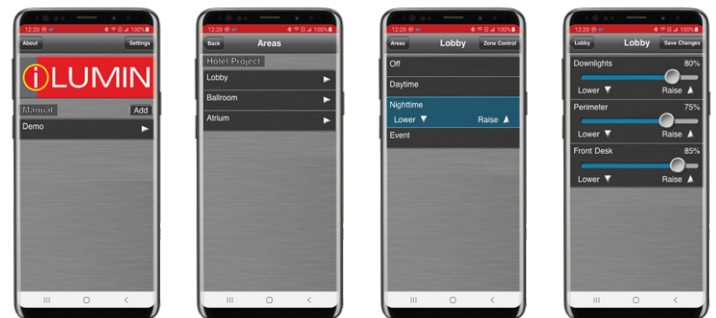

## Order Information

The WaveLinx Wired Mobile app can be downloaded via the Apple App Store or Google Play and is an accessory to the WaveLinx Wired network.

## Product Specifications

### Key Features

- Mobile user interface for controlling WaveLinx Wired network
- Bi-directional control and feedback
- Supports multiple iPhone® and iPad® devices on same network
- Automatically loads room and scene information
- Selective password protection
- Adjust and save changes
- Customizable background images
- Intuitive fader and switch icons

### Software Specifications

#### Operating System Supported:

- Apple® iOS® v11 and greater and supporting hardware
- Android™ version 7 and greater and supporting hardware

**Devices Supported:** Smartphones and tablets

#### Code Commissioning

- Create areas, scenes & zones

## Typical schematic

Application requires installation of Ethernet Gateway (EG2-NA) providing a connection between an iCAN network and an Ethernet LAN.

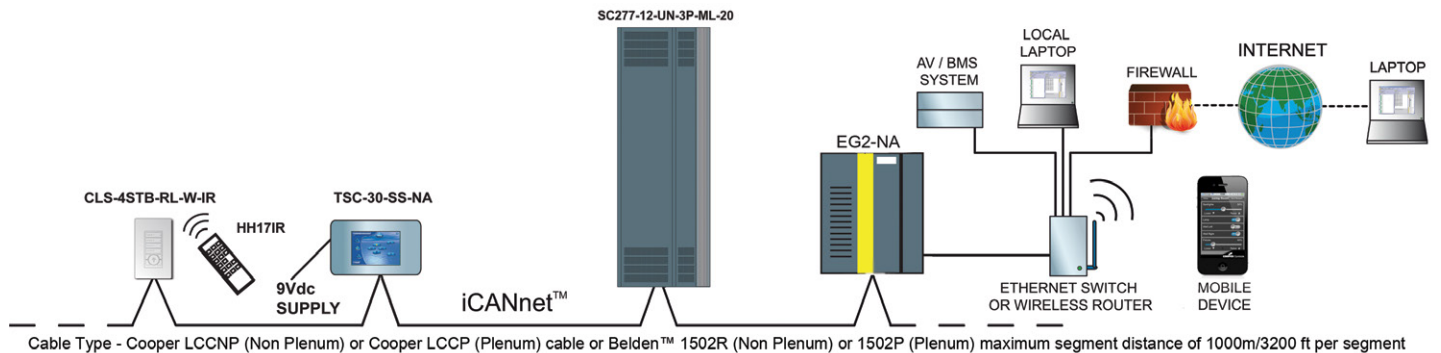

## System architecture

Simple WaveLinx wired system

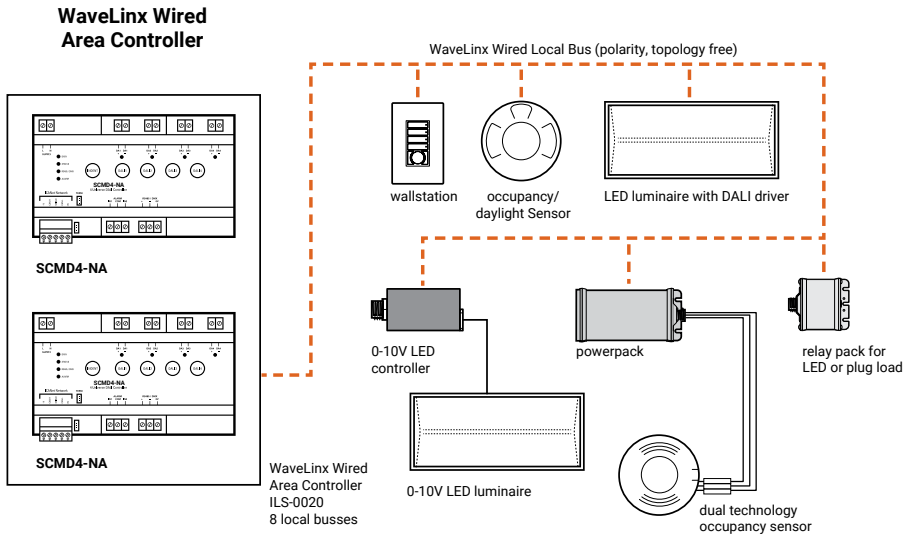

## Complete WaveLinx wired system

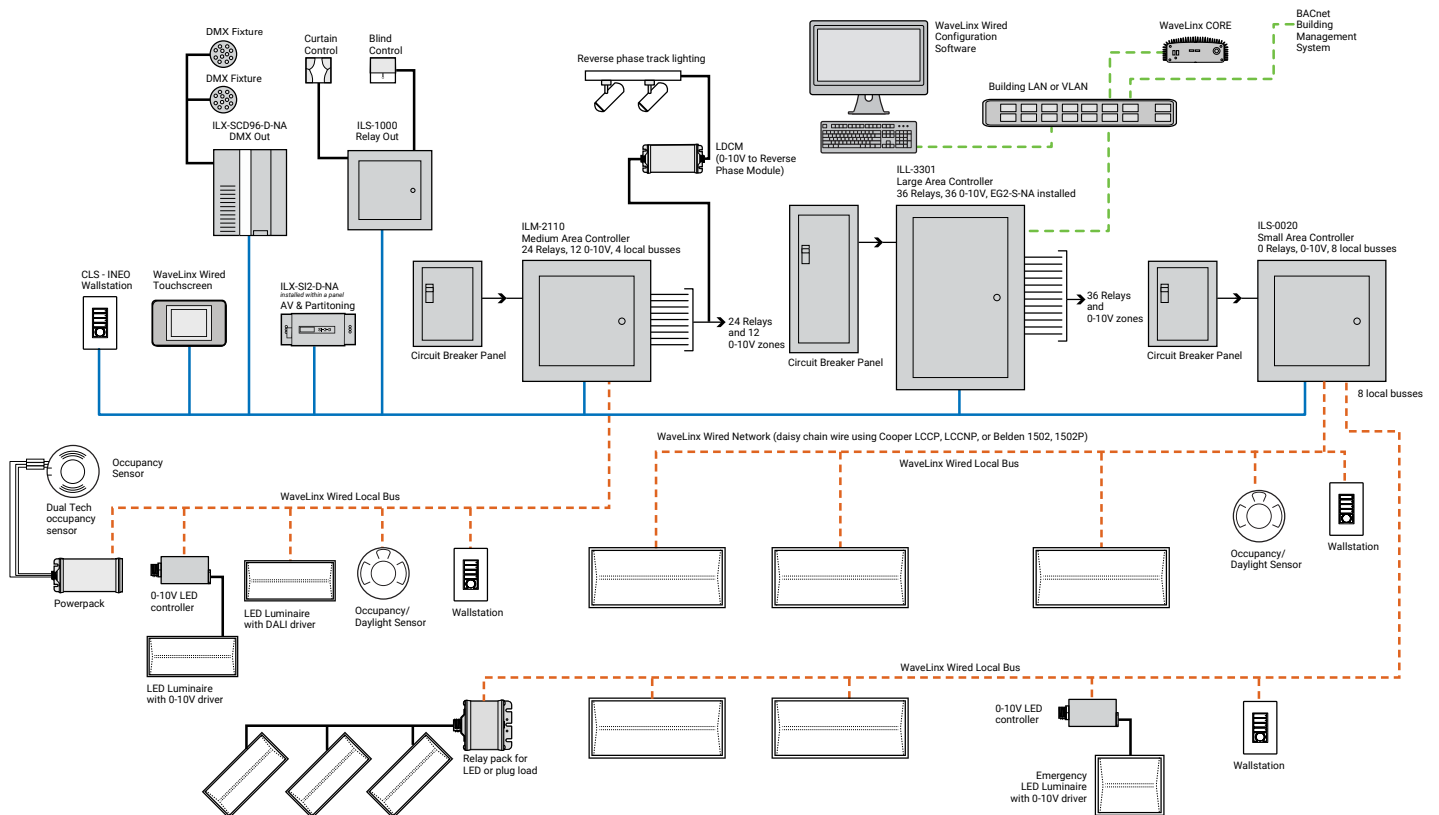

## Sample System Topology:

This diagram shows the main components of the WaveLinX wired and PRO wireless connected lighting system.

The **WaveLinX PRO wireless system** communicates using wireless mesh technology based on the IEEE 802.15.4 standard. A PoE LAN connection for each WaveLinX Area Controller (WAC) is required for power and data access to the building lighting network.

The **WaveLinX wired system** controls the devices using relay, 0-10V, DMX and the WaveLinX wired digital local bus. The WaveLinX wired system connects to the building LAN using the EG2 module. Each WaveLinX wired area controller communicates on the WaveLinX wired network.

WaveLinX Area Controllers (WAC) and WaveLinX Ethernet Gateways (EG2) communicate with WaveLinX CORE over the Ethernet network.

Please refer to the WaveLinX PRO Wireless Network and IT Guidance Technical Guide and WaveLinX Wired Network and IT Guidance Technical Guide for more information.

 [View WaveLinX Network and IT Guidance Technical Guide](#)

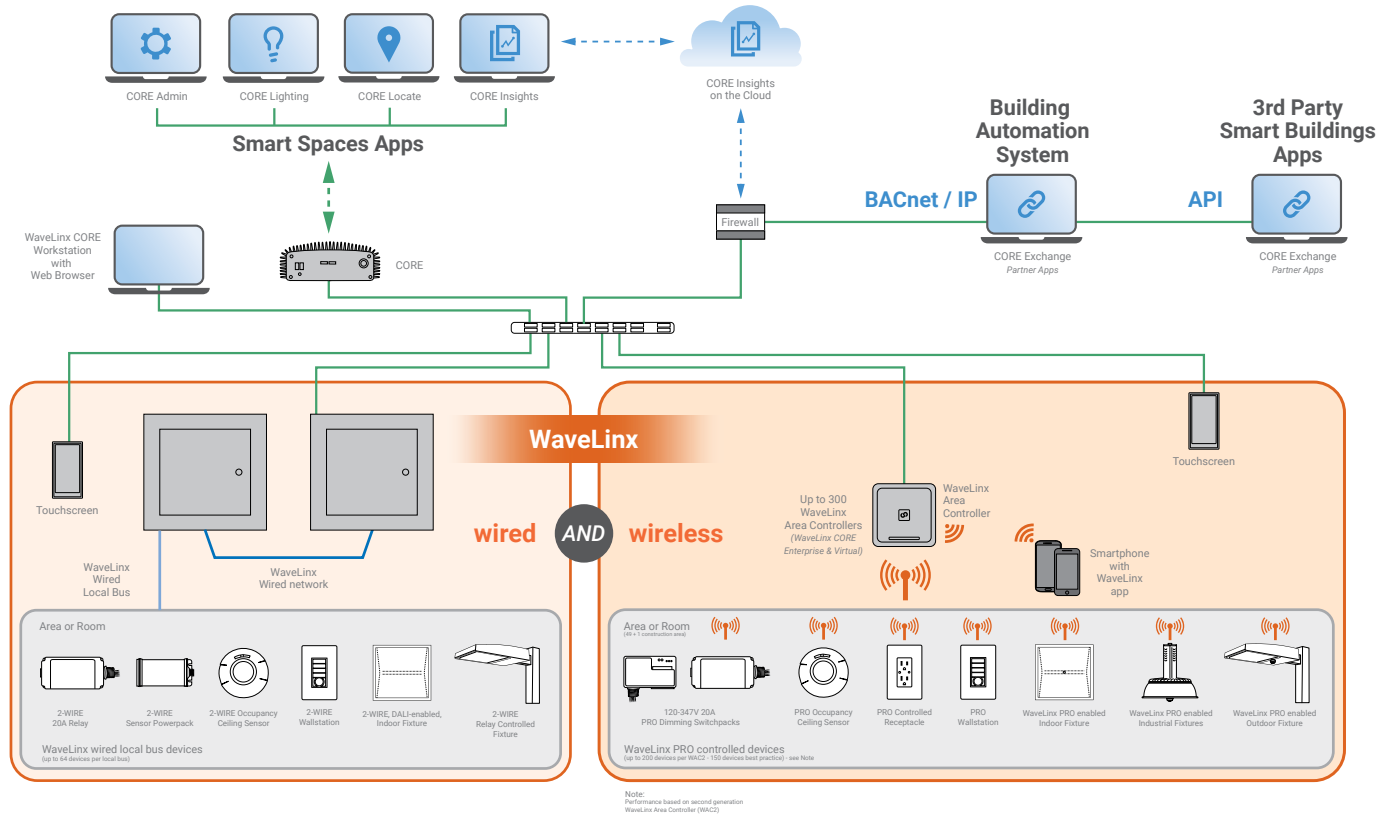

## Control Systems

- WaveLinX
- WaveLinX wired
- VividTune