

Project		Catalog #		Type	
Prepared by		Notes		Date	



## Lumière

### EON 303-S1-LEDB1

Ceiling / Wall Mount

#### Typical Applications

- Hospitality • Commerical Landscape • Outdoor Area/Site • Residential
- Architectural

#### Interactive Menu

- Order Information [page 2](#)
- Product Specifications [page 2](#)
- Lumen Maintenance [page 3](#)
- Product Warranty

#### Product Certification



#### Product Features



#### Top Product Features

- 180° Adjustability at the knuckle
- 2700K, 3000K, 3500K or 4000K Color Temperature and Amber (585-595nm)
- Forward/Lateral Throw or Flood Optics with diffuse glass sealed lens
- Patented AccuLED Optics™ System
- Universal Input LED Driver Included (120 - 277V, 50/60 Hz)
- ELV or 0-10 Dimming

#### Dimensions

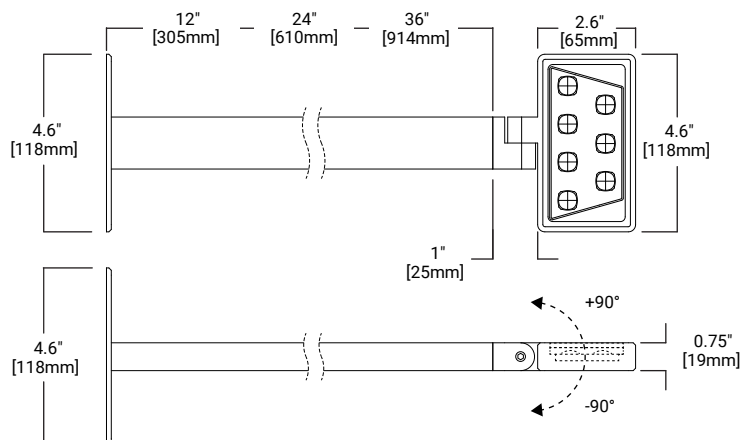

**TECHNICAL DATA**  
40°C Maximum Temperature Rating  
External Supply Wiring 90°C Minimum

## Order Information

SAMPLE ORDER NUMBER: 303-S1-LEDB1-2700-UNV-T2-DIM10-BK-12-EDGE

Domestic Preferences	Series	Color Temperature	Input Voltage	Optics	Dimming	Finish	Stem Length	Options
Domestic Preferences <sup>(5)</sup>	Series	Color Temperature	Input Voltage	Optics	Dimming	Finish <sup>(1)</sup>	Stem Length <sup>(2)</sup>	Options <sup>(3,4)</sup>
<b>[Blank]</b> =Standard <b>BAA</b> =Buy American Act	<b>303-S1-LEDB1</b>  Head contains one (1) Mini LightBAR™	<b>2700K</b> =2700K <b>3000K</b> =3000K <b>3500K</b> =3500K <b>4000K</b> =4000K <b>TSAM</b> =Turtle Safe Amber (585-595nm)	<b>UNV</b> =Universal 120-277, 50/60Hz	<b>T2</b> =Type II, Lateral Throw <b>T4</b> =Type IV, Forward Throw <b>T5X</b> =Type V, Extra Wide Flood	<b>DIMELV</b> =Trailing Edge Phase <b>DIM10</b> =0-10V Dimming	<b>Painted</b> <b>BK</b> =Black <b>BZ</b> =Bronze <b>CS</b> =City Silver <b>WT</b> =White <b>Premium Paint</b> <b>BA</b> =Brushed	<b>12</b> =12" Stem <b>24</b> =24" Stem <b>36</b> =36" Stem	<b>EDGE</b> =Edge lit glass lens <b>LCF</b> =LightBAR cover plate matches housing finish
<b>Notes</b>  (5) Only product configurations with this designated prefix are built to be compliant with the Buy American Act of 1933 (BAA). Please refer to <a href="#">DOMESTIC PREFERENCES</a> website for more information. Components shipped separately may be separately analyzed under domestic preference requirements.	<b>Notes</b>	<b>Notes</b>	<b>Notes</b>	<b>Notes</b>	<b>Notes</b>	<b>Notes</b>  (1) Custom and RAL color matching available upon request. Consult factory for further information.	<b>Notes</b>  (2) Stem lengths are nominal (shown in inches).	<b>Notes</b>  (3) Add suffix in the order shown. (4) LCF option not available when WT (white) finish is selected.

## Product Specifications

## Construction

- Head and back plate are precision machined from corrosion-resistant 6061-T6 aluminum
- A standard 12" or optional 24" and 36" length extruded straight arm provides 180° of vertical adjustment for easy aiming
- Consult factory for additional lengths
- A universal mounting plate and one piece silicone key hole gasket is provided for adaption to junction box or surface
- Stainless steel hardware is included

## Mounting

- The luminaire mounts directly to a standard 4" square junction box
- For further mounting information see technical notes section on page 3

## Optical

- LightBAR™ and optical assembly are sealed by a diffused, impact resistant tempered glass lens
- The optical assembly is available in three distributions: T2 (lateral throw), T4 (forward throw) and T5X (Extra Wide Flood)
- Available in several color temperatures: 2700K, 3000K, 3500K, 4000K and TSAM (Amber)

- Both color temperature and distribution must be specified when ordering – see catalog logic for details
- An edge-lit option is available

## Electrical

- The 8.5W 303-S1-LEDB1 is standard with an ELV trailing edge phase dimmable driver that accepts a universal input (120-277, 50/60Hz)
- It will operate in -40°C to 50°C [-40°F to 122°F]
- The driver incorporates surge protection
- An optional 0-10V dimming driver is also available.

## Finish

- The luminaires are double protected by a RoHS compliant chemical film undercoating and polyester powder coat paint finish, surpassing the rigorous demands of the outdoor environment
- The LightBAR™ cover plates are standard white and may be specified to match finish of luminaire housing (LCF)
- A variety of standard colors are available
- RAL and custom color matches available upon request
- Luminaires can also be brushed with a clear coat finish

## Approvals

- UL and cUL listed, standard wet label
- Tested according to IESNA LM-79 and LM-80 procedures
- ROHS Compliant
- IP66 Ingressed Protection rated

## Warranty

- Lumiere warrants the EON series of fixtures against defects in material and workmanship for five (5) years. Auxiliary equipment such as LED drivers carries the original manufacturer's warranty

## Lumen Maintenance

Ambient Temperature	TM-21 Lumen Maintenance (72,000 Hours)	TM-21 Reported L70(10k) (Hours)	Theoretical L70 (Hours)
25°C	> 94%	> 60,000	365,000
40°C			
50°C			

## Current Draw

Model	Line Voltage	Current Draw
303-S1-LEDB1	120-277V, 50/60Hz	0.13A

## Lumens - CRI/CCT Table

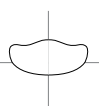
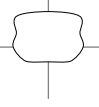
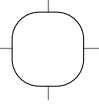
Optic Type	Distribution	Watts	Delivered Lumens	LPW	CCT (K) / Color	CRI nom. / Wavelength
T2 (Lateral Throw)		8.5	520	61	2700	90
			535	63	3000	80
			581	68	3500	80
			568	67	4000	80
		6.5	180	28	TSAM	585-595nm
T4 (Forward Throw)		8.5	475	56	2700	90
			488	57	3000	80
			531	62	3500	80
			519	61	4000	80
		6.5	158	24	TSAM	585-595nm
T5X (Extra Wide Flood)		8.5	580	68	2700	90
			597	70	3000	80
			649	76	3500	80
			634	75	4000	80
		6.5	194	30	TSAM	585-595nm

NOTES: 1 When the LCF option is selected use a lumen multiplier of .85

## Options

### Edge

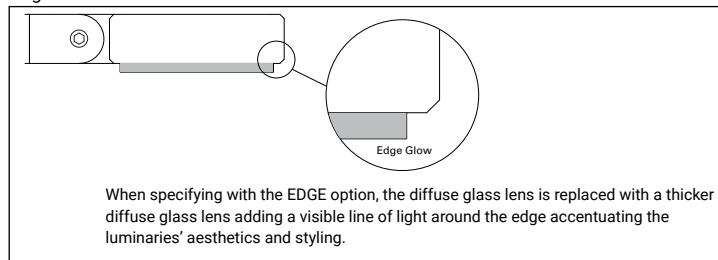

## Technical Notes

- Junction box size and depth is important when specifying product. Recommended junction boxes include 2-1/8" deep, 4" square weld/drawn Crouse Hinds part numbers TP403, TP434, TP494, TP196, TP395 or equivalent. Use with included universal mounting plate or with Crouse-Hinds part number TP480 or equivalent cover with similar fixture mounting locations.
- The universal wall plate provided with all EON wall mount fixtures can be used with an outdoor rated two gang 30.5 cubic inch capacity outlet box. Cooper Crouse-Hinds part numbers TP7086 – TP7122 or equivalent. The universal mounting plate will attach with four (4) 6-32 pan head/flat stainless steel screws (not provided).
- Driver can be remote mounted in a junction box a max distance of 25 feet (voltage drop needs to be considered) or placed in the junction box behind the luminaire.
- When specifying with the EDGE option, the diffused glass becomes thicker adding a visible line of light around the edge accentuating the luminaires' aesthetics and styling.
- If Luminaire will not be dimmed, the Luminaire must be ordered with DIMELV option, but does not have to be dimmed.
- Driver Dimensions:

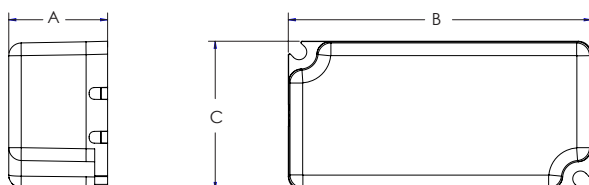

Luminaire Type	Dimming Type	Driver Dimensions in [mm]		
		A	B	C
303-S1-LEDB1	DIMELV	.98 [25.0]	2.78 [70.5]	1.14 [28.9]
	DIM10	.98 [25.0]	3.36 [85.3]	1.49 [37.9]