

Project		Catalog #		Type	
Prepared by		Notes		Date	



# Lumière

## EON 303-S1-LEDB1

Ceiling / Wall Mount

### Typical Applications

- Hospitality • Commerical Landscape • Outdoor Area/Site • Residential
- Architectural

### Interactive Menu

- Order Information [page 2](#)
- Product Specifications [page 2](#)
- Lumen Maintenance [page 3](#)
- Product Warranty

### Product Certification



### Product Features



### Top Product Features

- 180° Adjustability at the knuckle
- 2700K, 3000K, 3500K or 4000K Color Temperature and Amber (585-595nm)
- Forward/Lateral Throw or Flood Optics with diffuse glass sealed lens
- Patented AccuLED Optics™ System
- Universal Input LED Driver Included (120 - 277V, 50/60 Hz)
- ELV or 0-10 Dimming

### Dimensions

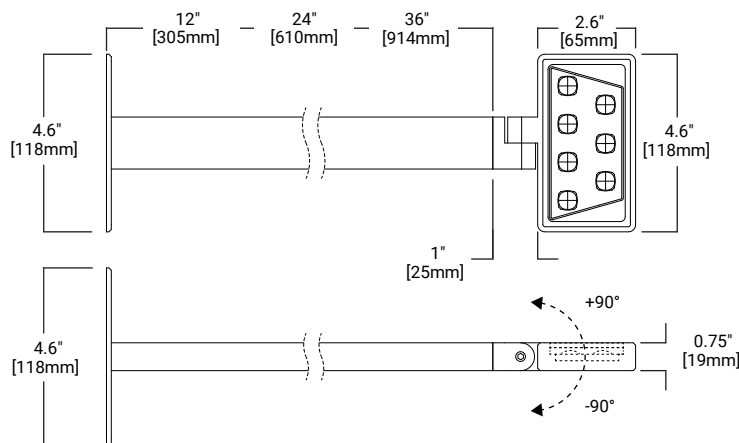

**TECHNICAL DATA**  
 40°C Maximum Temperature Rating  
 External Supply Wiring 90°C Minimum

## Order Information

SAMPLE ORDER NUMBER: 303-S1-LEDB1-2700-UNV-T2-DIM10-BK-12-EDGE

Domestic Preferences	Series	Color Temperature	Input Voltage	Optics	Dimming	Finish	Stem Length	Options
<b>[Blank]</b> =Standard <b>BAA</b> =Buy American Act <b>BABA</b> =Build America Buy America Act	<b>303-S1-LEDB1</b> Head contains one (1) Mini LightBAR™	<b>2700K</b> =2700K <b>3000K</b> =3000K <b>3500K</b> =3500K <b>4000K</b> =4000K <b>TSAM</b> =Turtle Safe Amber (585-595nm)	<b>UNV</b> =Universal 120-277, 50/60Hz	<b>T2</b> =Type II, Lateral Throw <b>T4</b> =Type IV, Forward Throw <b>T5X</b> =Type V, Extra Wide Flood	<b>DIMELV</b> =Trailing Edge Phase Dimming <b>DIM10</b> =0-10V Dimming	<b>Painted</b> <b>BK</b> =Black <b>BZ</b> =Bronze <b>CS</b> =City Silver <b>WT</b> =White <b>Premium Paint</b> <b>BA</b> =Brushed	<b>12</b> =12" Stem <b>24</b> =24" Stem <b>36</b> =36" Stem	<b>EDGE</b> =Edge lit glass lens <b>LCF</b> =LightBAR cover plate matches housing finish
<b>Notes</b> (1) Only product configurations with these prefixes are built to be compliant with the Buy America Act of 1935 (BAA) or Buy America Build America Act (BABA). Please see the Compliance section in Product Specifications for more detail.	<b>Notes</b>	<b>Notes</b>	<b>Notes</b>	<b>Notes</b>	<b>Notes</b>	<b>Notes</b> (2) Custom and RAL color matching available upon request. Consult factory for further information.	<b>Notes</b> (3) Stem lengths are nominal (shown in inches).	<b>Notes</b> (4) Add suffix in the order shown. (5) LCF option not available when WT (white) finish is selected.

## Product Specifications

### Construction

- Head and back plate are precision machined from corrosion-resistant 6061-T6 aluminum
- A standard 12" or optional 24" and 36" length extruded straight arm provides 180° of vertical adjustment for easy aiming
- Consult factory for additional lengths
- A universal mounting plate and one piece silicone key hole gasket is provided for adaption to junction box or surface
- Stainless steel hardware is included

### Mounting

- The luminaire mounts directly to a standard 4" square junction box
- For further mounting information see technical notes section on page 3

### Optical

- LightBAR™ and optical assembly are sealed by a diffused, impact resistant tempered glass lens
- The optical assembly is available in three distributions: T2 (lateral throw), T4 (forward throw) and T5X (Extra Wide Flood)
- Available in several color temperatures: 2700K, 3000K, 3500K, 4000K and TSAM (Amber)
- Both color temperature and distribution must be specified when ordering – see catalog logic for details
- An edge-lit option is available

### Electrical

- The 8.5W 303-S1-LEDB1 is standard with an ELV trailing edge phase dimmable driver that accepts a universal input (120-277, 50/60Hz)
- It will operate in -40°C to 50°C [-40°F to 122°F]
- The driver incorporates surge protection
- An optional 0-10V dimming driver is also available.

### Finish

- The luminaires are double protected by a RoHS compliant chemical film undercoating and polyester powder coat paint finish, surpassing the rigorous demands of the outdoor environment
- The LightBAR™ cover plates are standard white and may be specified to match finish of luminaire housing (LCF)
- A variety of standard colors are available
- RAL and custom color matches available upon request
- Luminaries can also be brushed with a clear coat finish

### Compliance

- UL and cUL listed, standard wet label
- Tested according to IESNA LM-79 and LM-80 procedures
- ROHS Compliant
- IP66 Ingressed Protection rated
- BAA domestic preference option meets BAA requirements
- Domestic preference option available to meet BABA requirements. BABA is the minimum Government compliance requirement for the Buy America Build America standards which is part of the Infrastructure and Investment Jobs Act (IIJA). Individual Government Agencies may have more stringent compliance standards
- Please refer to the [DOMESTIC PREFERENCES](#) website or consult the CLS Domestic Preferences team for more information. Components shipped separately may be separately analyzed under domestic preference requirements

### Warranty

- Five-year limited warranty. Consult website for details: [www.cooperlighting.com/legal](http://www.cooperlighting.com/legal)

## Lumen Maintenance

Ambient Temperature	TM-21 Lumen Maintenance (72,000 Hours)	TM-21 Reported L70(10k) (Hours)	Theoretical L70 (Hours)
25°C	> 94%	> 60,000	365,000
40°C			
50°C			

## Current Draw

Model	Line Voltage	Current Draw
303-S1-LEDB1	120-277V, 50/60Hz	0.13A

## Lumens - CRI/CCT Table

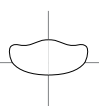
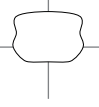
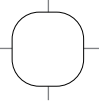
Optic Type	Distribution	Watts	Delivered Lumens	LPW	CCT (K) / Color	CRI nom. / Wavelength
T2 (Lateral Throw)		8.5	520	61	2700	90
			535	63	3000	80
			581	68	3500	80
			568	67	4000	80
			6.5	180	28	TSAM
T4 (Forward Throw)		8.5	475	56	2700	90
			488	57	3000	80
			531	62	3500	80
			519	61	4000	80
			6.5	158	24	TSAM
T5X (Extra Wide Flood)		8.5	580	68	2700	90
			597	70	3000	80
			649	76	3500	80
			634	75	4000	80
			6.5	194	30	TSAM

NOTES: 1 When the LCF option is selected use a lumen multiplier of .85

## Options

### Edge

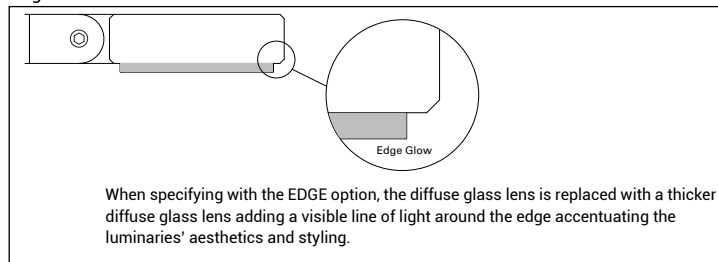

## Technical Notes

- Junction box size and depth is important when specifying product. Recommended junction boxes include 2-1/8" deep, 4" square weld/drawn Crouse Hinds part numbers TP403, TP434, TP494, TP196, TP395 or equivalent. Use with included universal mounting plate or with Crouse-Hinds part number TP480 or equivalent cover with similar fixture mounting locations.
- The universal wall plate provided with all EON wall mount fixtures can be used with an outdoor rated two gang 30.5 cubic inch capacity outlet box. Cooper Crouse-Hinds part numbers TP7086 – TP7122 or equivalent. The universal mounting plate will attach with four (4) 6-32 pan head/flat stainless steel screws (not provided).
- Driver can be remote mounted in a junction box a max distance of 25 feet (voltage drop needs to be considered) or placed in the junction box behind the luminaire.
- When specifying with the EDGE option, the diffused glass becomes thicker adding a visible line of light around the edge accentuating the luminaires' aesthetics and styling.
- If Luminaire will not be dimmed, the Luminaire must be ordered with DIMELV option, but does not have to be dimmed.
- Driver Dimensions:

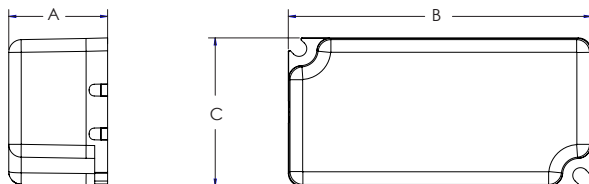

Luminaire Type	Dimming Type	Driver Dimensions in [mm]		
		A	B	C
303-S1-LEDB1	DIMELV	.98 [25.0]	2.78 [70.5]	1.14 [28.9]
	DIM10	.98 [25.0]	3.36 [85.3]	1.49 [37.9]