

Project		Catalog #		Type	
Prepared by		Notes		Date	



# WaveLinx Wired

## SCMD4-NA

### Local Bus Control Module

#### Typical Applications

Office • Education • Healthcare • Hospitality • Retail • Industrial • Manufacturing • Outdoor

#### Product Certification



#### Product Features

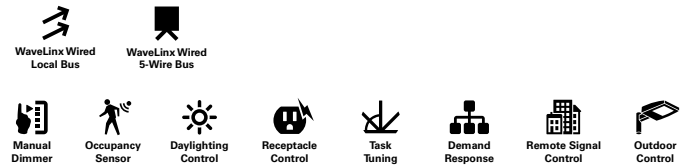

#### Interactive Menu

- Ordering Information page 2
- Additional Resources page 3
- Wiring Diagrams page 4
- Connected Systems page 5
- Product Warranty

#### Top Product Features

- Can individually control up to 256 addressable devices on four WaveLinx wired local bus
- Up to 64 individual devices per WaveLinx wired local bus
- Alarm and Emergency dry contact inputs
- RS485 / DMX512 inputs

#### Dimensions



Two key hole slots as an alternative to DINRail fixing

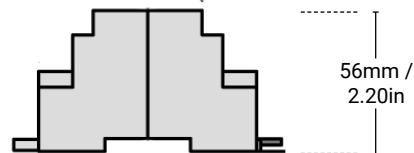

## Order Information

Catalog Number

Catalog Number	Description
SCMD4-NA	WaveLinx Wired local bus control module

## Product Specifications

### Key Features

- Provides four WaveLinx wired local busses to address and control 256 devices (sensors, fixtures, relays, wallstations)
- Mounts to standard Top Hat (TS 35) DINrail
- 2 dry contact inputs
- RS485 / DMX512 control
- Connects to the WaveLinx wired digital network
- 4 internal dedicated WaveLinx wired local bus power supplies
- Each bus has a dedicated test/override button allowing the installer to test or override the installation prior to commissioning
- Configuration stored in Non Volatile EEPROM
- Configurable start up mode

### Mechanical

**Weight:** 0.35kg/0.77lbs

**Operating temperature:** +2°C to +50°C

Note: All enclosures must be adequately ventilated

**Max storage temperature:** +60°C

**Humidity:** +5 to 95% non-condensing

**Environmental protection:** IP20

### Electrical

**Supply:** 120-277VAC +/- 10% 50/60 Hz, 0.2AMAX

**Switch inputs:** 2, configurable as break or make, max wire size 12/14AWG

**WaveLinx wired Network inputs/output:** Screw terminals

**WaveLinx wired Local Bus:** Max wire size 16AWG

**WaveLinx wired Local Bus Power:** Nominal 16V, max current 250mA supplies to each bus

**DMX signal:** Addressable in software, DMX512

**Maximum load:** 0.2A @ 50°C

**Terminals max wire size:** 12/14AWG

### Standards/Ratings

- cULus Listed - Energy Management Equipment (UL916)
- Manufactured in an ISO 9001 certified factory
- Meets ASHRAE Standard 90.1 requirements
- Meets IECC 2015 requirements
- Meets CEC Title 24 requirements

### Environmental Regulations:

- RoHS Directive 2011/65/EU

### Warranty

Five year warranty standard

## Overview

The SCMD4-NA provides four WaveLinx wired local busses enabling dimming and switching of up to 256 individually addressable devices including luminaires and other WaveLinx wired devices. WaveLinx wired multi-sensors, wallstations and DAC's can be added to each bus creating a complete solution. Each bus supports up to 64 addresses.

The SCMD4-NA also features direct input capabilities from a DMX system or from the WaveLinx wired digital network.

The SCMD4-NA includes dry contact inputs that can be used for emergency override or fire alarm inputs.

## System architecture

Simple WaveLinx wired system

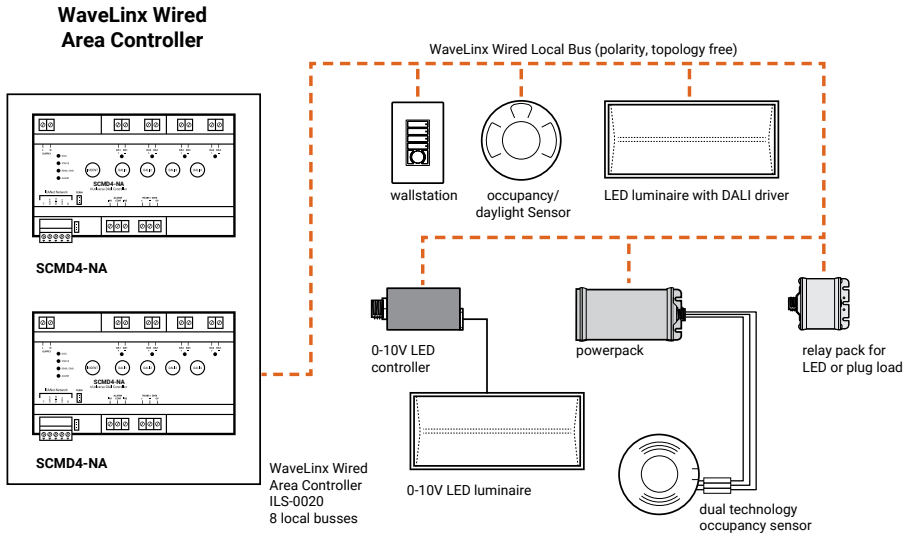

## Complete WaveLinx wired system

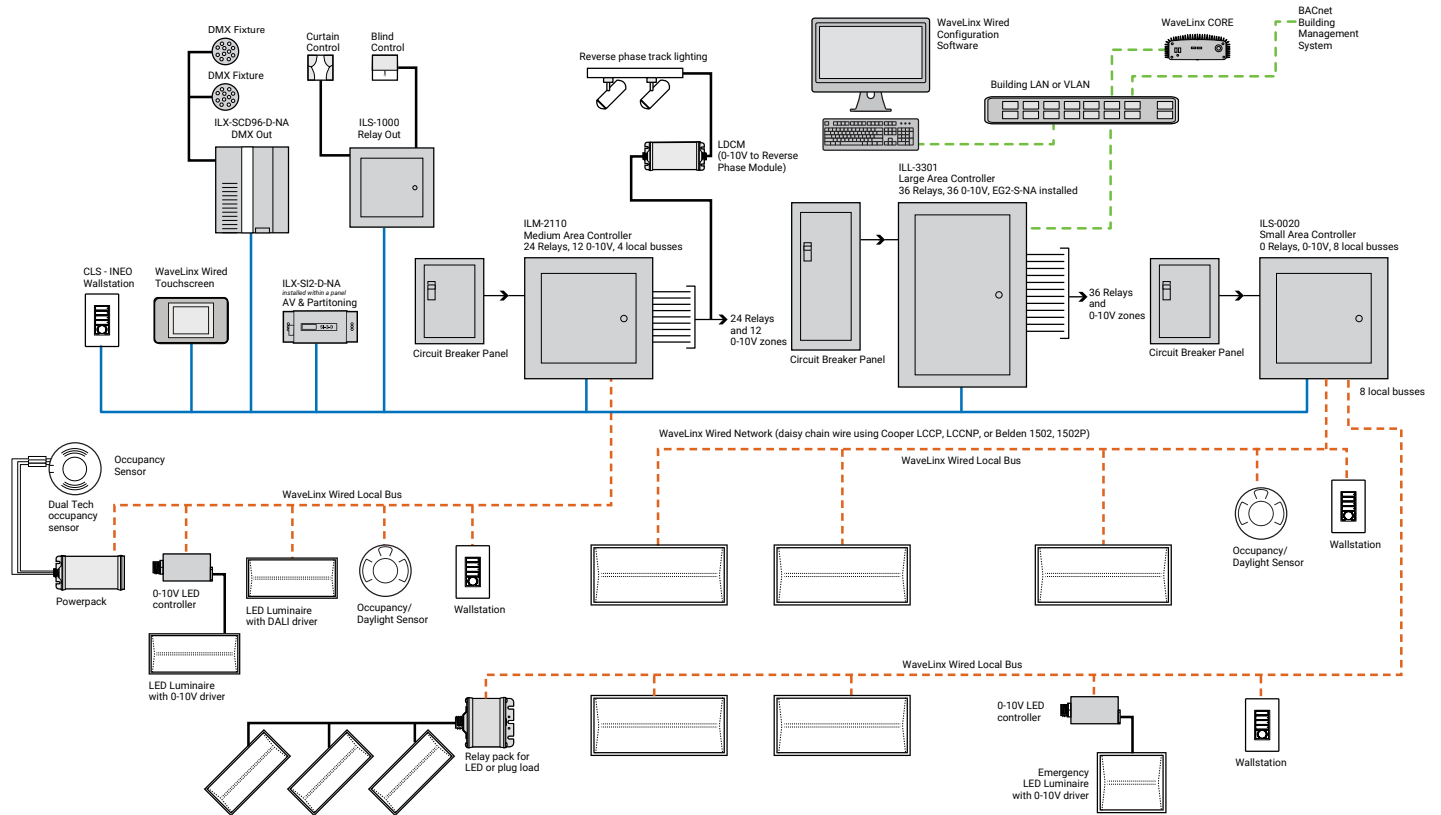

## Sample System Topology:

This diagram shows the main components of the WaveLinX wired and PRO wireless connected lighting system.

The **WaveLinX PRO wireless system** communicates using wireless mesh technology based on the IEEE 802.15.4 standard. A PoE LAN connection for each WaveLinX Area Controller (WAC) is required for power and data access to the building lighting network.

The **WaveLinX wired system** controls the devices using relay, 0-10V, DMX and the WaveLinX wired digital local bus. The WaveLinX wired system connects to the building LAN using the EG2 module. Each WaveLinX wired area controller communicates on the WaveLinX wired network.

WaveLinX Area Controllers (WAC) and WaveLinX Ethernet Gateways (EG2) communicate with WaveLinX CORE over the Ethernet network.

Please refer to the WaveLinX PRO Wireless Network and IT Guidance Technical Guide and WaveLinX Wired Network and IT Guidance Technical Guide for more information.

[View WaveLinX Network and IT Guidance Technical Guide](#)

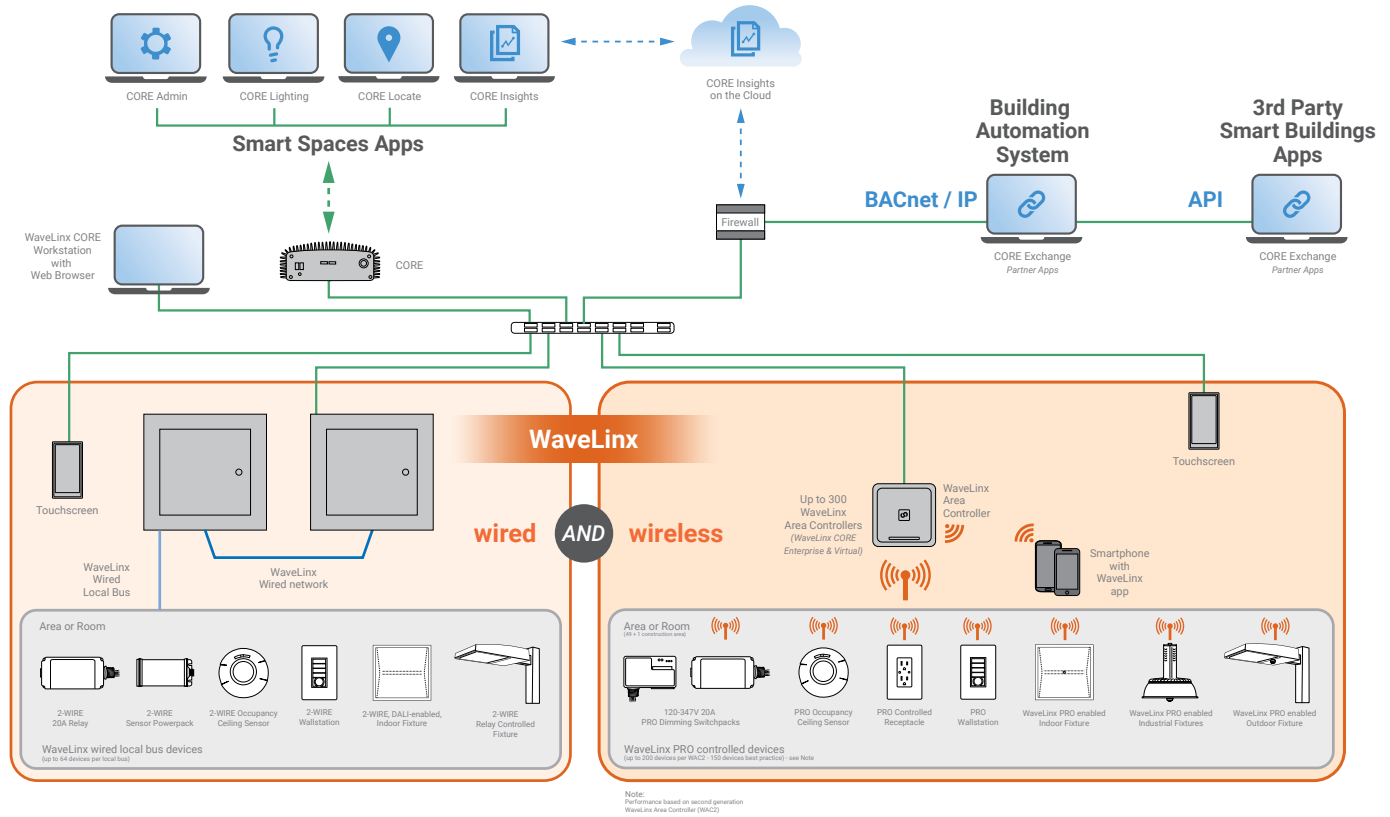

## Control Systems

- WaveLinX
- WaveLinX wired
- VividTune