

Project		Catalog #		Type	
Prepared by		Notes		Date	



# Lumière

## Lanterra 9002

Wall Mount Cylinder  
Interior / Exterior  
Integrated LED

### Typical Applications

- Hospitality • Commerical Landscape • Outdoor Area/Site • Residential
- Architectural

**Interactive Menu**

- Order Information [page 2](#)
- Product Specifications [page 3](#)
- Mounting Details [page 4](#)
- Lumen Table [page 6](#)
- Photometrics [page 7](#)
- Integrated Sensor [page 8](#)

### Product Certification



### Product Features



### Top Product Features

- Uplight, downlight or combined up and downlight
- Up to 1000 delivered lumens per side and 107 LPW
- Field interchangeable Spot, Medium, Flood and Wide optics
- Integrated LED source with 80, 90, and 97 CRI options available
- Premium machined aluminum construction with stainless steel hardware
- Line voltage input with ELV, Triac and 0-10V dimming standard
- Integral and remote driver mounting options

### Dimensions

WRS mount shown

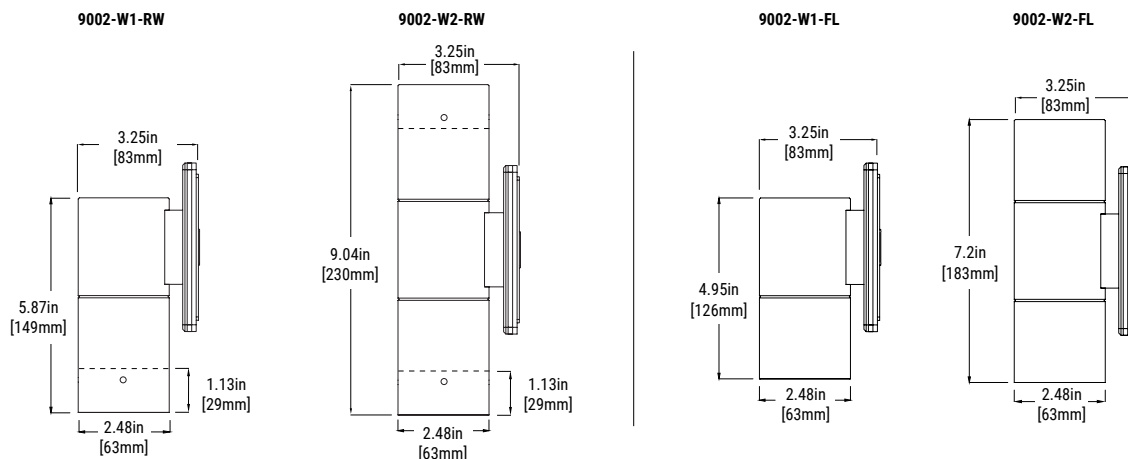

## Order Information

SAMPLE ORDER NUMBER: 9002-W2-RW-LED3090-M-M-CS-L1-UNV-RSM

Domestic Preferences	Series	Direction	Hood	LED CCT & CRI	Field Replaceable optic 1	Field Replaceable optic 2	Finish	Light level	Voltage	Mounting	Options
<b>[Blank]</b> =Standard <b>BAA</b> =Buy American Act <b>BABA</b> =Build America Buy America Act	<b>9002</b>	<b>W1</b> =Up or Down <b>W2</b> <sup>(2)</sup> =Up and Down	<b>RW</b> =Standard-Recessed Lens with weep holes <b>RI</b> =Recessed Lens with no weep holes <b>FL</b> =Flush lens hood	<b>Standard CRI</b> <b>LED2790</b> = 2700K, 90 CRI <b>LED3090</b> = 3000K, 90 CRI <b>LED3590</b> = 3500K, 90 CRI <b>LED4080</b> = 4000K, 80 CRI <b>LED5080</b> = 5000K, 80 CRI <b>Premium CRI</b> <b>LED2797</b> = 2700K, 97 CRI <b>LED3097</b> = 3000K, 97 CRI <b>LED3597</b> = 3500K, 97 CRI <b>LED4097</b> = 4000K, 97 CRI	<b>S</b> =Spot <b>M</b> =Medium <b>F</b> =Flood <b>W</b> =Wide Flood	<b>S</b> =Spot <b>M</b> =Medium <b>F</b> =Flood <b>W</b> =Wide Flood	<b>Painted</b> <b>BK</b> =Black <b>BZ</b> =Bronze <b>CS</b> =City Silver <b>WT</b> =White	<b>L1</b> =Light Level 1	<b>UNV</b> =120-277V	<b>Surface Mount - Wall, Ceiling, Ground</b> <b>RSM</b> = Round Surface Mount- mounts directly to junction box <b>Remote Driver Housing</b> <b>WRR</b> <sup>(7)</sup> =Remote Driver Housing - Round Wall Plate <b>WRS</b> <sup>(7)</sup> =Remote Driver Housing - Square Wall Plate <b>Integral Driver Mount</b> <b>WIS</b> =Wall Integral Driver Plate	<b>SVPD2</b> <sup>(8)</sup> =Standalone integral sensor
<b>Notes</b> (1) Only product configurations with these prefixes are built to be compliant with the Buy America Act of 1933 (BAA) or Buy America Build America Act (BABA). Please see the Compliance section in Product Specifications for more detail.	<b>Notes</b>	<b>Notes</b> (2) W2 doubles input wattage listed with RSM only	<b>Notes</b>	<b>Notes</b>	<b>Notes</b>	<b>Notes</b> (3) Only available for double head option (W2)	<b>Notes</b> (4) Premium metal not available for RSM option (5) Consult factory for premium/natural metals material finish. (6)ROHS Compliant - For Natural materials consult factory	<b>Notes</b>	<b>Notes</b>	<b>Notes</b> (7) Remote Driver up to 60°	<b>Notes</b> (8) Only available for Single head, Up or down (W1) with RSM only.

## Accessories - order separately

### Accessories

#### Accessories <sup>(9)</sup>

	Filters	Lens	Louver	Optics
<b>ISHH01LUM</b> =Programming Remote for sensor <b>ISHH02LUM</b> =Personal Control Remote for sensor	<b>F71-2</b> =Peach Dichroic <b>F72-2</b> = Amber Dichroic <b>F73-2</b> = Green Dichroic <b>F74-2</b> = Medium Blue <b>F75-2</b> = Yellow Dichroic <b>F76-2</b> = Red Dichroic <b>F77-2</b> =Dark Blue Dichroic <b>F78-2</b> = Light Blue Dichroic <b>F79-2</b> = Neutral Density Dichroic <b>F80-2</b> =Magenta Dichroic <b>F22-2</b> = Red Color <b>F33-2</b> = Blue Color <b>F44-2</b> =Green Color <b>F55-2</b> = Yellow Color <b>F66-2</b> = Mercury Color	<b>LSL-2</b> =Linear Spread Lens <b>DIF-2</b> =Diffused Lens <b>OSL-2</b> =Overall Spread Lens	<b>LVR-2</b> =45° Hex Cell Louver	<b>LLR-S-2</b> =15° Spot <b>LLR-M-2</b> = 25° Medium <b>LLR-F-2</b> = 40° Flood <b>LLR-W-2</b> = 55° Wide Flood <b>LLR-K-2</b> = Spot, Medium, Flood, Wide Flood Kit
<b>Notes</b> (9) Accessories sold separately will be separately analyzed under domestic preference requirements. Consult factory for further information.				

## Product Specifications

### Construction

- Housing and hood are precision-machined from corrosion resistant billet stock 6061-T6 aluminum, C360 brass, C932 bronze\*, C110 copper or 303/304 stainless steel.
- Housing and hood are sealed with a high temperature silicone O-ring gasket to prevent water intrusion.
- Tempered glass lens, factory sealed with high temperature silicone O-ring to prevent water intrusion and breakage due to thermal shock.
- Stainless steel hardware is standard to provide maximum corrosion resistance.

### Hood

- Hood removes to allow for field-swapping of optical distributions
- Hood is removable and accepts up to two internal accessories at once (lenses, louvers and filters) to achieve multiple lighting effects.
- Weep hole prevents water and mineral stains from collecting on the lens, even in the straight up position.
- The flush lens design reduces fixture length, minimizes debris collection and prevents water and mineral stains from collecting on the lens.

### Finish

- Fixtures constructed from 6061-T6 aluminum are double protected by an ROHS\* chemical film undercoating and polyester powder coat paint finish
- A variety of standard colors are available. Custom colors are available via ETO. Additional charges and lead time will apply.
- Fixtures constructed from brass, bronze, copper or stainless steel are left unpainted to reveal the natural beauty of the material. Brass, bronze\* and copper will patina naturally over time.

### Mounting

- Options for integral and remote mounted drivers
- Round Surface Mount (RSM) utilizes an aluminum housing to create an IP66 compartment for the drivers
- Wall Integral Square (WIS) provides a more minimalist aesthetic and requires the fixture to mount a 4 inch square junction box to allow driver fitment directly behind the fixture
- Remote mounted drivers can be up to 60 feet away from the light fixture

### Electrical

- Long life LED system coupled with electronic driver (120-277V/50-60Hz) is compatible with TRIAC (Leading Edge Dimming), ELV (Trailing Edge Dimming) and 0-10V dimming to deliver optical performance. Light can be dimmed from 100-1% while maintaining constant CCT.
- Multiple CCT and CRI options available including four premium 97CRI options
- 86% lumen maintenance at 60,000hrs.
- Surge protection is incorporated in the LED driver.

### Compliance

- cULus Wet Location listed for use in -30° to 50° ambient environments unless otherwise noted
- Tested according to IESNA LM-79 and LM-80 procedures
- ROHS compliant.
- IP66 Rated.
- BAA domestic preference option meets BAA requirements
- BABA domestic preference option meets BABA requirements. BABA products meet minimum government compliance requirements for Buy America Build America standard, part of the Infrastructure and Investment Jobs Act (IIJA). Individual government agencies may have more stringent compliance standards
- See [DOMESTIC PREFERENCES](#) website or consult the CLS Domestic Preferences team for more information

### Warranty

- Five-year limited warranty. Consult website for details: [www.cooperlighting.com/legal](http://www.cooperlighting.com/legal)

## Mountings

### ROUND SURFACE MOUNT (RSM)

RSM-W1

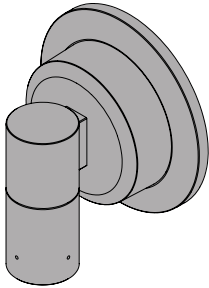

ISO VIEW

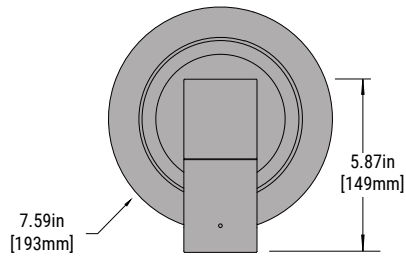

FRONT VIEW

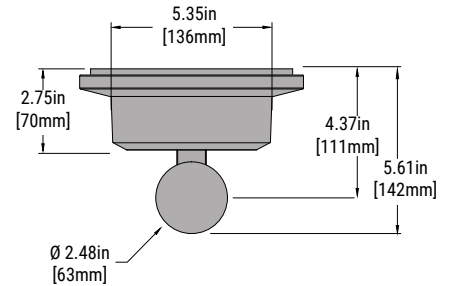

TOP VIEW

### ROUND SURFACE MOUNT (RSM)

RSM-W2

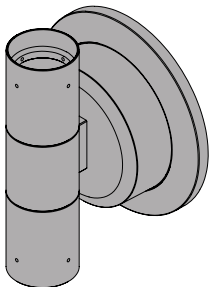

ISO VIEW

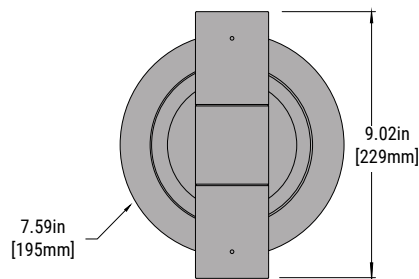

FRONT VIEW

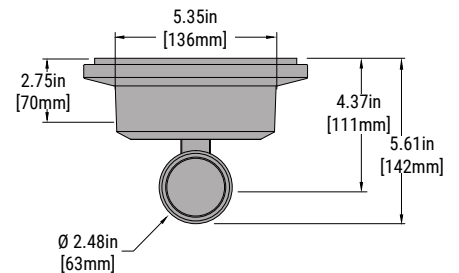

TOP VIEW

### WALL INTEGRAL DRIVER SQUARE PLATE (WIS)

WIS-W1

Requires mounting to a 4" square junction box with a minimum depth of 2-1/8"

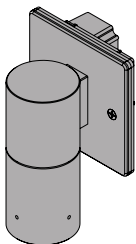

ISO VIEW

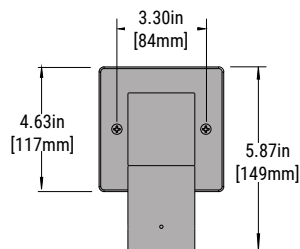

FRONT VIEW

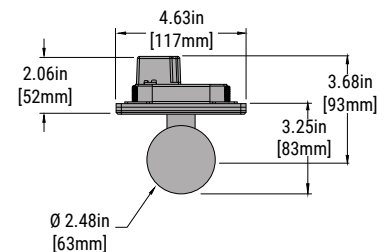

TOP VIEW

## Mountings

### WALL INTEGRAL DRIVER SQUARE PLATE (WIS)

WIS-W2

Requires mounting to a 4" square junction box with a minimum depth of 2-1/8"

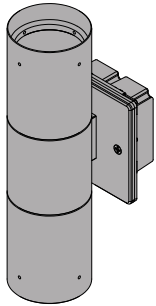

ISO VIEW

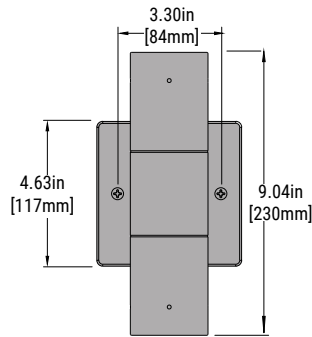

FRONT VIEW

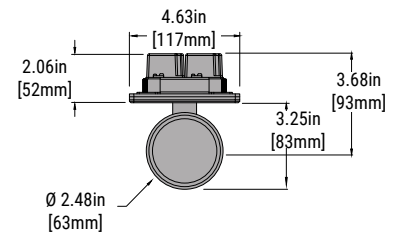

TOP VIEW

### ROUND WALL PLATE WITH REMOTE DRIVER

WRR-W1 Round wall plate, as shown

WRS-W1 Square wall plate, also available

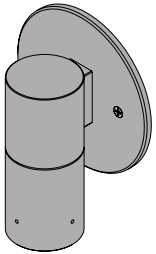

ISO VIEW

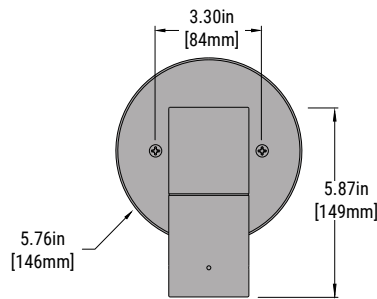

FRONT VIEW

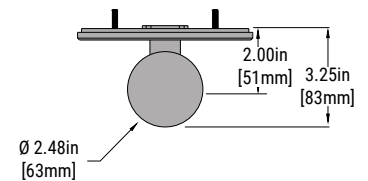

TOP VIEW

WRR-W2 Round wall plate, as shown

WRS-W2 Square wall plate, also available

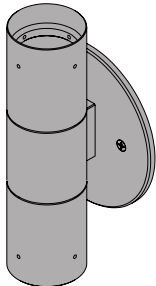

ISO VIEW

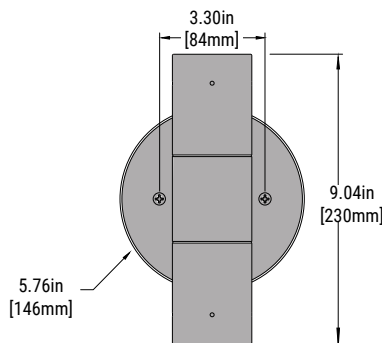

FRONT VIEW

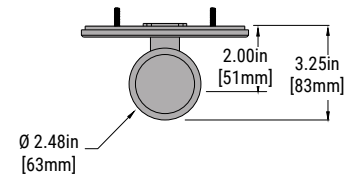

TOP VIEW

### REMOTE BOX (Included with WRR and WRS)

Remote Driver distance up to 60'

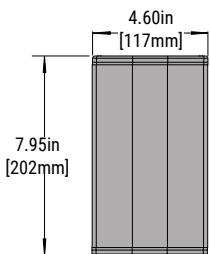

FRONT VIEW

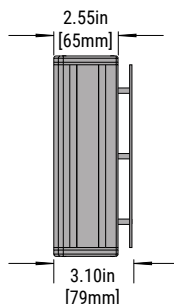

SIDE VIEW

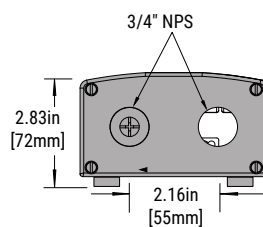

BOTTOM VIEW

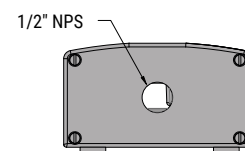

TOP VIEW

Lumen Table

		9002-[W1] Regressed Hood - Black L1 - 10W		
		CBCP	Lumens	LPW
<b>S Spot 15°</b>	LED2790	4566	358	35.8
	LED3090	4837	379	37.9
	LED3590	5236	411	41.1
	LED4080	6028	473	47.3
	LED5080	6581	516	51.6
	LED2797	4350	341	34.1
	LED3097	4657	365	36.5
	LED3597	4898	384	38.4
	LED4097	5022	394	39.4
	<b>M Medium Flood 25°</b>	LED2790	4252	724
LED3090		4505	767	76.7
LED3590		4877	831	83.1
LED4080		5614	956	95.6
LED5080		6129	1044	104.4
LED2797		4051	690	69.0
LED3097		4337	739	73.9
LED3597		4562	777	77.7
LED4097		4677	797	79.7
<b>F Flood 40°</b>	LED2790	1604	746	74.6
	LED3090	1699	791	79.1
	LED3590	1840	856	85.6
	LED4080	2118	985	98.5
	LED5080	2312	1076	107.6
	LED2797	1528	711	71.1
	LED3097	1636	761	76.1
	LED3597	1721	801	80.1
	LED4097	1764	821	82.1
<b>W Wide Flood 55°</b>	LED2790	798	685	68.5
	LED3090	846	726	72.6
	LED3590	916	785	78.5
	LED4080	1054	904	90.4
	LED5080	1151	987	98.7
	LED2797	761	653	35.0
	LED3097	814	699	69.9
	LED3597	856	735	73.5
	LED4097	878	753	75.3

TM30 Data

9002	CCT/CRI	Rf	Rg	Ra	R9
	2790	91.8	100.0	93.8	66.3
	3090	91.3	99.1	92.1	62.6
	3590	90.4	98.7	92.5	65.5
	4080	82.6	93.8	84.2	15.1
	5080	81.4	93.3	83.8	14.0
	2797	94.7	100.3	98.2	92.7
	3097	94.0	100.1	98.6	94.2
	3597	93.0	99.6	98.2	95.3
	4097	91.1	97.8	95.9	87.7

Lumen maintenance

Ambient Temperature	TM-21 Lumen Maintenance (60,000 Hours)	Theoretical L70 (Hours)
25°C, 40°C, 40°C	> 86%	> 90,000

Power Table

Number of Heads	Light Level	Input Current (A) at 120 VAC	Input Current (A) at 277 VAC	Input Power (W)
W1	L1	0.08	0.03	10
W2	L1	0.16	0.06	20

## Photometrics

Test Number	P29421
Lumcat	9002-[A1, P1, S1, SU1, W1]-X-FL-LED4080-S-BK-L1-UNV
Lumens	458 Lm
Watts	10 W
LPW	45.8 Lm/W
CCT	4000K
SC (0/90/45)	0.24 / 0.24 / 0.24
Beam Angle	14°

Color metric summary	
TM-30-15	Rf = 82.6
	Rg = 93.8
CRI/CIE	Ra = 84.2
	R9 = 15.1

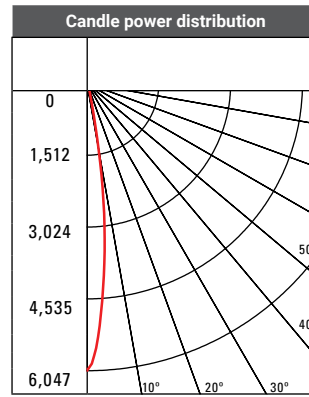
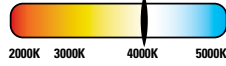

Cone of light				
Horizontal Illuminance on Floor				
MH	FC	L	W	
2'	1511.8	0.4	0.4	
4'	377.9	0.8	0.8	
6'	168	1.4	1.4	
8'	94.5	1.8	1.8	
10'	60.5	2.4	2.4	
15'	26.9	3.6	3.6	
20'	15.1	4.8	4.8	
30'	6.7	7.2	7.2	
40'	3.8	9.6	9.6	

Candela table	
Angle	0-deg
0	6047
5	4064
10	1430
15	292
20	137
30	21
40	7
50	3
60	2
70	1
80	0
90	0

Test Number	P29422
Lumcat	9002-[W1]-X-FL-LED4080-M-BK-L1-UNV
Lumens	985 Lm
Watts	10 W
LPW	98.5 Lm/W
CCT	4000K
SC (0/90/45)	0.4 / 0.4 / 0.36
Beam Angle	23.1°

Color metric summary	
TM-30-15	Rf = 82.6
	Rg = 93.8
CRI/CIE	Ra = 84.2
	R9 = 15.1

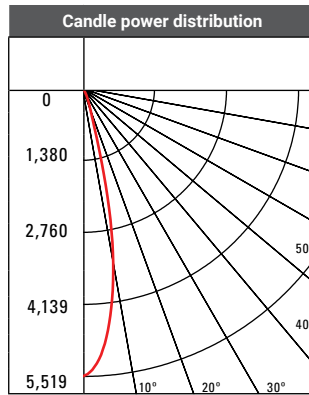
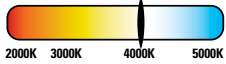

Cone of light				
Horizontal Illuminance on Floor				
MH	FC	L	W	
2'	1379.8	0.6	0.6	
4'	344.9	1.4	1.4	
6'	153.3	2.2	2.2	
8'	86.2	3	3	
10'	55.2	3.8	3.8	
15'	24.5	5.8	5.8	
20'	13.8	7.8	7.8	
30'	6.1	11.8	11.8	
40'	3.4	15.8	15.8	

Candela table	
Angle	0-deg
0	5519
5	4909
10	3391
15	1302
20	457
30	133
40	22
50	6
60	2
70	1
80	0
90	0

Test Number	P29423
Lumcat	9002-[W1]-X-FL-LED4080-F-BK-L1-UNV
Lumens	1015 Lm
Watts	10W
LPW	101.5 Lm/W
CCT	4000K
SC (0/90/45)	0.66 / 0.66 / 0.63
Beam Angle	40.3°

Color metric summary	
TM-30-15	Rf = 82.6
	Rg = 93.8
CRI/CIE	Ra = 84.2
	R9 = 15.1

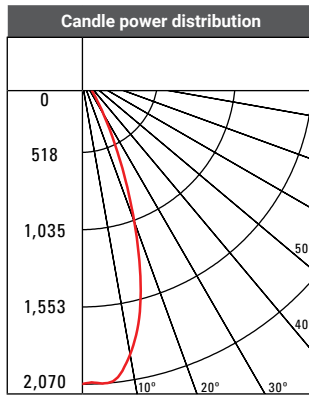
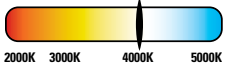

Cone of light				
Horizontal Illuminance on Floor				
MH	FC	L	W	
2'	517.5	1.2	1.2	
4'	129.4	2.6	2.6	
6'	57.5	3.8	3.8	
8'	32.3	5.2	5.2	
10'	20.7	6.6	6.6	
15'	9.2	9.8	9.8	
20'	5.2	13.2	13.2	
30'	2.3	19.8	19.8	
40'	1.3	26.4	26.4	

Candela table	
Angle	0-deg
0	2070
5	2070
10	1900
15	1547
20	1048
30	306
40	60
50	11
60	3
70	2
80	0
90	0

Test Number	P29424
Lumcat	9002-[W1]-X-FL-LED4080-W-BK-L1-UNV
Lumens	947 Lm
Watts	10 W
LPW	94.7 Lm/W
CCT	4000K
SC (0/90/45)	0.87 / 0.87 / 0.88
Beam Angle	57.1°

Color metric summary	
TM-30-15	Rf = 82.6
	Rg = 93.8
CRI/CIE	Ra = 84.2
	R9 = 15.1

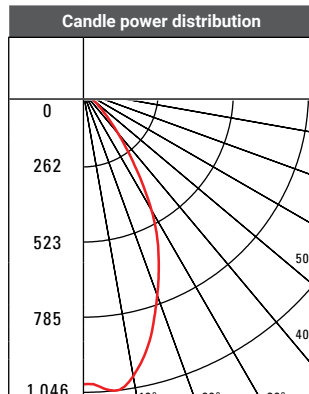
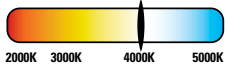

Cone of light				
Horizontal Illuminance on Floor				
MH	FC	L	W	
2'	257.5	1.6	1.6	
4'	64.4	3.4	3.4	
6'	28.6	5	5	
8'	16.1	6.8	6.8	
10'	10.3	8.6	8.6	
15'	4.6	12.8	12.8	
20'	2.6	17.2	17.2	
30'	1.1	25.8	25.8	
40'	0.6	34.4	34.4	

Candela table	
Angle	0-deg
0	1018
5	1042
10	1005
15	896
20	754
30	477
40	189
50	56
60	13
70	2
80	0
90	0

CCT/CRI	LED2790	LED3090	LED3590	LED4080	LED5080	LED2797	LED3097	LED3597	LED4097
FC Multiplier	0.757	0.802	0.869	1.000	1.092	0.722	0.773	0.813	0.833

Note: Photometric tables show lumen output for W1 only. For W2 (Up and Down) option, uplight and downlight both match lumen output as W1.

## Integrated Sensor - SVPD2

The Lanterra Cylinder 9002 with Integrated Sensor technology provides automatic energy savings without sacrificing performance. Traditionally, these types of energy savings required coordination between the luminaire and a lighting control system. The Lanterra Cylinder 9002 delivers superior lighting with integrated PIR occupancy sensing and daylighting controls.

Capture the benefits of traditional lighting controls, without complicated circuit planning or special wiring. The Lanterra Cylinder 9002 delivers automatic ON to an energy saving light level, while ensuring lighting is turned OFF when the space is unoccupied.

The SVPD2 sensor is configured for outdoor use, so the integral daylight sensor will enable the luminaire to automatically adjust to daylight conditions by turning off when sufficient sunlight is present. Consult factory for indoor configuration.

Occupied light levels and unoccupied light levels can be adjusted using the integrated sensor programming remote (Catalog Number: ISHH01LUM). While the default unoccupied level is OFF, a lower light level can be saved instead using the programming remote. The integrated sensor personal remote (Catalog Number: ISHH02LUM) provides code compliant manual raise, lower, ON, OFF control.

The Lanterra Cylinder 9002 with Integrated Sensor is easy to install with no special wiring and ensures energy savings out-of-the-box with default control settings.



### How it works

- As the user enters the space controlled by the integral sensor, the lighting turns ON to the occupied light level.
- Lighting will remain at the occupied level until the space is unoccupied. This will start the occupancy timeout period (default 20 minutes).
- If the space remains unoccupied for half of the timeout period, the lighting will automatically reduce to the Energy Saver light level (default matches occupied level). This adjustable light level is often set to half of the occupied daylight level using the programming remote.
- At the end of the timeout period the lighting will go to the unoccupied light level. This adjustable light level uses the OFF default setting.
- If sufficient sunlight is present, the luminaire will remain OFF, regardless of occupancy.

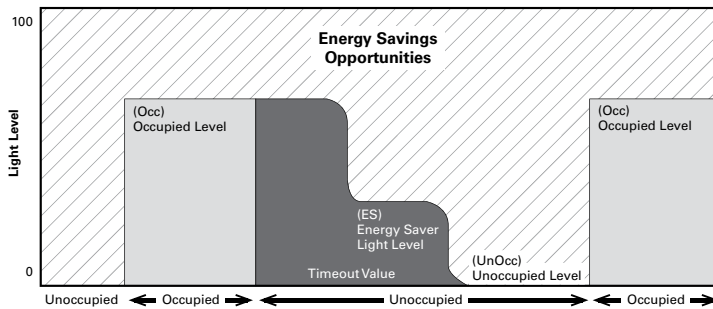

### Coverage

#### SVPD2 Coverage Pattern (not to scale)

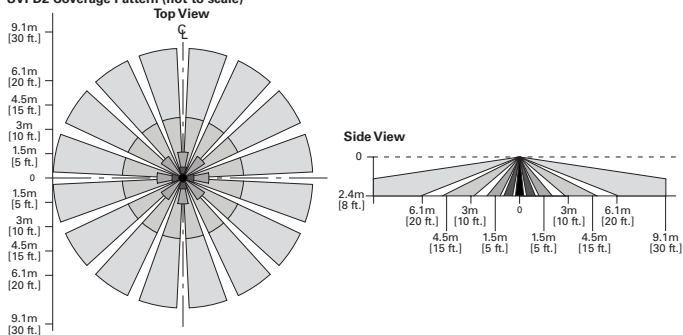

### Sensor Dimensions

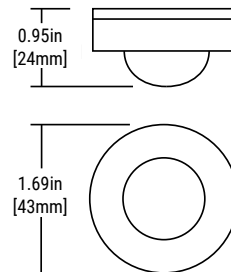

### Optional Remote Controls



ISHH01LUM Programming Remote



ISHH02LUM Personal Control Remote

Specifications and dimensions subject to change without notice.