

DESCRIPTION

The Paralux III Series features recessed aesthetics and the latest in energy efficient technology. The luminaire incorporates a nominal 3" deep precision cell louver into a 4-3/4" deep para-contoured fixture housing. This combination creates a total high performance parabolic optical assembly for optimum performance. The series is compatible with all of today's popular ceiling systems and is available with a number of options and accessories for application versatility.

2EP3-IC is designed for installations when the housing will be in direct contact with insulation. The high performance luminaire is designed to offer maximum efficiency and performance for today's unique interior specifications.

SPECIFICATION FEATURES

Construction

4-3/4" deep, para-contoured housing, die formed of code gauge, prime cold rolled steel. Die embossed housing has full length die formed stiffeners for added strength. Contoured ballast/wireway cover is easily removed. Die formed captive lampholder bracket fully encloses lampholder wiring permitting easy lampholder replacement. Heavy gauge end plates are securely attached with interlocking tabs and screws. Four auxiliary fixture end suspension points provided. KOs for continuous row wiring. End plates have integral Grid-Lock feature for safety and convenience.

Electrical**

Ballasts are CBM/ETL Class "P" and are positively secured by mounting bolts. Pressure lock lampholders. UL/CUL listed for Type IC Recessed Luminaire (Rated for direct contact with insulation) Suitable for damp locations.

Finish

Lighting grade, baked white enamel finish. Multistage, iron phosphate pretreatment ensures maximum bonding and rust inhibition.

Hinging/Latching

Positive spring loaded, self locking, steel latches. Safety lock T-hinges allow hinging and latching from either side.

Louver

Die formed of low iridescent, vertical grain anodized aluminum. Finish is Anodic oxide coating. Accurate precision parabolic cells are held in place with interlocking feature. True-cut mitered corners. Black reveal with integral mechanical light seal around entire perimeter of louver. Louver protected from construction contaminants by polyethylene cover.

Compliance

Options to meet Buy American Act requirements.

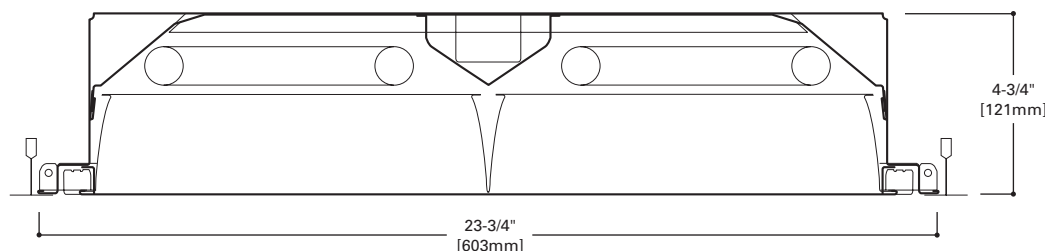

MOUNTING DATA

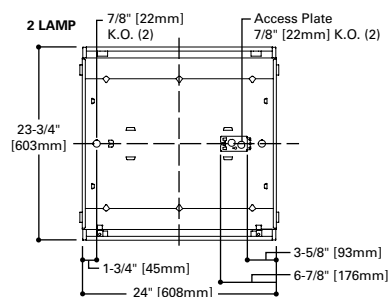

LAMP CONFIGURATIONS

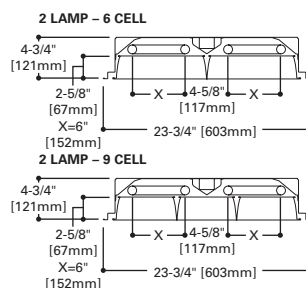

CEILING COMPATIBILITY

G	G	G	F	MZ	Ceiling Type	Trim Type
Grid/Lay-in Standard	ConcealedT	Slot Grid	Aluminum Flange Trim With Supporting Swing Gates	Modular Trim With Supporting Swing Gates	Exposed Grid	G
					ConcealedT	G
					Slot Grid	G
					Flange	F
					Concealed "T" or "Z"	MZ
					Metal Pan	MZ
					(Verify compatibility/ consult factory.)	



2EP3GAX-IC 2U6T8

6, 9, 16 Cell

2' X 2' PARABOLIC
2-U LAMPS
SEMI-SPECULAR,
SPECULAR OR WHITE
PAINTED LOUVER

Paralux III
Recessed Static or
Air Supply Troffer

For Use in
Insulated Ceilings



ENERGY DATA

Input Watts:
EB Ballast & STD Lamps
2U6T8 (61)

Luminaire Efficacy Rating
LER = FP-52
Catalog Number: 2EP3GAX-IC-2U6T8

Yearly Cost of 1000 lumens,
3000 hrs at .08 KWH = \$4.62

**Reference the lamp/ballast data in the
Technical Section for specific lamp/ballast
requirements.

LINEAR DISCONNECT
Designed to provide safe and convenient
means of disconnecting power

PHOTOMETRICS

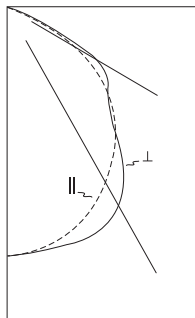
**2EP3GAX-IC-2U6T8S231**

Electronic Ballast

FB31T8/35K/6 Lamps
2600 LumensSpacing criterion:
(II) 1.2 x mounting
height, (⊥) 1.3 x
mounting height

Efficiency 63.8%

Test Report:

2EP3GAXIC2U6T8S231.IES

LER = FP-52

Yearly Cost of 1000
lumens, 3000 hrs at
.08 KWH = \$4.62**Coefficients of Utilization**

		Effective floor cavity reflectance								20%							
		80%				70%				50%				30%			
rc																	
rw		70	50	30	10	70	50	30	10	50	30	10		50	30	10	0
RCR																	
0		76	76	76	76	74	74	74	74	71	71	71		68	68	68	64
1		71	68	66	64	69	67	65	63	64	62	61		62	60	59	56
2		65	60	57	53	63	59	56	53	57	54	52		55	53	51	48
3		60	54	49	45	58	53	48	45	51	47	44		49	46	43	41
4		55	48	43	39	53	47	42	39	45	41	38		44	40	37	36
5		51	43	38	34	49	42	37	33	41	36	33		40	36	33	31
6		47	39	33	29	46	38	33	29	37	32	29		36	32	29	27
7		43	35	30	26	42	35	30	26	34	29	26		33	29	26	24
8		40	32	27	23	39	32	27	23	31	26	23		30	26	23	22
9		38	29	24	21	37	29	24	21	28	24	21		28	24	21	20
10		35	27	22	19	35	27	22	19	26	22	19		26	22	19	18

Zonal Lumen Summary

Zone	Lumens	%Lamp	%Fixture
0-30	1067	20.5	32.2
0-40	1717	33.0	51.8
0-60	2984	57.4	90.0
0-90	3317	63.8	100.0
0-180	3317	63.8	100.0

Typical VCP Percentages

Room Size (Ft.)	Height Along		Height Across	
	8.5'	10.0'	8.5'	10.0'
20 x 20	72	67	65	60
30 x 30	79	73	75	69
30 x 60	83	78	79	74
60 x 30	82	78	78	73
60 x 60	85	82	82	78

Candela

Angle	Along II	45°	Across ⊥
0	1314	1314	1314
5	1303	1311	1319
10	1274	1304	1338
15	1234	1300	1371
20	1188	1293	1383
25	1129	1266	1330
30	1066	1210	1174
35	990	1089	998
40	909	920	902
45	812	773	880
50	708	698	924
55	586	647	950
60	422	547	754
65	204	327	327
70	65	102	100
75	21	25	26
80	7	9	10
85	4	4	4
90	0	0	0

ORDERING INFORMATION

SAMPLE NUMBER: 2EP3GAX-IC-3BX4036-120V-EB51-U

Domestic Preferences⁽⁹⁾ [Blank] =Standard BAA =Buy American Act	Number of Lamps 2=2 Lamps 3=3 Lamps ⁽³⁾	Voltage⁽⁴⁾ 120V =120 Volt 277V =277 Volt 347V =347 Volt UNV =Universal Voltage 120-277 ⁽⁵⁾	Ballast Type EB8 =T8 Electronic Start. Total Harmonic Distortion < 10% No. of Ballast 1, 2 or 3 EB8+/PLUS =T8 Electronic Start. Total Harmonic Distortion < 10% High Ballast Factor >1.15 No. of Ballast 1, 2 or 3 ER8 =T8 Electronic Program Rapid Start. Total Harmonic Distortion < 10% No. of Ballast 1, 2 or 3	Options PAF =Painted After Fabrication REP =Riveted Endplates Packaging U =Unit Pack PAL =Job Pack, out of carton PALC =Job Pack, in carton
Rating Blank =Standard ATW-SW4 =Chicago Rated HR =Heat Removal ⁽¹⁾ Width 2=2' Width EP =Paralux Louver 3=3" Louver Depth	Wattage (Length) U6T8 =32WT8 (24") U15/8 =31WT8 (24") Louver Color/Type ST =Silver Tannenbaum	Options GL =Single Element Fuse GM =Double Element Fuse WTR =White Reveal Flex =Flex Installed (Reference Flex ordering information) EL =Emergency Installed ^{(6), (10)}		
Trim Type G =Grid/Lay-in (Standard) G =Concealed T/Slot Grid ⁽⁷⁾ F =Aluminum Flange Trim ⁽⁸⁾ MZ =Modular Trim AX =Air Supply Floating Louver X =Blank Side/Floating Louver - Non-Air Supply (Omit A) AVX =Air Supply Floating Louver with Directional Air Vane (Add V)	Cell Configuration 36=3 Rows of 6, 18 Cell Option - Aluminum Flange Trim⁽⁸⁾ Blank =SW (Single White) Type Color 'S' Single 'N' Natural 'R' In Row 'W' White 'E' End of Row			
IC =IC Rated				

ACCESSORIES⁽¹⁰⁾**EQ-CLIP-U**=T-BAR Safety Earthquake Clips⁽²⁾

NOTES: ⁽¹⁾ Integral end plate grid lock feature not available in heat removal. ⁽²⁾ An EQ Grid Clip is recommended for all 9/16" ceiling systems. Four required per fixture. ⁽³⁾ Standard off-center ballast on 3-lamp fixtures. ⁽⁴⁾ Products also available in non-US voltages and frequencies for international markets. ⁽⁵⁾ Not available when specifying emergencies, voltage must be specific. ⁽⁶⁾ Fixtures equipped with "EL" option may require a 5-1/2" housing depth. If installing in field, must use low profile battery pack. ⁽⁷⁾ Louver is recessed by 5/16" in Concealed T or Slot Grid T. ⁽⁸⁾ Specify row configuration, type in catalog number when ordering complete fixture. ⁽⁹⁾ Only product configurations with this designated prefix are built to be compliant with the Buy American Act of 1933 (BAA). Please refer to **DOMESTIC PREFERENCES** website for more information. Components shipped separately may be separately analyzed under domestic preference requirements. ⁽¹⁰⁾ Accessories sold separately will be separately analyzed under domestic preference requirements. Consult factory for further information.

Specifications & dimensions subject to change without notice. Consult your Cooper Lighting Solutions Representative for availability and ordering information.

SHIPPING DATA

Catalog No.	Wt.
2EP3GAX-IC-2U6T8S231	28 lbs.
2EP3GAX-IC-2U6T8S331	28 lbs.
2EP3GAX-IC-2U6T8S441	28 lbs.