

## DESCRIPTION

The Paralux III Series features recessed aesthetics and the latest in energy efficient technology. The luminaire incorporates a true 3" deep precision cell louver into a deep para-contoured fixture housing. This combination creates a total high performance parabolic optical assembly for optimum performance. The series is compatible with all of today's popular ceiling systems and is available with a number of options and accessories for application versatility. The high performance luminaire is designed to offer maximum efficiency and performance for today's unique interior specifications. The Paralux III series is an excellent choice for commercial office spaces, schools, hospitals or retail merchandising areas.

## SPECIFICATION FEATURES

### Construction

Deep, para-contoured housing, die formed of code gauge, prime cold rolled steel. Die embossed housing has full length die formed stiffeners for added strength. Contoured ballast/wireway cover is easily removed without tools. Die formed captive lampholder bracket fully encloses lampholder wiring permitting easy lampholder replacement. Heavy end plates are securely attached with interlocking tabs and screws. Four auxiliary fixture end suspension points provided. KO's for continuous row wiring. End plates have integral Grid-Lock feature for safety and convenience. Housing features enable fixture to be converted from Grid to T-option or vice versa in the field.\*

### Electrical\*\*

Ballast are CBM/ETL Class "P" and are positively secured by mounting bolts. Pressure lock lampholders. UL/CUL listed. Suitable for damp locations.

### Finish

Lighting grade, baked white enamel finish. Multistage, iron phosphate pretreatment ensures maximum bonding and rust inhibition.

### Hinging/Latching

Positive cam action spring loaded, self locking, black steel latches. Safety lock T-hinges allow hinging and latching either side.

### Louver

Die formed of low iridescent, vertical grain anodized aluminum. Finish is Anodic Oxide coating. Accurate precision parabolic cells are held in place with interlocking feature. True-cut mitered corners. Black reveal with integral mechanical light seal around entire perimeter of louver. Louver protected from construction contaminants by polyethylene cover.

### Compliance

Options to meet Buy American Act requirements.

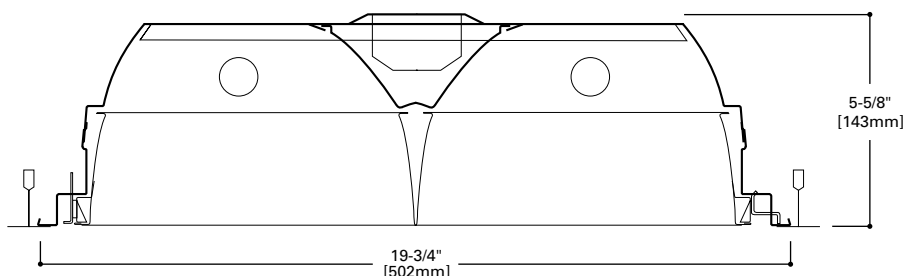

## MOUNTING DATA

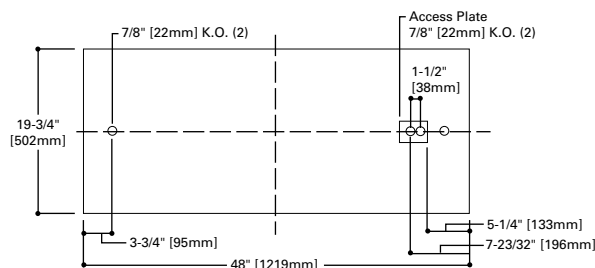

## LAMP CONFIGURATIONS

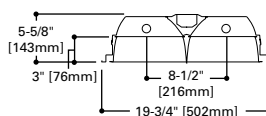

## CEILING COMPATIBILITY

G	T	T	F	MZ	Ceiling Type	Trim Type
Grid/Lay-in Standard	Concealed T	Slot Grid	Aluminum Flange Trim With Supporting Swing Gates	Modular Trim With Supporting Swing Gates	Exposed Grid	G
					Concealed T	G or T
					Slot Grid	G or T
					Flange	F
					Concealed "T" or "Z"	MZ
					Metal Pan	MZ
					(Verify compatibility/ consult factory.)	

Catalog #	Type
Project	
Comments	Date
Prepared by	



**EP3GAX2048**  
**228T8**  
**232**

**12 Cell**

**20" X 48" PARABOLIC**  
**2 T8 LAMPS**  
**SEMI-SPECULAR, SPECULAR**  
**OR WHITE PAINTED LOUVER**

Paralux III  
Recessed Static or Air  
Supply Troffer



## ENERGY DATA

Input Watts:  
**EB Ballast & STD Lamps**  
228T8 (48), 232 (55)

Luminaire Efficacy Rating

**LER = FP-59**

Catalog Number:

EP3GAX2048-2U1-5/8

**Yearly Cost of 1000 lumens,**  
**3000 hrs at .08 KWH = \$4.07**

\*Convertibility applies to housing only.  
Appropriate shielding media assemblies  
must be utilized.

\*\*Reference the lamp/ballast data in the  
Technical Section for specific lamp/ballast  
requirements.

**LINEAR DISCONNECT**  
Designed to provide safe and convenient  
means of disconnecting power

## PHOTOMETRICS

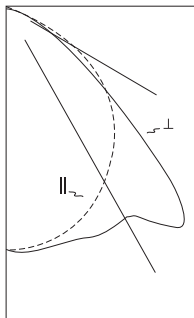

### EP3GAX2048-232S261

Electronic Ballast

F32T8/35K Lamps  
2800 Lumens

Spacing criterion:  
(H) 1.2 x mounting  
height, (L) 1.8 x  
mounting height

Efficiency 71.5%

Test Report:  
EP3GX2048232S261.IES

LER = FP-59

Yearly Cost of 1000  
lumens, 3000 hrs at  
.08 KWH = \$4.07

### Coefficients of Utilization

		Effective floor cavity reflectance								20%							
		80%				70%				50%				30%			
		rc				rc				rc				rc			
		rw	70	50	30	10	70	50	30	10	50	30	10	50	30	10	0%
		RCR															
		0	85	85	85	85	83	83	83	83	79	79	79	76	76	76	71
		1	80	77	75	73	78	75	73	71	73	71	69	70	68	67	64
		2	74	70	66	62	72	68	65	62	66	63	60	64	61	59	56
		3	69	63	58	54	67	61	57	54	59	56	53	58	54	52	50
		4	63	56	51	47	62	55	50	46	53	49	46	52	48	45	43
		5	58	50	44	40	57	49	44	40	48	43	40	47	42	39	37
		6	54	45	39	35	52	44	39	35	43	38	34	42	38	34	33
		7	49	40	34	30	48	40	34	30	39	34	30	38	33	30	28
		8	45	36	30	26	44	35	30	26	34	29	26	34	29	25	24
		9	41	32	26	22	40	31	26	22	31	26	22	30	25	22	21
		10	38	29	23	19	37	28	23	19	28	23	19	27	22	19	18

### Zonal Lumen Summary

Zone	Lumens	%Lamp	%Fixture
0-30	1209	21.6	30.2
0-40	2061	36.8	51.5
0-60	3713	66.3	92.8
0-90	4003	71.5	100.0
0-180	4003	71.5	100.0

### Typical VCP Percentages

Room Size (Ft.)	Height Along		Height Across	
	8.5'	10.0'	8.5'	10.0'
20 x 20	78	75	82	79
30 x 30	85	81	87	84
30 x 60	87	84	89	86
60 x 30	85	84	88	86
60 x 60	88	87	90	89

### Candela

Angle	Along H	45°	Across ⊥
0	1490	1490	1490
5	1476	1495	1509
10	1447	1487	1517
15	1407	1467	1516
20	1355	1436	1524
25	1292	1402	1549
30	1218	1374	1568
35	1134	1345	1597
40	1037	1309	1802
45	929	1283	1658
50	807	1251	1000
55	665	930	553
60	497	469	342
65	296	222	175
70	118	83	58
75	31	26	25
80	10	11	11
85	3	3	3
90	0	0	0

### ORDERING INFORMATION

SAMPLE NUMBER: EP3GAX2048-232S261-UNV-EB81-U

<b>Domestic Preferences<sup>(9)</sup></b> <b>[Blank]</b> =Standard <b>BAA</b> =Buy American Act  <b>Rating</b> <b>Blank</b> =Standard <b>ATW-SW4</b> =Chicago Rated  <b>Heat Removal<sup>(1)</sup></b> <b>HR</b> =Heat Removal <b>HRDO</b> =Heat Removal Damper Open <b>HRDC</b> =Heat Removal Damper Closed  <b>Series</b> <b>EP3</b> =Paralux III  <b>Trim Type<sup>(4)</sup></b> <b>G</b> =Grid/Lay-in - Standard <b>T</b> =Concealed T/Slot Grid <sup>(2)</sup> <b>F</b> =Aluminum Flange Trim <sup>(6)</sup> <b>MZ</b> =Modular Trim  <b>Air Supply</b> <b>AX</b> =Air Supply Floating Louver <b>X</b> =Blank Side/Floating Louver - Non-Air Supply <b>AVX</b> =Air Supply Floating Louver with Directional Air Vane  <b>Width</b> <b>2048</b> =20" Width x 48" Length	<b>Number of Lamps</b> 2 lamps  <b>Wattage (Length)</b> <b>28T8</b> =28W T8 (48") <sup>(7)</sup> <b>32</b> =32W T8 (48")  <b>Louver Color</b> <b>S</b> =Silver <b>W</b> =White  <b>Cell Configuration</b> <b>26</b> =2 Rows of 6, 12 Cell (20x48)  <b>Louver Finish</b> <b>I</b> =Semi-Specular/Haze (Low Iridescent) Standard (Silver Only) <b>P</b> =Painted (White only)  <b>Option - Aluminum Flange Trim<sup>(8)</sup></b> <b>Blank</b> =SW (Single White) Type Color 'S' Single 'N' Natural 'R' In Row 'W' White 'E' End of Row	<b>Voltage<sup>(3)</sup></b> <b>120V</b> =120 Volt <b>277V</b> =277 Volt <b>347V</b> =347 Volt <b>UNV</b> =Universal Voltage 120-277 <sup>(6)</sup>  <b>Options</b> <b>GL</b> =Single Element Fuse <b>GM</b> =Double Element Fuse <b>WTR</b> =White Reveal <b>Flex</b> =Flex Installed (Reference Flex ordering information) <b>EL</b> =Emergency Installed <sup>(8)</sup>	<b>Ballast Type</b> <b>EB8</b> =T8 Electronic Start. Total Harmonic Distortion < 10% No. of Ballast 1, 2 or 3 <b>EB8 /PLUS</b> =T8 Electronic Start. Total Harmonic Distortion < 10% High Ballast Factor >1.15 No. of Ballast 1, 2 or 3 <b>ER8</b> =T8 Electronic Program Rapid Start. Total Harmonic Distortion < 10% No. of Ballast 1, 2 or 3  <b>High Performance T8 Ballasts</b> <b>HB8</b> =T8 Electronic Instant Start. Total Harmonic Distortion < 10%. Standard Ballast Factor .86 - .88 <b>HB8_L</b> =T8 Electronic Instant Start. Total Harmonic Distortion < 10%. Low Ballast Factor .77 - .82 <b>HB8_N</b> =T8 Electronic Instant Start. Total Harmonic Distortion < 10%. Normal Ballast Factor 1.0 <b>HB8_H</b> =T8 Electronic Instant Start. Total Harmonic Distortion < 10%. High Ballast Factor 1.15 - 1.20 <b>HR8</b> =T8 Electronic Program Rapid Start. Total Harmonic Distortion < 10%. Standard Ballast Factor .86 - .88 <b>HR8_DIM</b> =T8 Electronic Program Rapid Start. Total Harmonic Distortion < 10%. Step Dimming. Ballast Factor .88 <b>HR8_L</b> =T8 Electronic Program Rapid Start. Total Harmonic Distortion < 10%. Low Ballast Factor .71 - .79 <b>HR8_H</b> =T8 Electronic Program Rapid Start. Total Harmonic Distortion < 10%. High Ballast Factor 1.15 - 1.20	<b>Options</b> <b>PAF</b> =Painted After Fabrication <b>REP</b> =Riveted Endplates  <b>Packaging</b> <b>U</b> =Unit Pack <b>PAL</b> =Job Pack, out of carton <b>PALC</b> =Job Pack, in carton
---	--	---	---	--

### ACCESSORIES<sup>(10)</sup>

EQ-CLIP-U=T-BAR Safety Earthquake Clips<sup>(2)</sup>

NOTES: <sup>(1)</sup> Integral end plate grid lock feature not available in heat removal. <sup>(2)</sup> An EQ Grid Clip is recommended for all 9/16" ceiling systems. Four required per fixture. <sup>(3)</sup> Products also available in non-US voltages and frequencies for international markets. <sup>(4)</sup> Convertibility applies to housing only, appropriate shielding media assemblies must be utilized. Fixture also adaptable with flanged or modular trims. <sup>(5)</sup> Not available when specifying emergencies, voltage must be specific. <sup>(6)</sup> Specify row configuration, type in catalog number when ordering complete fixture. <sup>(7)</sup> When utilizing 28W T8 lamps, HPT8 Ballast must be specified. 32W lamps are 90 CRI only. <sup>(8)</sup> Please specify required voltage, 120V or 277V. <sup>(9)</sup> Only product configurations with this designated prefix are built to be compliant with the Buy American Act of 1933 (BAA). Please refer to **DOMESTIC PREFERENCES** website for more information. Components shipped separately may be separately analyzed under domestic preference requirements. <sup>(10)</sup> Accessories sold separately will be separately analyzed under domestic preference requirements. Consult factory for further information.

Specifications & dimensions subject to change without notice. Consult your Cooper Lighting Solutions Representative for availability and ordering information.

### SHIPPING DATA

Catalog No.	Wt.
EP3GAX2048-232S261	41 lbs.