

Project	Catalog #	Type
Prepared by	Notes	Date



Streetworks

Utility Flood Medium

Floodlight & Sign Lighting Luminaire

Product Certifications & Features



Interactive Menu

- Ordering Information [page 2](#)
- Mounting Details [page 2](#)
- Energy and Performance Data [page 3](#)

Product Specifications

OPTICS

- The LED chamber incorporates a vacuum metalized reflector that provides high-efficiency illumination.
- Optics are precisely designed to shape the NEMA type 6H x 6V wide distribution and 3H x 3V spot distribution, maximizing efficiency and application spacing.
- Clear glass tempered lens with full circumference form-in-place silicone gasket protects the optics from damage.
- Various CCTs available, offered in 2200K, 2700K, 3000K, 4000K, 5000K, or 5700K and minimum 70 CRI.

ELECTRICAL

- LED driver is mounted to the removable die-cast aluminum door for optimal heat sinking and ease of maintenance.
- 120-277V, 240-480V, 347V, and 480V; 50/60Hz
- Standard 0-10V dimming
- Integral 6kV surge is standard. 10kV surge protection options with series or parallel configurations
- 40°C to 40°C ambient temperature operating range. Optional 50°C HA (high ambient) available.

PHYSICAL CHARACTERISTICS

- Heavy-duty, die cast aluminum housing, driver compartment and driver door.
- A separate driver compartment and external fins provide optimal thermal management that result in longer LED and driver life.
- Access to the driver for maintenance is achieved with a removable driver door using pan head screws.
- A one-piece silicone gasket seals the door to the fixture housing.
- Housing and cast parts finished in five-stage super TGIC polyester powder coat paint, 2.5 mil nominal thickness for superior protection against fade and wear.
- Heavy-duty steel top and side visors control glare and spill light. 1/8" thick UV stabilized vandal guard shields glass lens from impact when mounted at low levels.
- Easy to install wire guard features a heavy-gauge welded construction with corrosion resistant polyester powder coat finish to protect glass from projected objects.
- Optional Factory or field installable nature guard made of steel for extended durability

CONTROLS

- Available with ANSI C136.10 3-pin or C136.41 7-pin control receptacle.

- Optional Field Adjustable Dimming Control (FADC) module allows for manual adjustment of lumen output and power usage; factory preset to highest output level. Enables a single SKU to cover multiple field applications

MOUNTING

- Mounting options include an integral die-cast aluminum slipfitter that is preset to a tilt of 45°.
- The knuckle base is supplied with a tooth lock adjustment that can be adjusted in 5° increments. Visual 15° adjustment indicators on the knuckle allow for 180° field rotation of the floodlight assembly.
- The slipfitter fits standard 2-3/8"-3" O.D. tenon.
- The trunnion mounting includes a 3/16" polyester powder coated galvanized steel trunnion with a 16/3 STW-A cord.
- The trunnion mount uses an interlocking slide adjustment that is locked in place with a set screw.

FINISH

- Housing and cast parts finished in five-stage super TGIC polyester powder coat paint, 2.5 mil nominal thickness for superior protection against fade and wear.

COMPLIANCE

- The housing, optical chamber and driver compartment are IP66 rated.
- Meets ANSI C136.31 for 3G luminaire vibration. Customer is responsible for engineering analysis to confirm pole and fixture compatibility for all applications. Suitable for mounting within 4' (1.2m) of the ground.
- BAA domestic preference option meets BAA requirements
- Products that meet BABA Domestic Preference Requirements - This Cooper product is manufactured in the US and meets the BABA cost of components rule. To verify a configured product with specific accessories and options meets BABA Domestic Preference Requirements; submit this catalog number to Cooper Lighting Quotation team for validation by our Engineering and Manufacturing teams. Our BABA designation is based on the minimum compliance requirement for BABA. Individual Government Agencies may have more stringent compliance standards.
- Products that meet BABA through Exemption - Allows any product to satisfy BABA requirements regardless of domestic content manufacturing for projects funded by FHWA through Oct 1st 2025. See notes portion in Ordering Information section for more detail.
- Products that meet BABA through BAA Exemption - FHWA and FTA agencies are utilizing their BAA rules for BABA compliance. Cooper's products with a BAA designation are manufactured in the US and utilize a BAA COTS exemption

rule for compliance. To verify a configured product with specific accessories and options meet BABA Domestic Preference Requirements; submit this catalog number to Cooper Lighting Quotation team for validation by our Engineering and Manufacturing teams. See notes portion in Ordering Information section for more detail.

- Please refer to the [DOMESTIC PREFERENCES](#) website or consult the CLS Domestic Preferences team for more information. Components shipped separately may be separately analyzed under domestic preference requirements.

SHIPPING DATA

- Approximate net weight: 20 lbs. (9.09 kgs.)
- EPA: 1.25 sq. ft.
- UFLD w/ Slipfitter / Trunnion Mount:
 - » Carton Size: 16 7/8" x 10 1/4" x 17 1/2"
 - » Pallet Size: 52" X 42"
 - » Cartons/Pallet: 24
- UFLD w/ Slipfitter / Trunnion Mount:
 - » Carton Size: 19 1/8" x 9 15/16" x 15 9/16"
 - » Pallet Size: 48" X 40"
 - » Cartons/Pallet: 30

WARRANTY

- Five-year limited warranty. Consult website for details. www.cooperlighting.com/legal

Dimensional Details

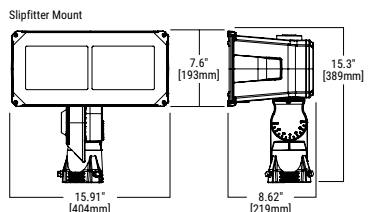

See Additional Dimensional Details for more detailed information.

Ordering Information

SAMPLE ORDER NUMBER: UFLD-CA2-180-740-U-66-C-BK-10K-PR7

Product Family	Configuration	Wattage Bucket	Color Temperature	Voltage	Distribution	Mounting	Color
UFLD =Utility Flood Medium BAA-UFLD =Utility Flood Medium Buy American Act Compliant ¹⁵ TAA-UFLD =Utility Flood Medium Trade Agreements Act Compliant ¹⁵ BABAE-UFLD =Build America Buy America Act (FHWA Exception, for projects funded by Oct 1, 2025) ¹⁵ BABAF-UFLD =Build America Buy America Act (FHWA Exception, for projects funded between Oct 1, 2025 and Oct 1, 2026, and FTA Buy America) ¹⁵	CA2 =2 LED	80 =80W 90 =90W 120 =120W 130 =130W 140 =140W 150 =150W 180 =180W 200 =200W	740 =70CRI, 4000K 727 =70CRI, 2700K ² 722 =70CRI, 2200K ² 730 =70CRI, 3000K ² 750 =70CRI, 5000K ² 760 =70CRI, 5700K ²	U =Universal (120-277V) 8 =480V ¹ 9 =347V	66 =NEMA 6H x 6V Wide ¹⁴ 33 =NEMA 3H x 3V Spot ¹³	C =Slipfitter, 2-3/8"-3" O.D. (SO cord through housing) S =Slipfitter, 2-3/8" - 3" O.D. (Leads through slipfitter) T =Trunnion Y =Yoke	BK =Black BZ =Bronze AP =Grey WH =White
Options (Add as Suffix)		Controls		Accessories (Order Separately) ¹⁶			
10K =Series 10kV UL 1449 Surge Protective Device 20K =Series 20kV UL 1449 Surge Protective Device 20KI =Series 20kV UL 1449 Surge Protective Device with light indicator 10MSP =Parallel 10kV MOV Surge Protection Device 20MSP =Parallel 20kV MOV Surge Protective Device HA =50°C High Ambient Temperature ³ CXXX =Cord Type ¹¹ FADC =Field Adjustable Dimming Controller ¹² NG-NF =Factory-installed Nature Guard Dxxxxx =DOT Configuration - Contact Quotes Team Uxxxxx =Utility Configuration - Contact Quotes Team		PR =NEMA 3-PIN Photocontrol Receptacle PR7 =NEMA 7-PIN Twistlock Photocontrol Receptacle MSP/DIM-L12 =Integrated Occupancy Sensor for Dimming Operation, 8' - 12' Mounting Height ^{4,5} MSP/DIM-L30 =Integrated Occupancy Sensor for Dimming Operation, 12' - 30' Mounting Height ^{4,5} MSP-L12 =Integrated Occupancy Sensor for ON/OFF Operation, 8' - 12' Mounting Height ^{4,5} MSP-L30 =Integrated Occupancy Sensor for ON/OFF Operation, 12' - 30' Mounting Height ^{4,5}		FA63 =3" O.D. Surface Mount Bracket ⁷ OA1223 =10kV/10kA UL 1449 Surge Protective Device Replacement OA/RA1013 =Photocontrol Shorting Cap ¹⁷ OA/RA1014 =NEMA Photocontrol - 120V ¹⁷ OA/RA1016 =NEMA Photocontrol - Multi-Tap ¹⁷ OA/RA1027 =NEMA Photocontrol - 480V ¹⁷ OA/RA1201 =NEMA Photocontrol - 347V ¹⁷ RAB-XX =Right Angle Pipe Bracket for Slipfitter ⁶ SAB-XX =Steel Angle Bracket for Trunnion ⁶ TYS-XX =Slipfitter Adapter for 2-3/8", 3" or 3-1/2" O.D. Tenon ^{6,8} TS2/UFLD-XX-M =Top and Side Visors ^{6,9} VS/UFLD-M =Vandal Shield ⁹ WG/UFLD-M =Wire Guard ⁹ NG-NF-FLD =Field-installed Nature Guard ISHH-01 =Integrated Sensor Programming Remote LLPC =Long-life Photocontrol ¹⁰ LLPC-FO =Long-life Photocontrol (Fail-Off) ¹⁰			
NOTES: 1. Only for use with 480V Wye systems. Per NEC, not for use with ungrounded systems, impedance grounded systems or corner grounded systems (commonly known as Three Phase Three Wire Delta, Three Phase High Leg Delta and Three Phase Corner Grounded Delta systems) 2. Extended lead times apply. Use dedicated IES files for 3000K, 5000K, and 5700K when performing layouts. These files are published on the UFLD luminaire product page on the website. 3. Not available with 3H x 3V spot distribution or 200W Wattage Bucket. 4. Integrated sensor option only available in slipfitter mounting. 5. Not available with Photocontrol. 6. Replace XX with color designation. Additional brackets and adaptors available on the poles product page on the website. 7. Not available with tenon mount. 8. Not available with slipfitter mount. 9. Cannot combine TS2 (Top and Side Visor), VS (Vandal Shield), or WG (Wire Guard), limited to one external guard per fixture. 10. Sold as accessory. Not covered under luminaire warranty.				11. 3-conductor cord available in 12, 14, and 16 gauge with lengths of 5, 8, 10, 15, 20, and 25 feet. Specify cord gauge with the first 2 digits and cord length with the last 2 digits (ex: C1605 = 16-gauge, 5 feet length cord). Standard cord is 16-gauge with length of 3.5 ft if not specified. 12. Cannot be used with PR7 or other motion response control options. 13. Only available in 90W and 140W. 14. Available in 80W, 120W, 130W, 150W, 180W, and 200W wattage buckets. 15. Only product configurations with these prefixes are built to be compliant with the Buy American Act of 1933 (BAA) or the Build America Buy America Act (BABA). BABA is the minimum Government compliance requirement for the Build America Buy America standards which is part of the Infrastructure and Investment Jobs Act (IIJA). Individual Government Agencies may have more stringent compliance standards. BABAE designates the product will meet the standards set for FHWA. As noted these projects must receive Government Funding by October 1, 2025. BABAF designates the product will meet the standards set for FHWA and FTA. As noted these projects must receive Government Funding by October 1, 2026. Please refer to the DOMESTIC PREFERENCES website or consult the CLS Domestic Preferences team for more information. Components shipped separately may be separately analyzed under domestic preference requirements. 16. Accessories sold separately will be separately analyzed under domestic preference requirements. Consult factory for further information. 17. PR or PR7 is required with this accessory			

Mounting Details

Drilling Patterns

Trunnion Mount

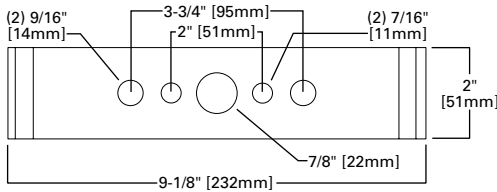

Yoke Mount

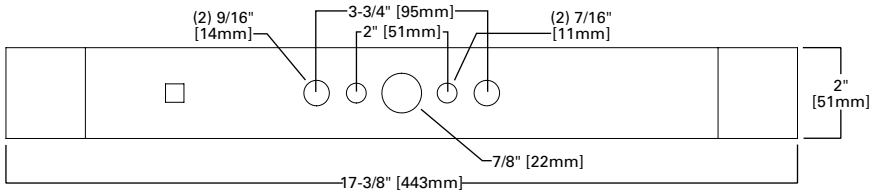

Optional Integrated Sensor

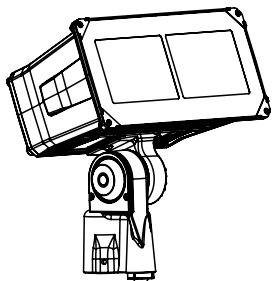

Accessories

Top and Side Visors

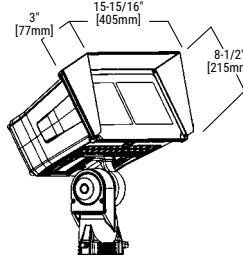

Wire Guard

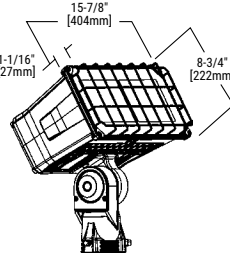

Vandal Shield

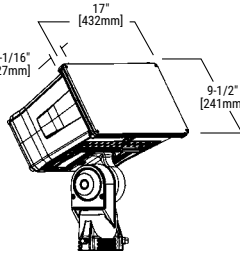

Nature Guard

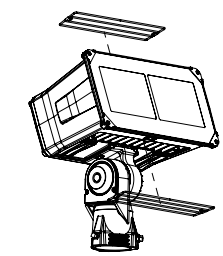

Additional Dimensional Data

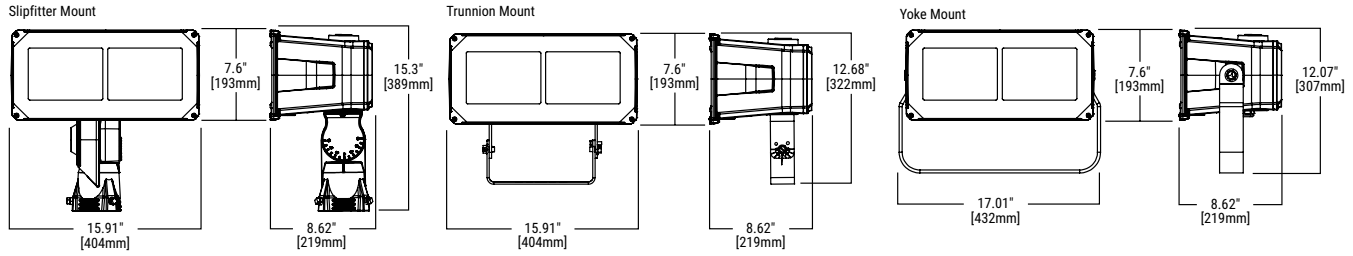

Energy and Performance Data

Distribution	6x6					
ANSI Wattage	80	120	130	150	180	200
Wattage	84	124	133	150	181	197
2200K	9,799	17,684	18,845	20,903	23,123	24,502
Lumens Per Watt	117	143	142	139	128	124
2700K	10,616	19,158	20,415	22,645	25,050	26,544
Lumens Per Watt	126	155	154	151	139	135
3000K	11,082	20,000	21,313	23,640	26,151	27,711
Lumens Per Watt	132	161	160	157	145	141
4000K	11,666	21,053	22,435	24,885	27,528	29,170
Lumens Per Watt	139	170	169	165	152	148
5000K	11,666	21,053	22,435	24,885	27,528	29,170
Lumens Per Watt	139	170	169	165	152	148
5700K	11,666	21,053	22,435	24,885	27,528	29,170
Lumens Per Watt	139	170	169	165	152	148

Distribution	3x3	
ANSI Wattage	90	140
Wattage	90	137
2200K	9,947	14,192
Lumens Per Watt	111	103
2700K	10,776	15,375
Lumens Per Watt	120	112
3000K	11,249	16,051
Lumens Per Watt	126	117
4000K	11,842	16,896
Lumens Per Watt	132	123
5000K	11,842	16,896
Lumens Per Watt	132	123
5700K	11,842	16,896
Lumens Per Watt	132	123

Current Draw

Voltage	Model Series							
	6 x 6	6 x 6	6 x 6	6 x 6	6 x 6	6 x 6	3x3	3x3
	80W	120W	130W	150W	180W	200W	90W	140W
	Current (A)	Current (A)	Current (A)	Current (A)	Current (A)	Current (A)	Current (A)	Current (A)
120V	0.701	1.033	1.100	1.242	1.507	1.642	0.747	1.145
277V	0.304	0.447	0.477	0.538	0.653	0.711	0.323	0.496
347V	0.242	0.357	0.380	0.429	0.521	0.568	0.258	0.396
480V	0.175	0.258	0.275	0.310	0.377	0.410	0.187	0.286

Lumen Maintenance

Ambient Temperature	TM-21 Lumen Maintenance (60,000 Hours)	Theoretical L70 (Hours)
All Distributions		
40°C	90.67%	221,000

Lumen Multiplier

Ambient Temperature	Lumen Multiplier
10°C	1.03
15°C	1.02
25°C	1.00
40°C	0.97
50°C	0.96

FADC Settings

FADC Position	Percent of Typical Lumen Output
1	25%
2	48%
3	56%
4	65%
5	75%
6	80%
7	85%
8	90%
9	95%
10	100%

NOTES: +/-5% typical value