

Project		Catalog #		Type	
Prepared by		Notes		Date	

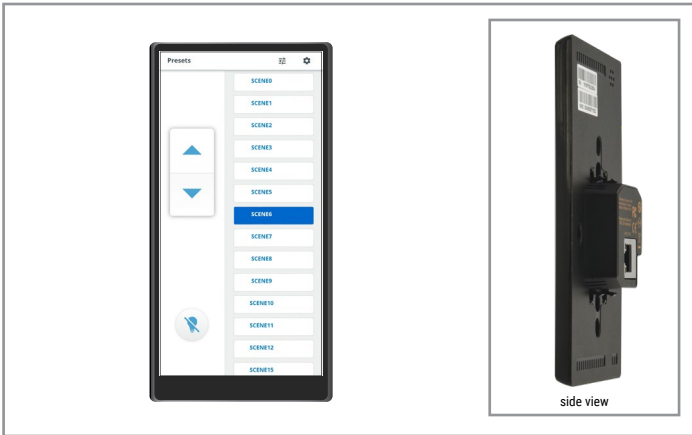

Fifth Light

TSE57 Fifth Light Touchscreen

Provides an elegant and discreet light control for any Fifth Light controlled space

Typical Applications

Office • Education • Healthcare • Hospitality • Retail

Interactive Menu

- Order Information [page 2](#)
- Additional Resources [page 3](#)
- Wiring Diagrams [page 4](#)
- Product Warranty

Product Certification



Title 47
Part 15
Class B

- Meets latest ASHRAE Standard 90.1 requirements
- Meets latest IECC requirements
- Meets latest CEC Title 24 requirements

Product Features



PoE
802.3af

Manual
Dimmer

Manually Switched
ON/OFF

Top Product Features

- **Light control** – Control the lights for a room/open space by allowing users to recall the light scenes/presets defined for the area and to raise/lower the light level for the entire area or the zones defined within an area.
- **Architectural design** – Low profile design with edge to edge glass and high resolution display making the touchscreen look amazing on any wall. The touchscreen’s user interface has been designed to ensure that users can immediately understand how to operate the touchscreen.
- **Easy installation** – The touchscreen easily mounts in a single gang switch box (minimum 1.4" / 35mm depth required) and is powered via PoE (IEEE 802.3af). All the information with regards to the scene names, zone names is automatically imported from the Fifth Light Central Manager.

Dimensional Details

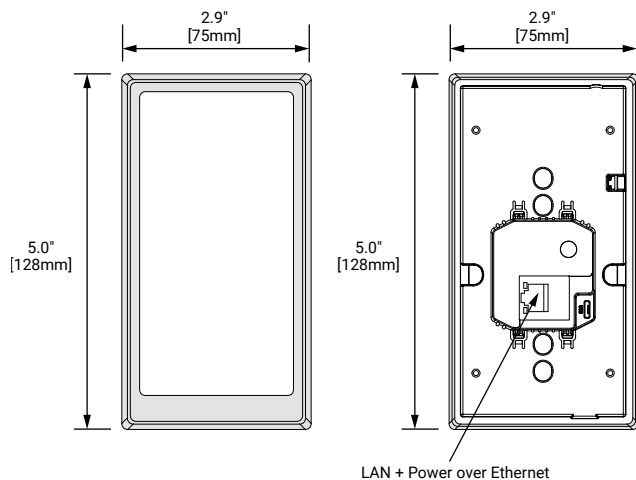

Mounting Height

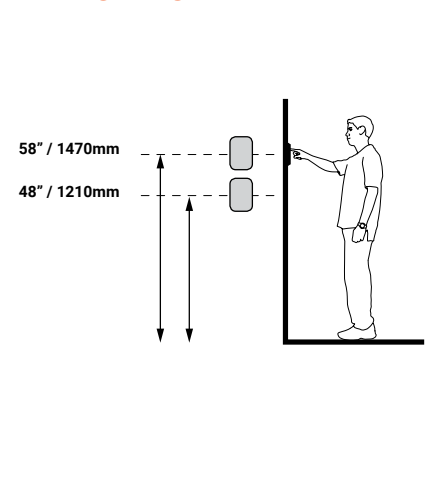

Order Information

The touchscreen is an accessory to the Fifth Light system.

Catalog Number

Catalog Number	Description
TSE57-WLX-B	5.7" Touchscreen for Fifth Light

Product Specifications

Key Features

- **Light control** – Control the lights for a room/open space by allowing users to recall the light scenes/presets defined for the area and to raise/lower the light level for the entire area or the zones defined within an area.
- **Architectural design** – Low profile design with edge to edge glass and high resolution display making the touchscreen look amazing on any wall. The touchscreen's user interface has been designed to ensure that users can immediately understand how to operate the touchscreen.
- **Easy installation** – The touchscreen easily mounts in a single gang switch box (minimum 1.4" / 35mm depth required) and is powered via PoE (IEEE 802.3af). All the information with regards to the scene names, zone names is automatically imported from the Fifth Light Central Manager.

Mechanical

Size: 5.0" x 2.9" x 0.3" (128 x 75 x 8mm) 0.6" (15mm) depth inside wall box

Environment:

- **Operating temperature:** 32°F to 104°F (0°C to 40°C)
- **Storage temperature:** 4°F to 158°F (-20°C to 70°C)
- **Relative humidity:** 0 - 90% non-condensing
- For indoor use only

Mounting: North America: single-gang switchbox (Arlington LV1)
Europe: single-gang Ø 65mm outlet switchbox (IEC/EN 60670)
UK: single gang electrical box BS 4662, BSEN 60670
Do not mount on metal surface

Mounting Height: 48"- 58" (121cm-147cm) above finished floor

Color: Black trim

Housing: High glass plastic

Electrical

Input Power:

- PoE (IEEE 802.3af)
- 4W (typical) / 8W (max)

Display:

- High performance 5.77" LCD
- High definition resolution (1440 x 720)
- Projected Capacitive Touch supporting multi-touch and gesture

Network:

- Gigabit Ethernet controller
- RJ-45 Ethernet port connectivity

System Performance

Capacity: Up to 16 per WAC

Standards/Ratings

- cULus Listed - Energy Management Equipment (UL916)
- FCC Title 47, Part 15 Class B
- CE
- Meets latest ASHRAE Standard 90.1 requirements
- Meets latest IECC requirements
- Meets latest CEC Title 24 requirements

Environmental Regulations:

- RoHS Directive 2011/65/EU
- WEEE Directive 2012/19/EU

Warranty

Five year warranty standard

System Architecture

This diagram illustrates the main components of the Fifth Light system. The DALI wallstations, DALI multi-sensors, DALI field relay, DALI dimming module, DALI DAC and DALI dimmable drivers/ballasts communicate with the Lighting Control Panel over the DALI bus while the touchscreen communicates with the Central Manager via ethernet.

Complete Fifth Light system

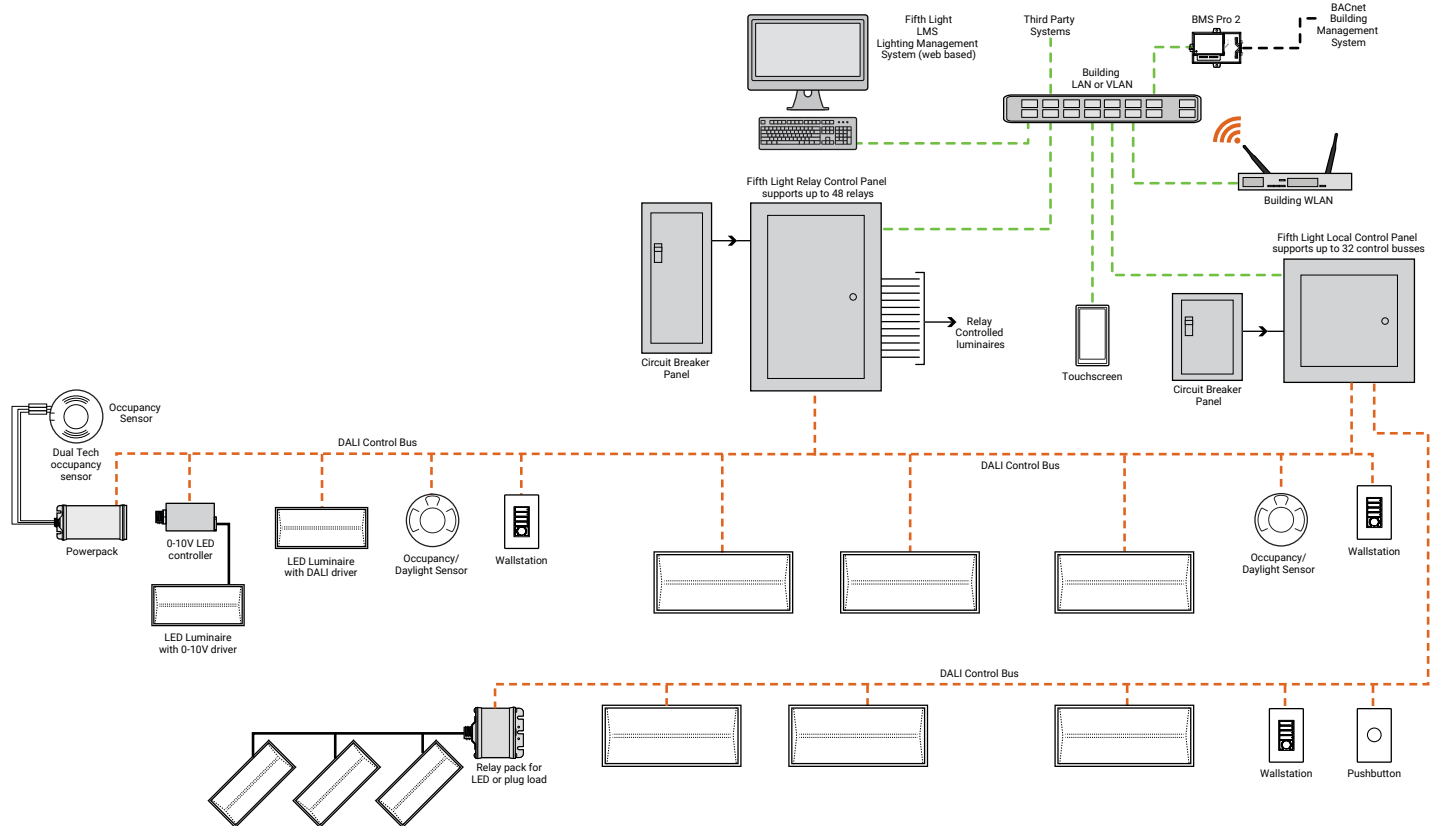

Overview

The Fifth Light TSE57 touchscreen provides an elegant and discreet light control for any Fifth Light controlled space. The portrait-oriented 5.7" [14.5cm] touchscreen features a low-profile design with edge to edge glass and an extremely responsive display making it a great architectural addition to conference rooms, executive offices and open spaces.

Installation

- Connect the Touchscreen to a Fifth Light connected PoE (IEEE 802.3af) enabled switch via an ethernet (CAT5 or higher) cable using the RJ45 port on the rear of the touchscreen
- The Touchscreen flush mounts in a portrait orientation to a single-gang switch box
- Do not mount on metal surface
- Use the Settings menu (PIN protected) on the Touchscreen for setup, i.e. associate it to a Fifth Light Central Manager and select one of the areas configured on the selected Central Manager

For more information, please refer to the Fifth Light Touchscreen Installation Guide.

Wiring Diagrams

Network Installation

